



ASSEMBLY INSTRUCTIONS COASTER FINE FURNITURE



Fine Furniture for every stage of life

106581(B1&B2) Dining Table

REVISION 0: 02/10/2015
REVISION 1: 10/16/2017
REVISION 2: 07/22/2019
REVISION 3: 05/21/2020

PAGE 1 OF 4

COASTERFURNITURE.COM

ITEM : 106581(B1&B2)



ASSEMBLY INSTRUCTIONS

ASSEMBLY TIPS:

1. Remove hardware from box and sort by size.
2. Please check to see that all hardware and parts are present prior to start of assembly.
3. Please follow attached instructions in the same sequence as numbered to assure fast & easy assembly.



WARNING!

1. Don't attempt to repair or modify parts that are broken or defective. Please contact the store immediately.
2. This product is for home use only and not intended for commercial establishments.



ASSEMBLY TIME

10 MINUTES

PARTS IDENTIFICATION

B1 (BOX 1)

A TOP

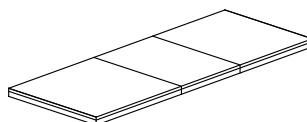

1PC

C STRETCHER



2PCS

B2 (BOX 2)

B LEG FRAME

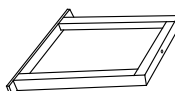

2PCS

HARDWARE IDENTIFICATION

Z-B1 (BOX 1) - HARDWARE PACK IS LOCATED IN 106581 (B1)

1 SHORT BOLT WITH WASHER
(M6 x 40mm - BLK)

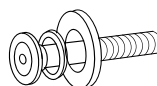

8PCS

2 LONG BOLT WITH WASHER
(M6 x 60mm - BLK)

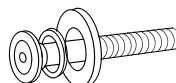

2PCS

3 HEX NUT
(5/16 - GD)



2PCS

4 LOCK WASHER
(M8 X 13mm - GD)



2PCS

5 FLAT WASHER
(M8 X 22mm - GD)



2PCS

6 ALLEN WRENCH
(M4 - GD)

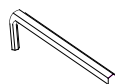

1PC

7 WRENCH
(12.8 - GD)



1PC

ITEM : 106581(B1&B2)

ASSEMBLY INSTRUCTIONS



STEP 1

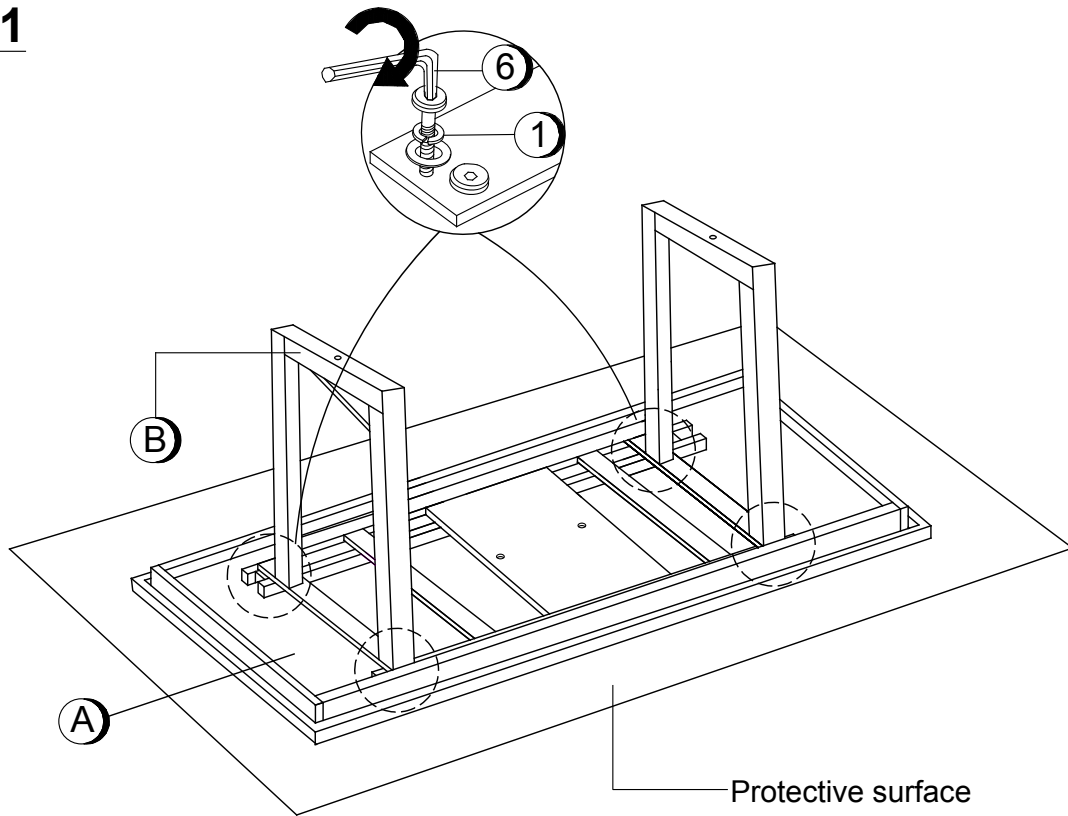

STEP 2

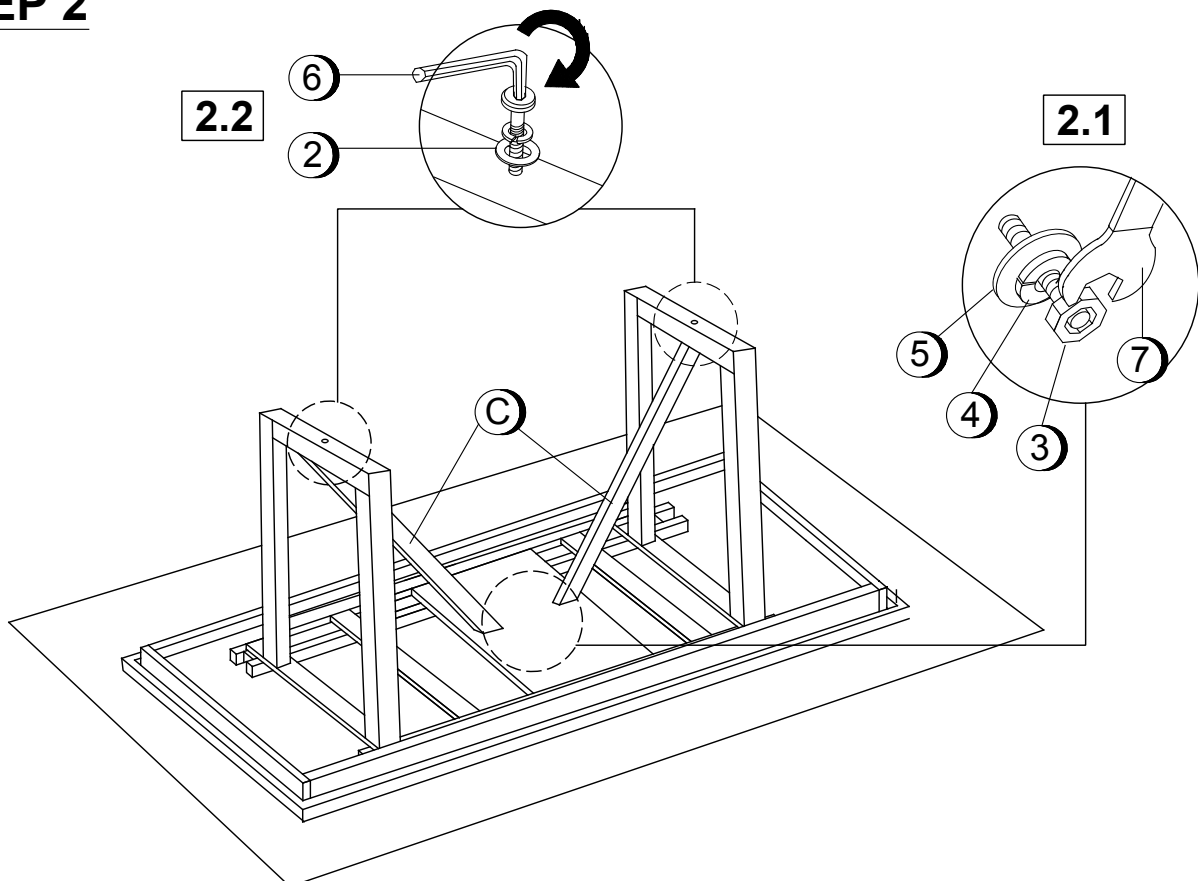

ITEM : 106581(B1&B2)

ASSEMBLY INSTRUCTIONS

STEP 3

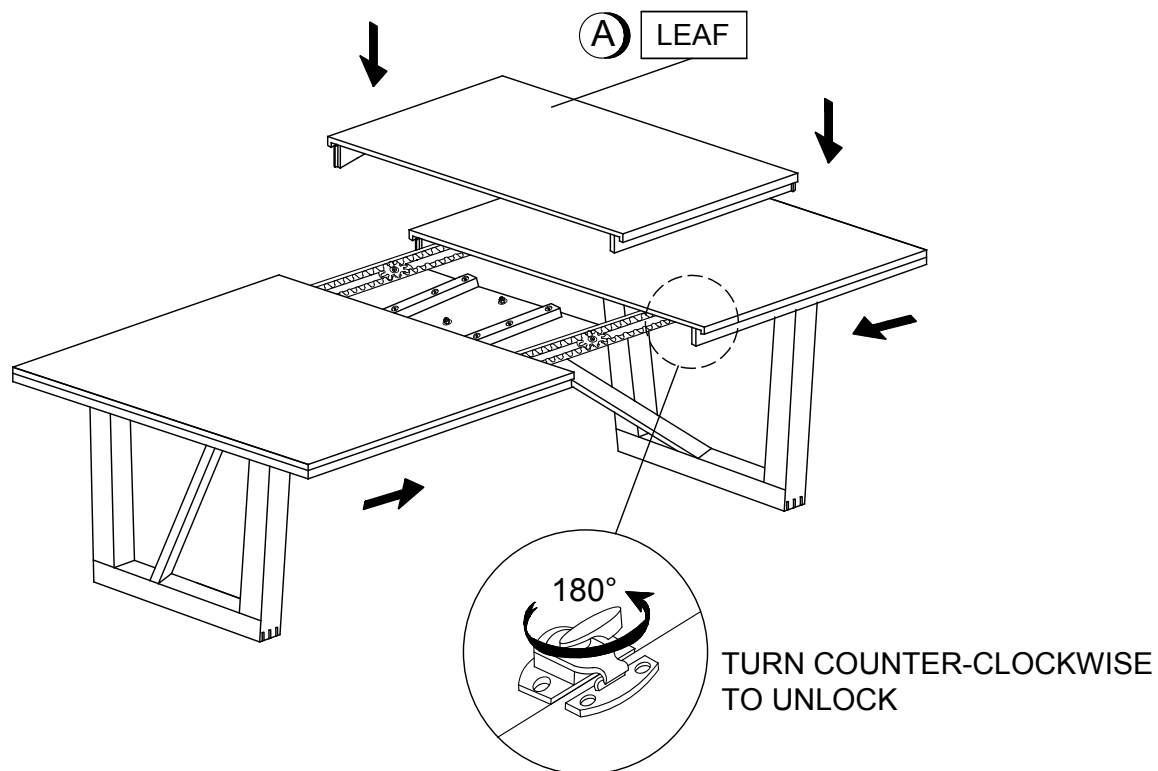

STEP 4 COMPLETE

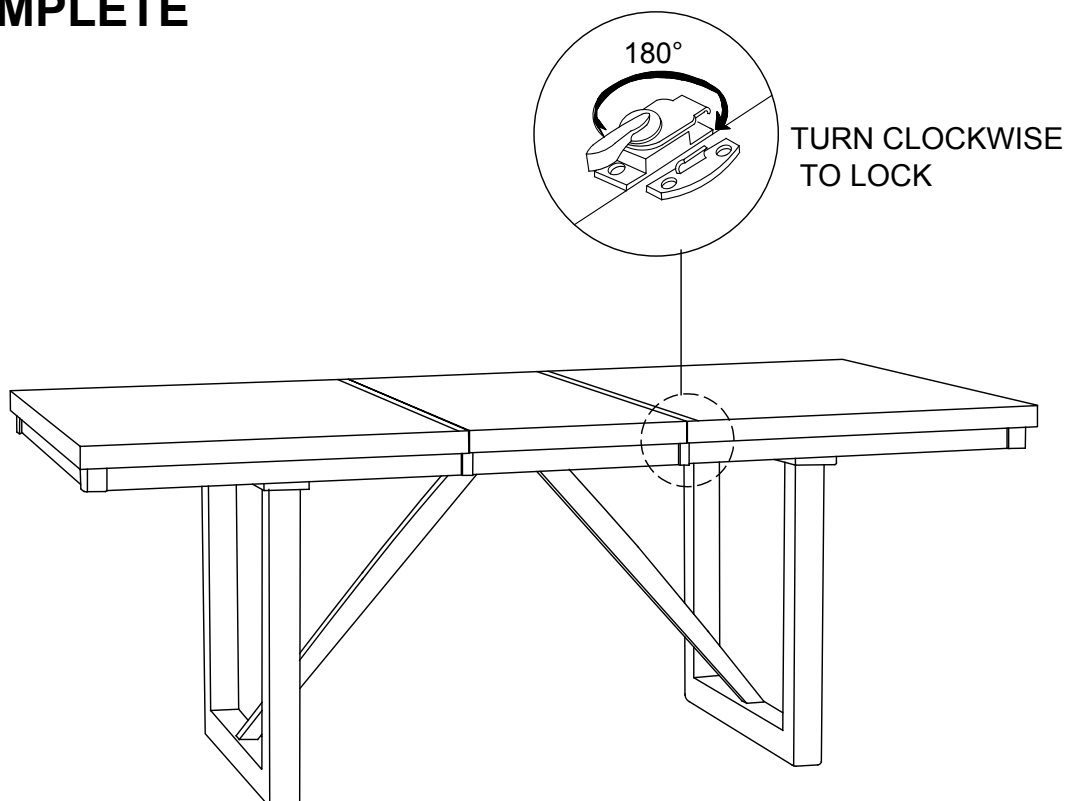

ITEM : 106581(B1&B2)

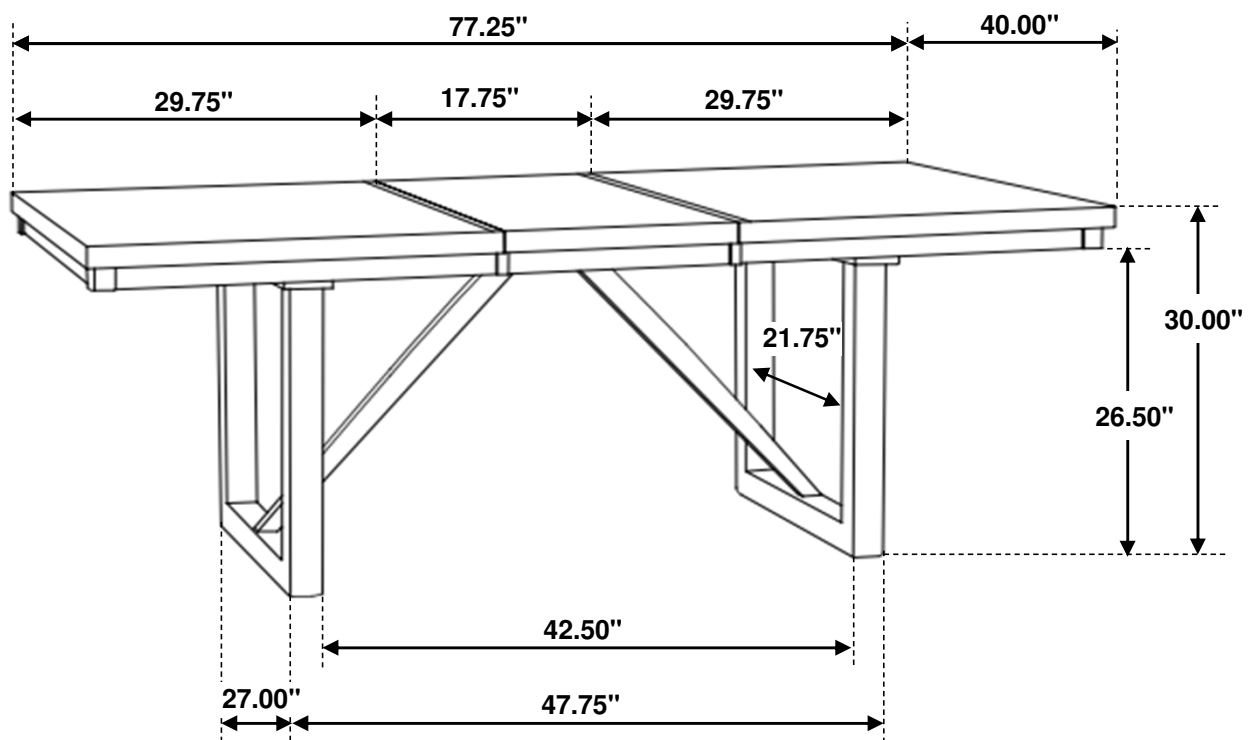

Note : Dimension tolerance $\pm 5\%$



ASSEMBLY INSTRUCTIONS

COASTER FINE FURNITURE



Fine Furniture for every stage of life

106582

Dining Side Chair

REVISION 0:02/10/2015
REVISION 1:10/16/2017
REVISION 2:07/22/2019

PAGE 1 OF 4

COASTERFURNITURE.COM

ITEM : 106582

ASSEMBLY INSTRUCTIONS



ASSEMBLY TIPS:

1. Remove hardware from box and sort by size.
2. Please check to see that all hardware and parts are present prior to start of assembly.
3. Please follow attached instructions in the same sequence as numbered to assure fast & easy assembly.



WARNING!

1. Don't attempt to repair or modify parts that are broken or defective. Please contact the store immediately.
2. This product is for home use only and not intended for commercial establishments.



ASSEMBLY TIME

10 MINUTES

PARTS IDENTIFICATION

A BACK FRAME

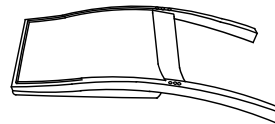

1PC

B SEAT CUSHION WITH FRAME

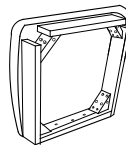

1PC

C FRONT LEG



2PCS

HARDWARE IDENTIFICATION

1 LONG BOLT WITH WASHER
(M6 x 80mm - BLK)

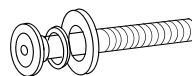

4PCS

2 MEDIUM BOLT WITH WASHER
(M6 x 60mm - BLK)

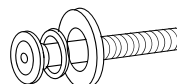

4PCS

3 SHORT BOLT WITH WASHER
(M6 x 45mm - BLK)

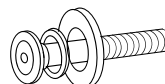

3PCS

4 ALLEN WRENCH
(M4 - GD)

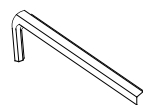

1PC

NOTE:

Quantities shown are for one chair.

ITEM : 106582

ASSEMBLY INSTRUCTIONS



STEP 1

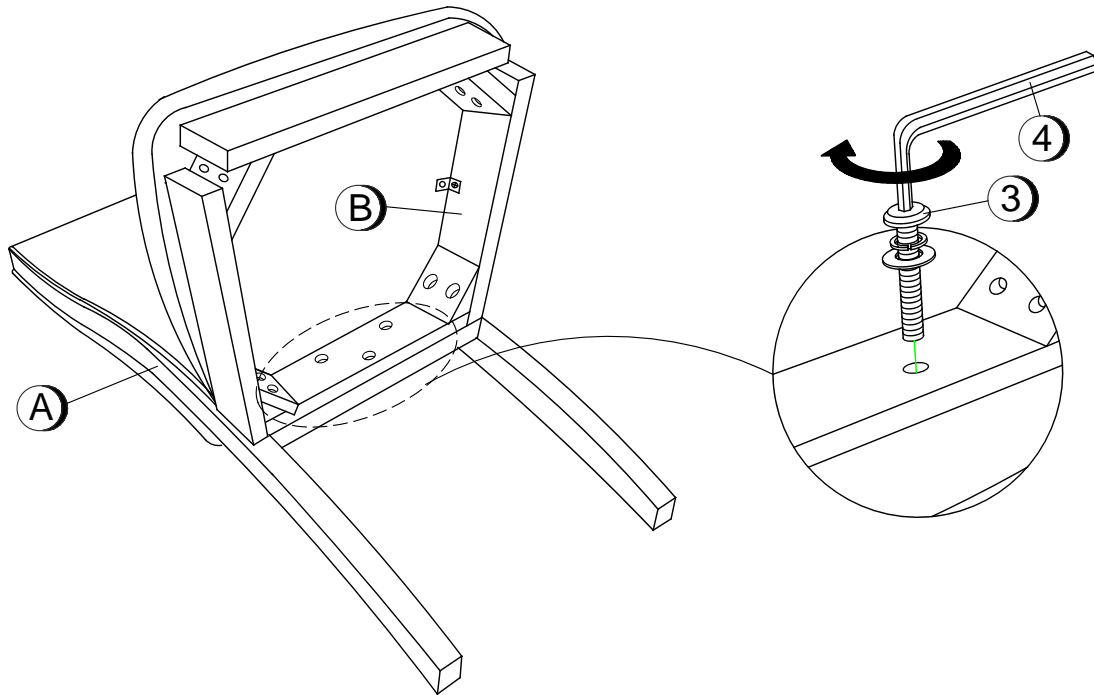

STEP 2

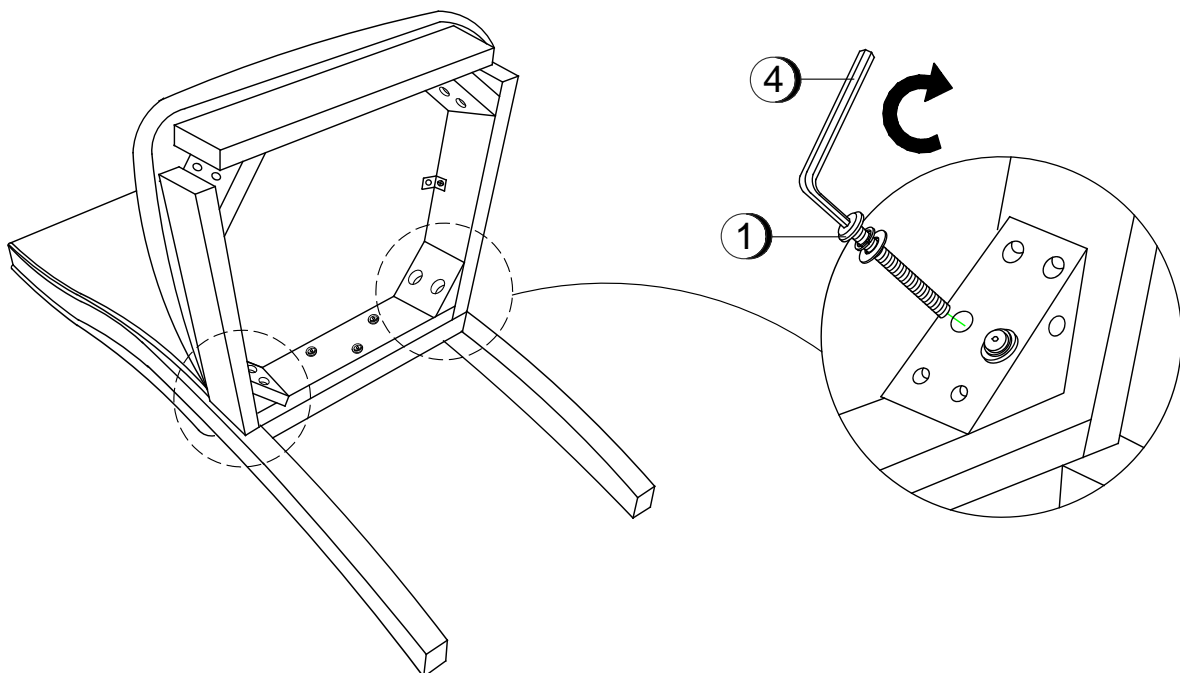

ITEM :106582

ASSEMBLY INSTRUCTIONS



STEP 3

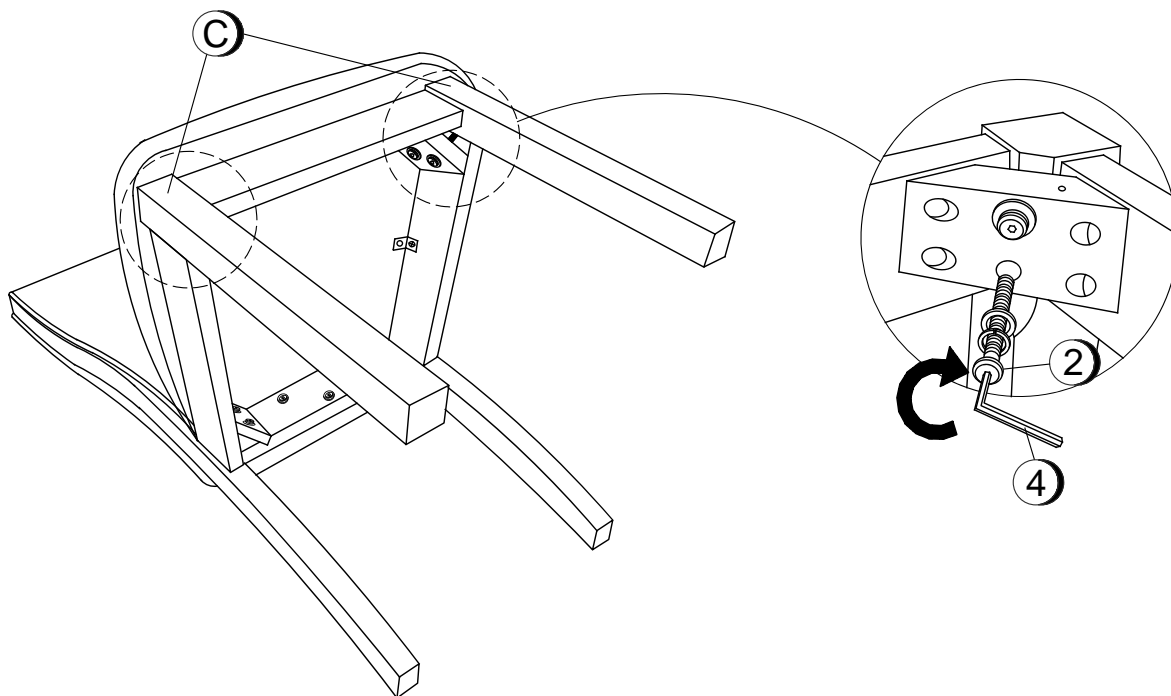

STEP 4 COMPLETE

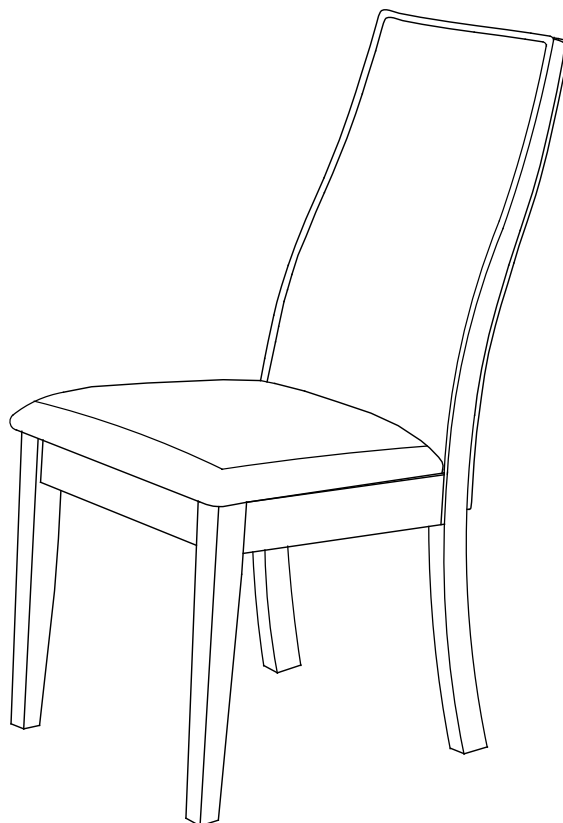

ITEM : 106582

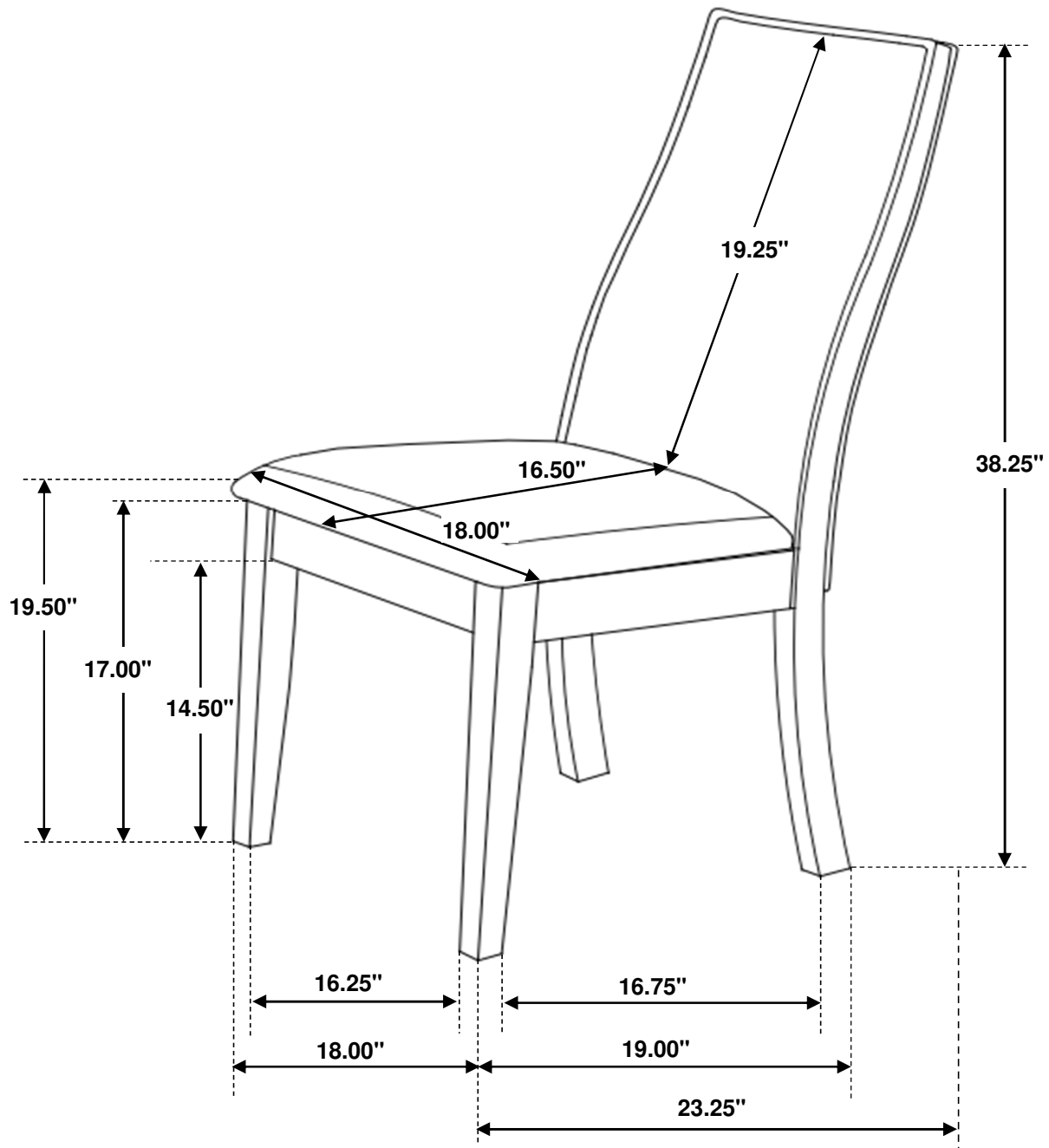

Note : Dimension tolerance $\pm 5\%$