

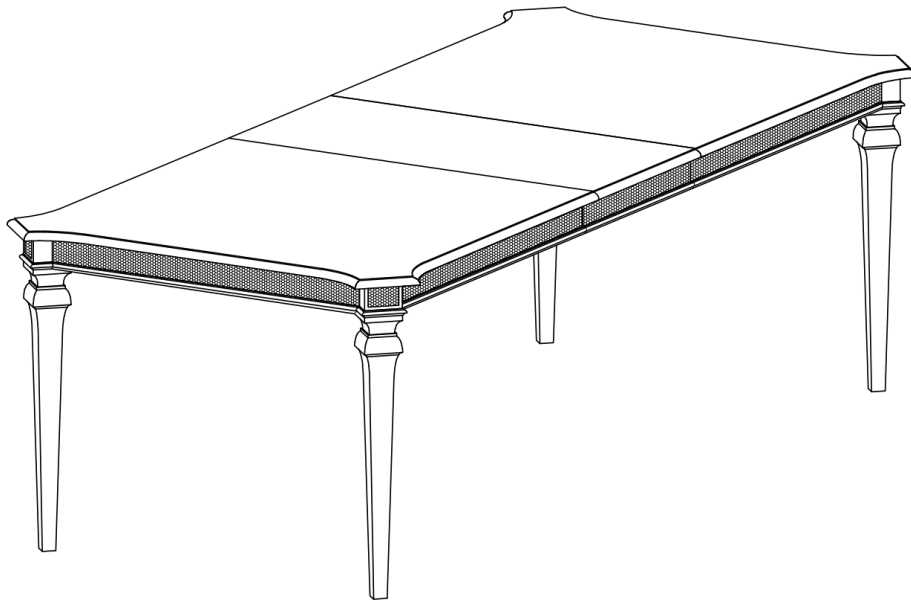

ASSEMBLY INSTRUCTIONS
COASTER FINE FURNITURE



Fine Furniture for every stage of life

107551
Dining Table

ITEM: **107551**

ASSEMBLY INSTRUCTIONS

ASSEMBLY TIPS:

1. Remove hardware from box and sort by size.
2. Please check to see that all hardware and parts are present prior to start of assembly.
3. Please follow attached instructions in the same sequence as numbered to assure fast & easy assembly.



WARNING!

1. Don't attempt to repair or modify parts that are broken or defective. Please contact the store immediately.
2. This product is for home use only and not intended for commercial establishments.



ASSEMBLY TIME

5 MINUTES

PARTS IDENTIFICATION

A TOP

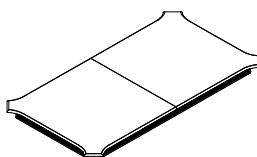

1PC

B LEG

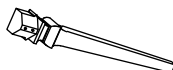

4PCS

C LEAF

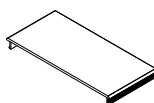

1PC

HARDWARE IDENTIFICATION

1

BOLT
(Φ5/16" x 65mm - RBW)

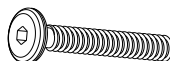

8PCS

2

LOCK WASHER
(Φ5/16" - RBW)



8PCS

3

FLAT WASHER
(Φ5/16" - RBW)



8PCS

4

ALLEN WRENCH
(4MM - RBW)



1PC

ITEM: **107551**

ASSEMBLY INSTRUCTIONS

STEP 1

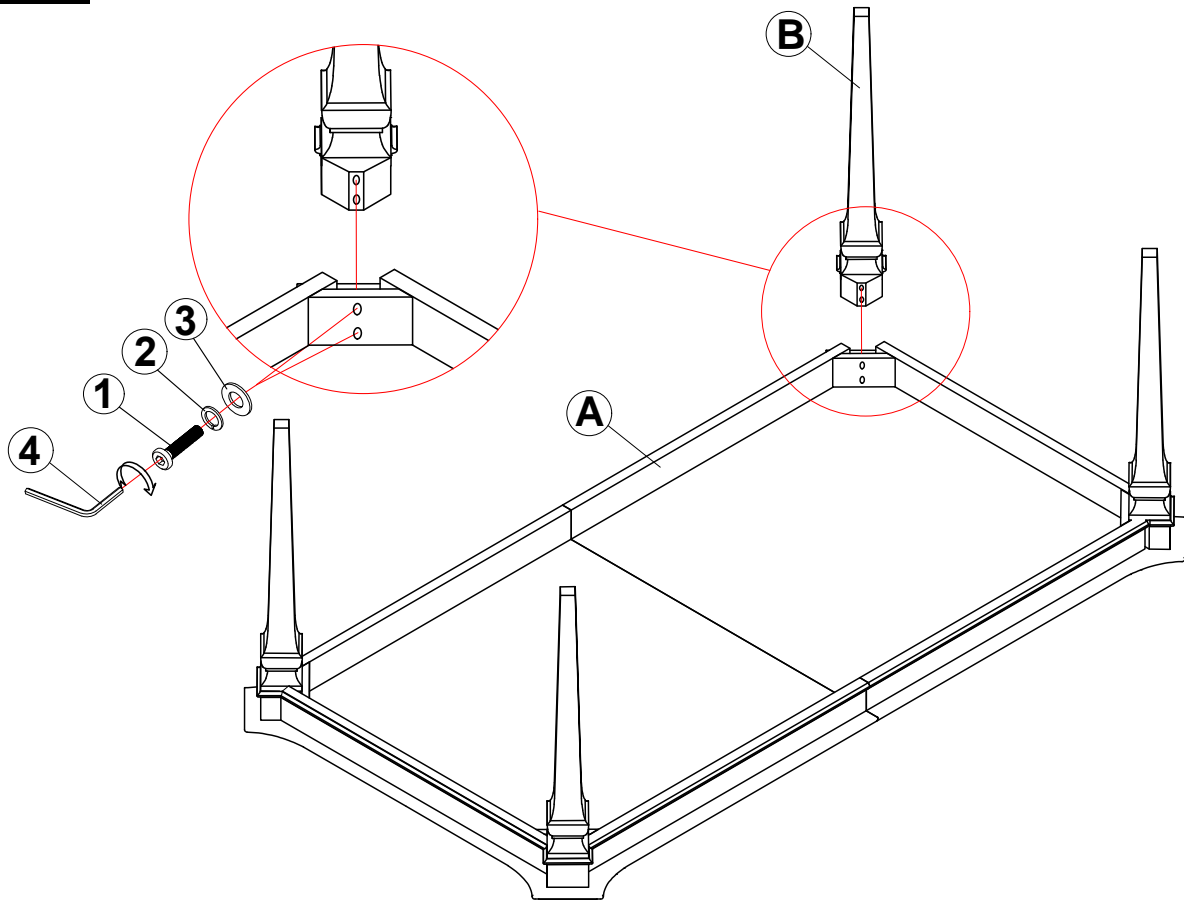

STEP 2

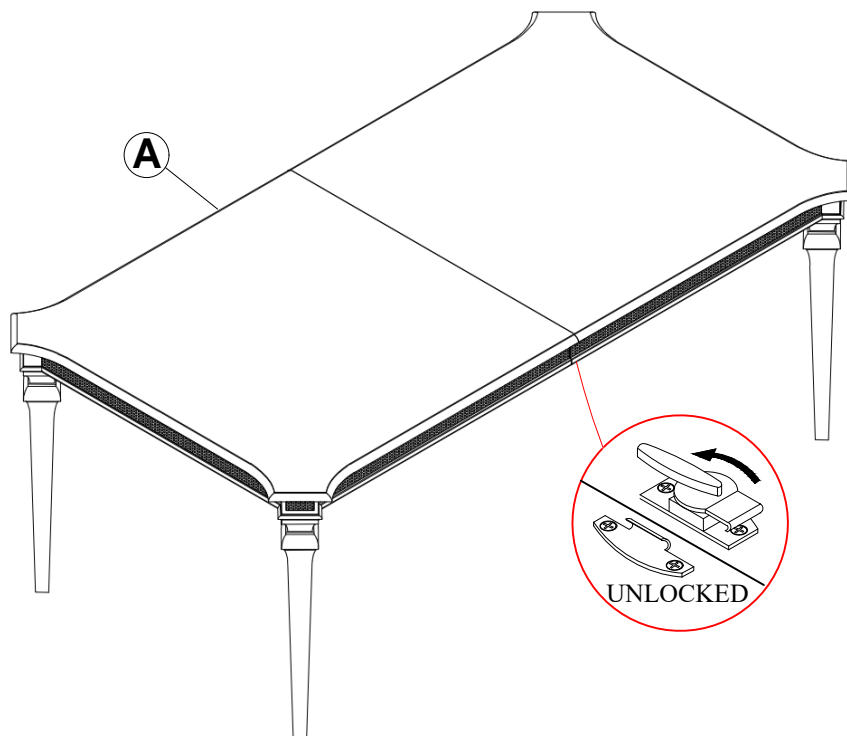

ITEM: **107551**

ASSEMBLY INSTRUCTIONS

STEP 3

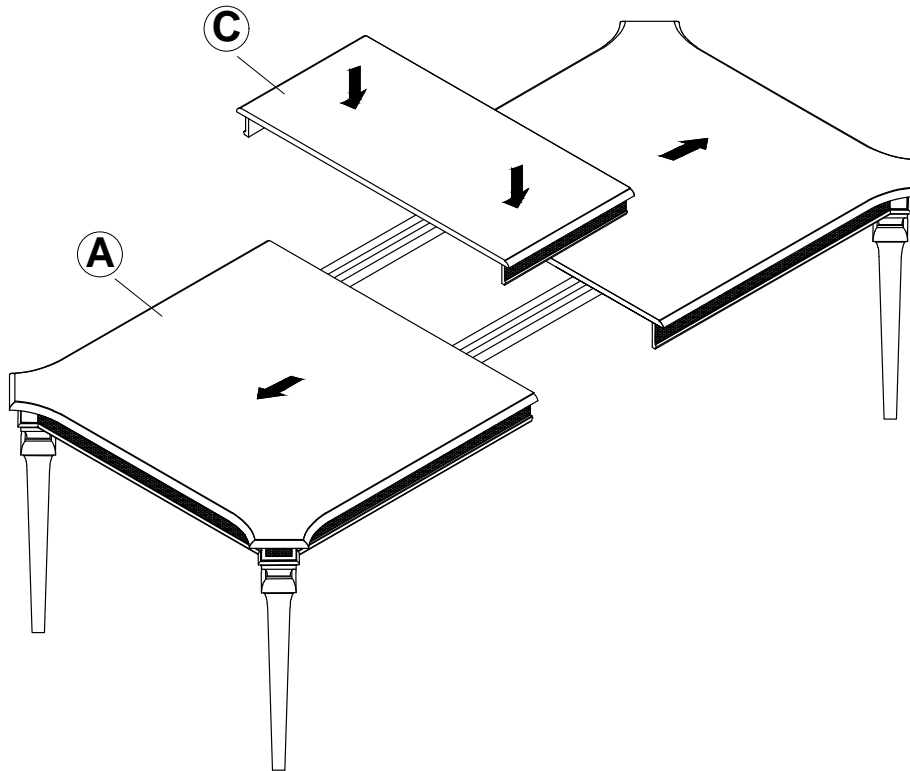

STEP 4 COMPLETE

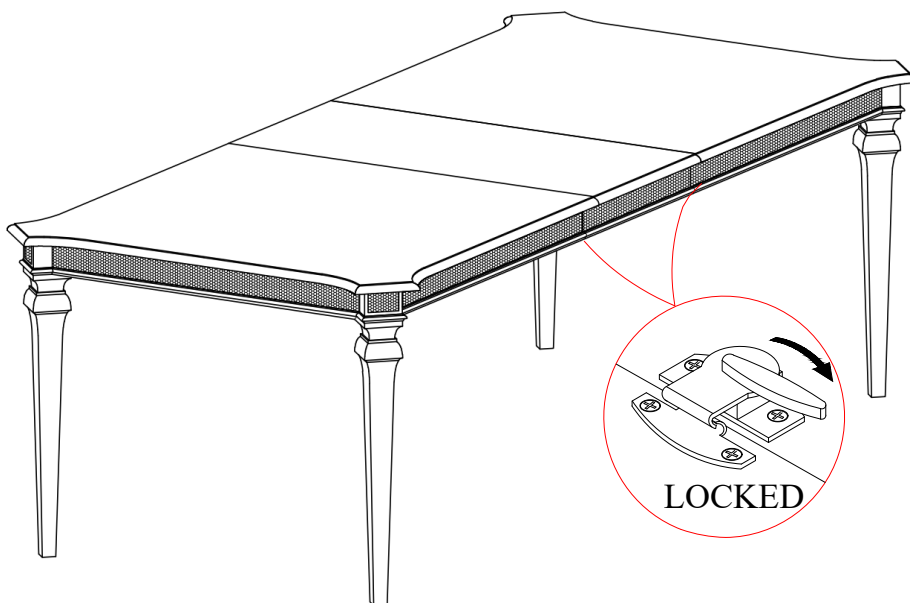

ITEM:107551

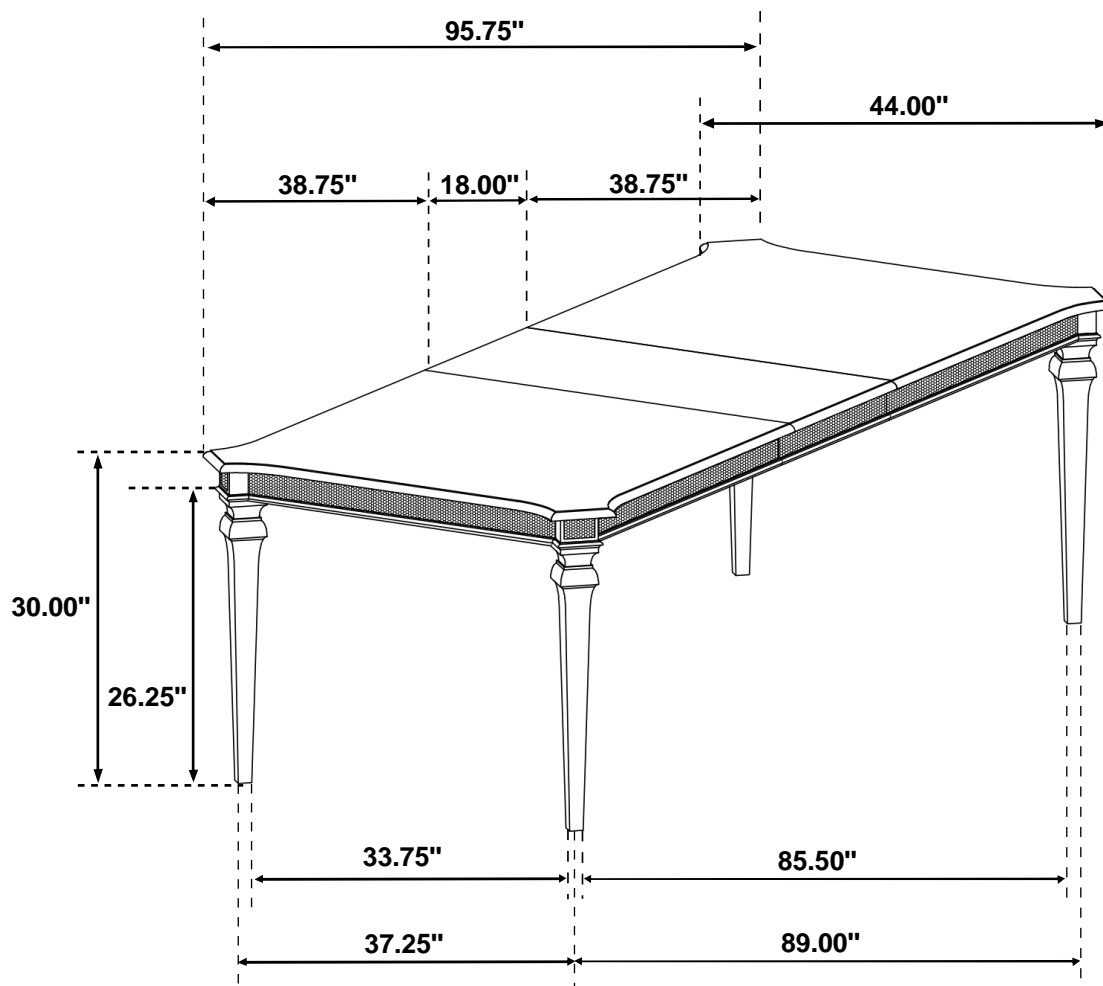

Note: Dimension tolerance $\pm 5\%$



ASSEMBLY INSTRUCTIONS
COASTER FINE FURNITURE



Fine Furniture for every stage of life

107552
Dining Side Chair

ITEM: **107552**



ASSEMBLY INSTRUCTIONS

ASSEMBLY TIPS:

1. Remove hardware from box and sort by size.
2. Please check to see that all hardware and parts are present prior to start of assembly.
3. Please follow attached instructions in the same sequence as numbered to assure fast & easy assembly.



WARNING!

1. Don't attempt to repair or modify parts that are broken or defective. Please contact the store immediately.
2. This product is for home use only and not intended for commercial establishments.



ASSEMBLY TIME

5 MINUTES

PARTS IDENTIFICATION

A BACK FRAME

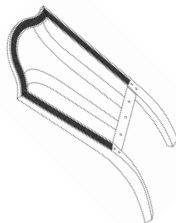

1PC

B SEAT CUSHION
WITH FRAME

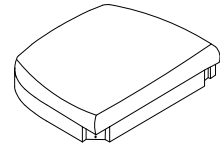

1PC

C FRONT LEG

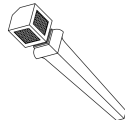

2PCS

HARDWARE IDENTIFICATION

1 SHORT BOLT
($\Phi 5/16"$ x 50mm - RBW)

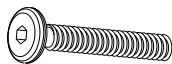

5PCS

2 LONG BOLT
($\Phi 5/16"$ x 70mm - RBW)

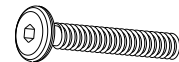

4PCS

3 LOCK WASHER
($\Phi 5/16"$ - RBW)



9PCS

4 FLAT WASHER
($\Phi 5/16"$ - RBW)



9PCS

5 ALLEN WRENCH
(4MM - RBW)



1PC

ITEM: **107552**

ASSEMBLY INSTRUCTIONS

STEP 1

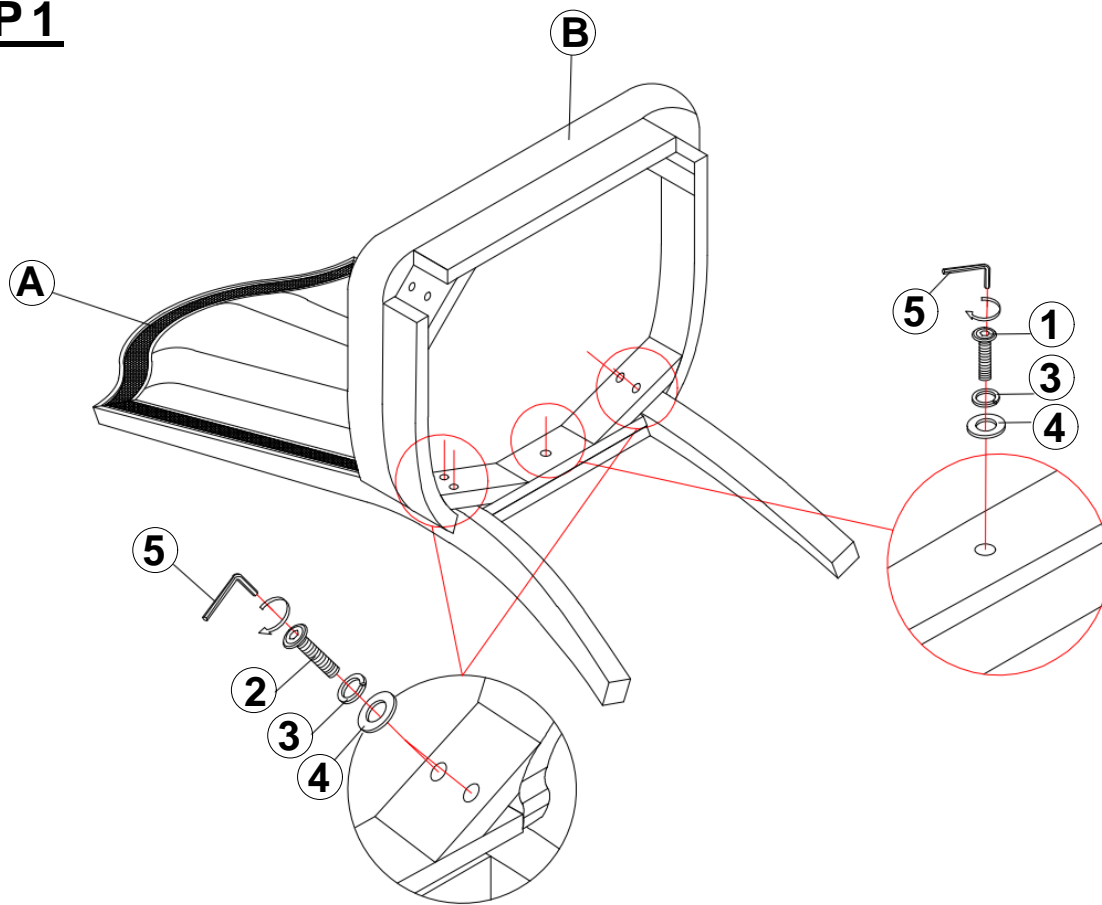

STEP 2

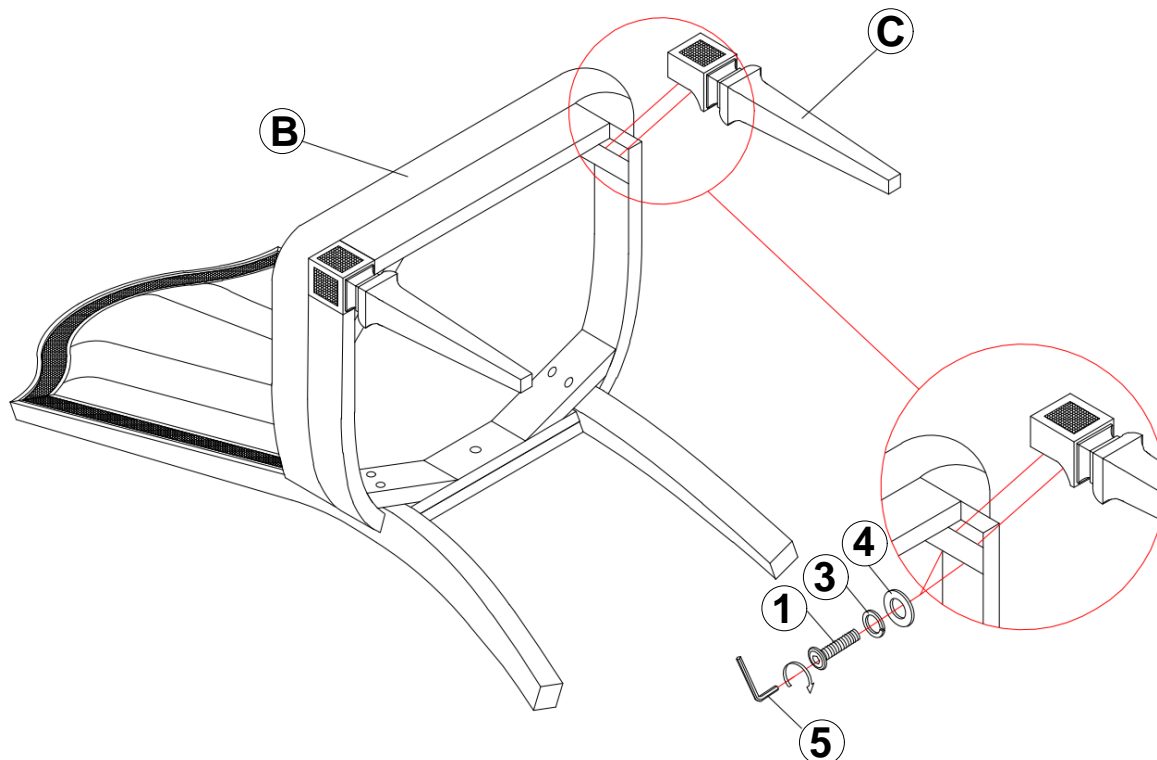

ITEM: **107552**

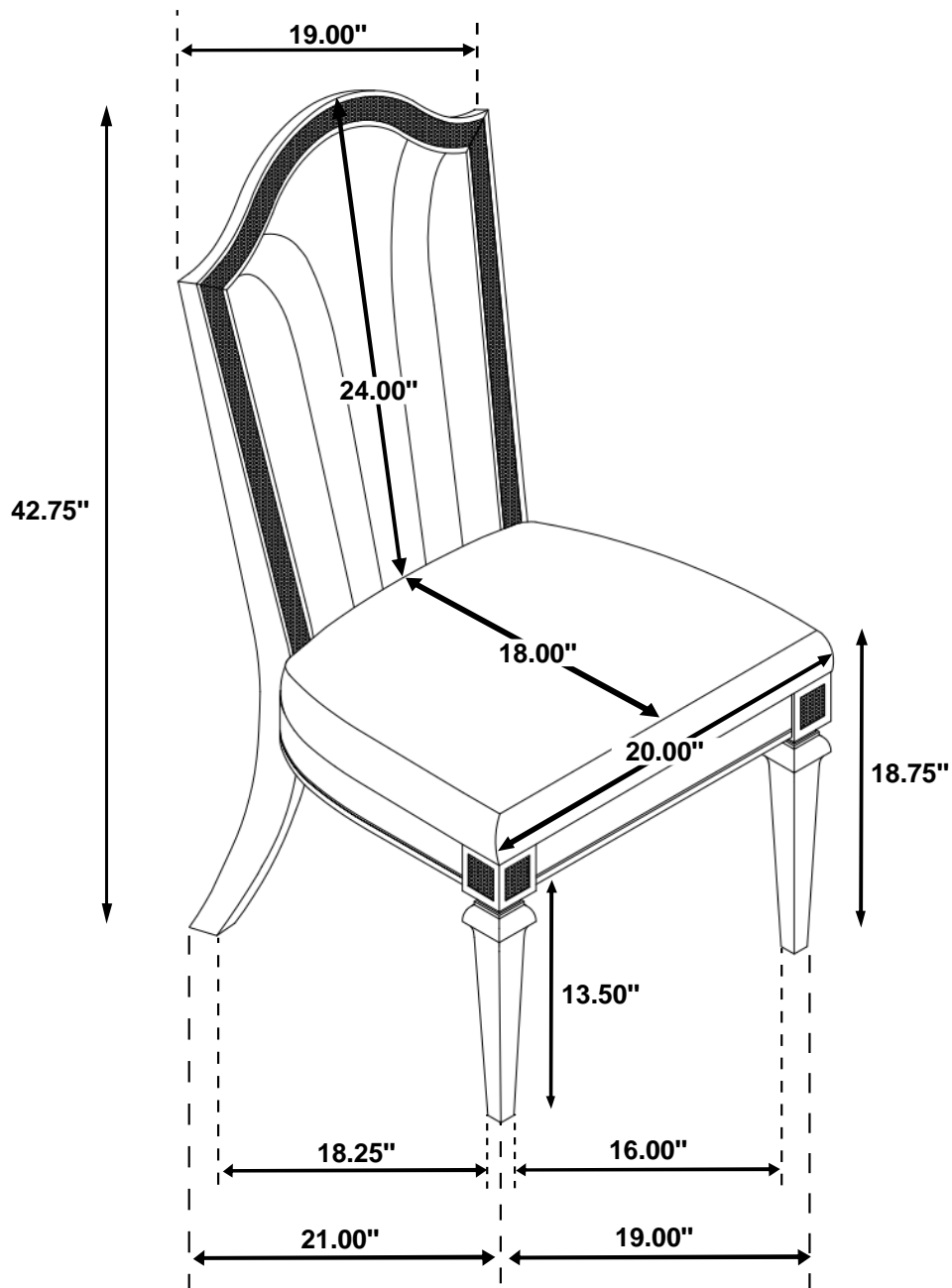

Note: Dimension tolerance $\pm 5\%$



ASSEMBLY INSTRUCTIONS
COASTER FINE FURNITURE



Fine Furniture for every stage of life

107553
DiningArm Chair

ITEM: **107553**



ASSEMBLY INSTRUCTIONS

ASSEMBLY TIPS:

1. Remove hardware from box and sort by size.
2. Please check to see that all hardware and parts are present prior to start of assembly.
3. Please follow attached instructions in the same sequence as numbered to assure fast & easy assembly.



WARNING!

1. Don't attempt to repair or modify parts that are broken or defective. Please contact the store immediately.
2. This product is for home use only and not intended for commercial establishments.



ASSEMBLY TIME

5 MINUTES

PARTS IDENTIFICATION

A BACK FRAME

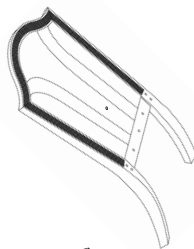

1PC

B SEAT CUSHION
WITH FRAME

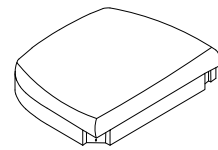

1PC

C FRONT LEG

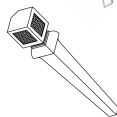

2PCS

D RIGHT ARM

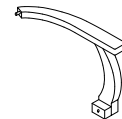

1PC

E LEFT ARM

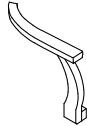

1PC

HARDWARE IDENTIFICATION

1 MEDIUM BOLT
($\Phi 5/16"$ x 50 mm - RBW)

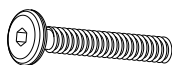

5PCS

2 LONG BOLT
($\Phi 5/16"$ x 70 mm - RBW)

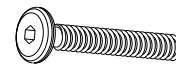

4PCS

3 SHORT BOLT
($\Phi 5/16"$ x 40 mm - RBW)

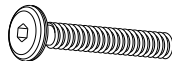

2PCS

4 LOCK WASHER
($\Phi 5/16"$ - RBW)



11PCS

5 FLAT WASHER
($\Phi 5/16"$ - RBW)



11PCS

6 ALLEN WRENCH
(4MM - RBW)



1PC

7 FLAT HEAD SCREW
($\Phi 4$ x 50mm - NK)

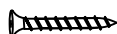

2PCS

ITEM: **107552**

ASSEMBLY INSTRUCTIONS

STEP 1

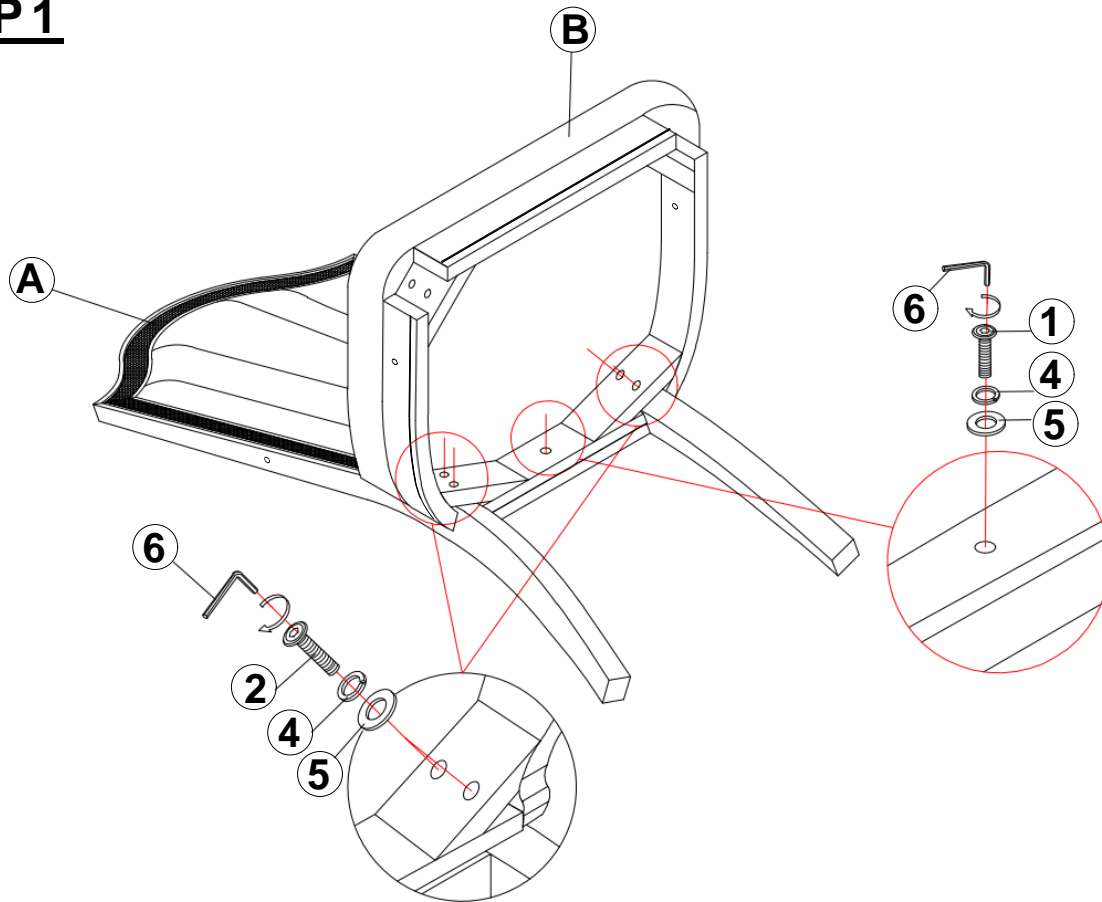

STEP 2

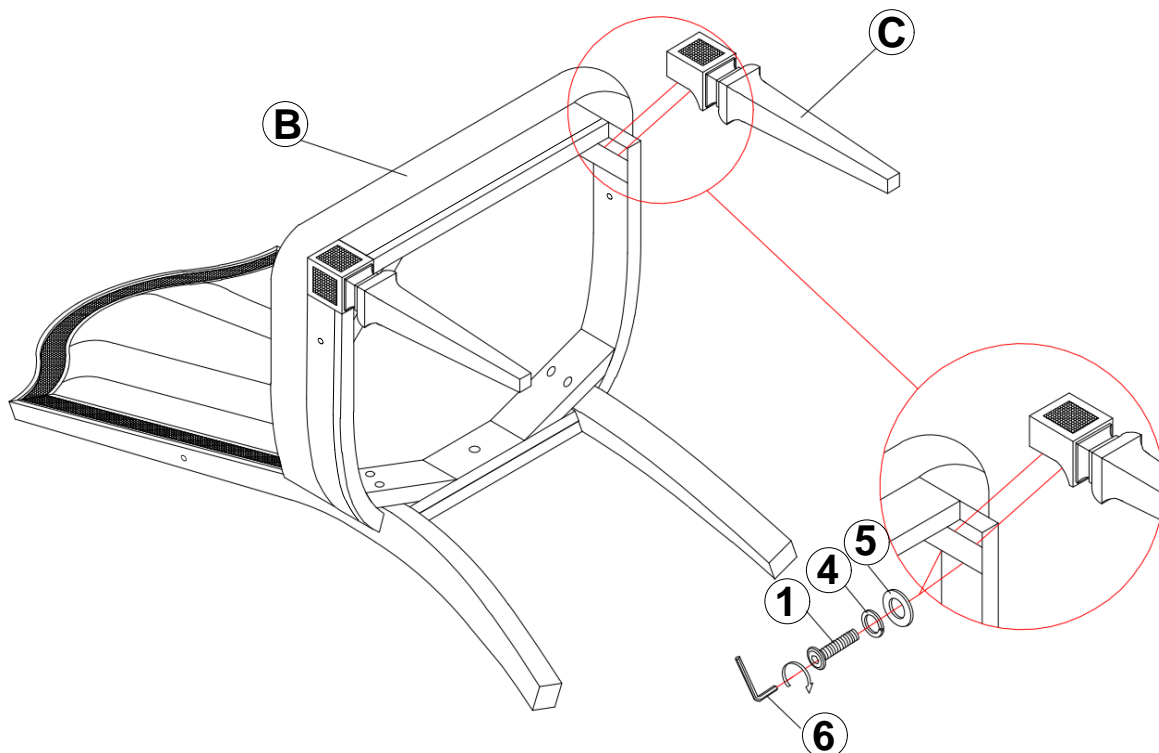

ITEM: **107553**

ASSEMBLY INSTRUCTIONS

STEP 3

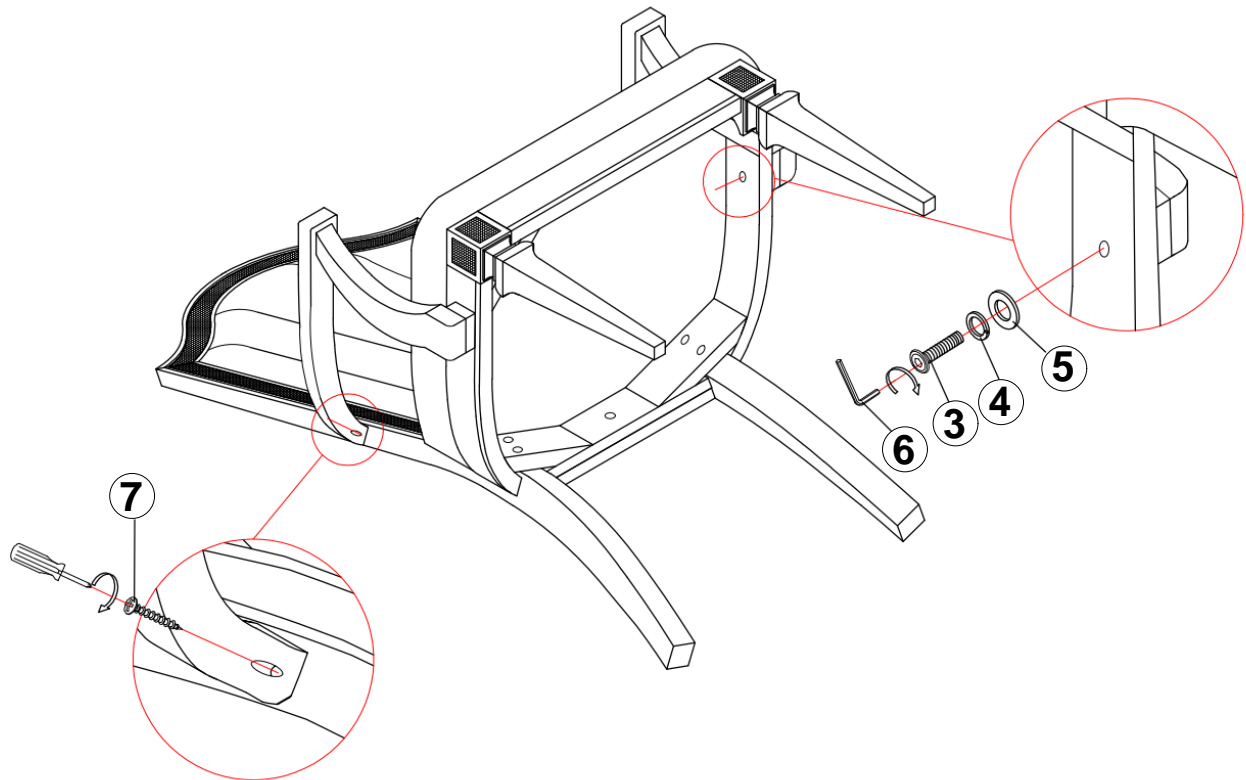

STEP 4 COMPLETE

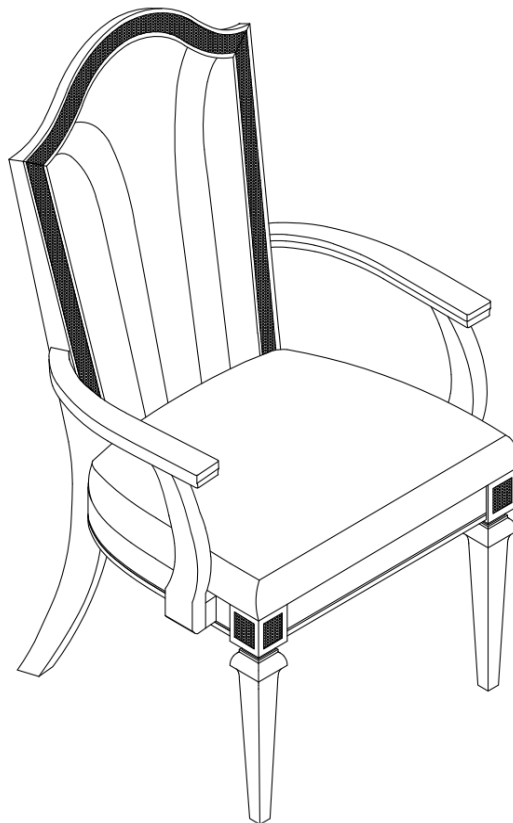

ITEM: **107553**

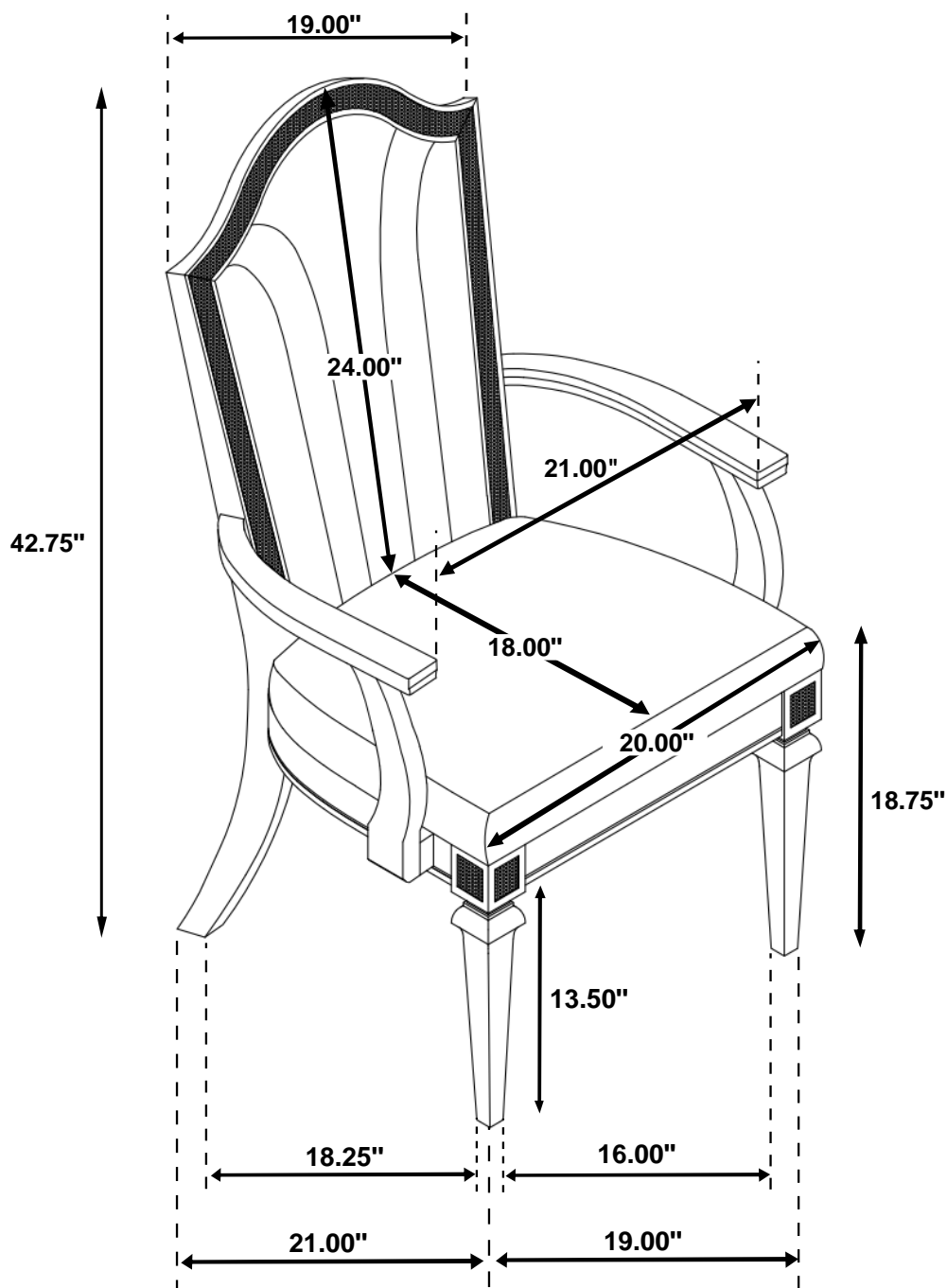

Note: Dimension tolerance $\pm 5\%$