



ASSEMBLY INSTRUCTIONS COASTER FINE FURNITURE



Fine Furniture for every stage of life

108231
Dining Table

ITEM: **108231**



ASSEMBLY INSTRUCTIONS

ASSEMBLY TIPS:

- 1.Remove hardware from box and sort by size.
- 2.Please check to see that all hardware and parts are present prior to start of assembly.
- 3.Please follow attached instructions in the same sequence as numbered to assure fast & easy assembly.



WARNING

- 1.Don't attempt to repair or modify parts that are broken or defective. Please contact the store immediately.
- 2.This product is for home use only and not intended for commercial establishments.



ASSEMBLY TIME

10 MINUTES

PARTS IDENTIFICATION

A	TOP		1PC
B	LEAF		1PC
C	LEG FRAME		2PCS

HARDWARE IDENTIFICATION

1	BOLT (5/16" x 40mm - RBW)		20PCS
2	LOCK WASHER (5/16" - RBW)		20PCS
3	FLAT WASHER (5/16" x 19 x 1.5mm - RBW)		20PCS
4	ALLEN WRENCH (4mm - RBW)		1PC

ITEM: **108231**
ASSEMBLY INSTRUCTIONS



STEP 1

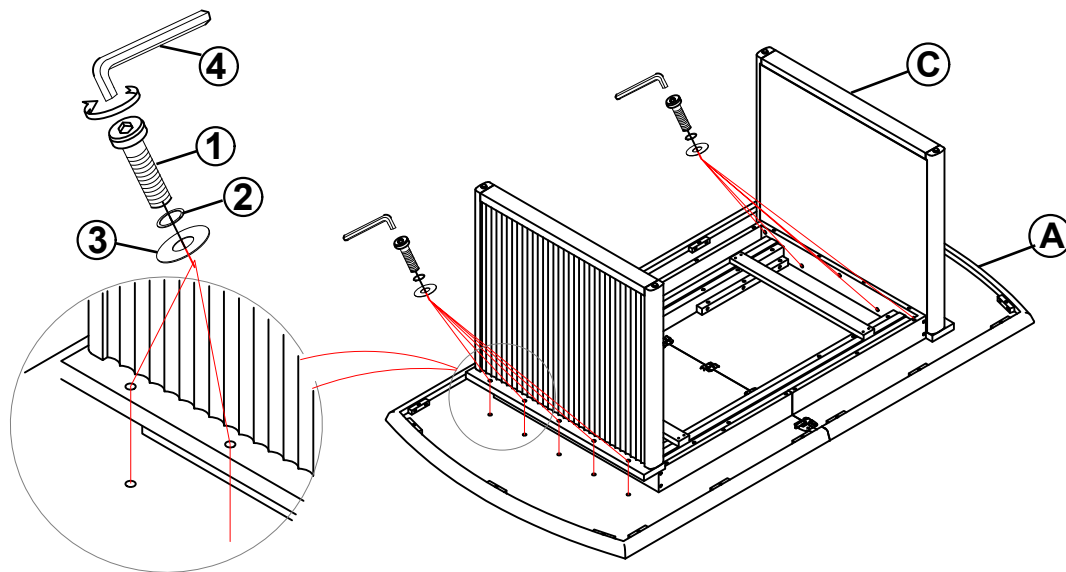

STEP 2

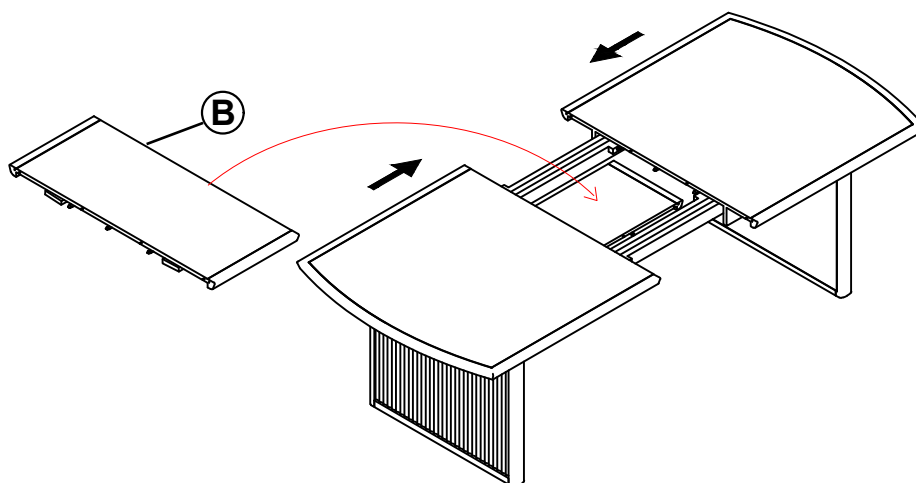

STEP 3
COMPLETE

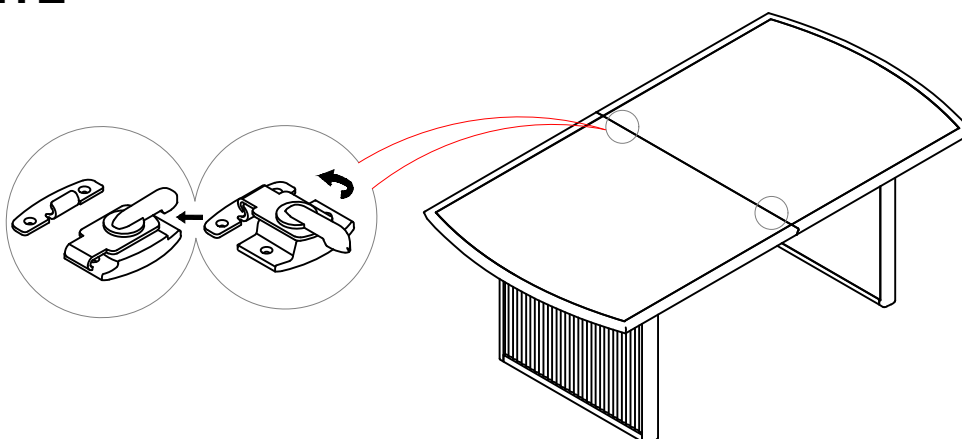

ITEM: **108231**



ASSEMBLY INSTRUCTIONS

STEP 4

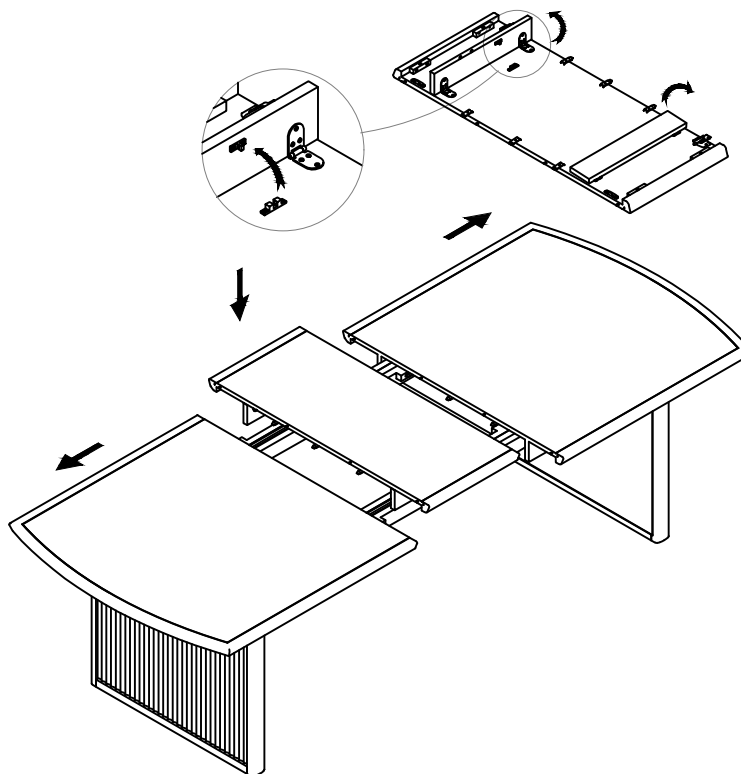

STEP 5

COMPLETE

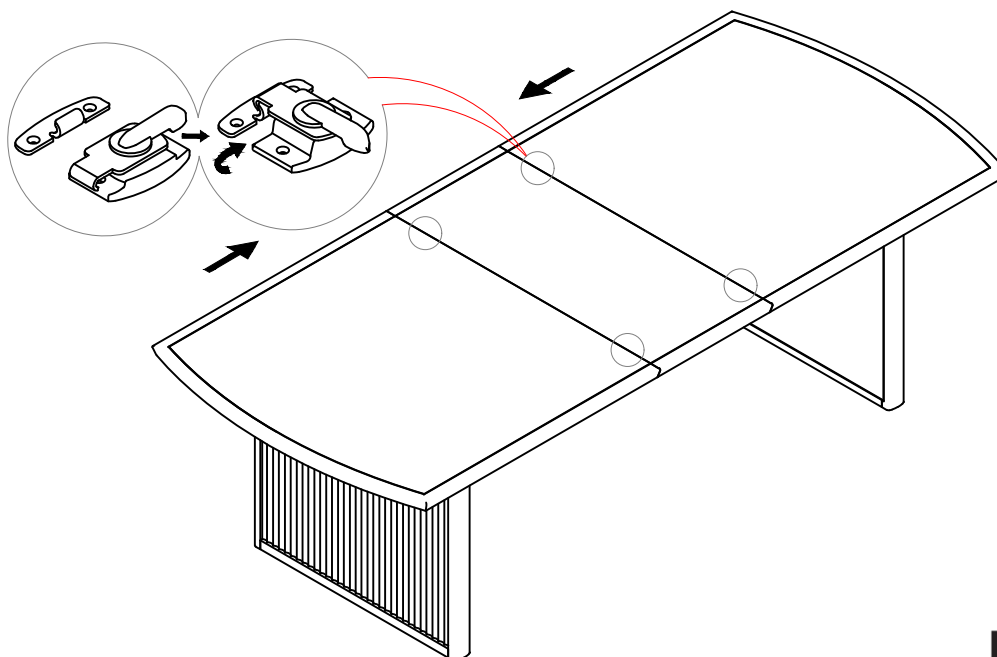

ITEM: **108231**

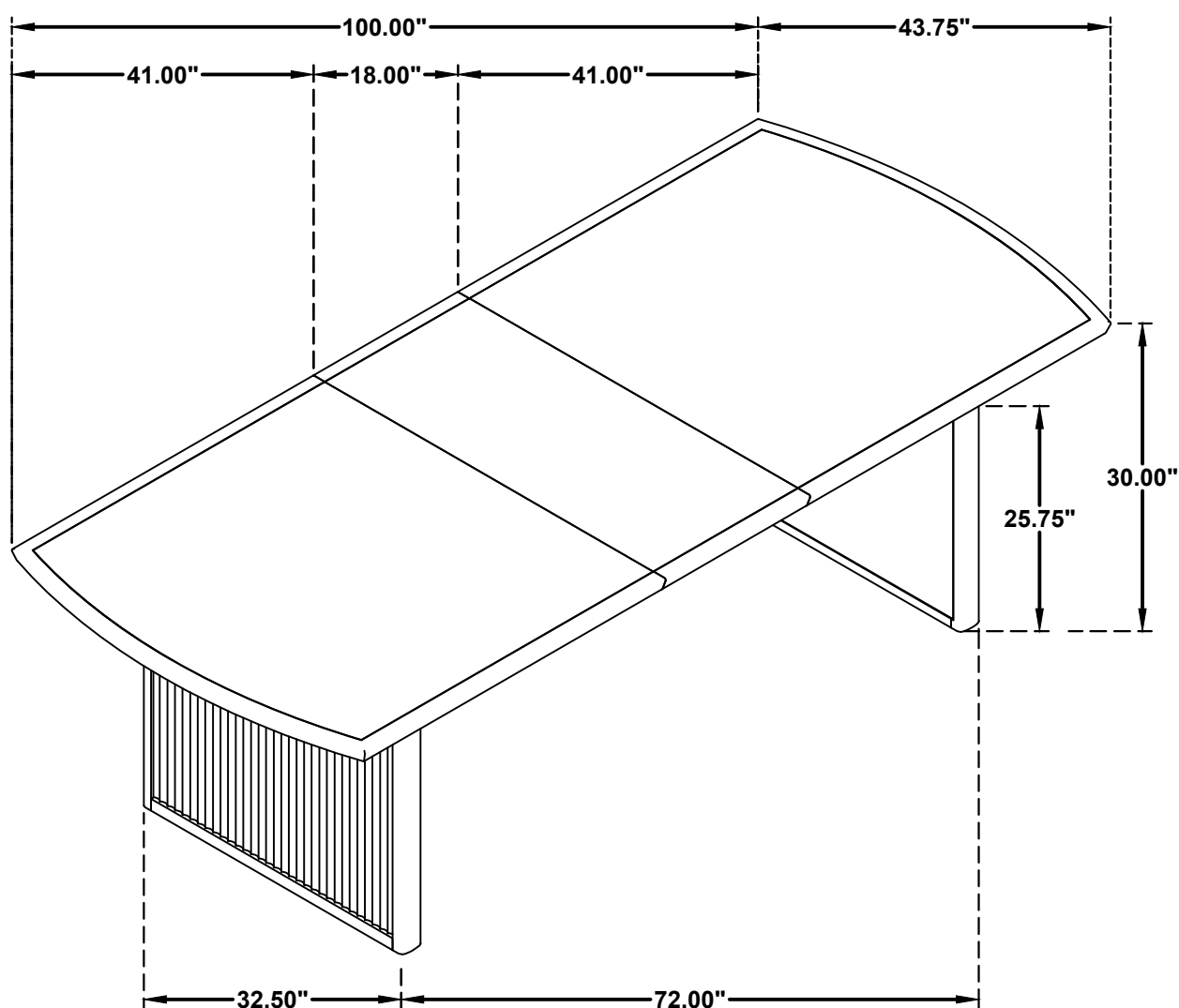

Note : Dimension tolerance $\pm 5\%$



ASSEMBLY INSTRUCTIONS COASTER FINE FURNITURE



Fine Furniture for every stage of life

108233
Side Chair

ITEM: 108233

ASSEMBLY INSTRUCTIONS



ASSEMBLY TIPS:

1. Remove hardware from box and sort by size.
2. Please check to see that all hardware and parts are present prior to start of assembly.
3. Please follow attached instructions in the same sequence as numbered to assure fast & easy assembly.



WARNING!

1. Don't attempt to repair or modify parts that are broken or defective. Please contact the store immediately.
2. This product is for home use only and not intended for commercial establishments.



ASSEMBLY TIME

10 MINUTES

PARTS IDENTIFICATION

A BACK FRAME

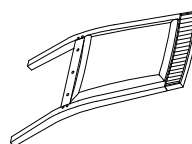

1PC

B SEAT CUSHION WITH FRAME

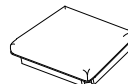

1PC

C FRONT LEG



2PCS

HARDWARE IDENTIFICATION

1 LONG BOLT
(5/16" x 70mm - BLK)



4PCS

2 MEDIUM BOLT
(5/16" x 50mm - BLK)



4PCS

3 SHORT BOLT
(5/16" x 38mm - BLK)

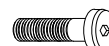

2PCS

4 LOCK WASHER
(5/16" - BLK)



10PCS

5 FLAT WASHER
(5/16" x 19 x 1.5mm - BLK)



10PCS

6 ALLEN WRENCH
(M4 x 30mm - BLK)



1PC

NOTE:

Quantities shown are for one chair.

ITEM: **108233**

ASSEMBLY INSTRUCTIONS



STEP 1

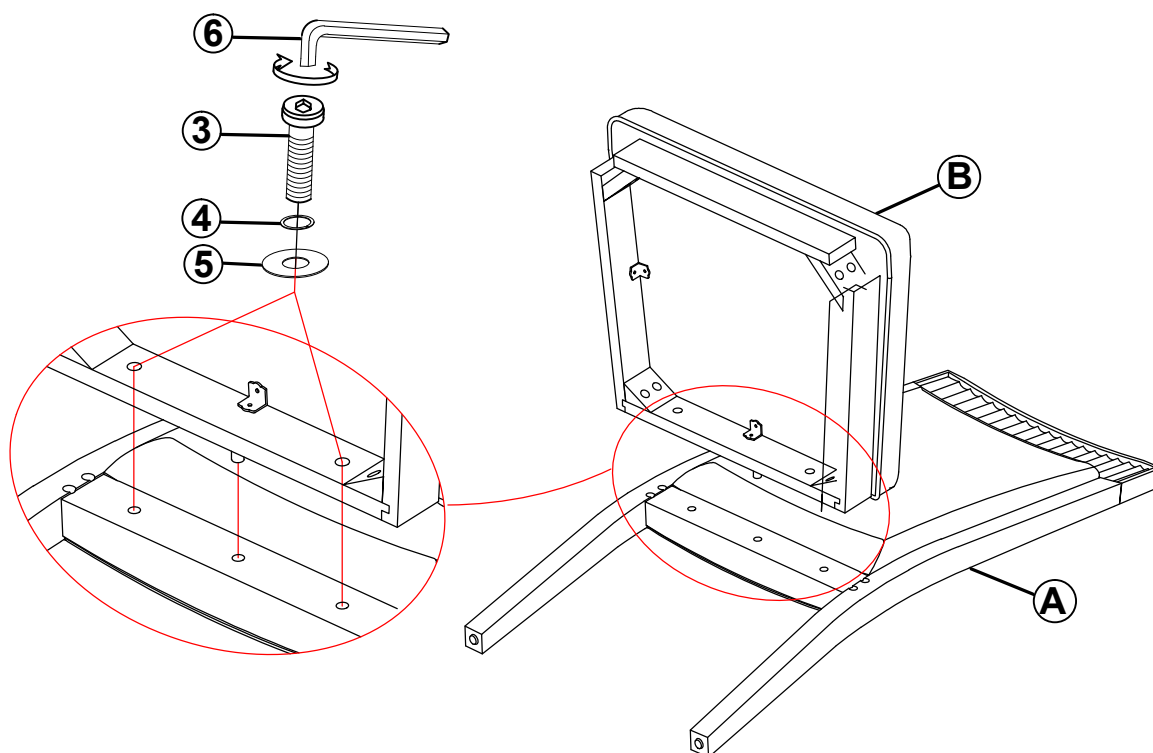

STEP 2

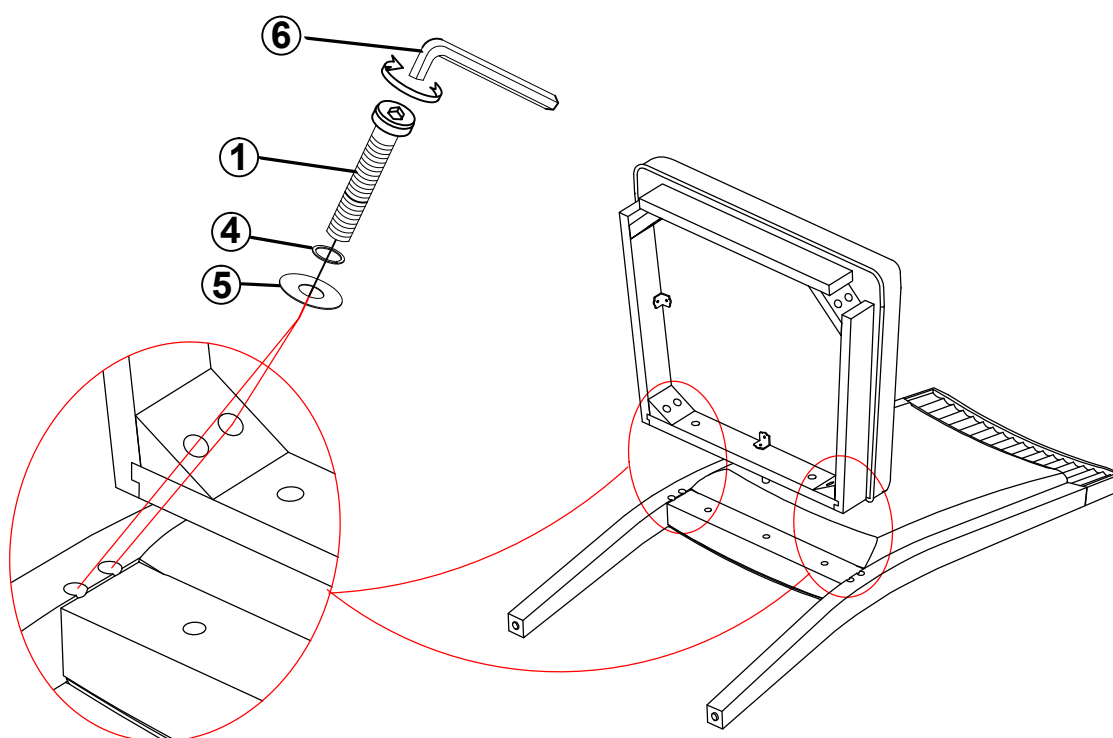

ITEM: **108233**

ASSEMBLY INSTRUCTIONS



STEP 3

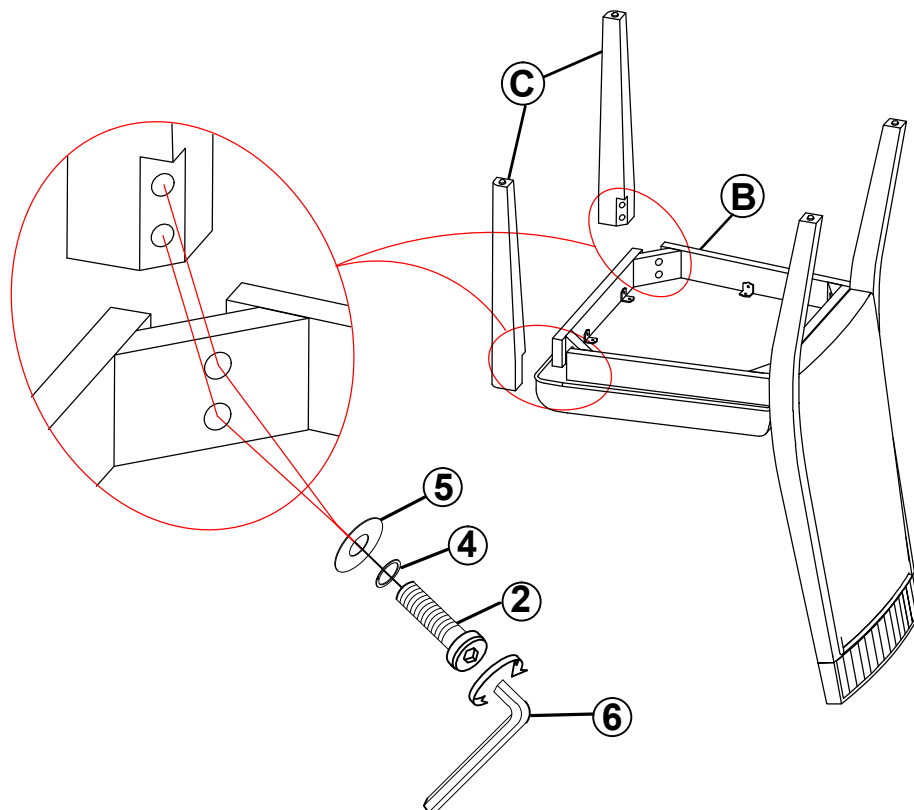

STEP 4 COMPLETE

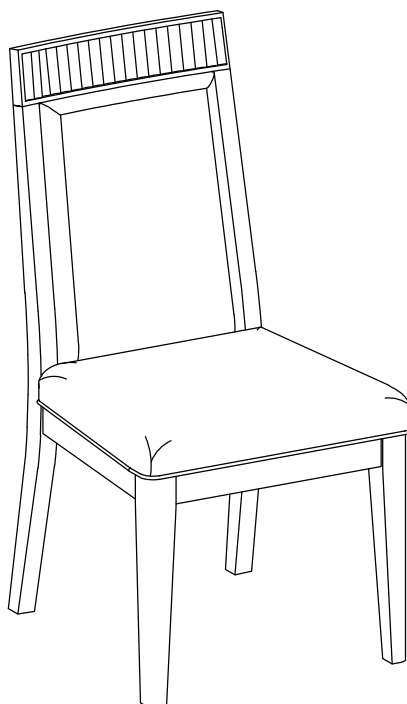

ITEM:108233

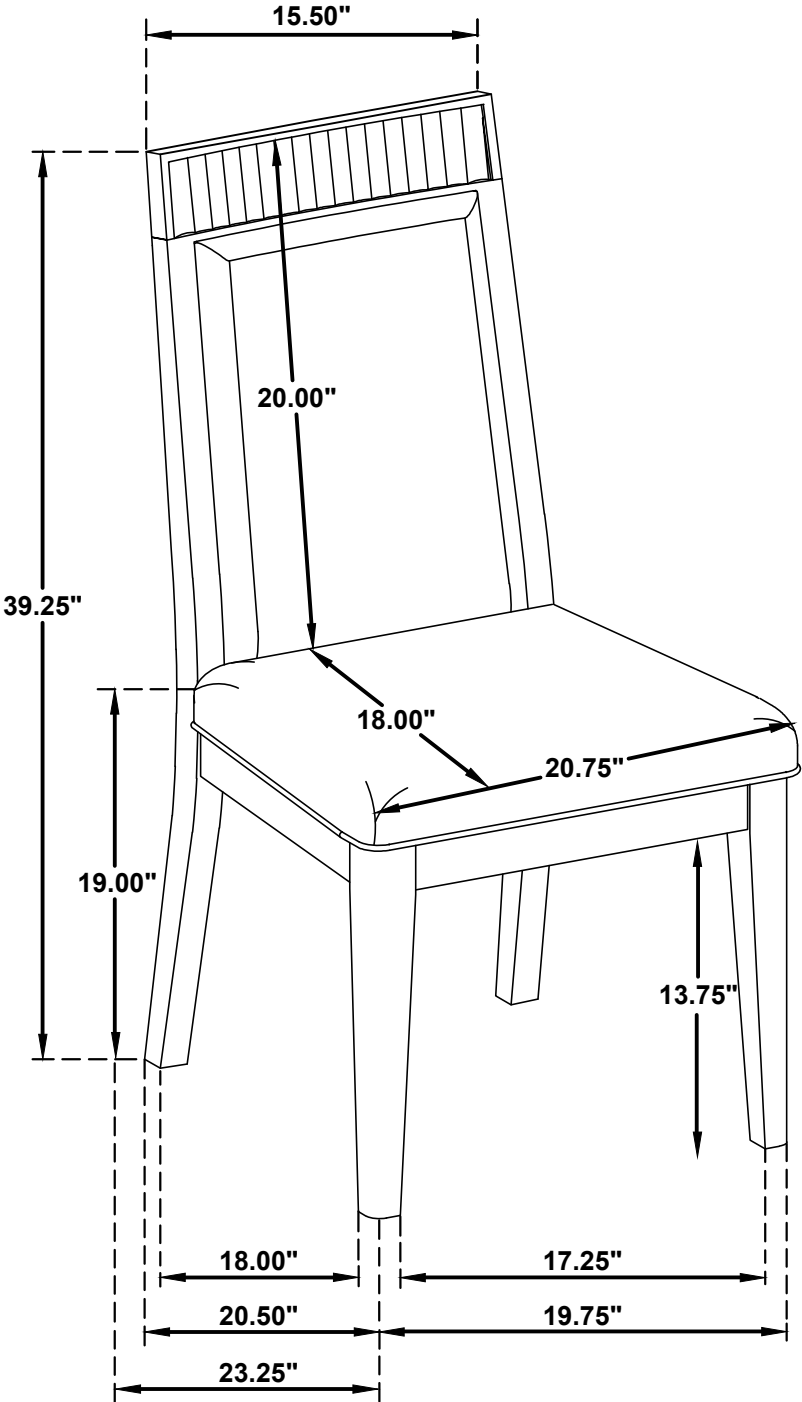

Note : Dimension tolerance $\pm 5\%$