



ASSEMBLY INSTRUCTIONS COASTER FINE FURNITURE



Fine Furniture for every stage of life

121231(B1&B2) Dining Table

REVISION 0 : 05/30/2018
REVISION 1 : 09/04/2018
REVISION 2 : 07/01/2020
REVISION 3 : 10/16/2025

PAGE 1 OF 5

COASTERFURNITURE.COM

ITEM:121231(B1&B2)



ASSEMBLY INSTRUCTIONS

ASSEMBLY TIPS:

1. Remove hardware from box and sort by size.
2. Please check to see that all hardware and parts are present prior to start of assembly.
3. Please follow attached instructions in the same sequence as numbered to assure fast & easy assembly.



WARNING!

1. Don't attempt to repair or modify parts that are broken or defective. Please contact the store immediately.
2. This product is for home use only and not intended for commercial establishments.



ASSEMBLY TIME

10 MINUTES

PARTS IDENTIFICATION

B1 (BOX 1)

AN TOP

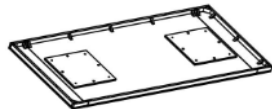

1PC

BN LEAF



2PCS

CN MOUNTING PLATE



2PCS

DN BASE

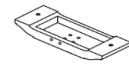

2PCS

EN CROSSBAR



1PC

B2 (BOX 2)

FN PEDESTAL COLUMN



2PCS

HARDWARE IDENTIFICATION

Z-B1(BOX 1) - HARDWARE PACK IS LOCATED IN 121231(B1)

1	LONG BOLT (5/16" x 45mm - BLK)		12PCS	5	FLAT WASHER (5/16" x 22D x 2mm - BLK)		28PCS
2	SHORT BOLT (5/16" x 38mm - BLK)		8PCS	6	ALLEN WRENCH (4mm - BLK)		1PC
3	HEX NUT (5/16" x 12mm - BLK)		8PCS	7	WRENCH (12mm - BLK)		1PC
4	LOCK WASHER (5/16" x 12D x 1.1mm - BLK)		28PCS				

ITEM: 121231(B1&B2)

ASSEMBLY INSTRUCTIONS



STEP 1

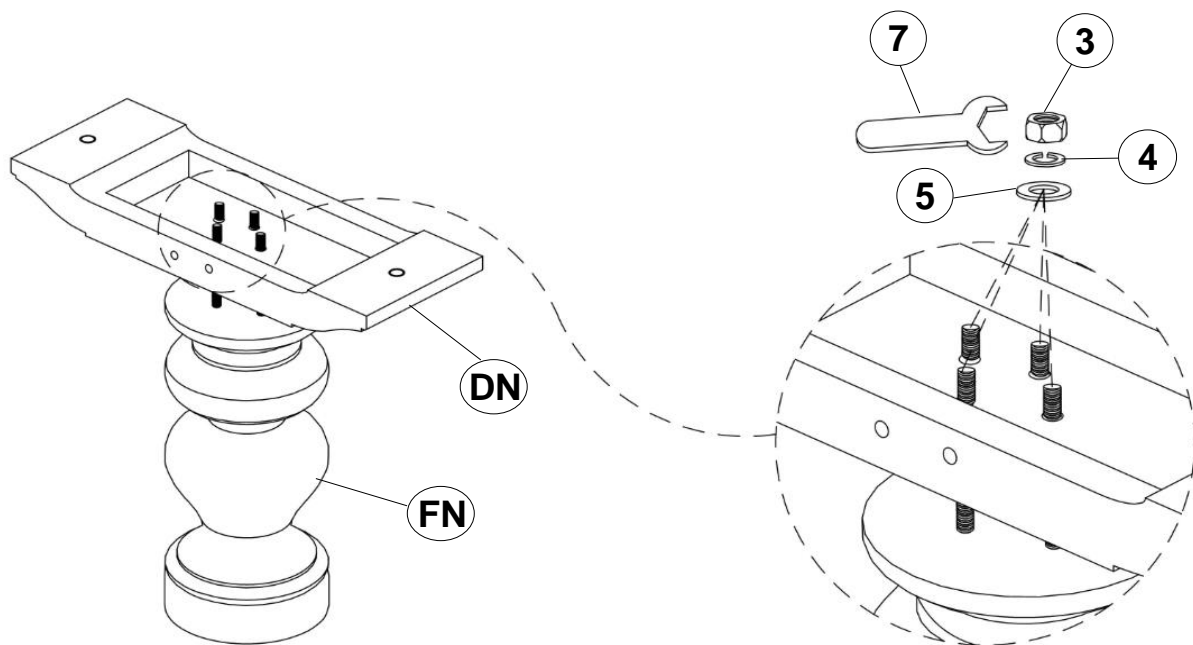

STEP 2

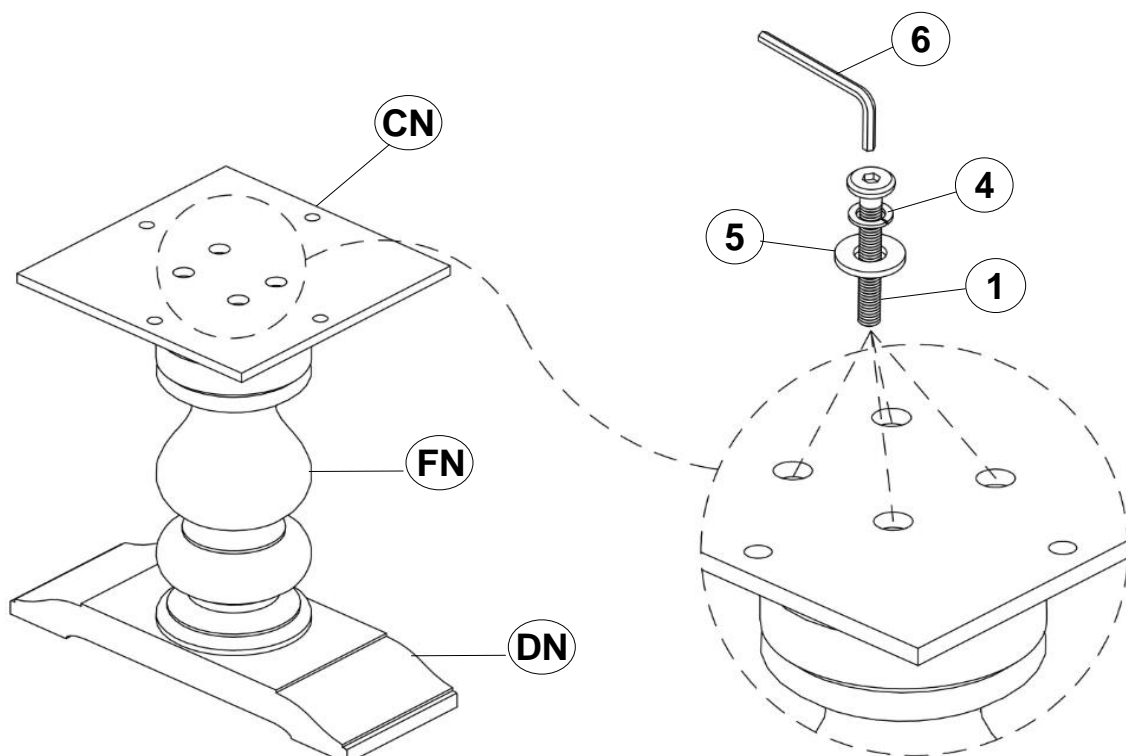

ITEM:121231(B1&B2)



ASSEMBLY INSTRUCTIONS

STEP 3

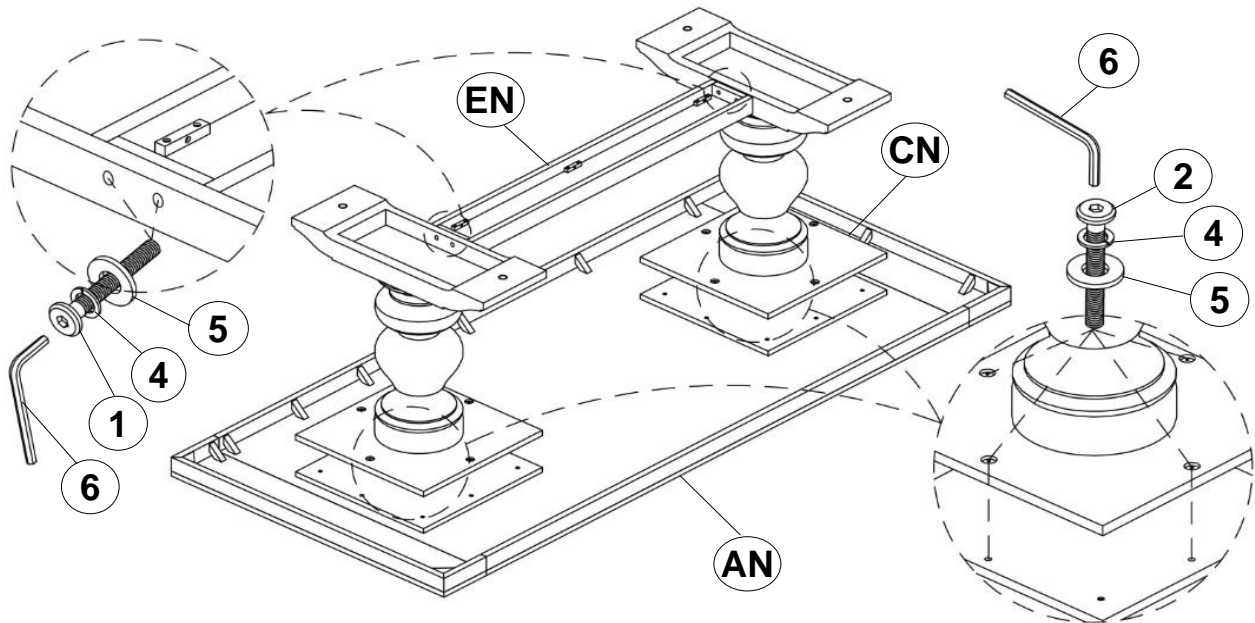

STEP 4

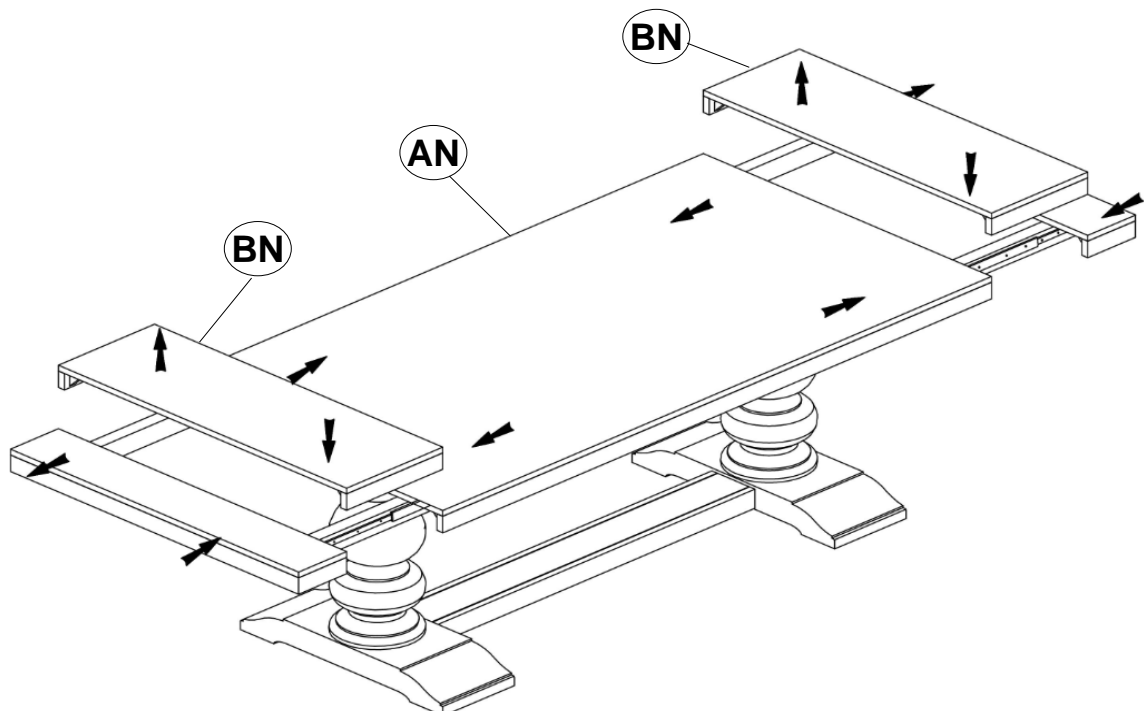

ITEM: **121231(B1&B2)**



ASSEMBLY INSTRUCTIONS

STEP 5

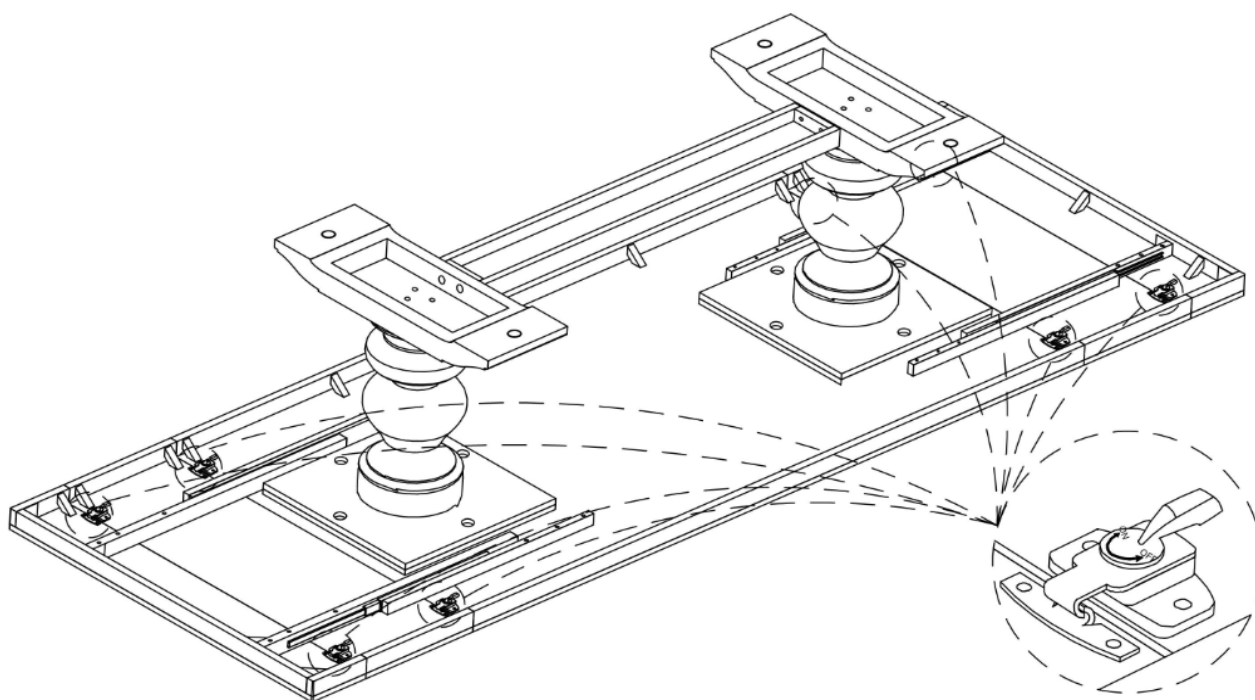

STEP 6 **COMPLETE**

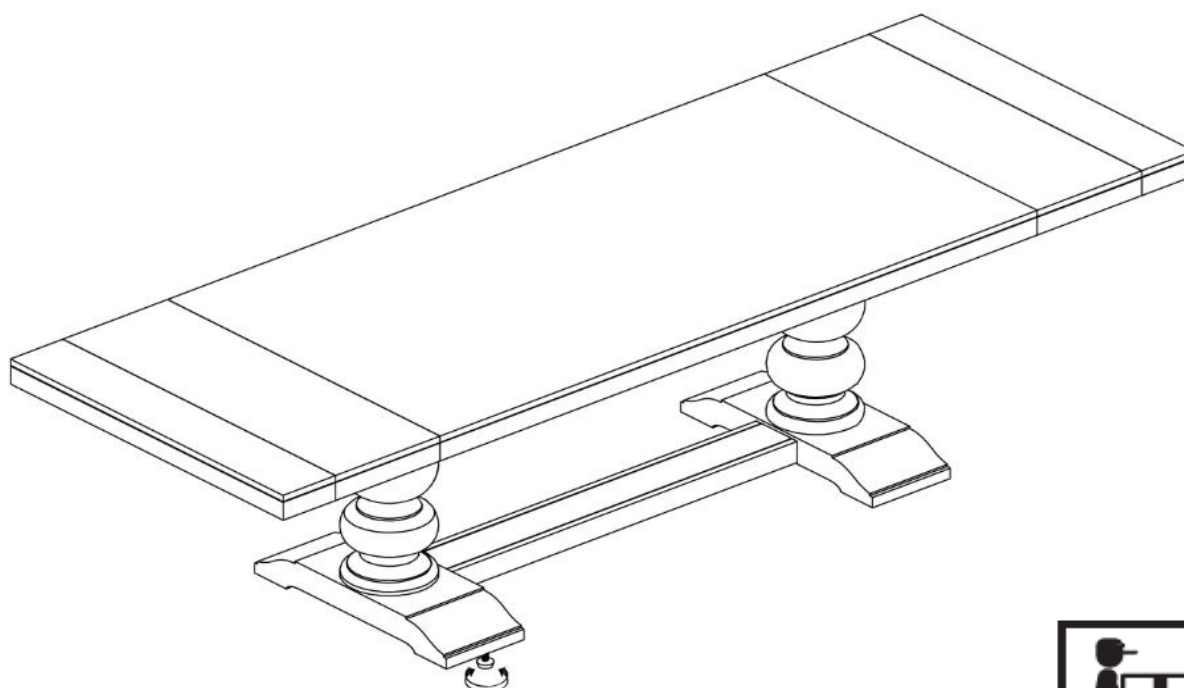

ADJUSTABLE LEVELER



ITEM: **121231(B1&B2)**

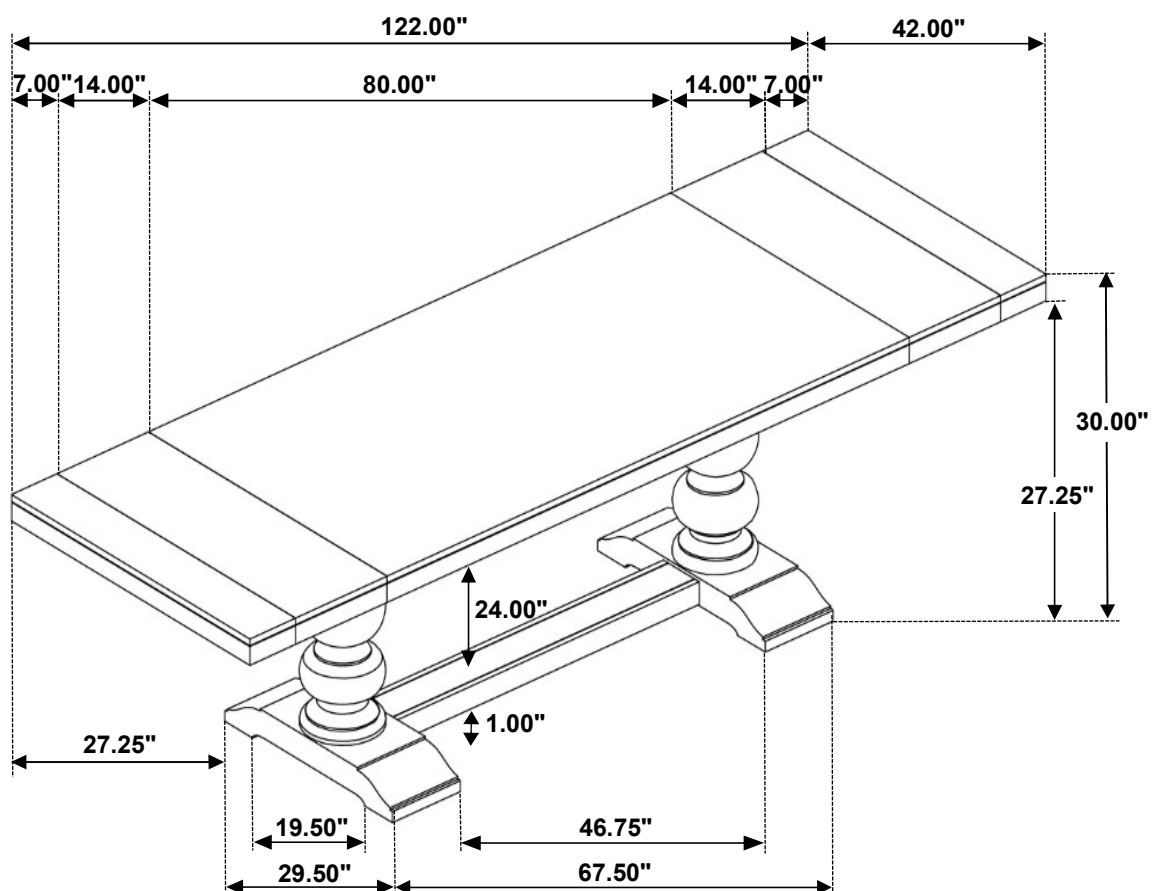

Note: Dimension tolerance $\pm 5\%$

ASSEMBLY INSTRUCTIONS
COASTER FINE FURNITURE



Fine Furniture for every stage of life

121714
Dining Chair

ITEM: **121714**



ASSEMBLY INSTRUCTIONS

ASSEMBLY TIPS:

1. Remove hardware from box and sort by size.
2. Please check to see that all hardware and parts are present prior to start of assembly.
3. Please follow attached instruction in the same sequence as numbered to assure fast and easy assembly.



WARNING !

1. Don't attempt to repair or modify parts that are broken or defective. Please contact the store immediately.
2. This product is for home use only and not intended for commercial establishment.



ASSEMBLY TIME

15 MINUTES

PARTS IDENTIFICATION

AD

SEAT AND BACK

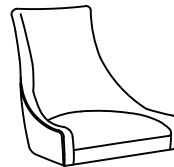

1PC

BD

FRONT LEG

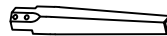

2PCS

CD

BACK LEG



2PCS

HARDWARE IDENTIFICATION

1

LONG BOLT
(M8 x 60mm - BLK)



8PCS

2

LOCK WASHER
(M8 - BLK)



8PCS

3

FLAT WASHER
(M8 - BLK)



8PCS

4

ALLEN WRENCH
(M5 - BLK)



1PC

ITEM: **121714**
ASSEMBLY INSTRUCTIONS

STEP 1

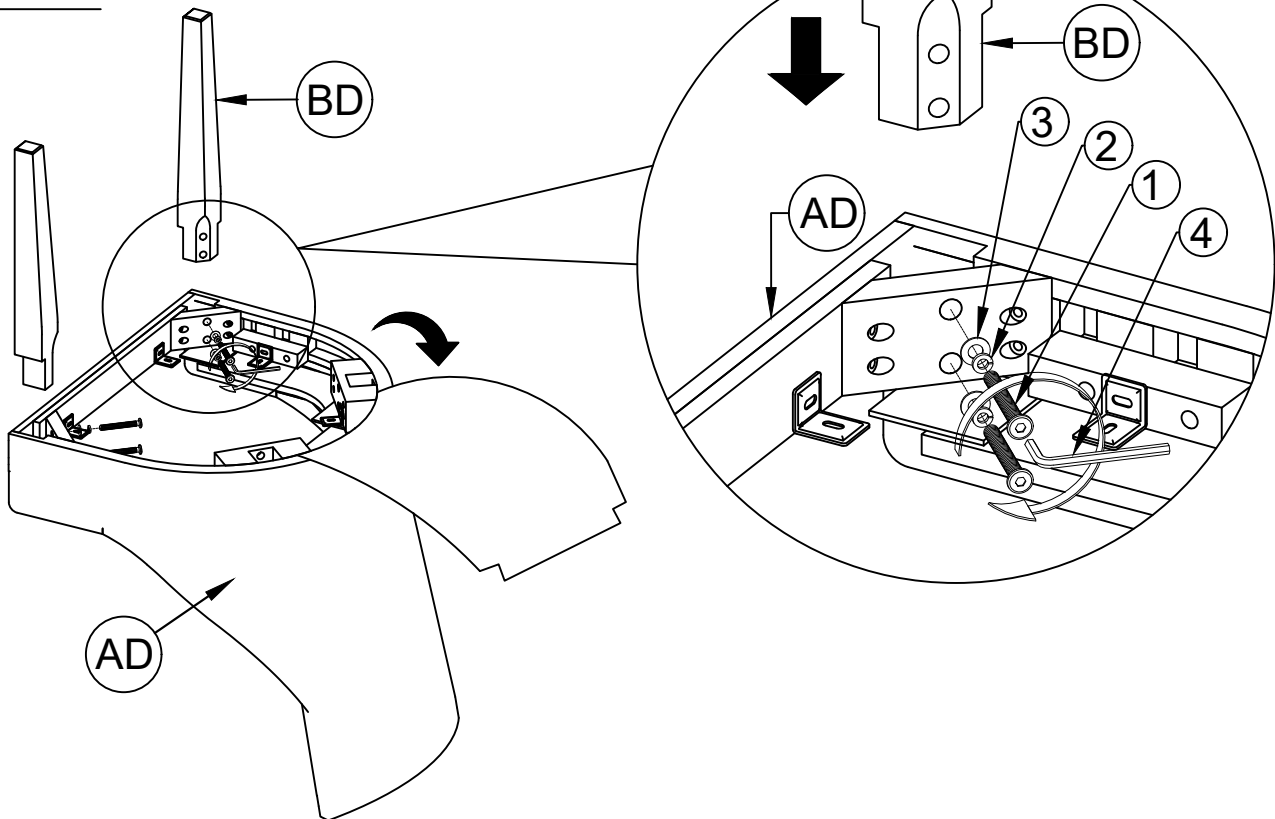

STEP 2

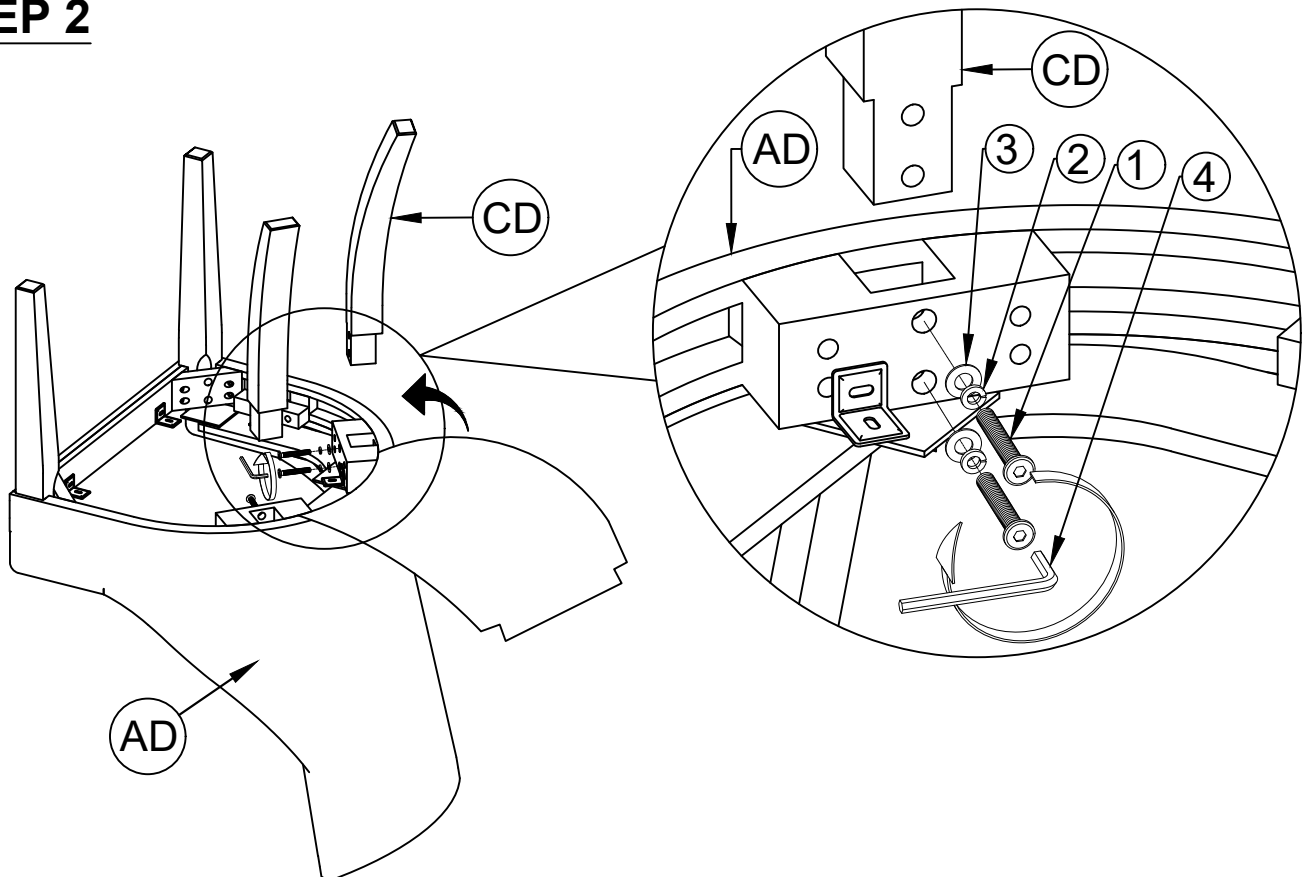

ITEM: **121714**

ASSEMBLY INSTRUCTIONS

STEP 3

COMPLETE

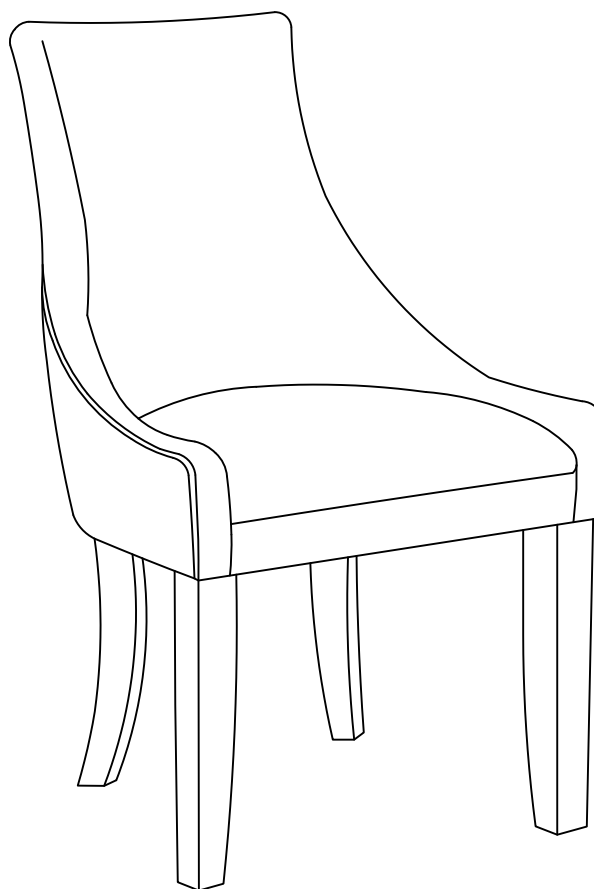

ITEM: **121714**

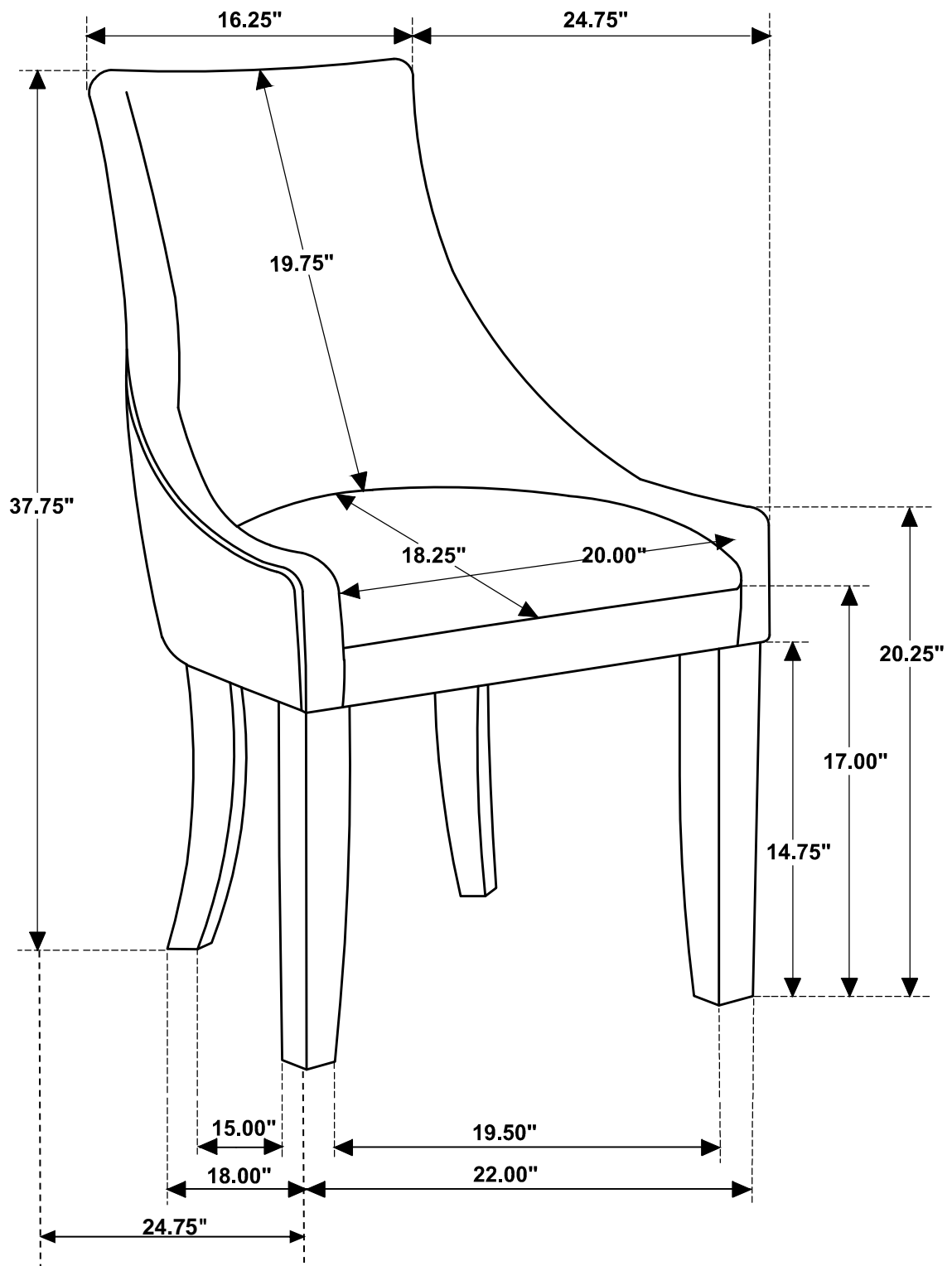

Note : Dimension tolerance $\pm 5\%$