



ASSEMBLY INSTRUCTIONS
COASTER FINE FURNITURE



Fine Furniture for every stage of life

150340
5Pc Dining Set

ITEM: 150340



ASSEMBLY INSTRUCTIONS

ASSEMBLY TIPS:

1. Remove hardware from box and sort by size.
2. Please check to see that all hardware and parts are present prior to start of assembly.
3. Please follow attached instructions in the same sequence as numbered to assure fast & easy assembly.



WARNING!

1. Don't attempt to repair or modify parts that are broken or defective. Please contact the store immediately.
2. This product is for home use only and not intended for commercial establishments.



ASSEMBLY TIME

35 MINUTES

PARTS IDENTIFICATION

A TABLE TOP



1PC

D SEAT CUSHION
WITH FRAME



4PCS

B TABLE LEG



4PCS

E FRONT LEG



8PCS

C BACK FRAME



4PCS

HARDWARE IDENTIFICATION

1 LONG BOLT
(Ø5/16" x 75mm - RBW)



24PCS

4 LOCK WASHER
(Ø5/16" x 13mm - RBW)



52PCS

2 MEDIUM BOLT
(Ø5/16" x 63mm - RBW)



16PCS

5 FLAT WASHER
(Ø5/16" x 19mm - RBW)



52PCS

3 SHORT BOLT
(Ø5/16" x 35mm - RBW)



12PCS

6 ALLEN WRENCH
(M4 x 59mm - RBW)

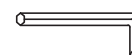

1PC

NOTE:

Phillips head screw driver is required in the assembly process. However, manufacturer does not provide this item.

ITEM: **150340**

ASSEMBLY INSTRUCTIONS



STEP 1

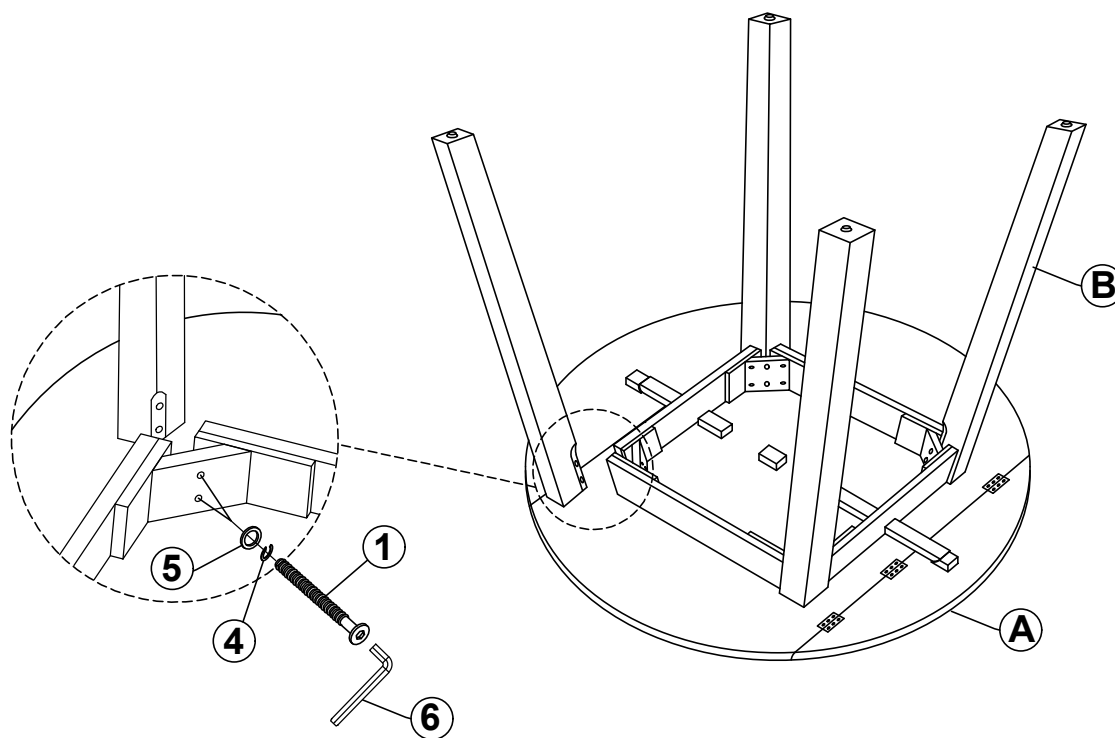

STEP 2

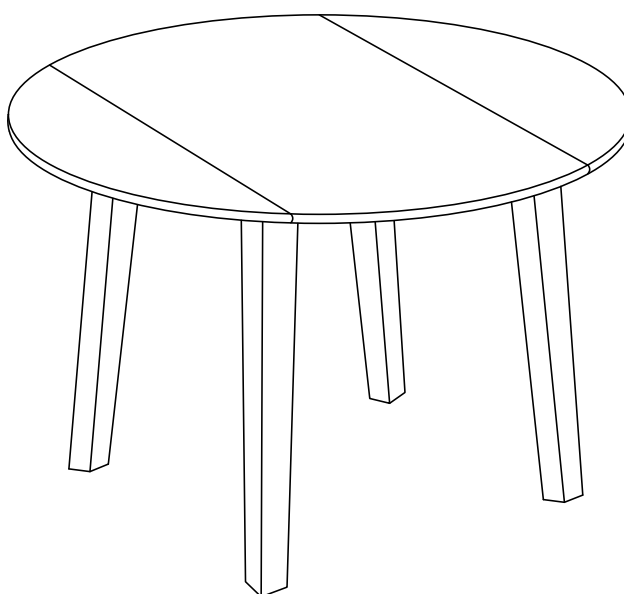

ITEM: **150340**

ASSEMBLY INSTRUCTIONS



STEP 3

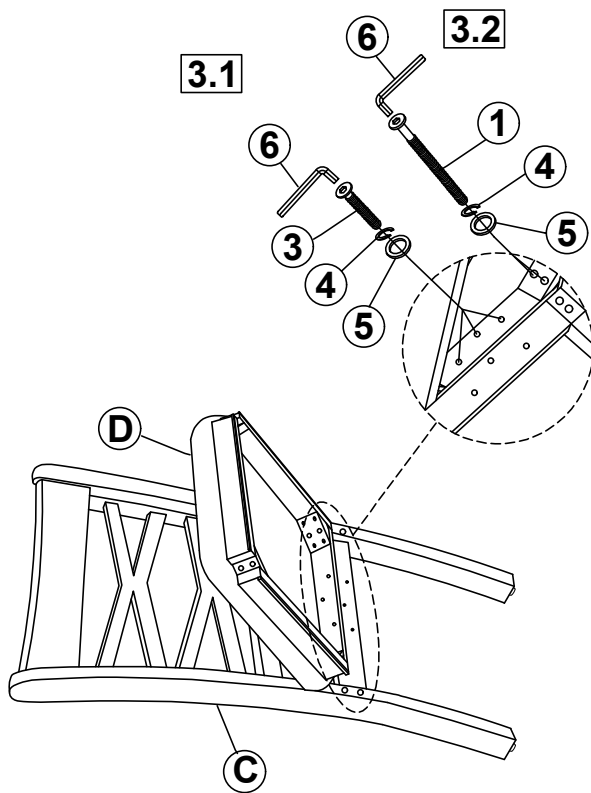

STEP 4

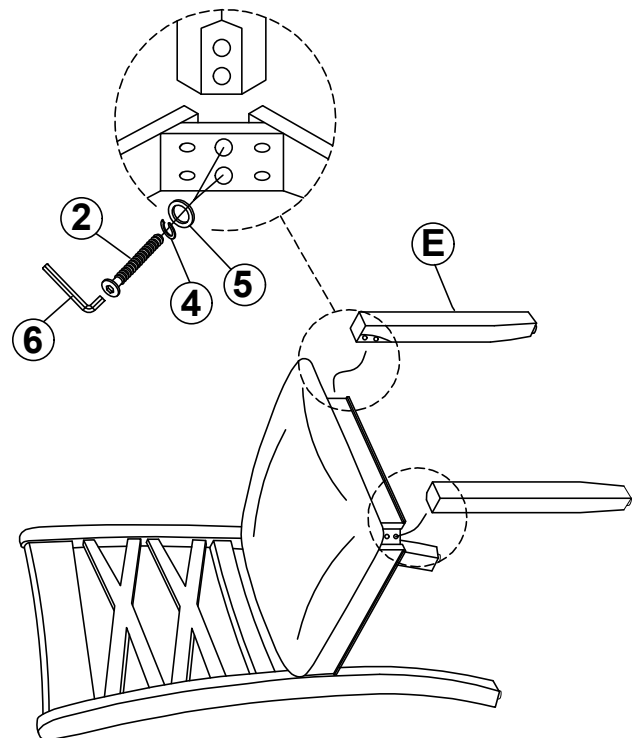

STEP 5 COMPLETE

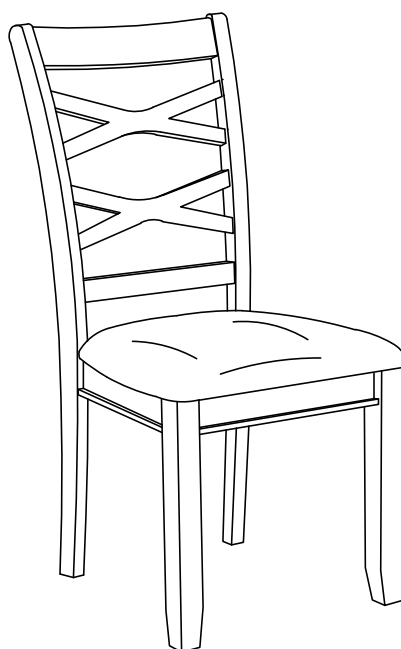

ITEM: **150340**

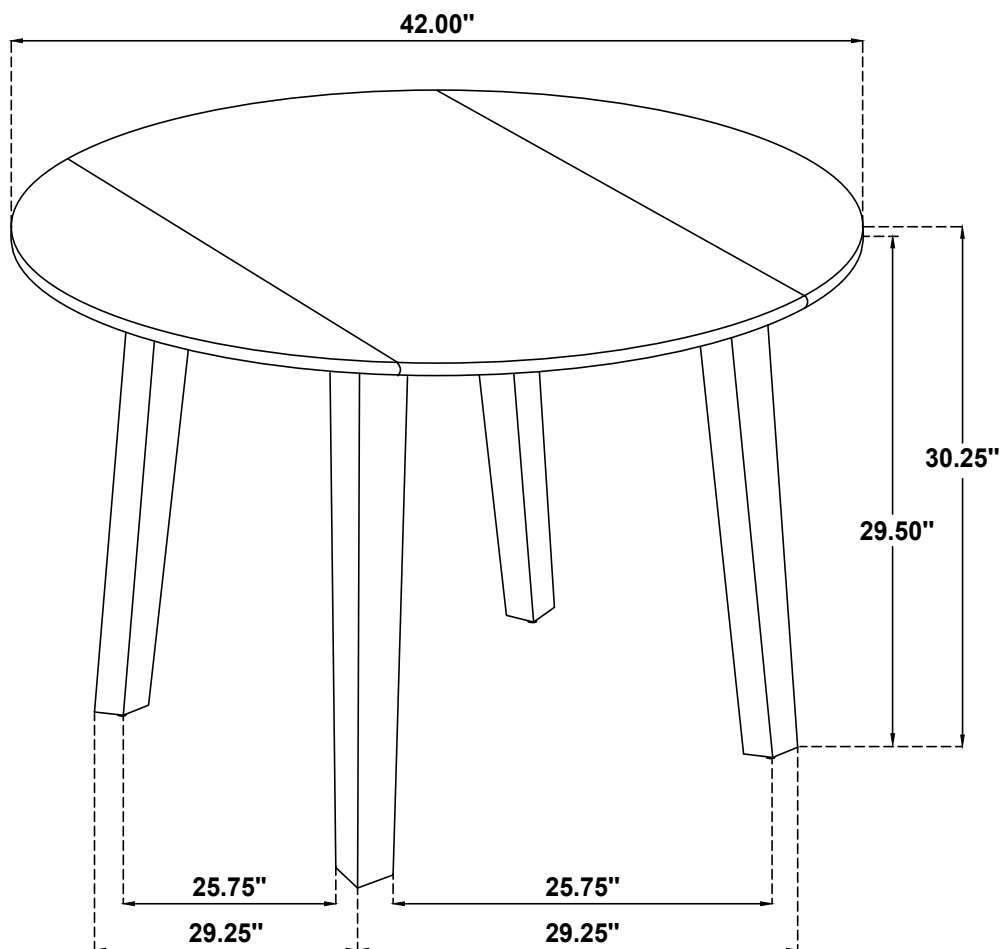

Note: Dimension tolerance $\pm 5\%$

ITEM: **150340**

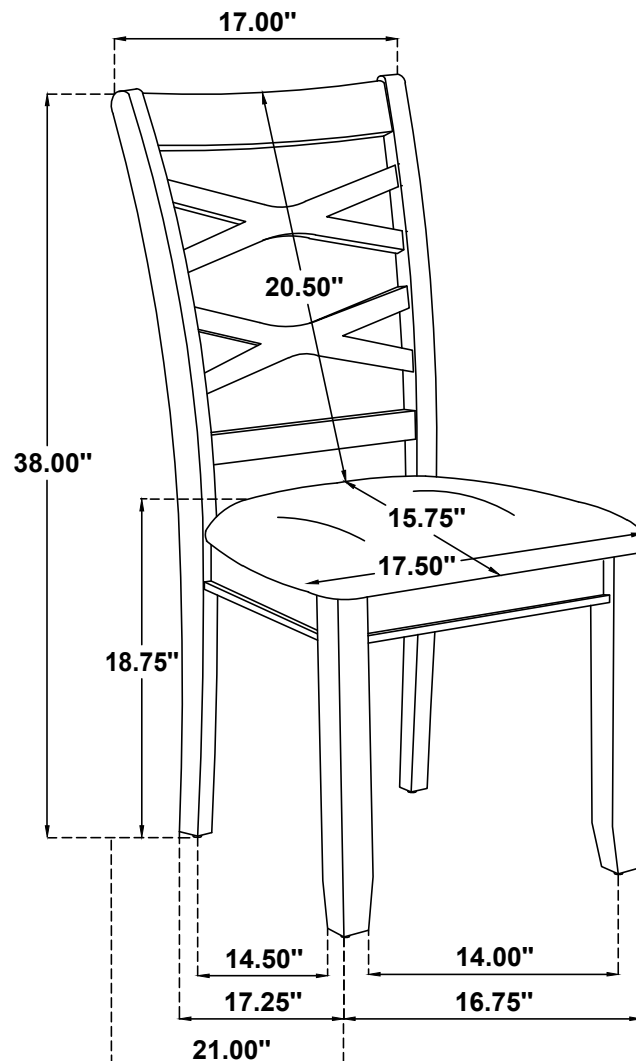

Note: Dimension tolerance $\pm 5\%$