



ASSEMBLY INSTRUCTIONS

COASTER FINE FURNITURE



Fine Furniture for every stage of life

224337
Vanity Table

ITEM: **224337**



ASSEMBLY INSTRUCTIONS

ASSEMBLY TIPS:

1. Remove hardware from box and sort by size.
2. Please check to see that all hardware and parts are present prior to start of assembly.
3. Please follow attached instructions in the same sequence as numbered to assure fast & easy assembly.



WARNING!

1. Don't attempt to repair or modify parts that are broken or defective. Please contact the store immediately.
2. This product is for home use only and not intended for commercial establishments.



ASSEMBLY TIME

15 MINUTES

PART IDENTIFICATION

A TABLE

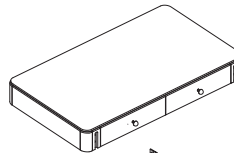

1PC

B FRONT LEG



2PCS

C LEFT BACK LEG



1PC

D RIGHT BACK LEG



1PC

E SHORT METAL STRETCHER



2PCS

F LONG METAL STRETCHER



1PC

HARDWARE IDENTIFICATION

1 BOLT
(M6 x 35mm - BLK)



8PCS

2 LOCK WASHER
(1.6 x 14mm - BLK)



8PCS

3 FLAT WASHER
(1 x 18mm - BLK)



8PCS

4 ALLEN WRENCH
(M4 x 65mm - BLK)



1PC

5 FLAT HEAD SCREW
(8 x 2" - BLK)



6PCS

ITEM: **224337**

ASSEMBLY INSTRUCTIONS



STEP 1

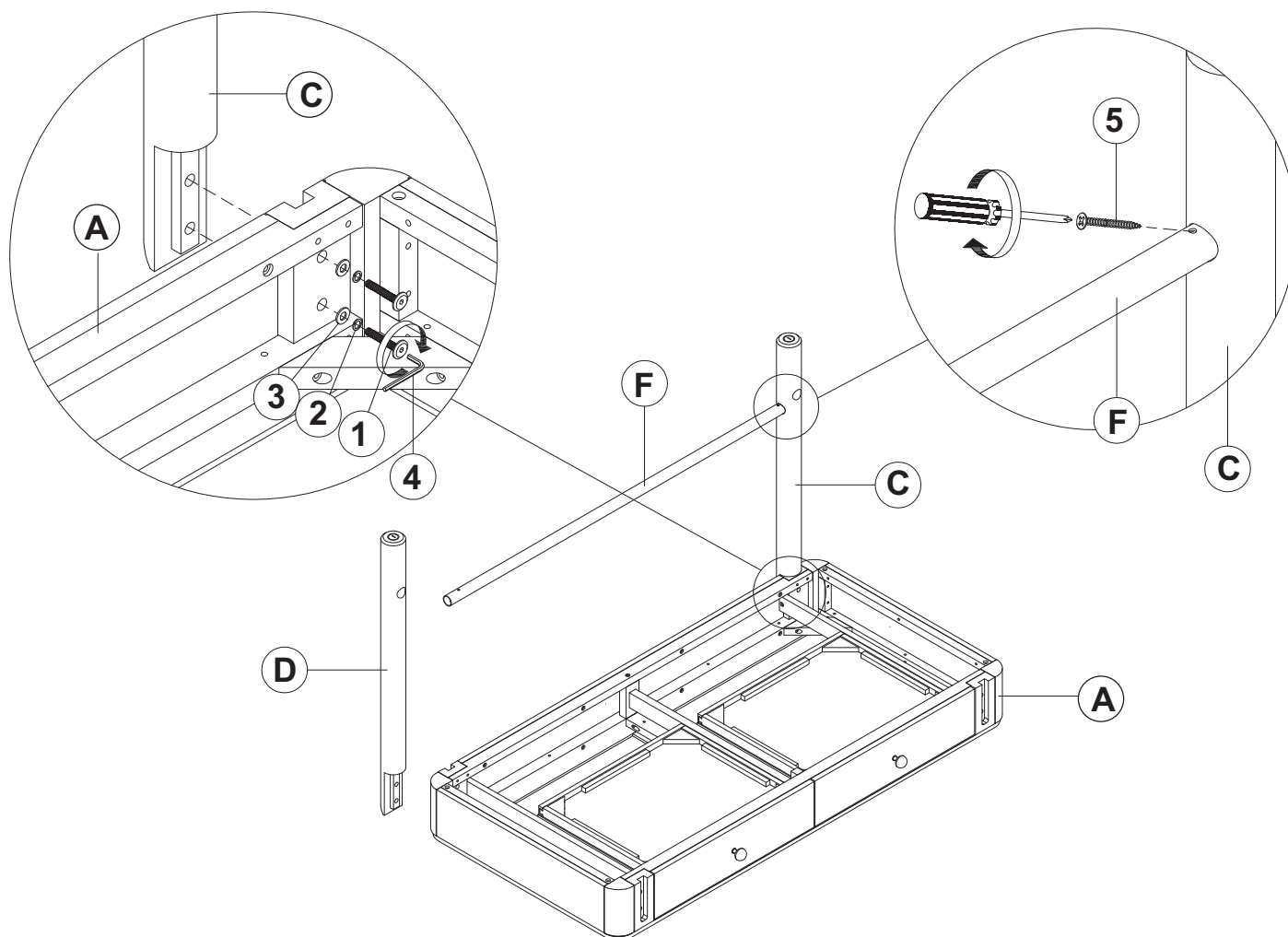

STEP 2

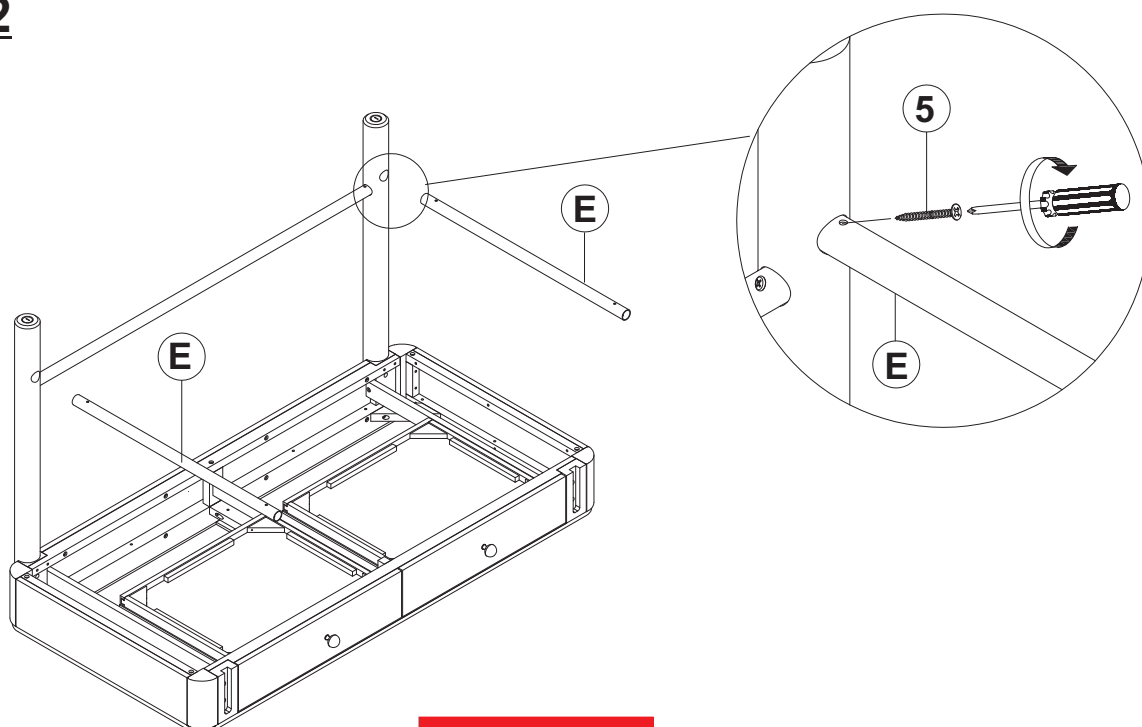

ITEM: **224337**

ASSEMBLY INSTRUCTIONS

STEP 3

COASTER
FINE FURNITURE

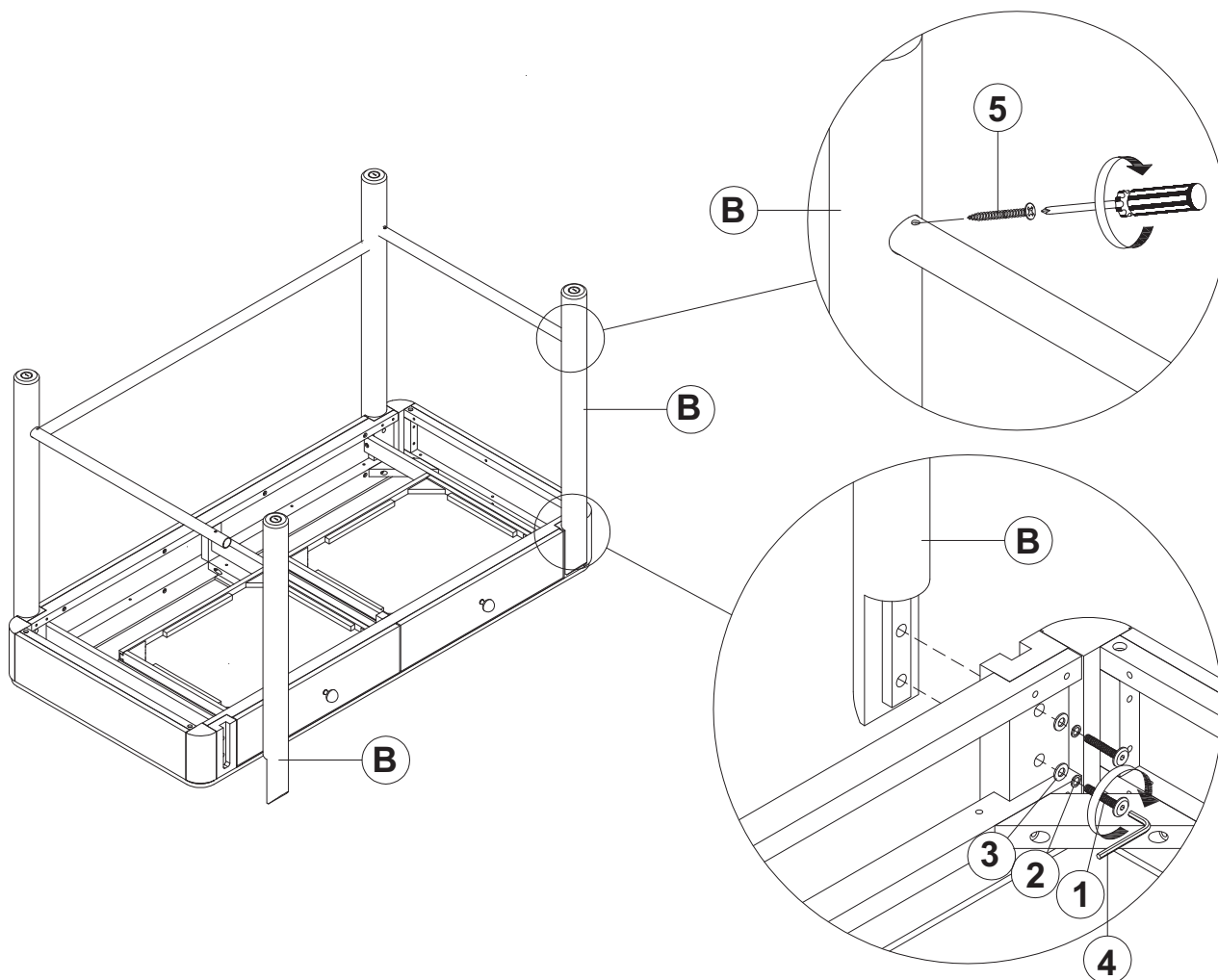

STEP 4 **COMPLETE**

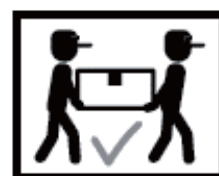
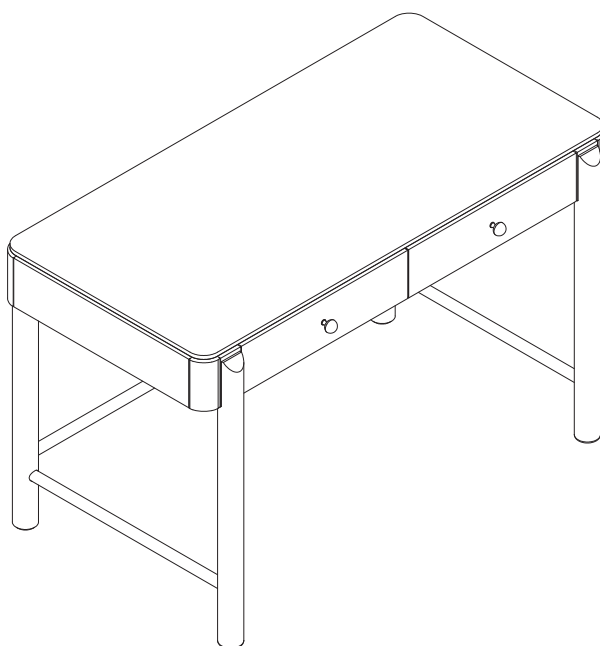

ITEM: **224337**



Inner Size of Drawer : 16.50"W x 13.75"D x 2.00"H x 0.50"T

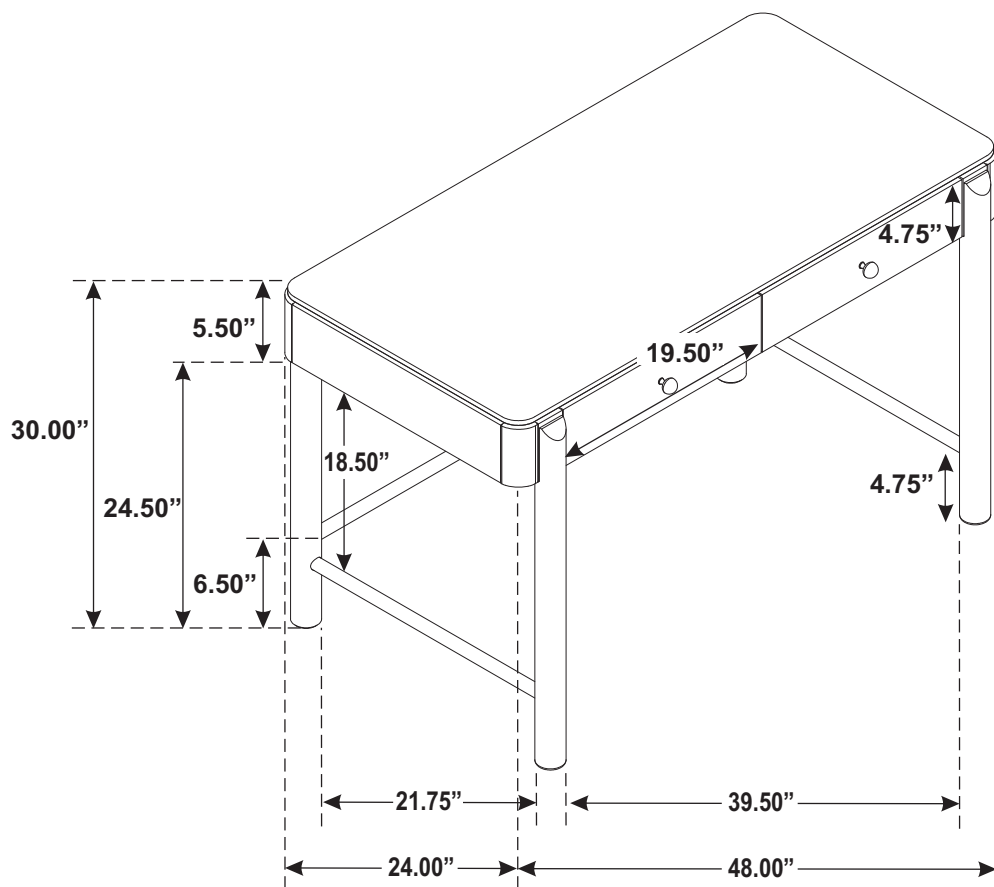

Note: Dimension tolerance $\pm 5\%$

ASSEMBLY INSTRUCTIONS
COASTER FINE FURNITURE



Fine Furniture for every stage of life

224338
Vanity Mirror

ITEM: **224338**



ASSEMBLY INSTRUCTIONS

ASSEMBLY TIPS:

1. Remove hardware from box and sort by size.
2. Please check to see that all hardware and parts are present prior to start of assembly.
3. Please follow attached instructions in the same sequence as numbered to assure fast & easy assembly.



WARNING!

1. Don't attempt to repair or modify parts that are broken or defective. Please contact the store immediately.
2. This product is for home use only and not intended for commercial establishments.



ASSEMBLY TIME

10 MINUTES

PART IDENTIFICATION

A MIRROR



1PC

B JEWELRY TRAY

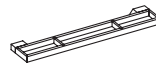

1PC

C HANGING BAR



1PC

HARDWARE IDENTIFICATION

1 METAL BRACKET
(2.5 x 65 x 65mm - BLK)



2PCS

2 BOLT
(M6 x 22mm - BLK)



4PCS

3 LOCK WASHER
(1.6 x 14mm - BLK)



4PCS

4 FLAT WASHER
(1 x 18mm - BLK)



4PCS

5 ALLEN WRENCH
(M4 x 65mm - BLK)



1PC

6 PAN HEAD SCREW
(8 x 2" - BLK)



6PCS

7 PLASTIC ANCHOR
(S8 - GREY)



6PCS

ITEM: **224338**

ASSEMBLY INSTRUCTIONS



STEP 1

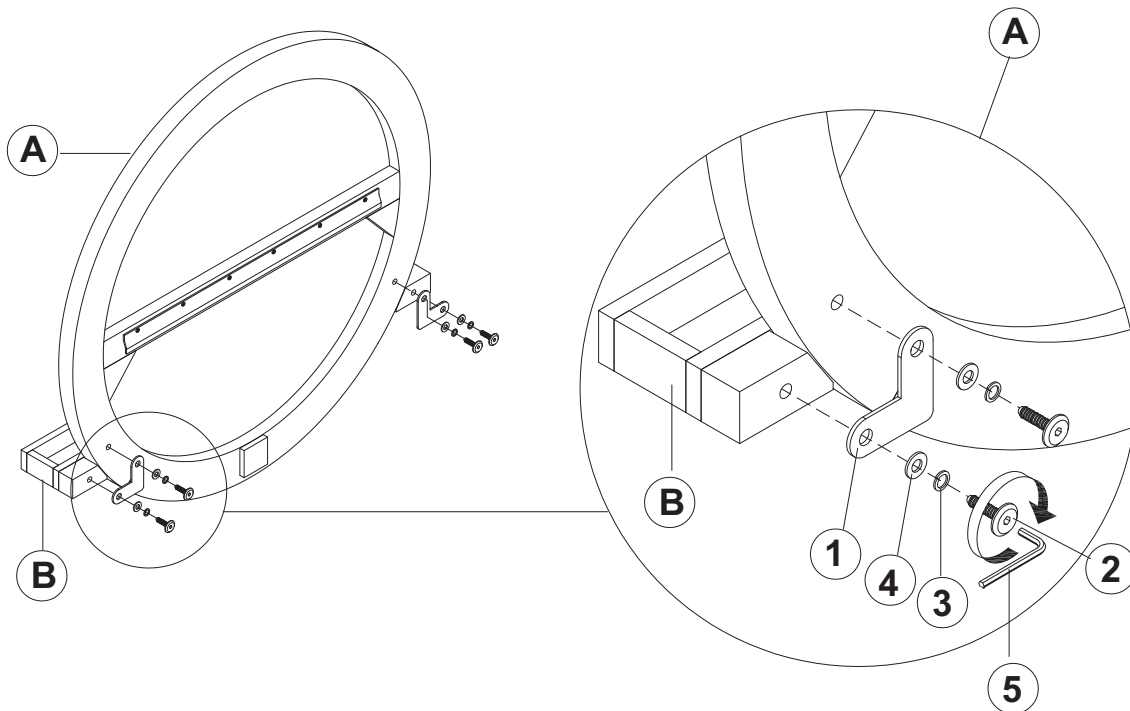

BACK VIEW

STEP 2

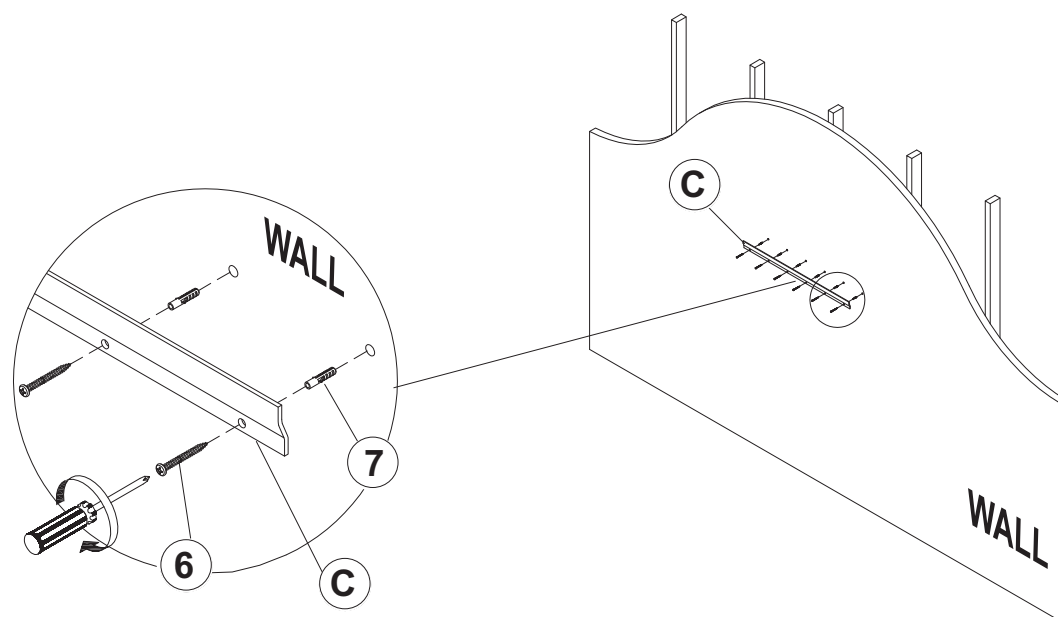

ITEM: **224338**

ASSEMBLY INSTRUCTIONS



STEP 3

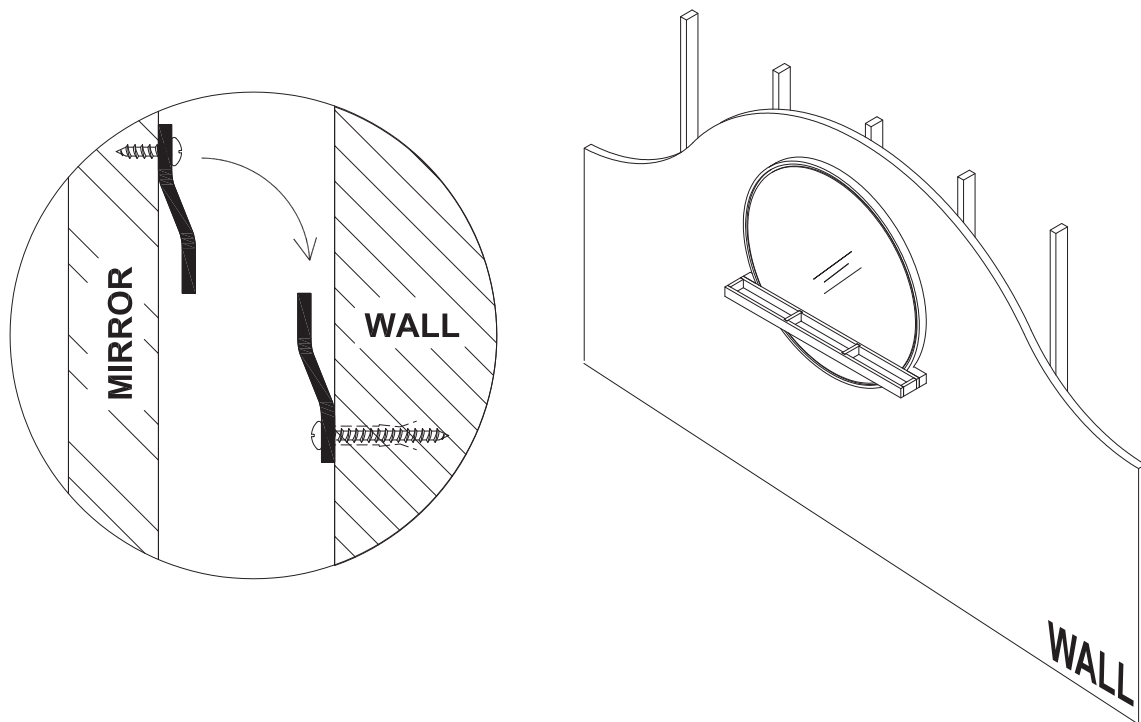

STEP 4 COMPLETE

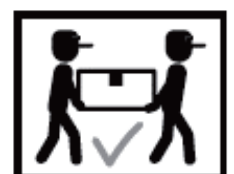
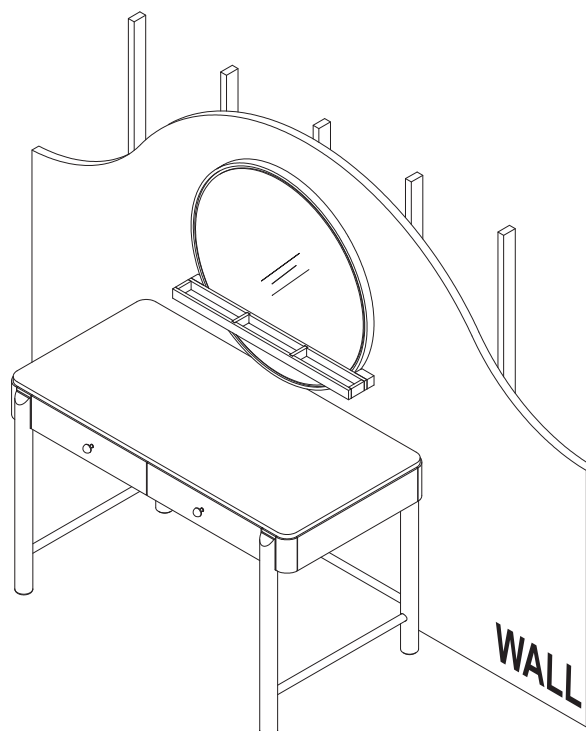

ITEM: **224338**

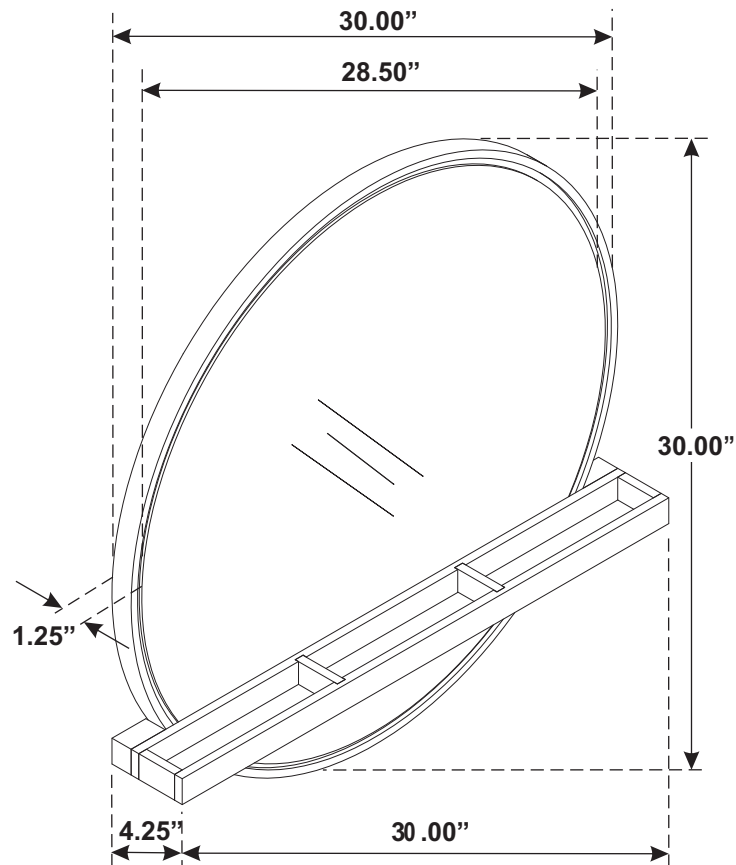

Note: Dimension tolerance $\pm 5\%$