



*ASSEMBLY INSTRUCTIONS*  
*COASTER FINE FURNITURE*



*Fine Furniture for every stage of life*

**610205P**  
**POWER LOVESEAT**

ITEM : 610205P

## ASSEMBLY INSTRUCTIONS



### ASSEMBLY TIPS:

- 1.Remove hardware from box and sort by size.
- 2.Please check to see that all hardware and parts are present prior to start of assembly.
- 3.Please follow attached instruction in the same sequence as numbered to assure fast & easy assembly.



### WARNING!

- 1.Don't attempt to repair or modify parts that are broken or defective. Please contact the store
- 2.This product is for home use only and not intended for commercial establishment.

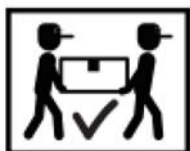

ASSEMBLY TIME

10 MINUTES

## PARTS IDENTIFICATION

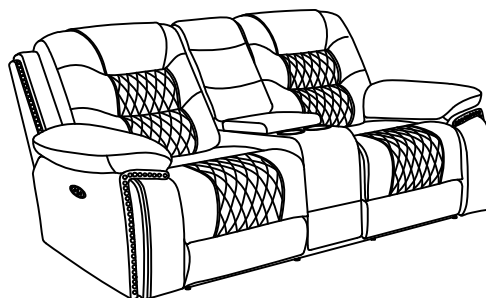
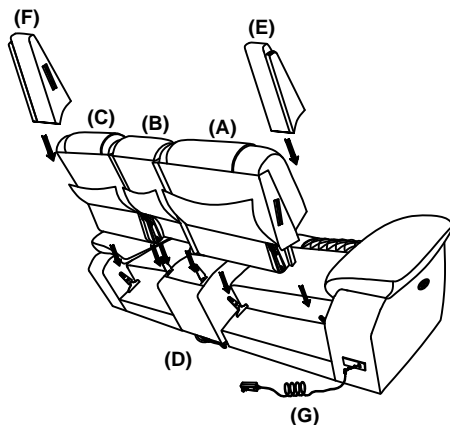

### PARTS LIST

A		LEFT BACK	1PC
B		MIDDLE BACK	1PC
C		RIGHT BACK	1PC
D		BASE	1PC
E		LEFT EAR	1PC
F		RIGHT EAR	1PC
G		PLUG-IN POWER SUPPLY	1PC

ITEM : 610205P

## ASSEMBLY INSTRUCTIONS



### STEP 1

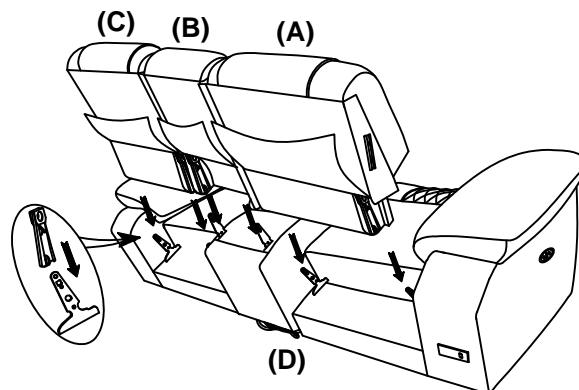

### STEP 2

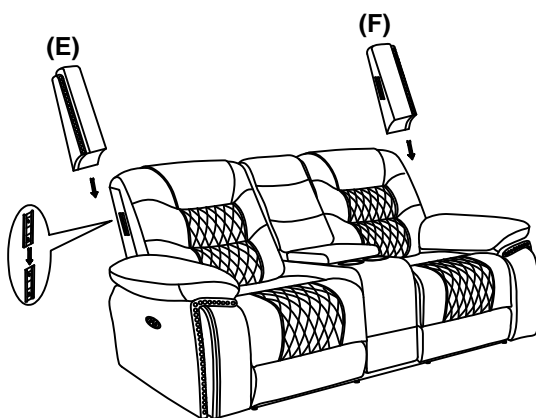

### STEP 3

Console with USB port and power supply

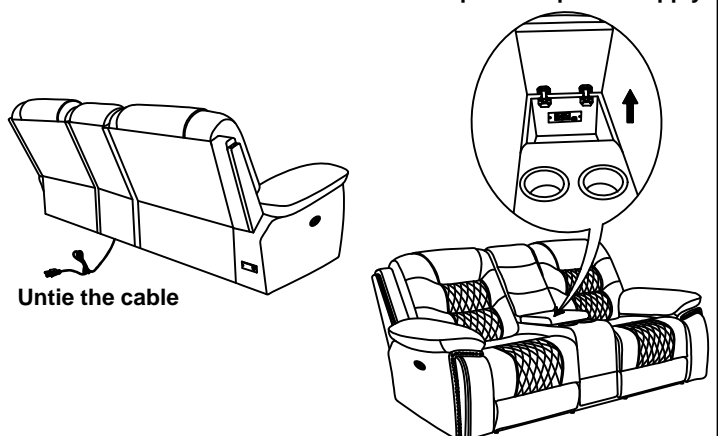

### STEP 4

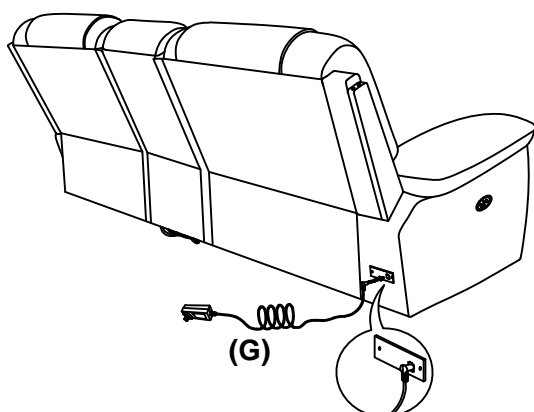

### STEP 5

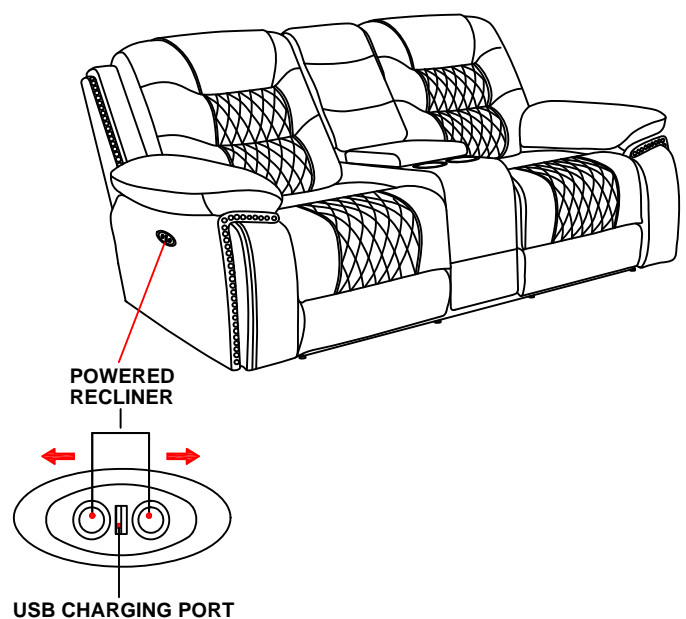

Please follow below steps to install the 9V batteries when there is no power to operate the motion sofa. (Any model of 9V battery is applicable)

#### STEP 1

Open the marked battery door on the backup battery box.

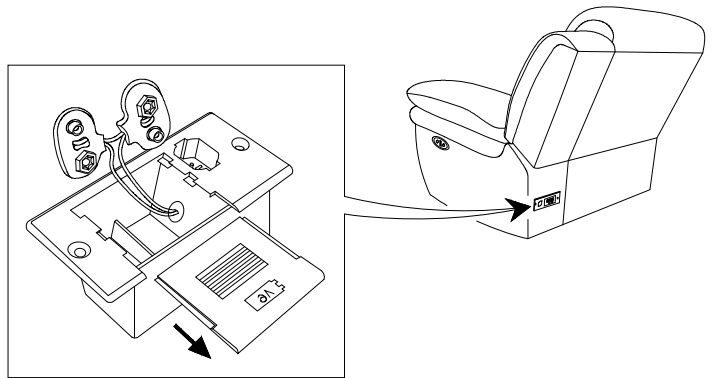

#### STEP 2

Install two 9V batteries in the backup battery box. (batteries are not included)

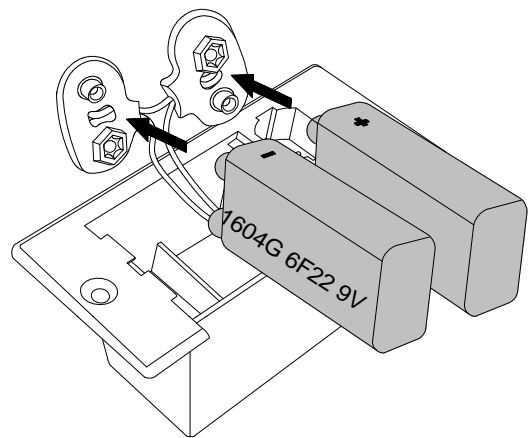

#### STEP 3

Push the batteries in.

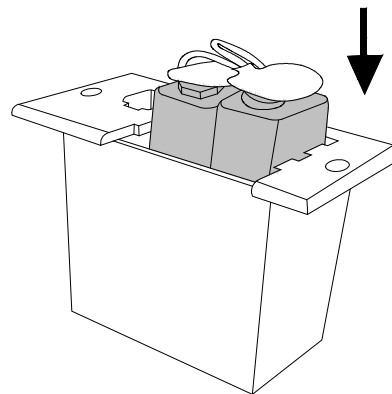

#### STEP 4

Close the box door.

Notice: Please don't keep the battery in the box when the power motion sofa is under daily use with power supply.

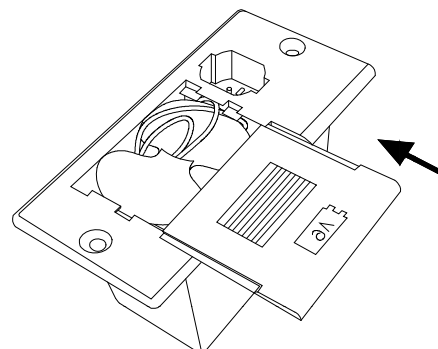

610205P

**COASTER**  
FINE FURNITURE

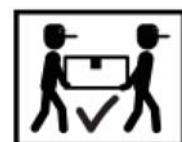
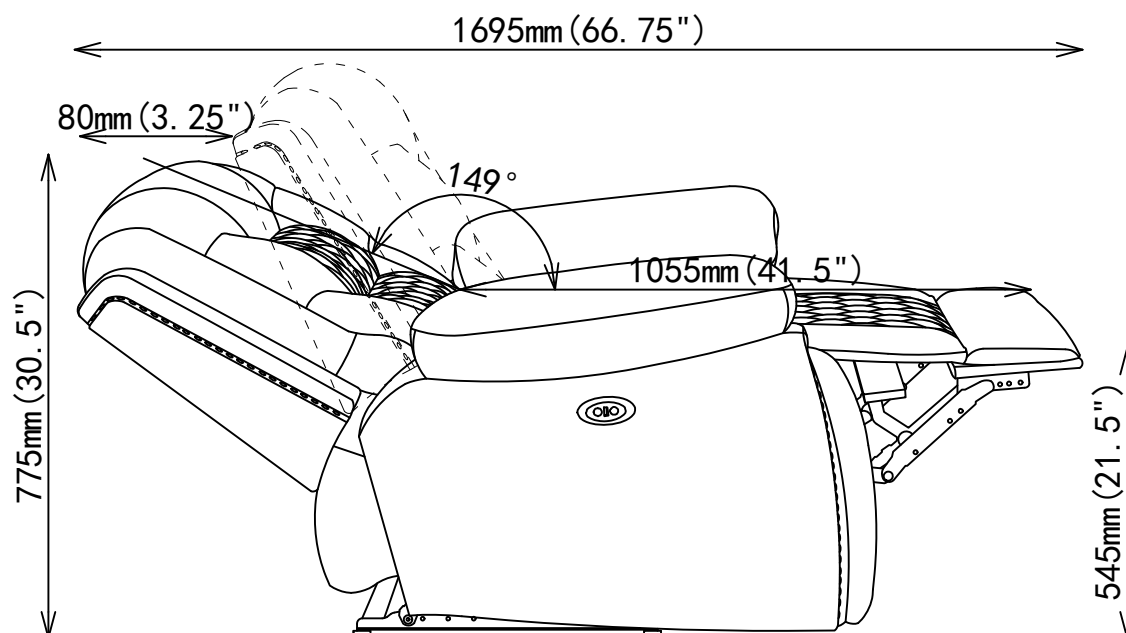
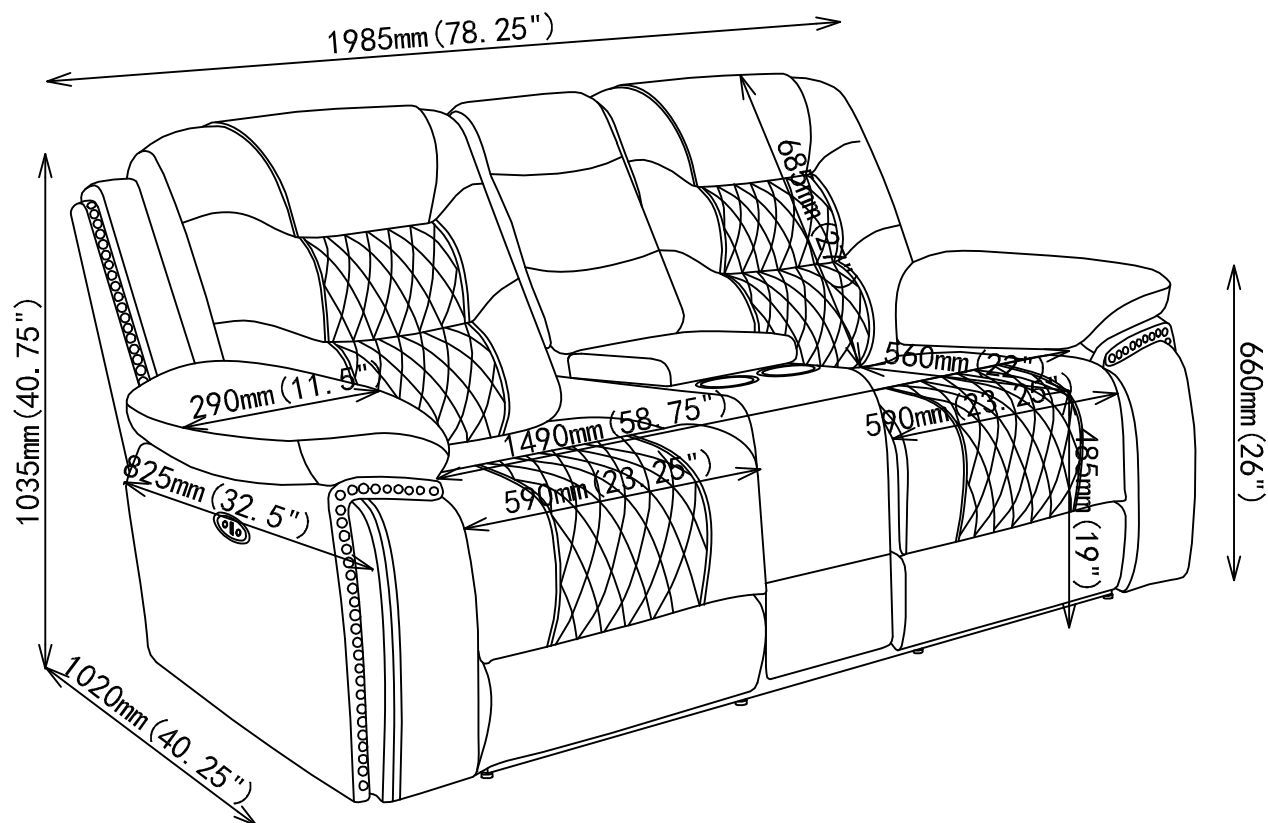

Note: Dimension tolerance  $\pm 5\%$

COASTERFURNITURE.COM