

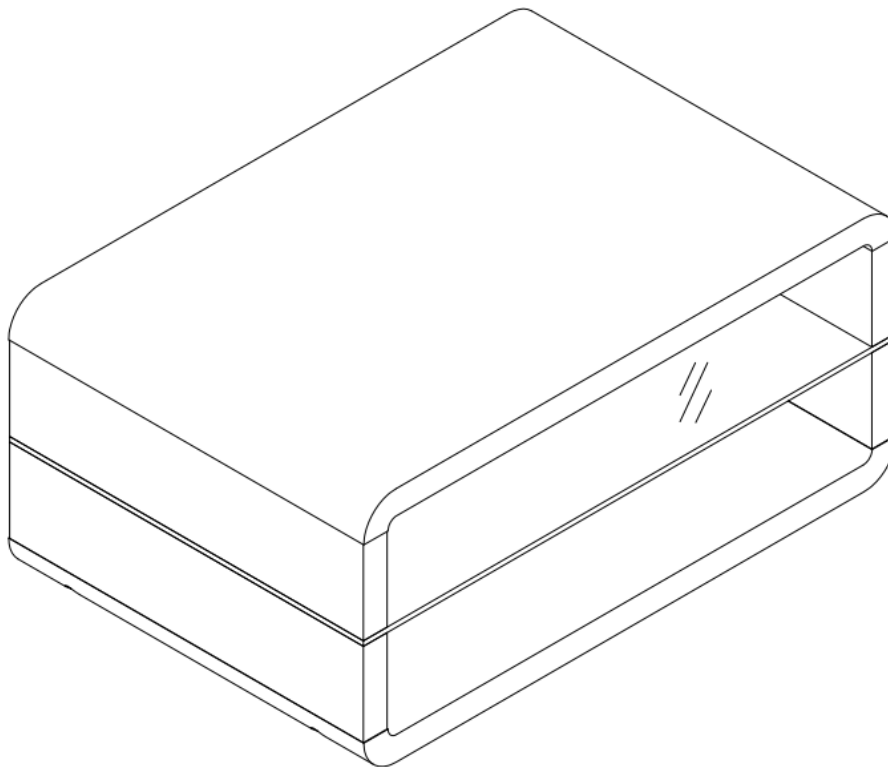

ASSEMBLY INSTRUCTIONS COASTER FINE FURNITURE



Fine Furniture for every stage of life

703268
Coffee Table

REVISION 0: 12/21/2018
REVISION 1: 07/02/2019
REVISION 2: 10/10/2020
REVISION 3: 08/04/2022

PAGE 1 OF 5

COASTERFURNITURE.COM

ITEM: 703268



ASSEMBLY INSTRUCTIONS

ASSEMBLY TIPS:

- 1. Remove hardware from box and sort by size.
- 2. Please check to see that all hardware and parts are present prior to start of assembly.
- 3. Please follow attached instructions in the same sequence as numbered to assure fast & easy assembly.



WARNING!

- 1. Don't attempt to repair or modify parts that are broken or defective. Please contact the store immediately.
- 2. This product is for home use only and not intended for commercial establishments.



ASSEMBLY TIME

15 MINUTES

PARTS IDENTIFICATION

A TOP

1PC

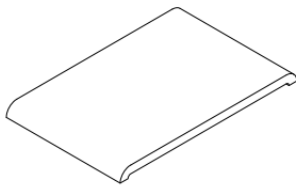

B BASE

1PC

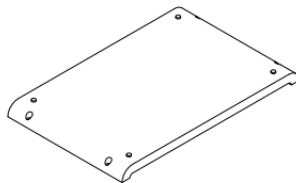

C GLASS

1PC

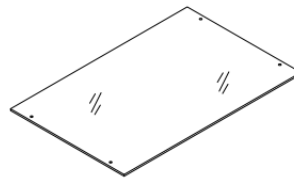

D SIDE PANEL

4PCS

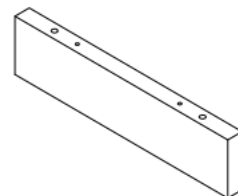

Z HARDWARE IDENTIFICATION

1 ROD

4PCS



M8*330

3 ROD NUT

4PCS



4 WASHER

4PCS



2 WOOD DOWEL

8PCS



Ø8*30

6 WOOD PLUG

1PC



M5

ITEM: 703268

ASSEMBLY INSTRUCTIONS



STEP 1

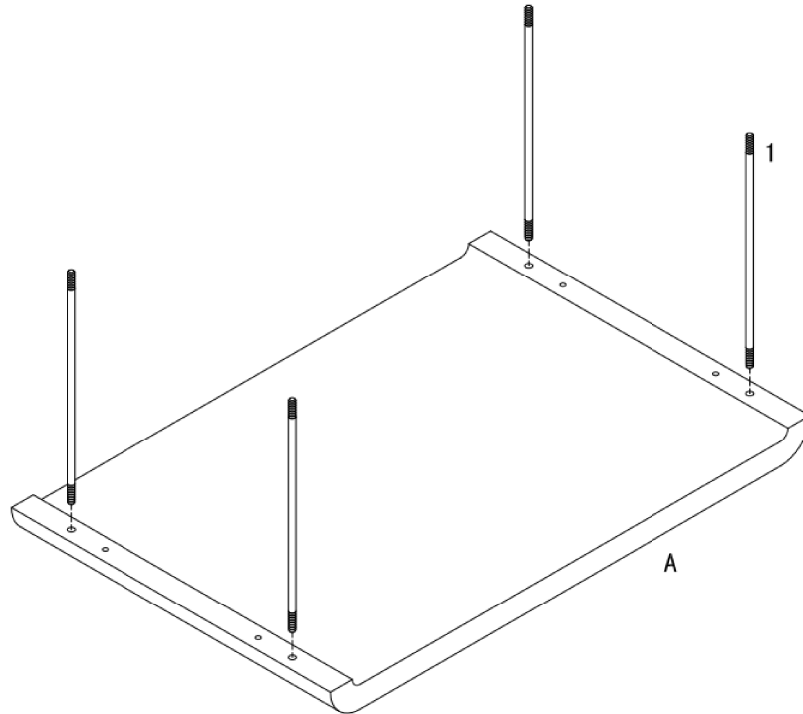

STEP 2

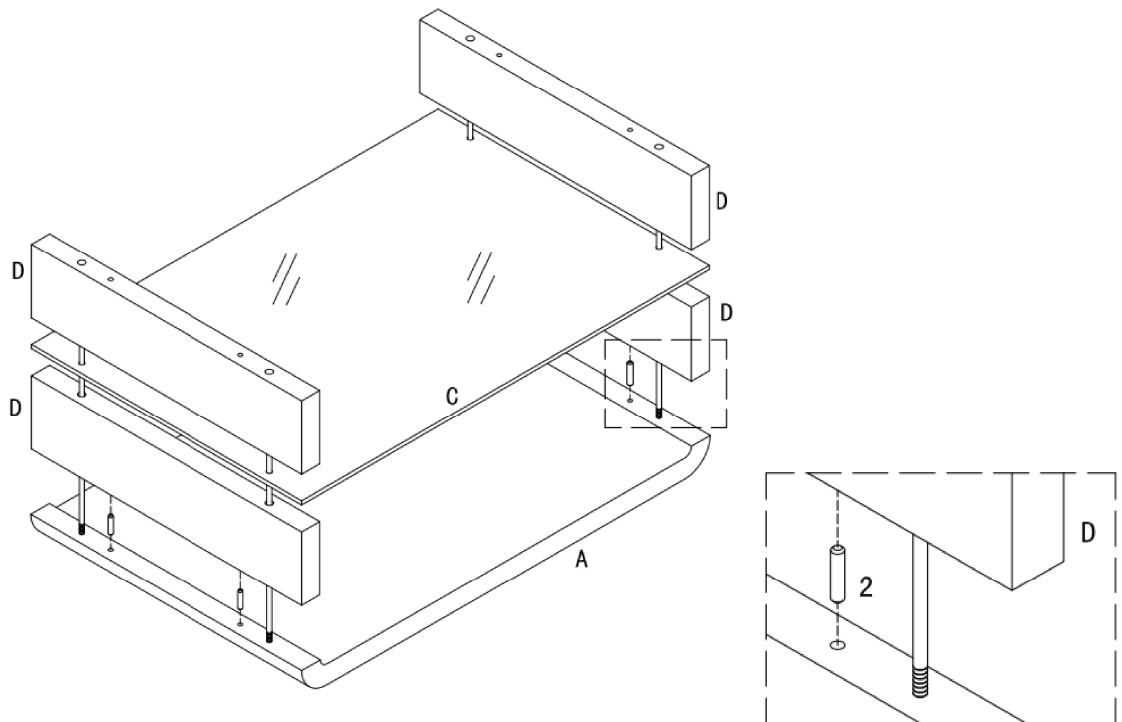

ITEM: 703268

ASSEMBLY INSTRUCTIONS



STEP 3

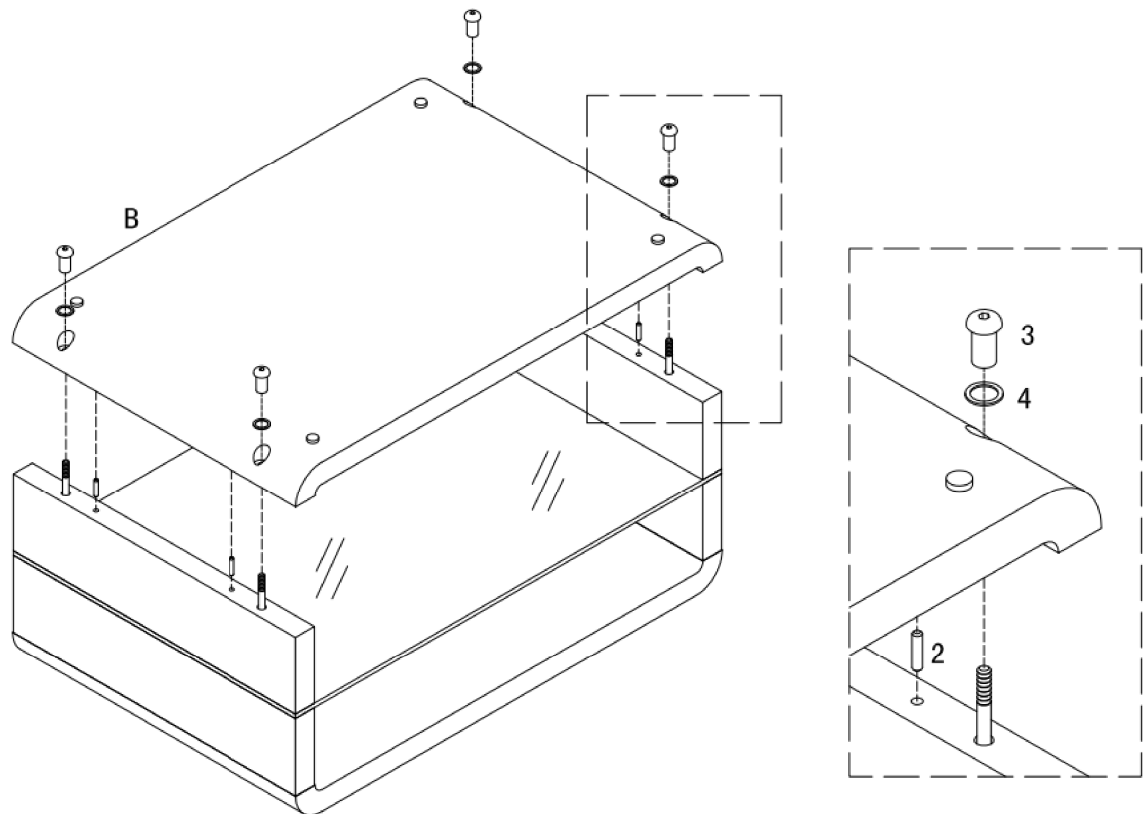

STEP 4

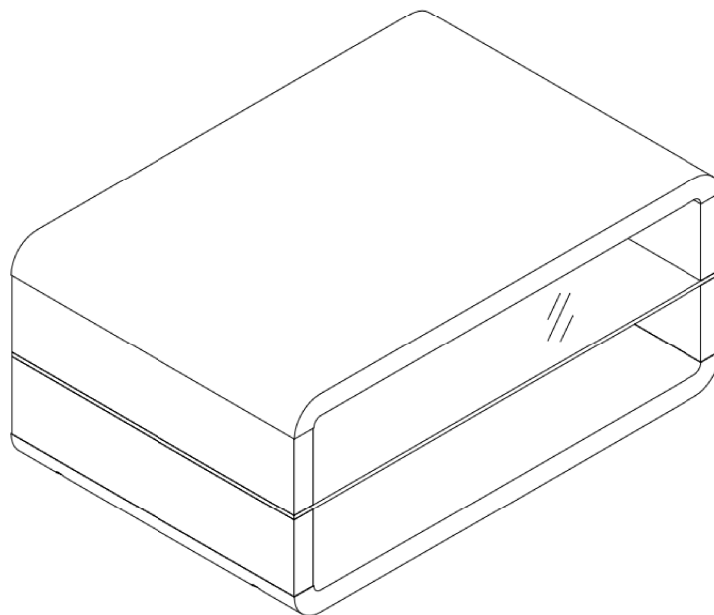

ITEM: 703268

ASSEMBLY INSTRUCTIONS

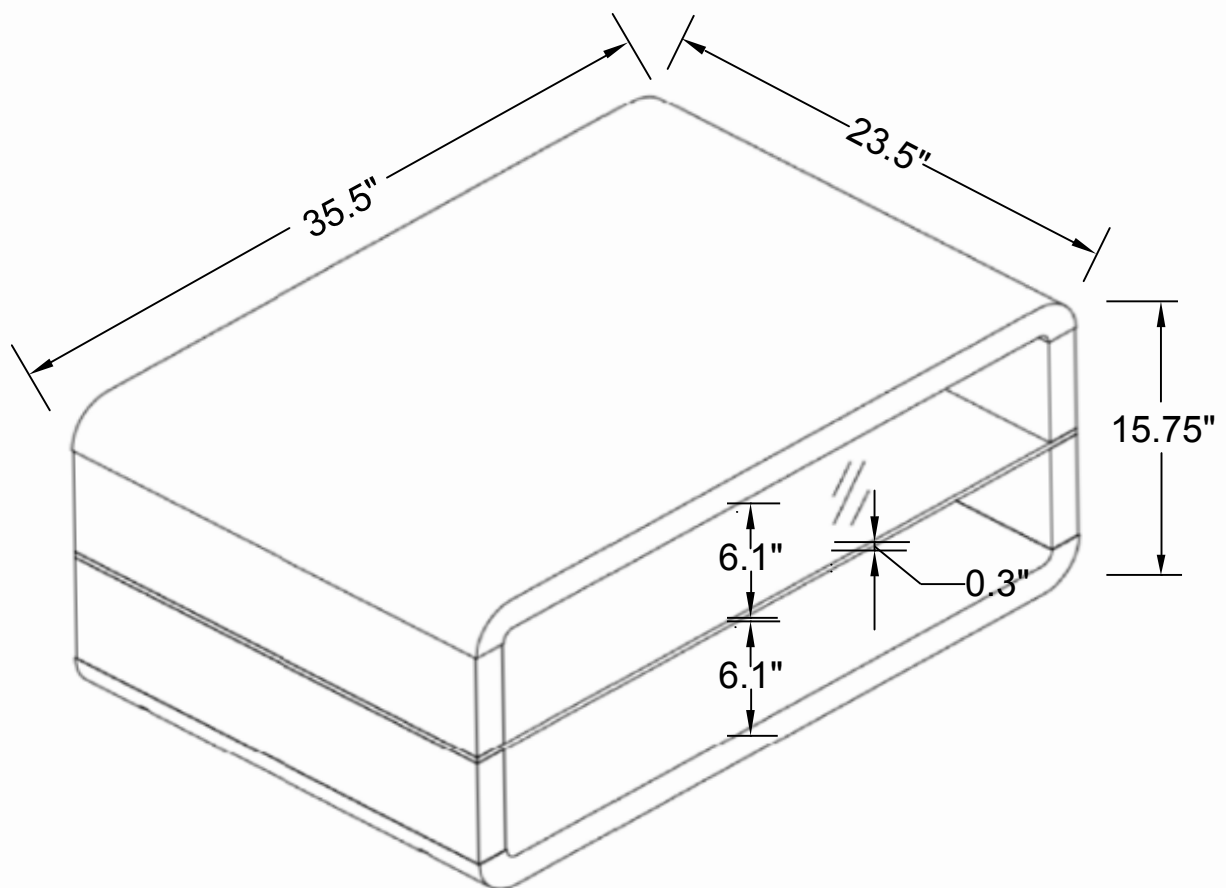

Note: Dimension tolerance $\pm 5\%$