

*ASSEMBLY INSTRUCTIONS
COASTER FINE FURNITURE*



Fine Furniture for every stage of life

705167
END TABLE

ITEM:705167

ASSEMBLY INSTRUCTIONS

ASSEMBLY TIPS:

1. Remove hardware from box and sort by size.
2. Please check to see that all hardware and parts are present prior to start of assembly.
3. Please follow attached instructions in the same sequence as numbered to assure fast & easy assembly.



WARNING!

1. Don't attempt to repair or modify parts that are broken or defective. Please contact the store immediately.
2. This product is for home use only and not intended for commercial establishments.



ASSEMBLY TIME

30 MINUTES

PARTS IDENTIFICATION

A SIDE PANEL

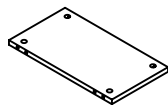

2 PCS

D

LONG CROSS
BRACE

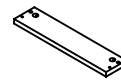

2 PCS

B DIVIDER PANEL

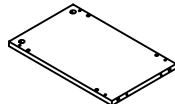

2 PCS

E

SHORT CROSS
BRACE

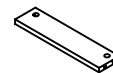

2 PCS

C BOTTOM PANEL

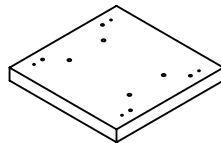

1 PC

F

TOP PANEL

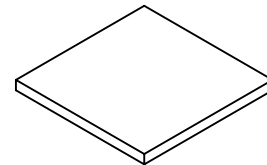

1 PC

Z

HARDWARE IDENTIFICATION

NO	DESCRIPTION	FIGURE	Q'TY	NO	DESCRIPTION	FIGURE	Q'TY
1	GLUE 40g		1 PC	5	BOLT Ø 9.5x55mm		4 PCS
2	WOODEN DOWEL Ø 8x30mm		24 PCS	6	PLASTIC FEET Ø 15mm		4 PCS
3	CAM BOLT Ø 7x35.5mm		20 PCS	7	STICKER Ø 20mm		4 PCS
4	CAM LOCK Ø15x12mm		20 PCS				

NOTE:

Phillips head screw driver is required in the assembly process; however, manufacturer does not provide this item.

ITEM: 705167

COASTER
FINE FURNITURE

STEP 1

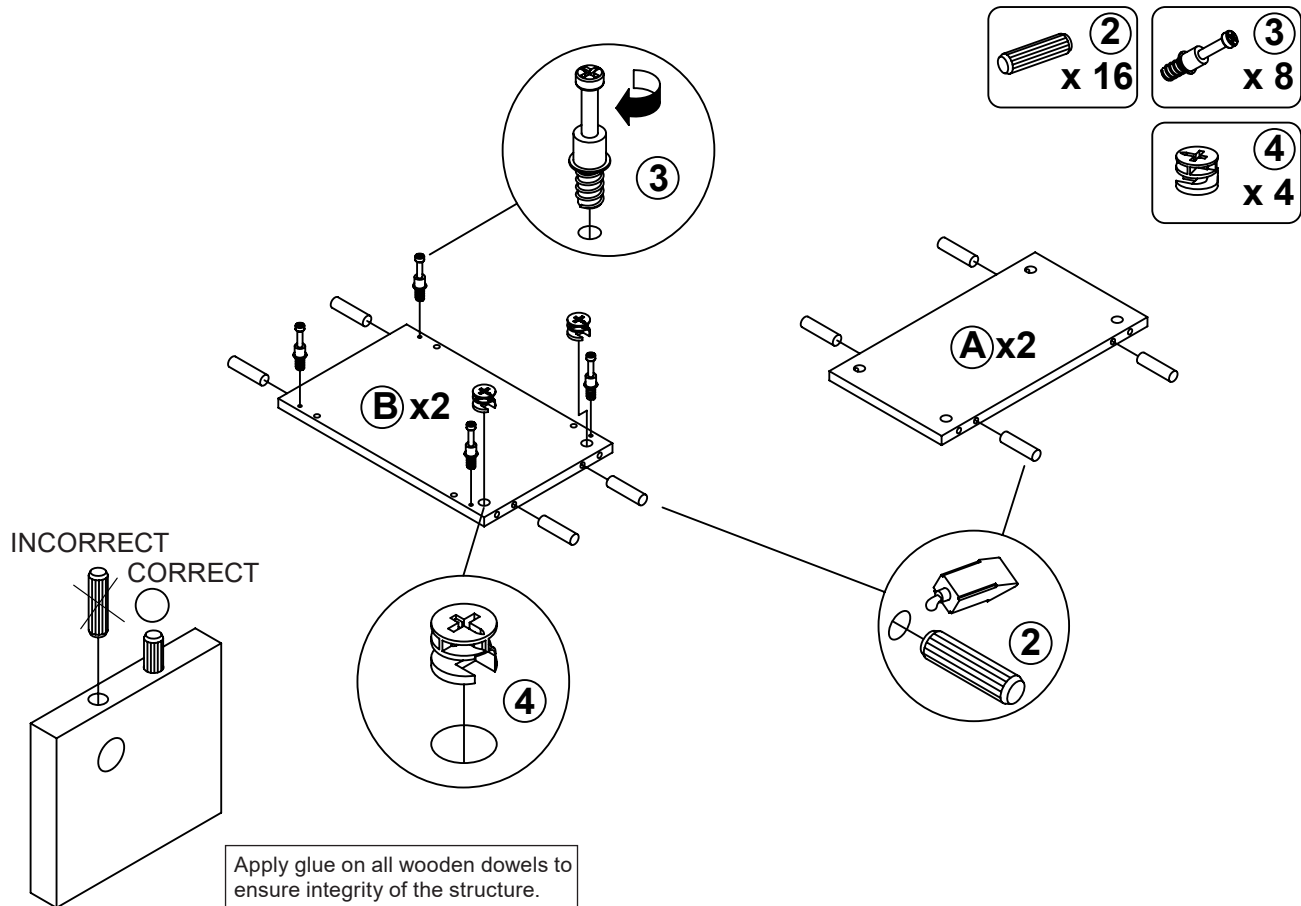

STEP 2

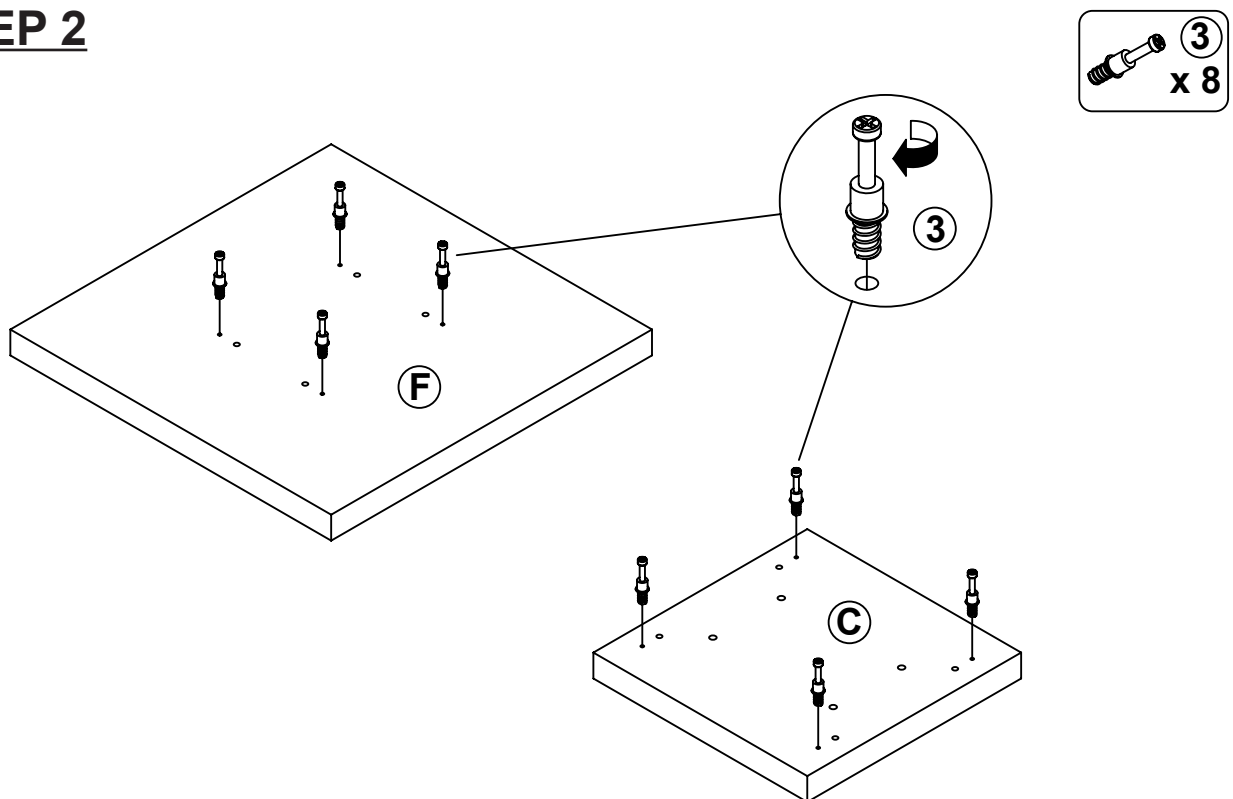

ITEM: 705167

STEP 3

COASTER
FINE FURNITURE

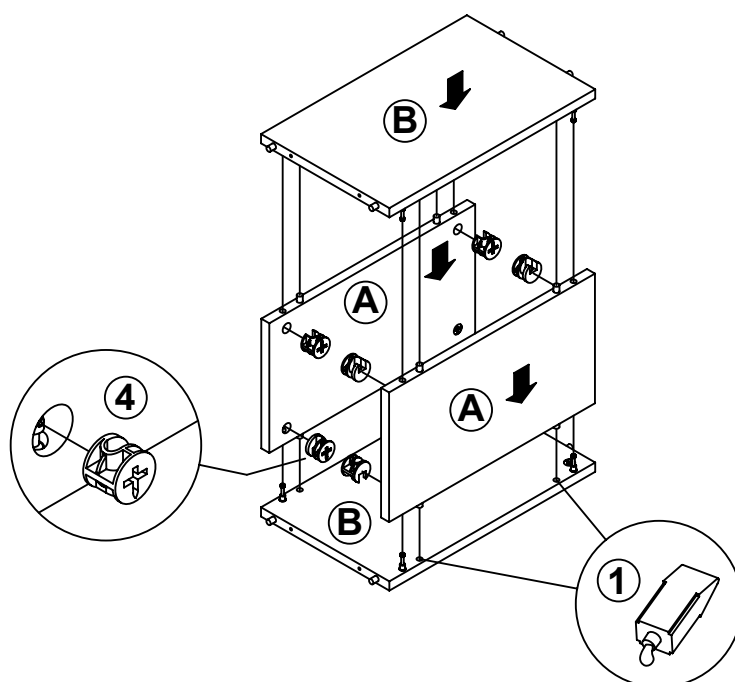

Apply glue on all wooden dowels to ensure integrity of the structure.

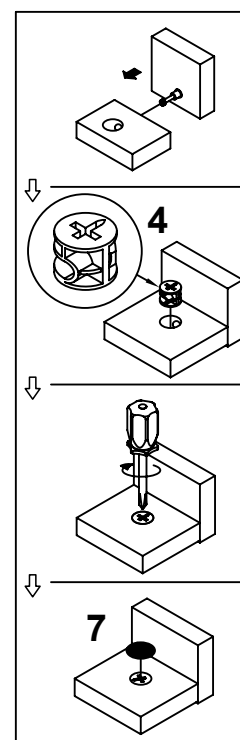

STEP 4

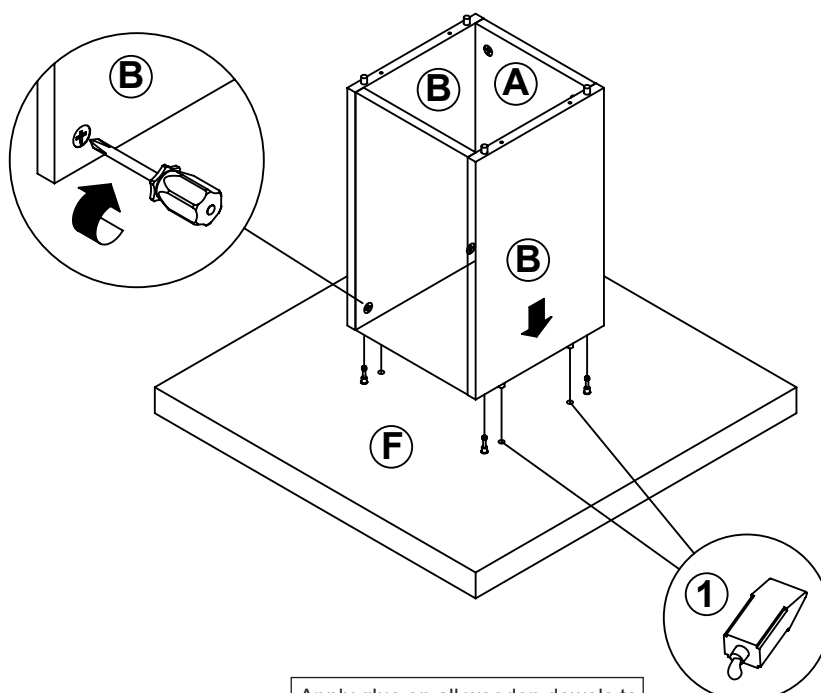
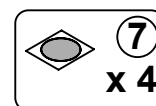

Apply glue on all wooden dowels to ensure integrity of the structure.

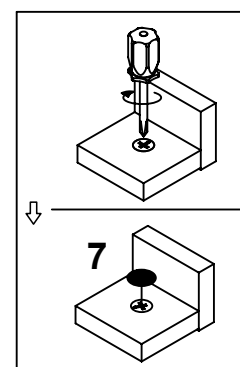

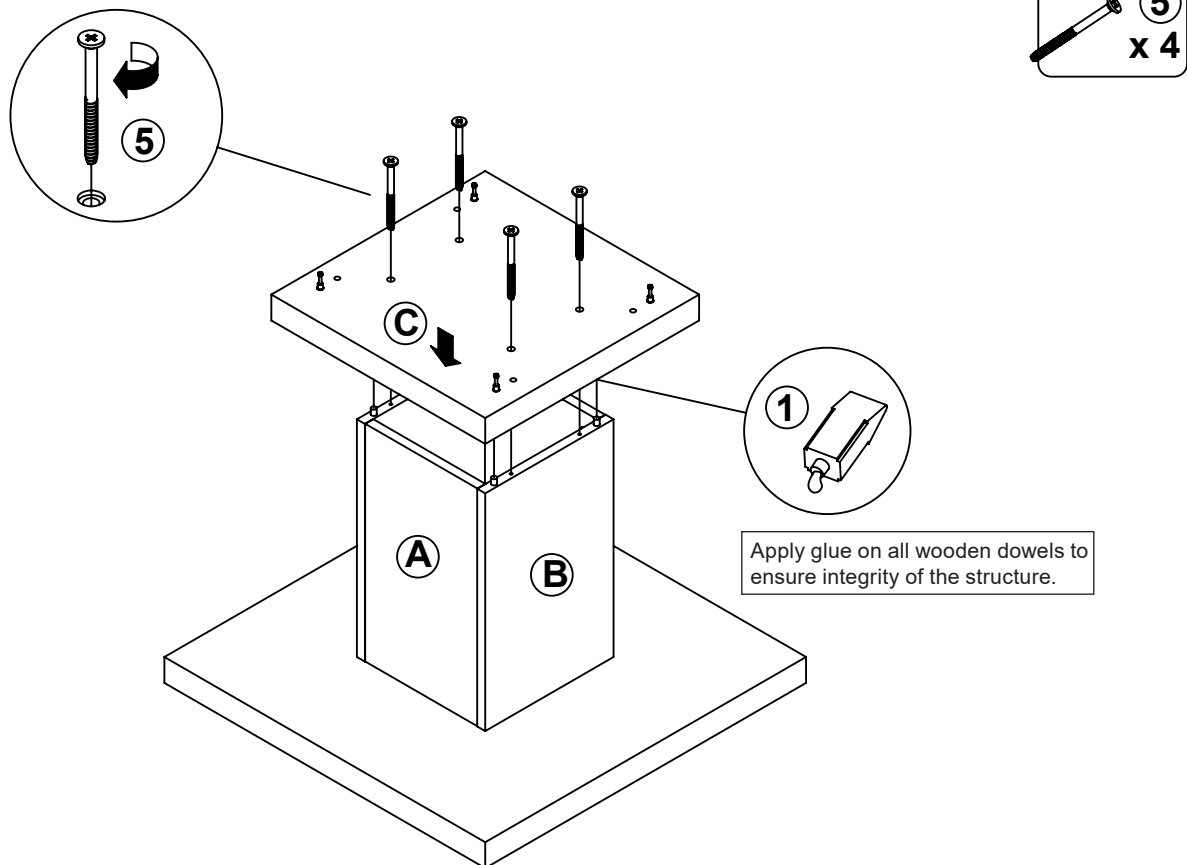
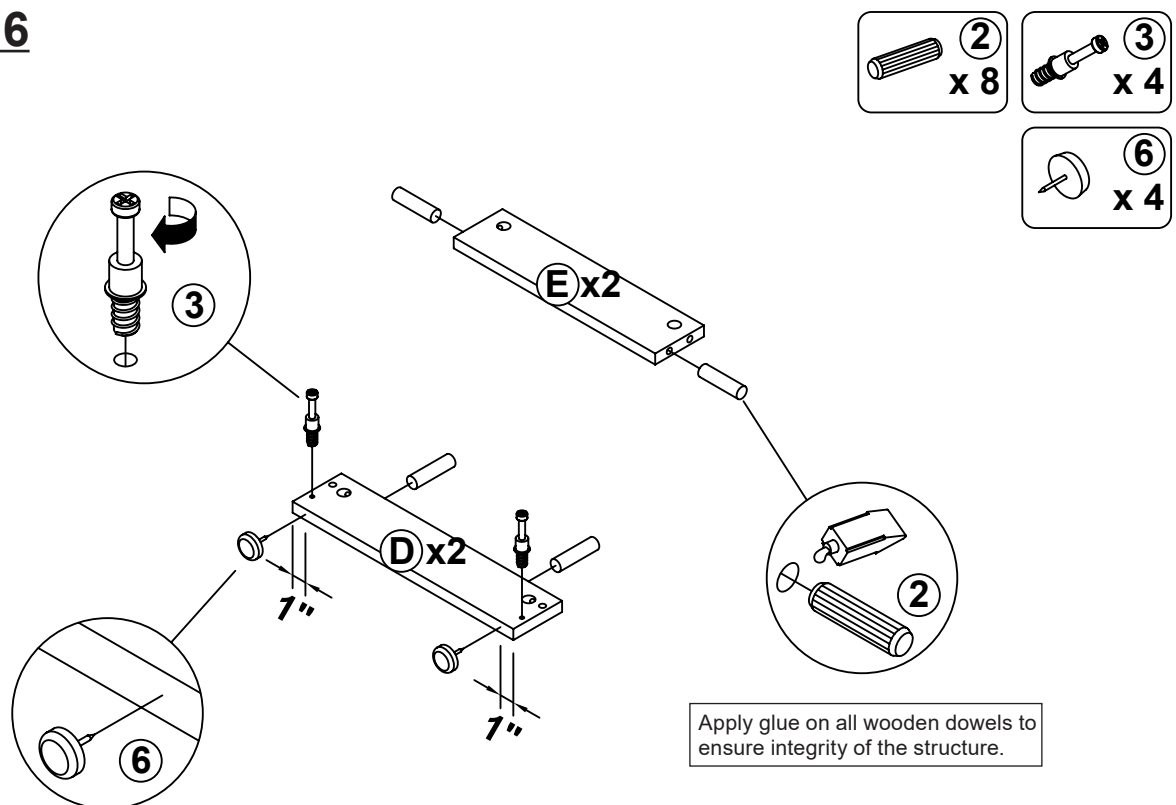
STEP 5**STEP 6**

ITEM: 705167

STEP 7

COASTER
FINE FURNITURE

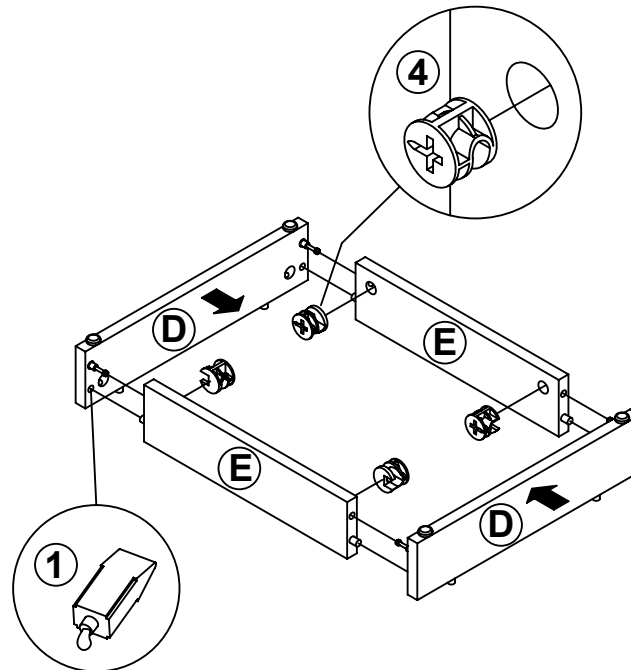
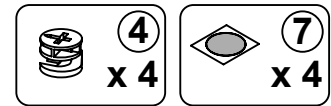

Apply glue on all wooden dowels to ensure integrity of the structure.

STEP 8

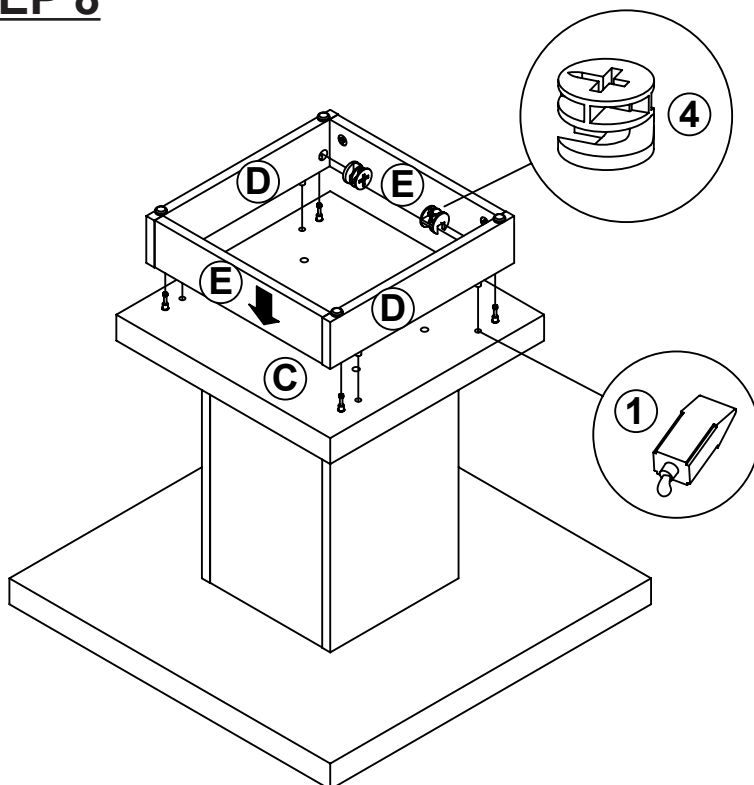
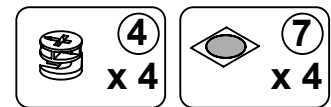

Apply glue on all wooden dowels to ensure integrity of the structure.

COMPLETE

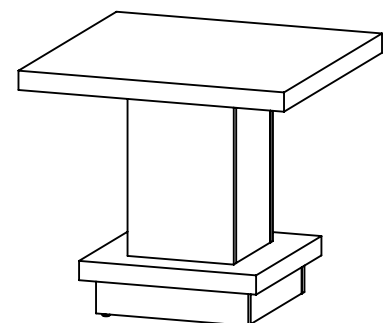

ITEM: 705167

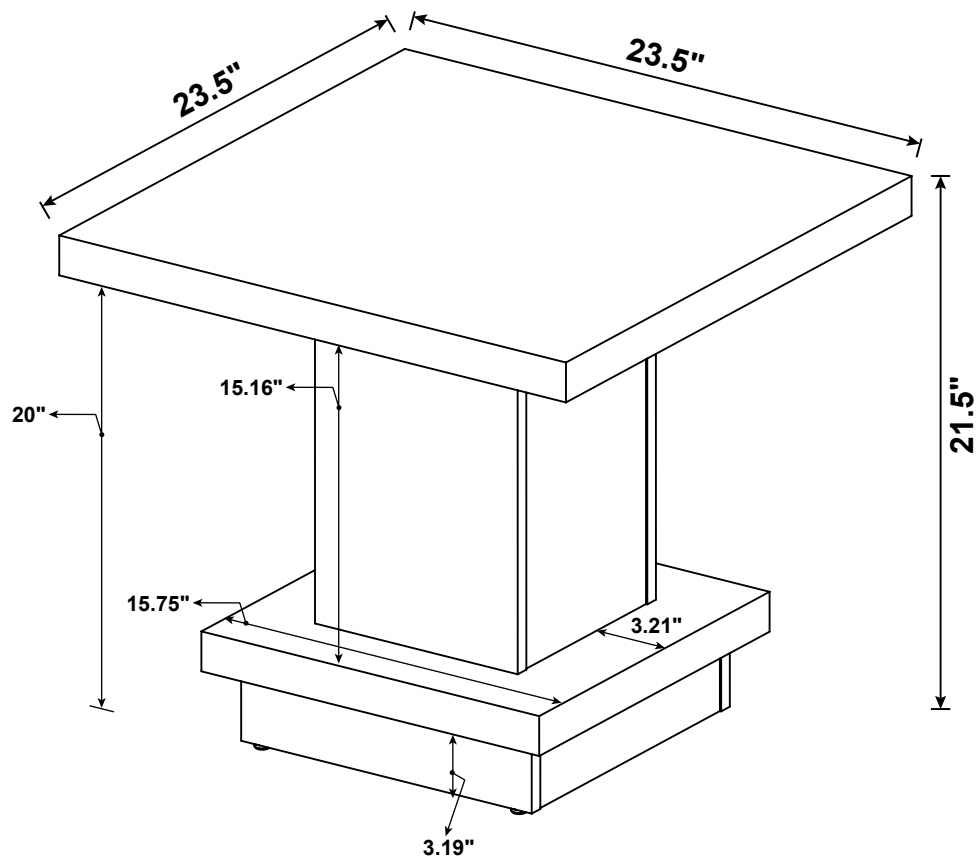

Note : Dimension tolerance $\pm 5\%$

*ASSEMBLY INSTRUCTIONS
COASTER FINE FURNITURE*

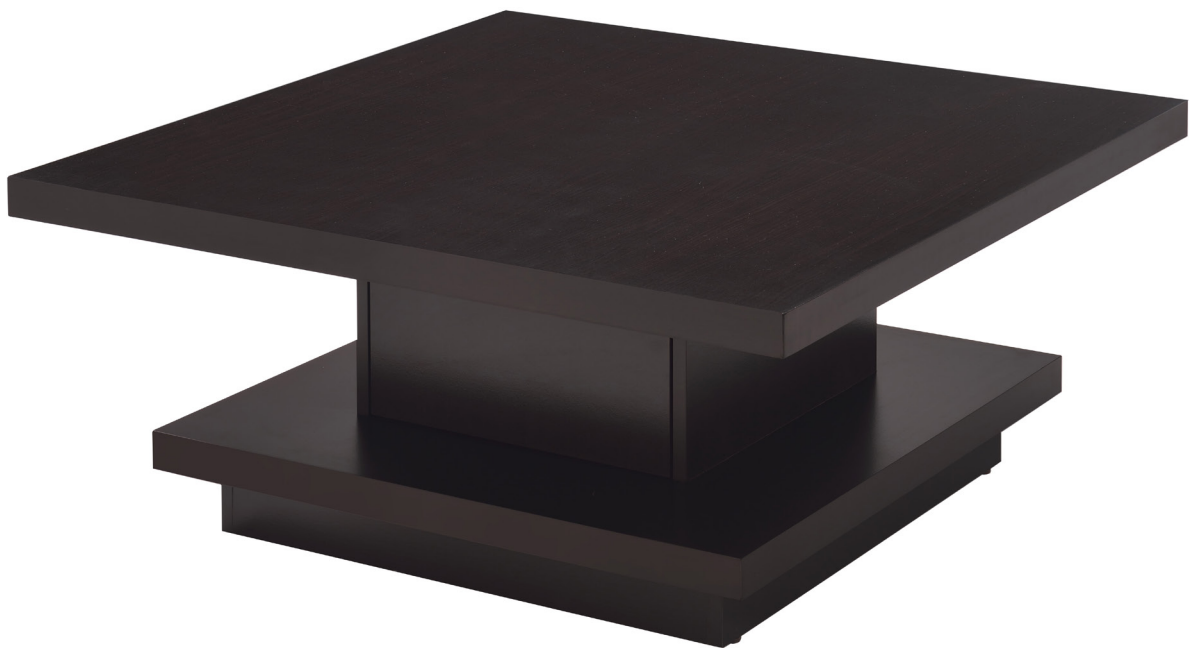

Fine Furniture for every stage of life

705168
COFFEE TABLE

ITEM:705168

ASSEMBLY INSTRUCTIONS

ASSEMBLY TIPS:

1. Remove hardware from box and sort by size.
2. Please check to see that all hardware and parts are present prior to start of assembly.
3. Please follow attached instructions in the same sequence as numbered to assure fast & easy assembly.



WARNING!

1. Don't attempt to repair or modify parts that are broken or defective. Please contact the store immediately.
2. This product is for home use only and not intended for commercial establishments.

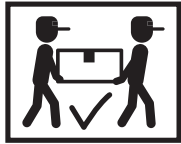

ASSEMBLY TIME

30 MINUTES

PARTS IDENTIFICATION

A LEFT SIDE
PANEL

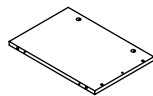

1 PC

B RIGHT SIDE
PANEL

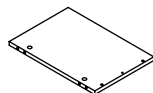

1 PC

C DOOR

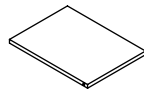

1 PC

D BACK PANEL

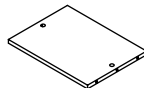

1 PC

E BOTTOM PANEL

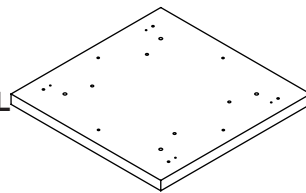

1 PC

F LONG CROSS
BRACE

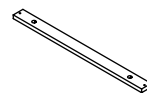

2 PCS

G SHORT CROSS
BRACE

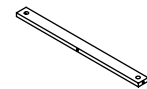

2 PCS

H TOP PANEL

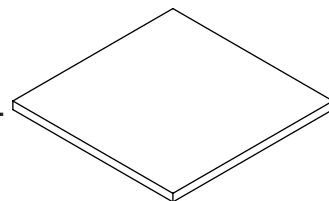

1 PC

HARDWARE IDENTIFICATION

Z							
NO	DESCRIPTION	FIGURE	Q'TY	NO	DESCRIPTION	FIGURE	Q'TY
1	GLUE 40g		1 PC	4	CAM LOCK Ø 15x12mm		14 PCS
2	WOODEN DOWEL Ø 8x30mm		20 PCS	5	BOLT Ø 9.5x55mm		4 PCS
3	CAM BOLT Ø 7x35.5mm		14 PCS	6	SINGLE MAGNETIC CATCH		1 PC



NOTE:

Phillips head screw driver is required in the assembly process; however, manufacturer does not provide this item.

ITEM:705168

Z

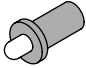
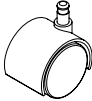
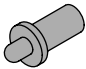
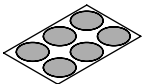
HARDWARE IDENTIFICATION

NO	DESCRIPTION	FIGURE	Q'TY	NO	DESCRIPTION	FIGURE	Q'TY
7	FLEXIBLE DOOR DAMPER		1 PC	10	CASTER		4 PCS
8	FIXED DOOR DAMPER		1 PC	11	STICKER Ø 20mm		3 PCS
9	SCREW FOR DOOR		1 PC	12	SCREW Ø 3x19mm SR		2 PCS

Z10 not included in blister packaging.

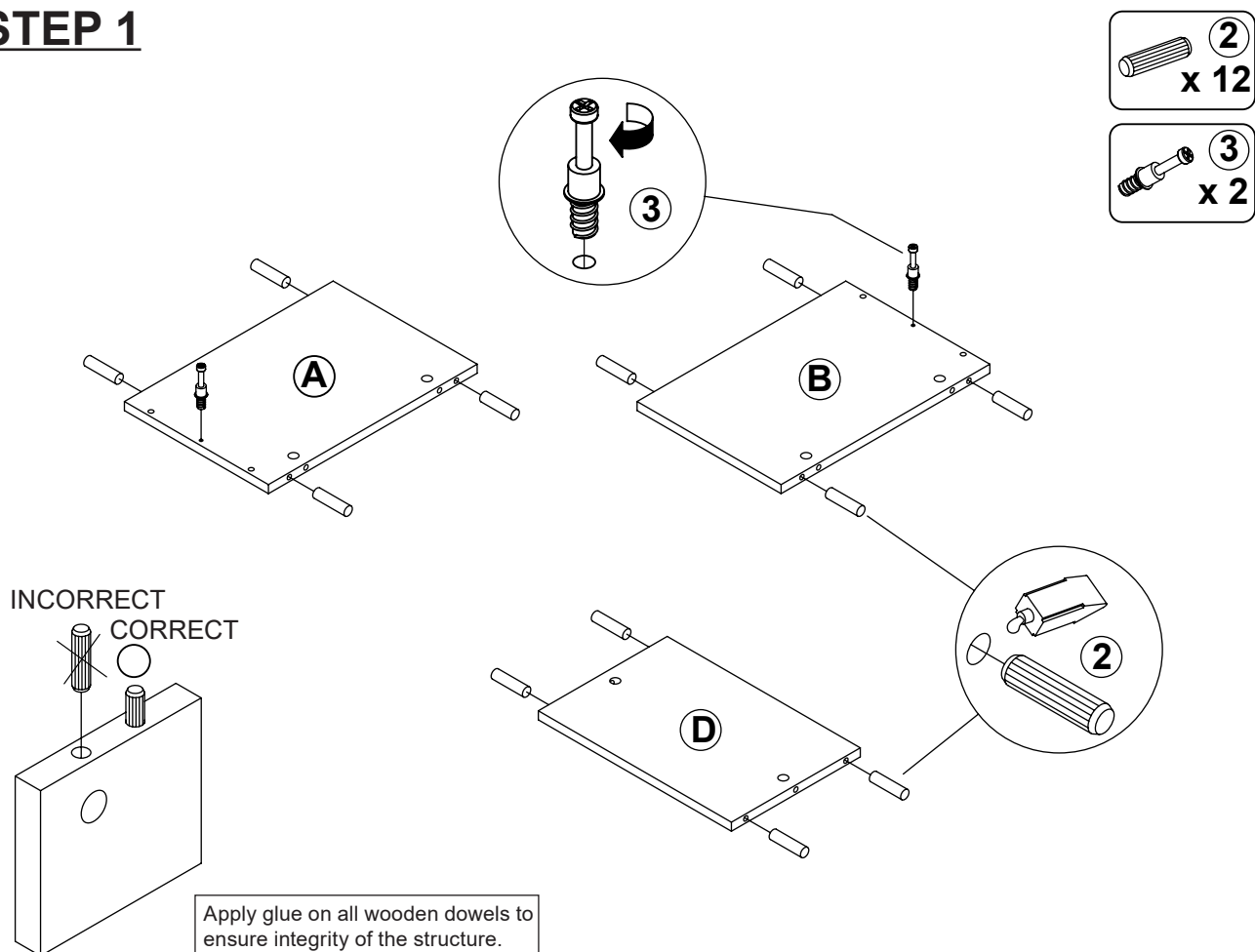
STEP 1**NOTE:**

Phillips head screw driver is required in the assembly process; however, manufacturer does not provide this item.

ITEM: **705168**

STEP 2

COASTER
FINE FURNITURE

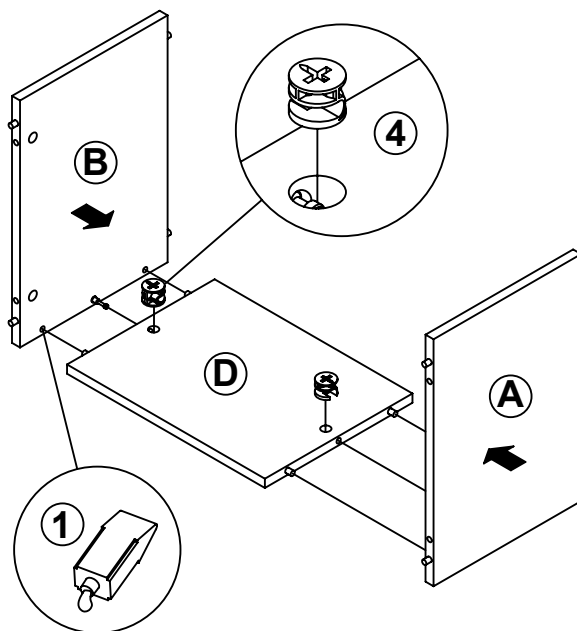
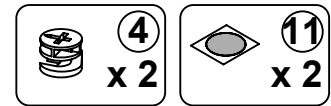

Apply glue on all wooden dowels to ensure integrity of the structure.

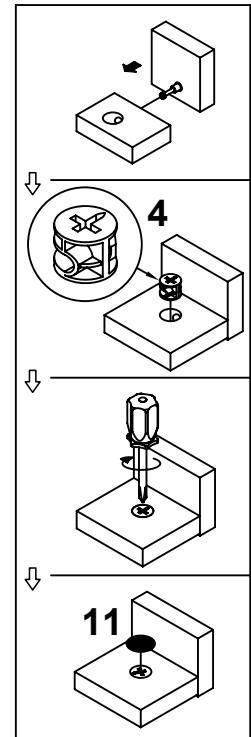

STEP 3

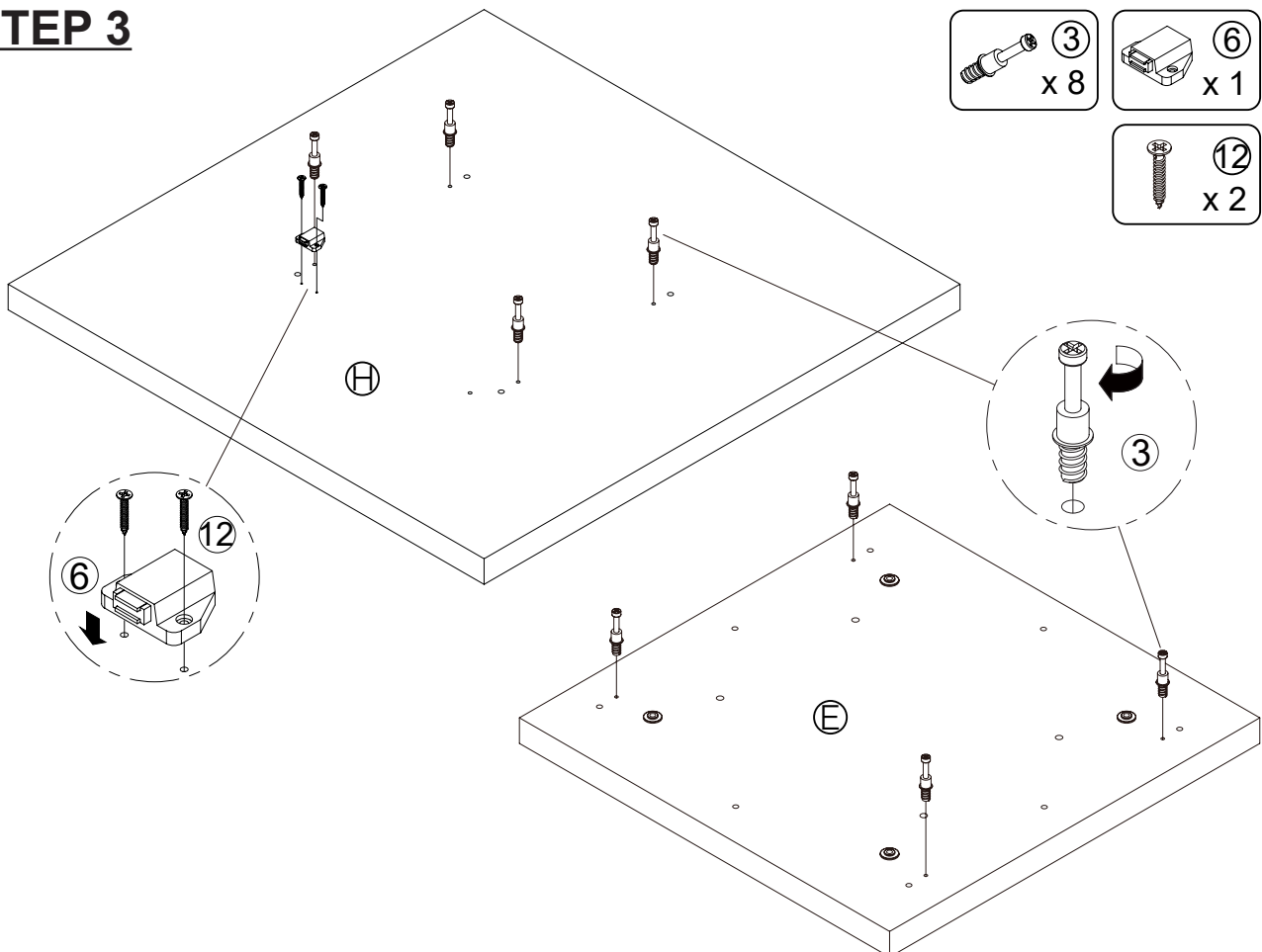
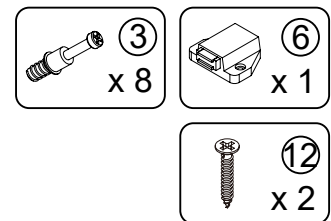

ITEM: **705168**

STEP 4

COASTER
FINE FURNITURE

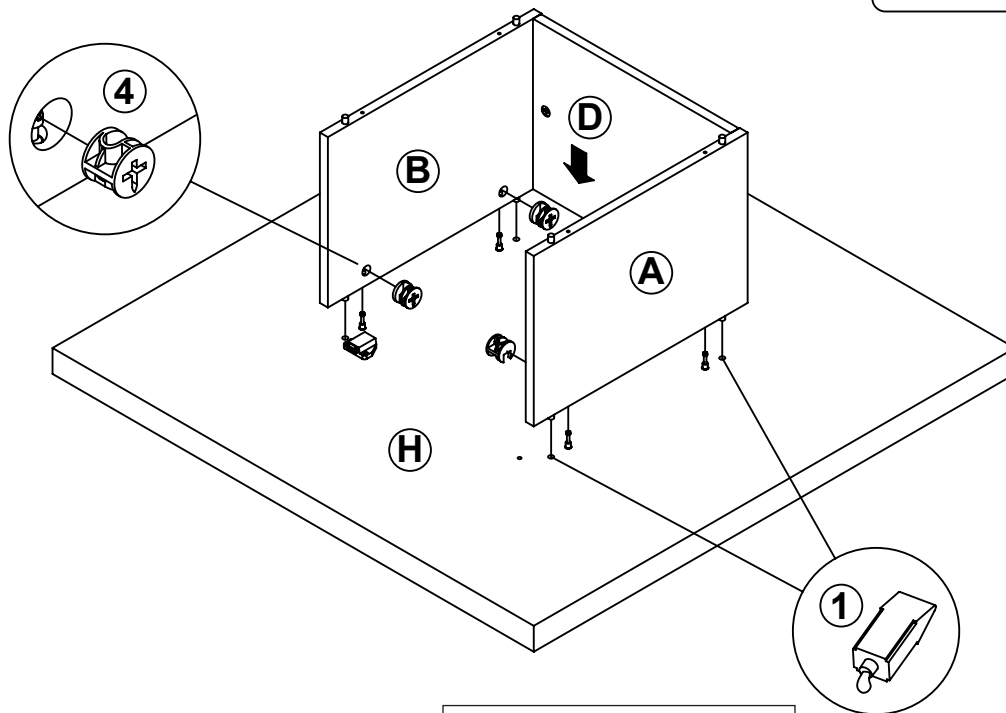
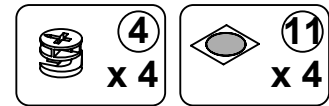

Apply glue on all wooden dowels to ensure integrity of the structure.

STEP 5

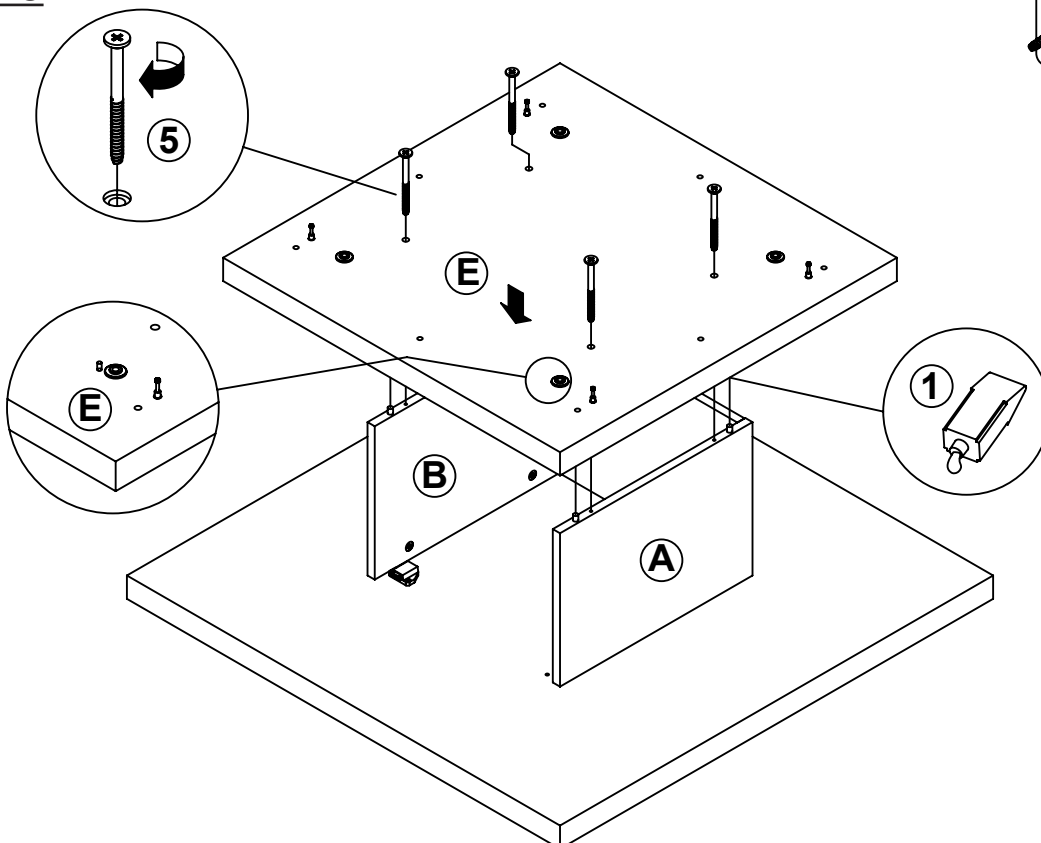
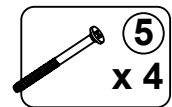

ITEM: 705168

STEP 6

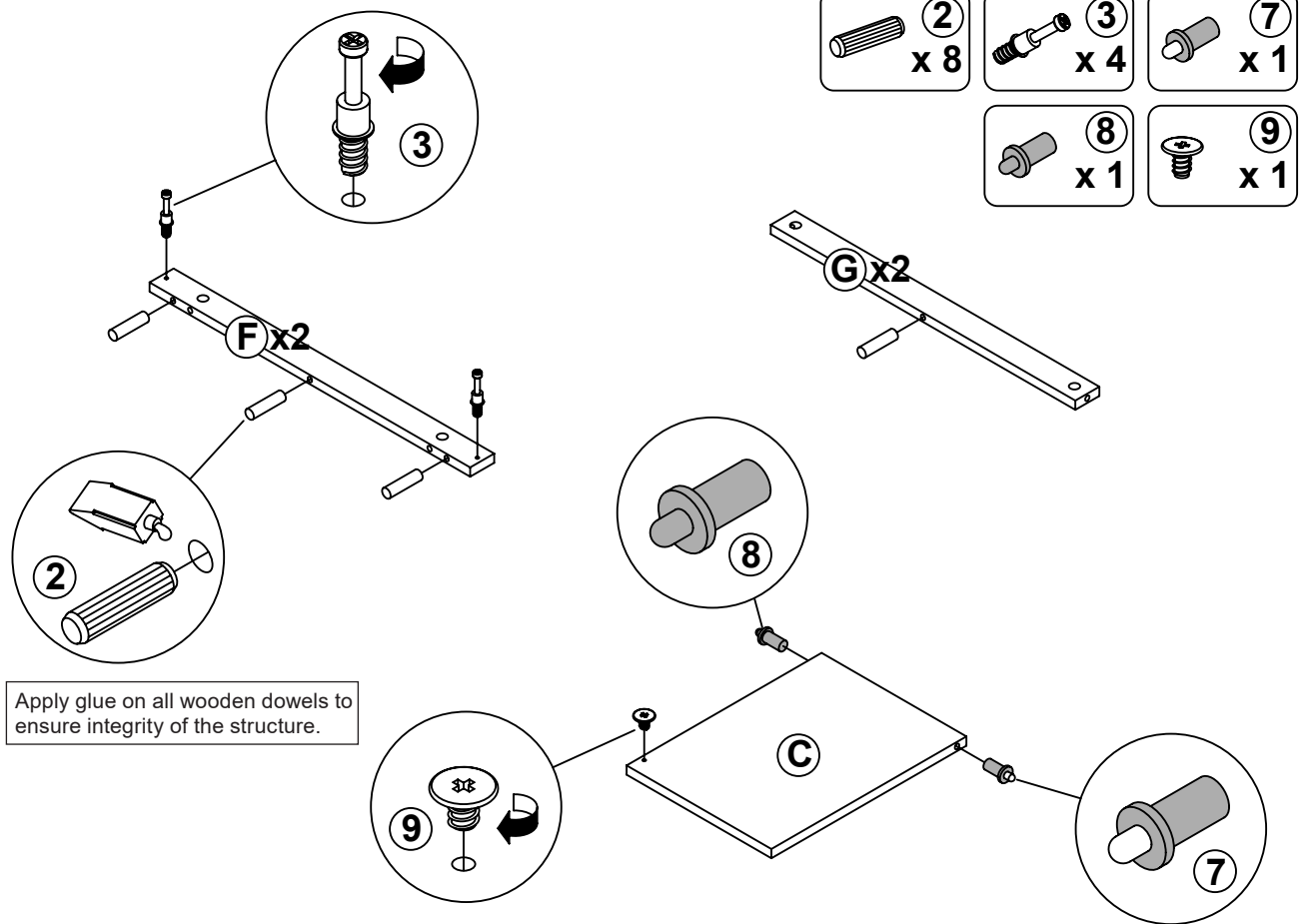

STEP 7

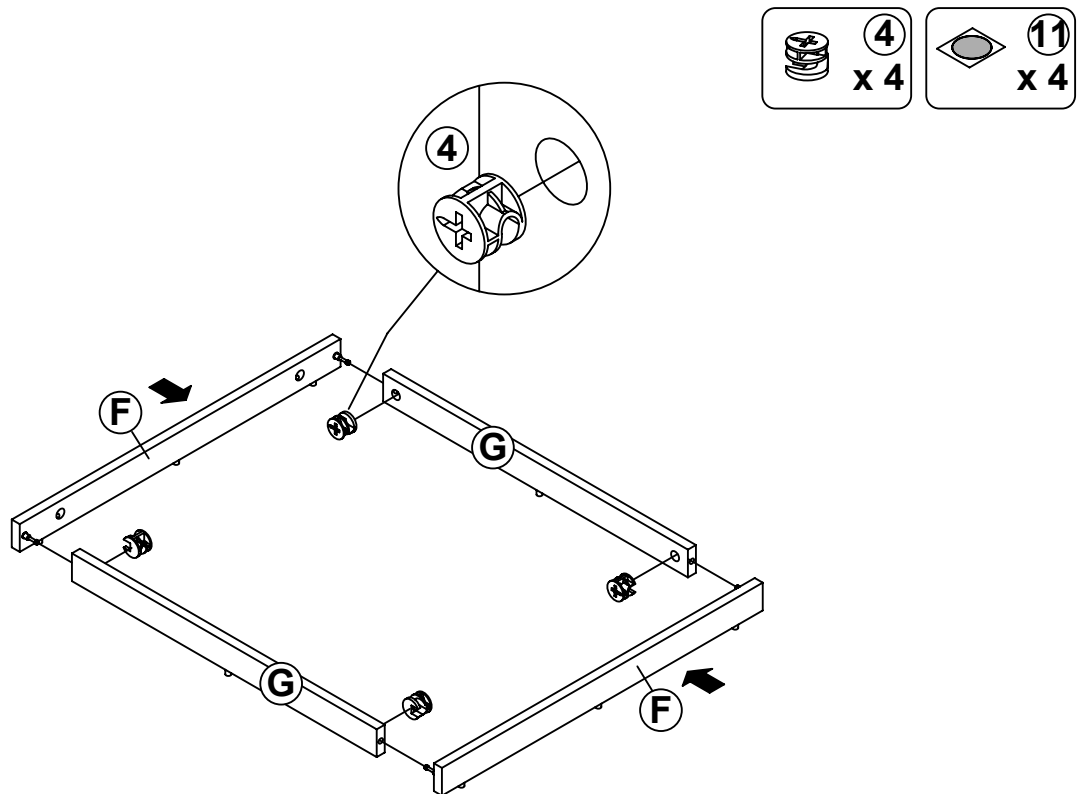

ITEM: **705168**

STEP 8

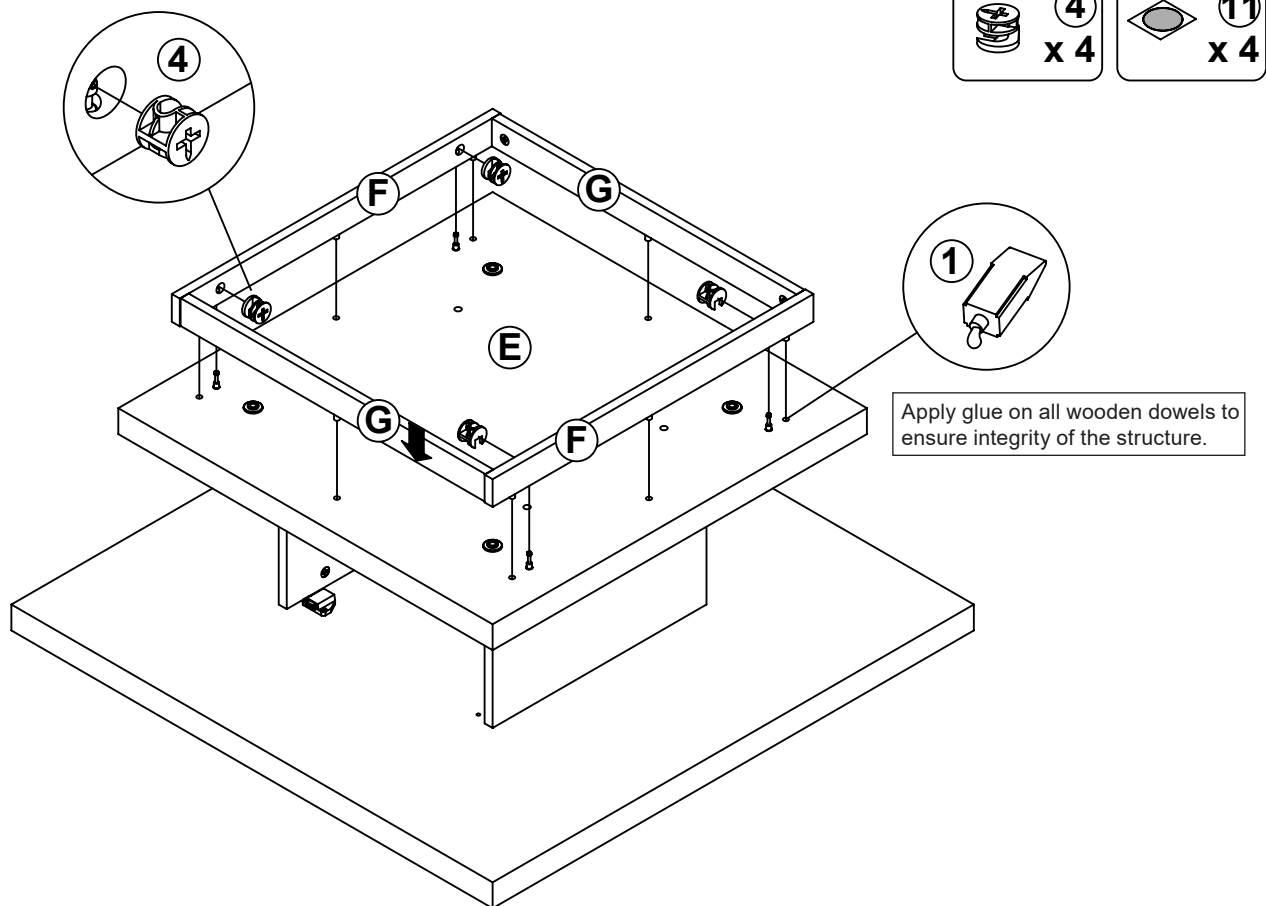

STEP 9

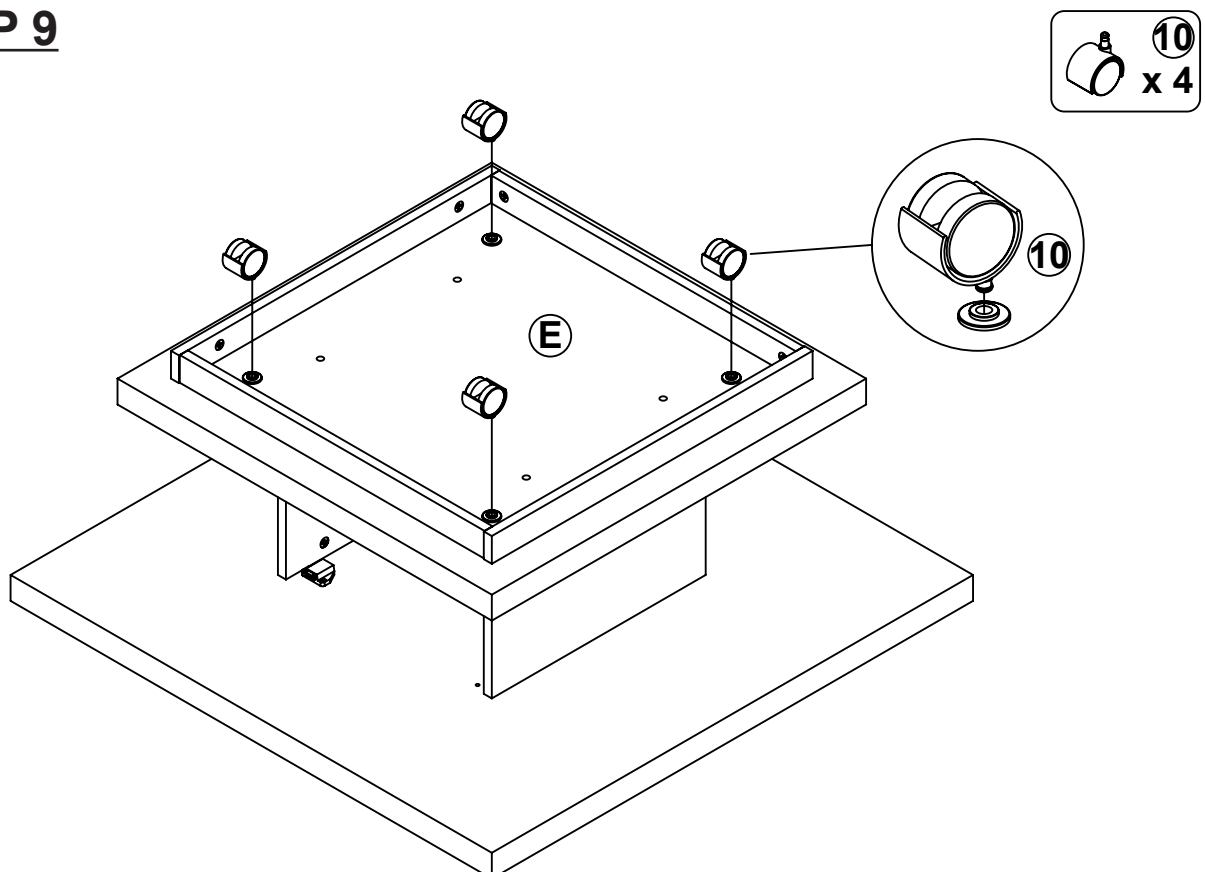

ITEM: **705168**

STEP 10

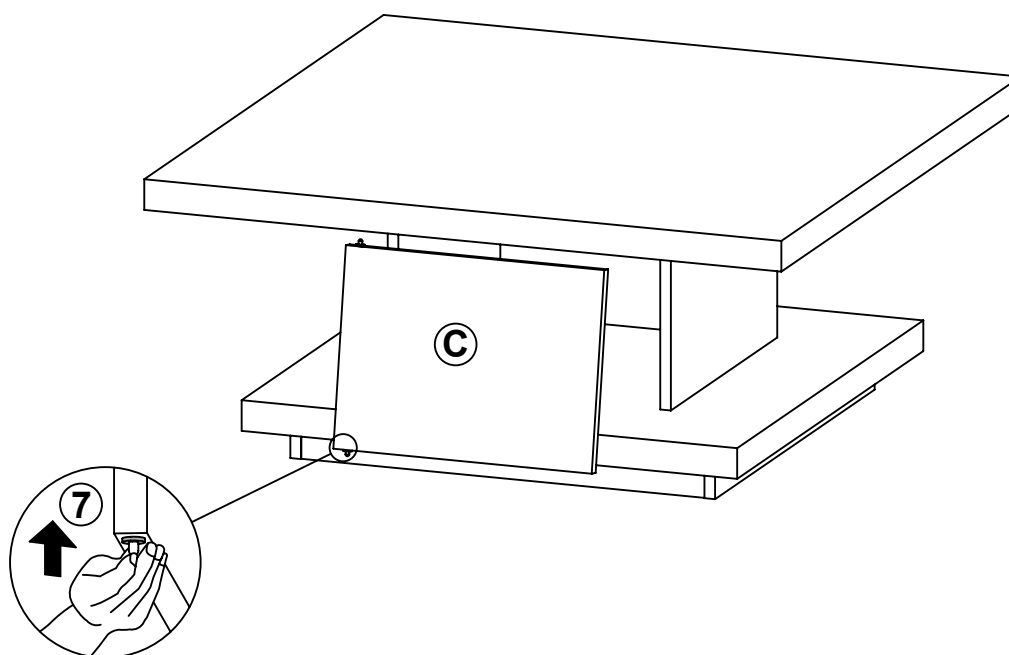

STEP 11

COMPLETE

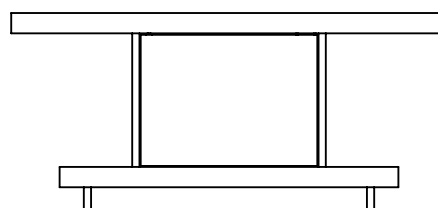
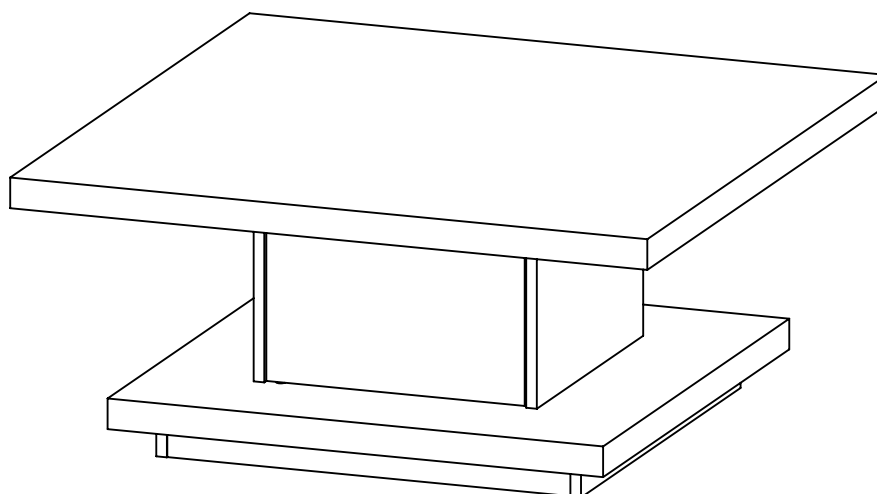

ITEM:705168

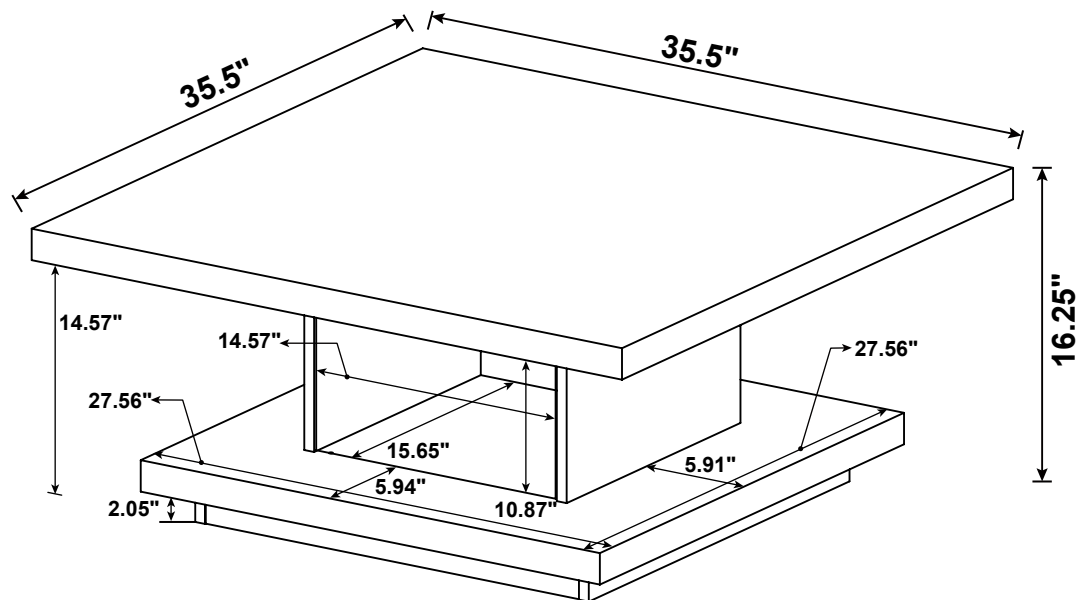

Note : Dimension tolerance $\pm 5\%$