

ASSEMBLY INSTRUCTIONS
COASTER FINE FURNITURE

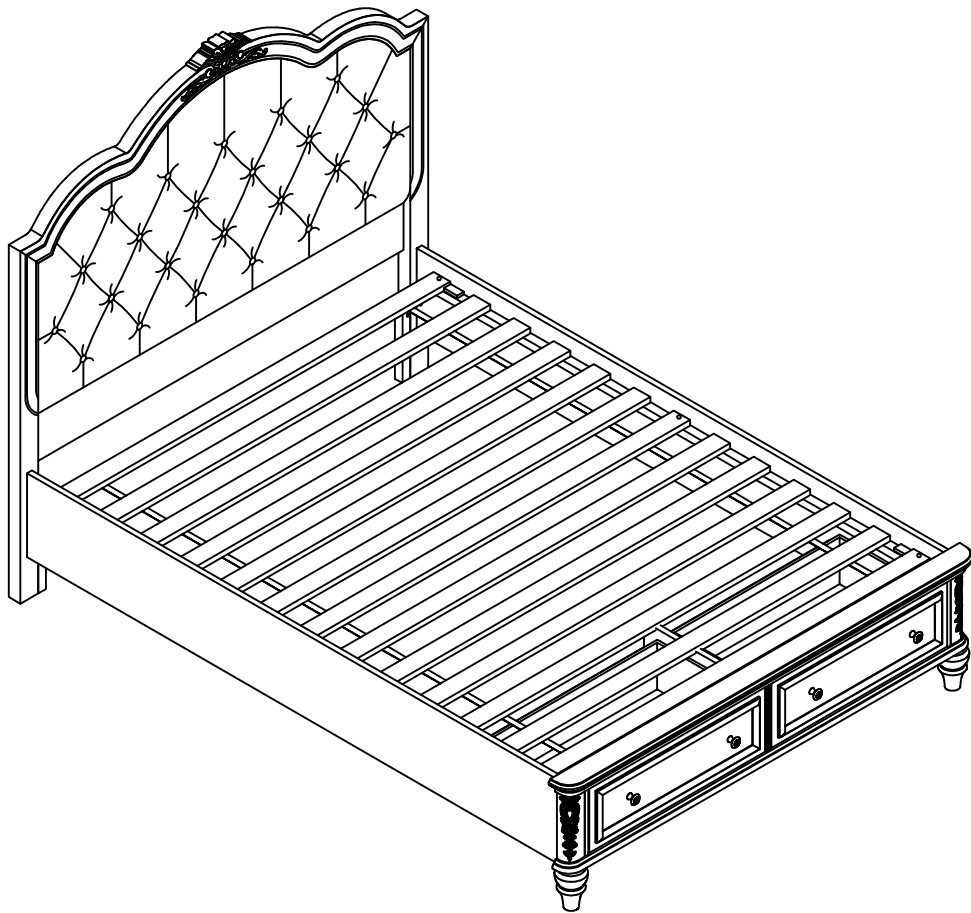

Fine Furniture for every stage of life

400891F (B1-B3)
Full Storage Bed

ITEM: 400891F (B1-B3)



ASSEMBLY INSTRUCTIONS

ASSEMBLY TIPS:

1. Remove hardware from box and sort by size.
2. Please check to see that all hardware and parts are present prior to start of assembly.
3. Please follow attached instructions in the same sequence as numbered to assure fast & easy assembly.



WARNING!

1. Don't attempt to repair or modify parts that are broken or defective. Please contact the store immediately.
2. This product is for home use only and not intended for commercial establishments.



ASSEMBLY TIME

20 MINUTES

PARTS IDENTIFICATION

B1 (BOX 1)

AN HEADBOARD

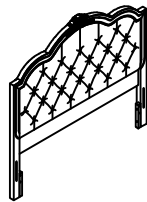

1PC

B2 (BOX 2)

BN STORAGE FOOTBOARD

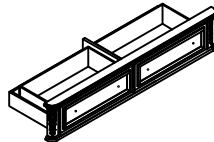

1PC

CN BUN FOOT



2PCS

B3 (BOX 3)

DN BED RAIL



2PCS

EN ROLL SLAT (13PCS)

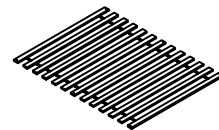

1SET

FN FOOTBOARD SUPPORT LEG WITH LEVELER

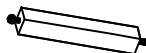

2PCS

AN 400891F (B1) FROM BOX 1 HEADBOARD

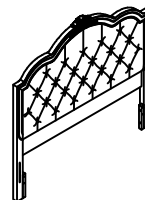

1PC

FBN 400891F (B2) FROM BOX 2 STORAGE FOOTBOARD COMPLETE

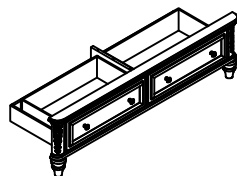

1PC

HARDWARE IDENTIFICATION

Z-B3 (BOX 3) - HARDWARE PACK IS LOCATED IN 400891F (B3)

1

FLAT HEAD SCREW
(Ø4 x 30mm - RBW)



6PCS

NOTE:

Phillips head screw driver is required in the assembly process; however, manufacturer does not provide this item.

ITEM: **400891F (B1-B3)**



ASSEMBLY INSTRUCTIONS

STEP 1

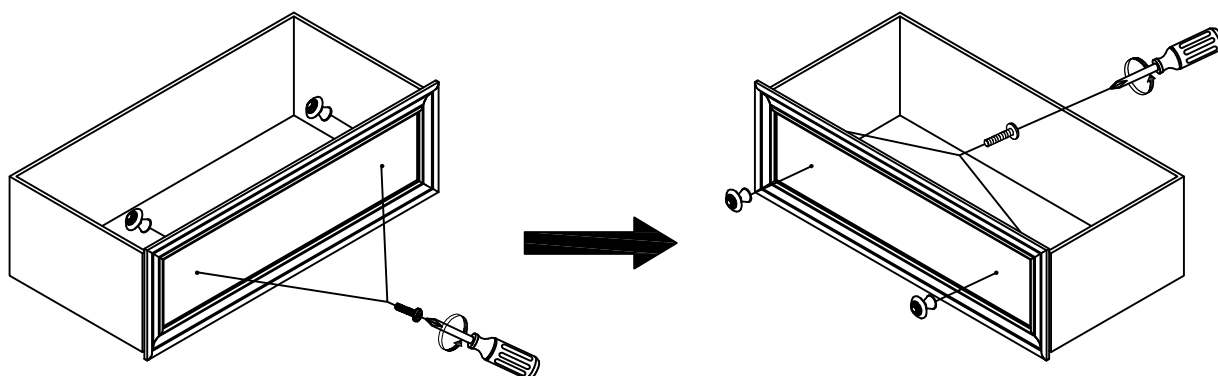

STEP 2

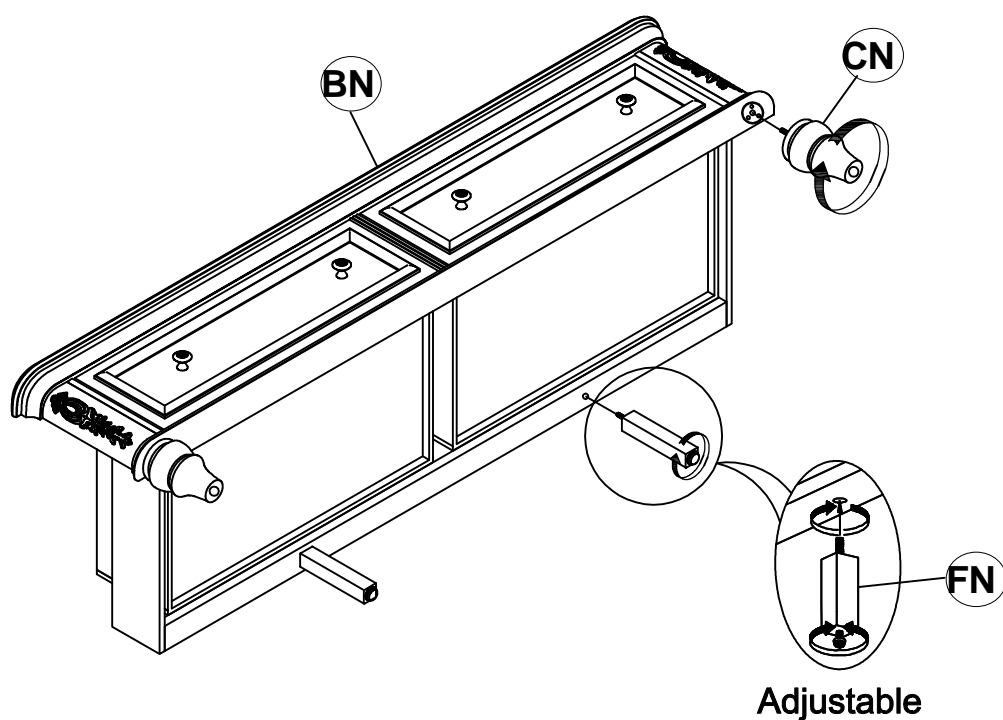

ITEM: **400891F (B1-B3)**

ASSEMBLY INSTRUCTIONS
STEP 3

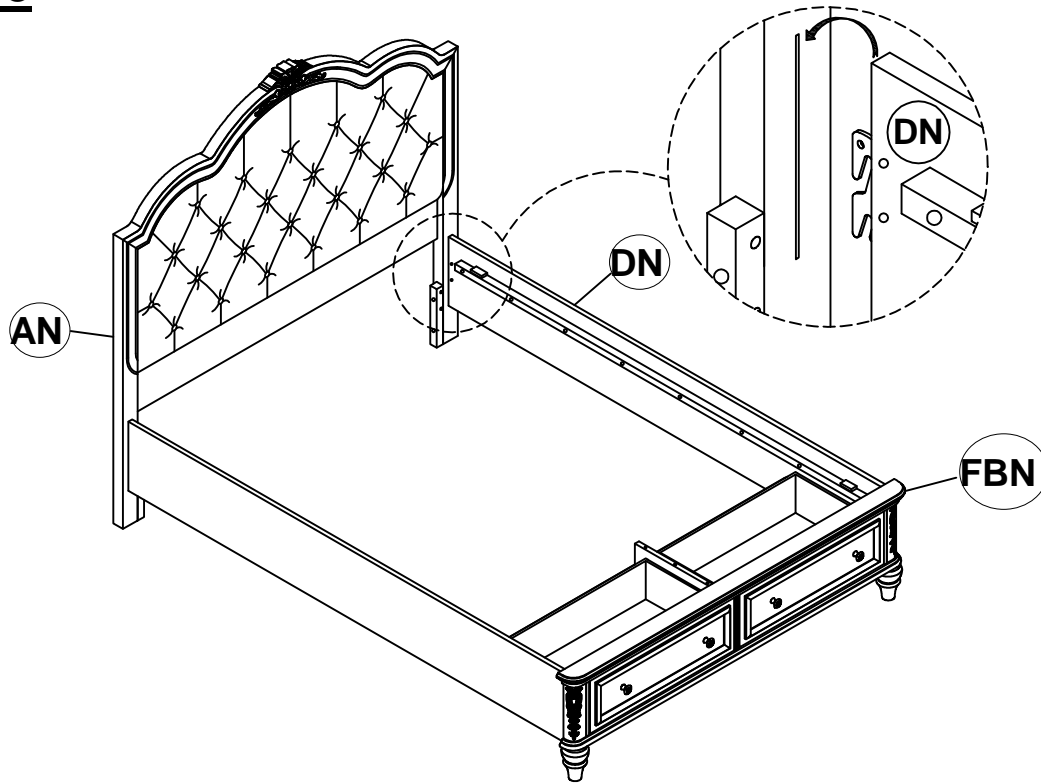

STEP 4

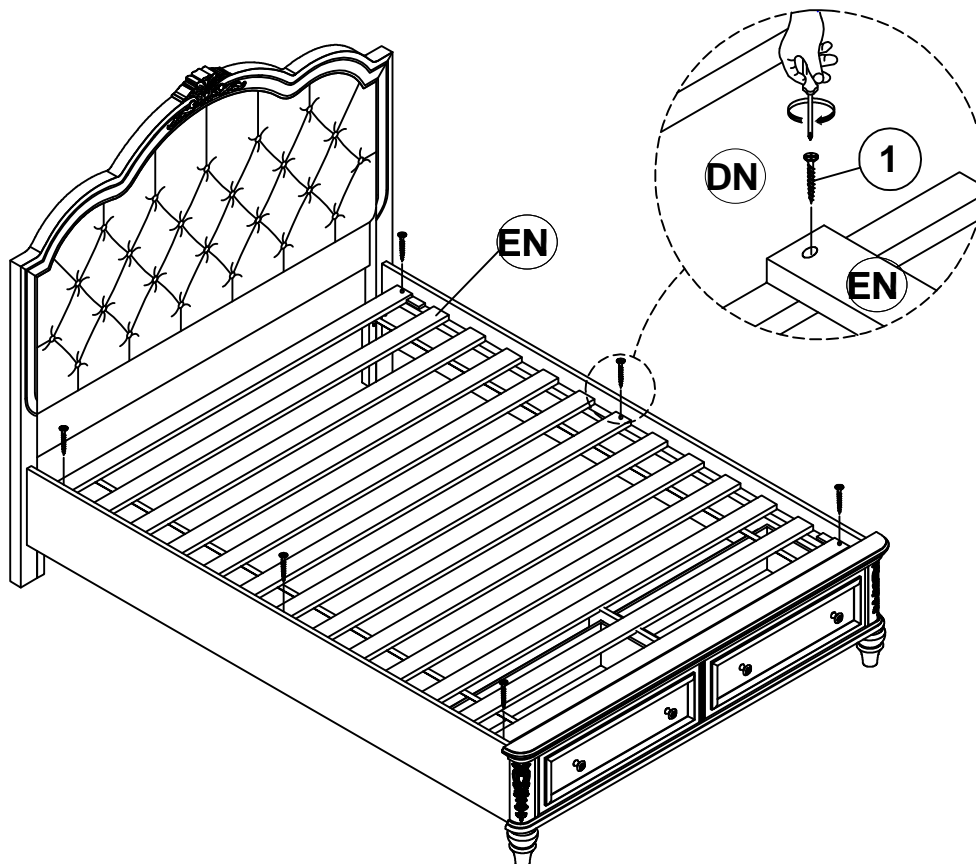

ITEM: **400891F (B1-B3)**



ASSEMBLY INSTRUCTIONS

STEP 5

COMPLETE

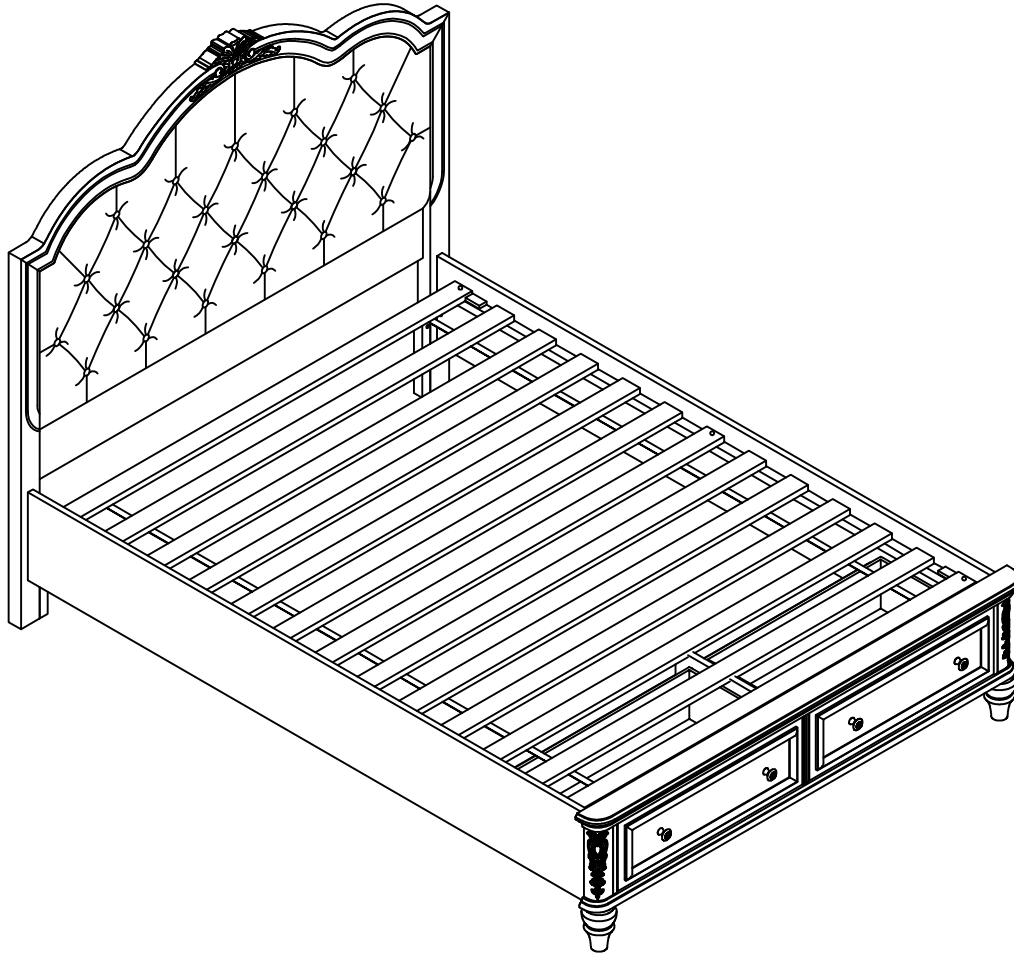

ITEM: 400891F (B1-B3)

INNER SIZE : 76" X 55"

INNER SIZE OF DRAWER : 23.5" X 14" X 6"

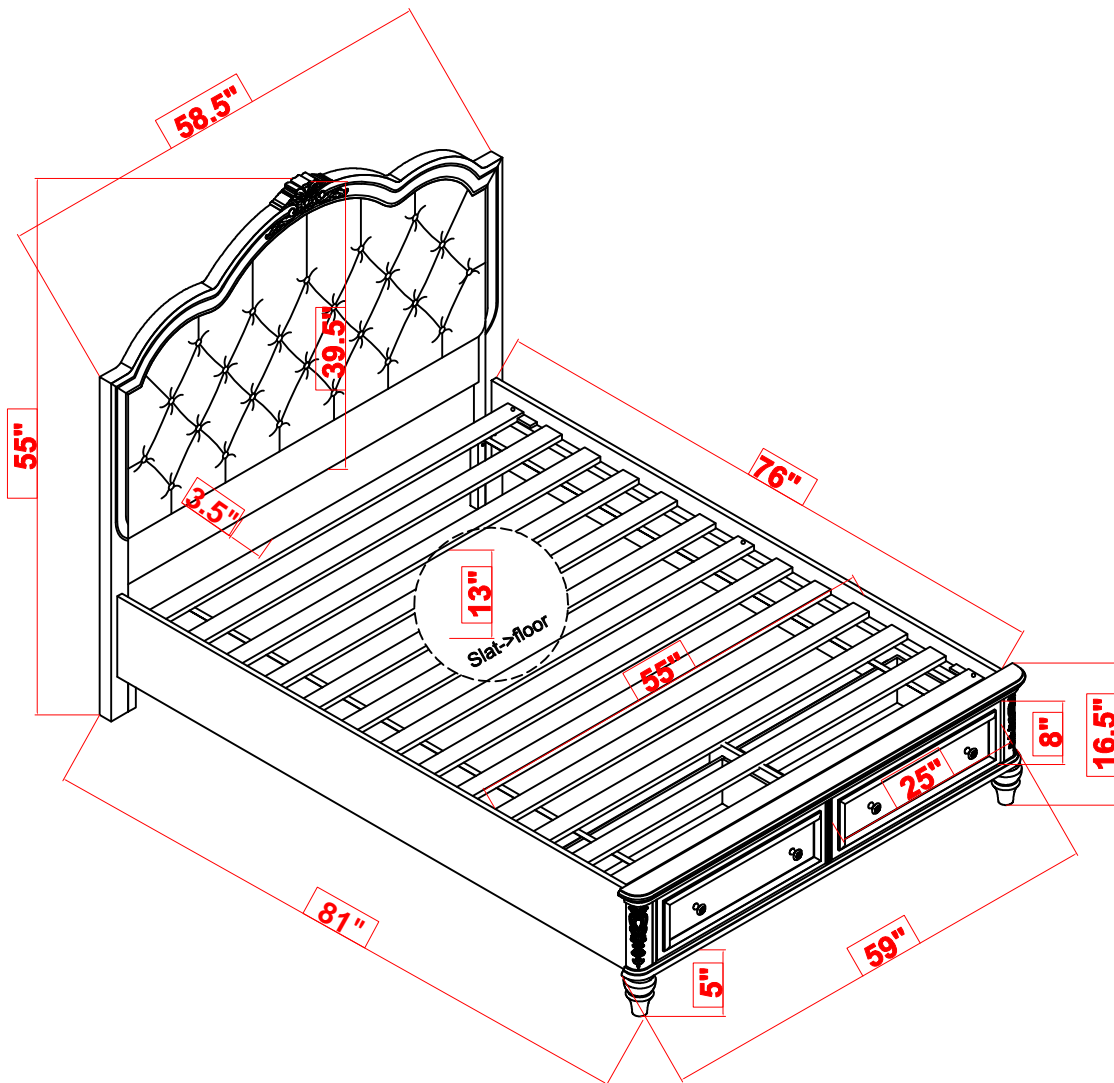

Note : Dimension tolerance $\pm 5\%$