



*ASSEMBLY INSTRUCTIONS
COASTER FINE FURNITURE*



Fine Furniture for every stage of life

**601741P
POWER MOTION SOFA
WITH DROP DOWN TABLE**

REVISION 1:08/21/2018
REVISION 2:07/09/2019
REVISION 3:01/03/2020
REVISION 4:09/14/2020

COASTERFURNITURE.COM

ITEM: 601741P
ASSEMBLY INSTRUCTIONS



ASSEMBLY TIPS:

1. Remove hardware from box and sort by size.
2. Please check to see that all hardware and parts are present prior to start of assembly.
3. Please follow attached instructions in the same sequence as numbered to assure fast & easy assembly.



WARNING!

1. Don't attempt to repair or modify parts that are broken or defective. Please contact the store immediately.
2. This product is for home use only and not intended for commercial establishments.

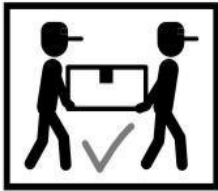

ASSEMBLY TIME PER UNIT 20 MINUTES

PARTS IDENTIFICATION

A		BASE	1 PC
B		LEFT BACK	1 PC
C		MIDDLE BACK	1 PC
D		RIGHT BACK	1 PC
E		POWER CABLE	1 PC

ITEM: 601741P
ASSEMBLY INSTRUCTIONS



STEP1

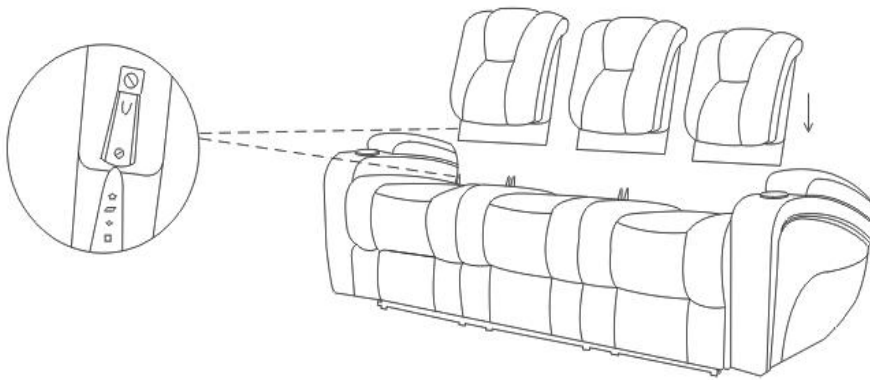

STEP2

TO OPERATE CENTER CONSOLE READING LIGHT, FIRST SELECT IF YOU PREFER TO USE THE LEFT OR RIGHT CUP HOLDER AS THE SWITCH.

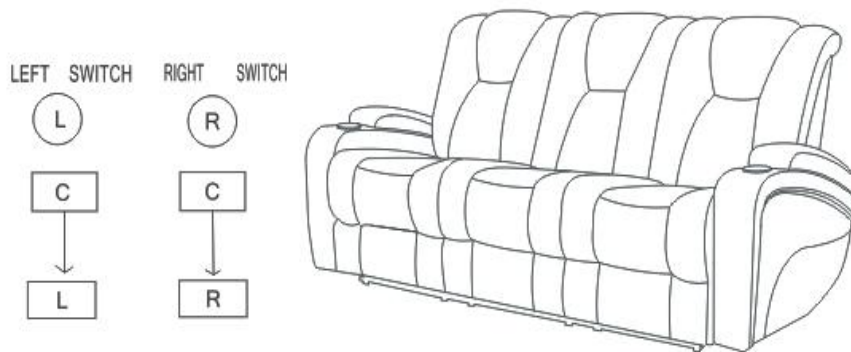

STEP3

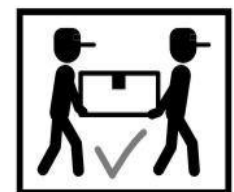
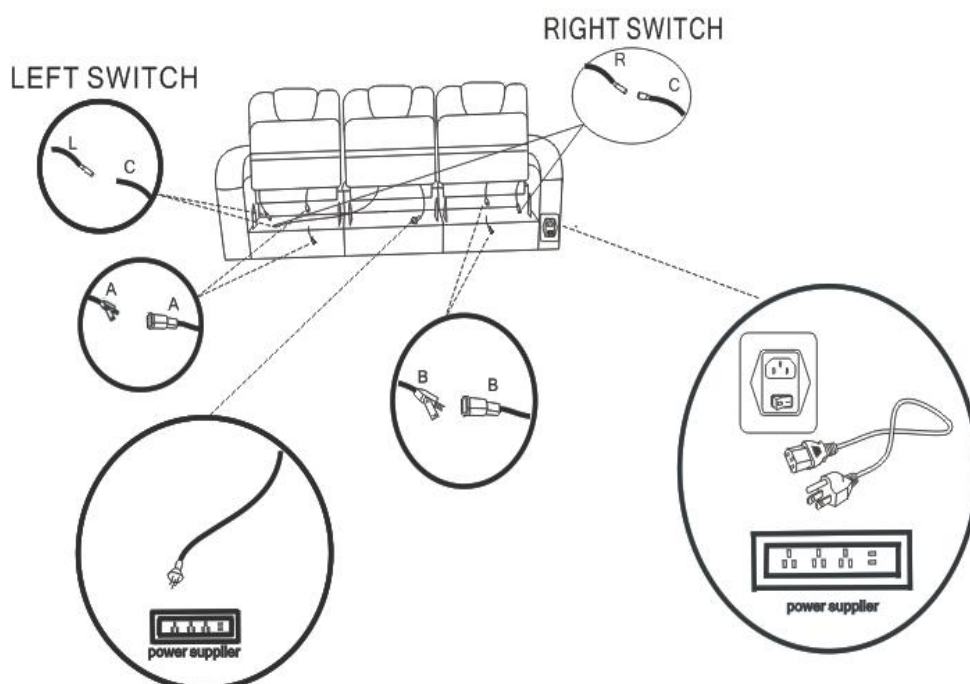

ITEM: 601741P
ASSEMBLY INSTRUCTIONS



SHOW1

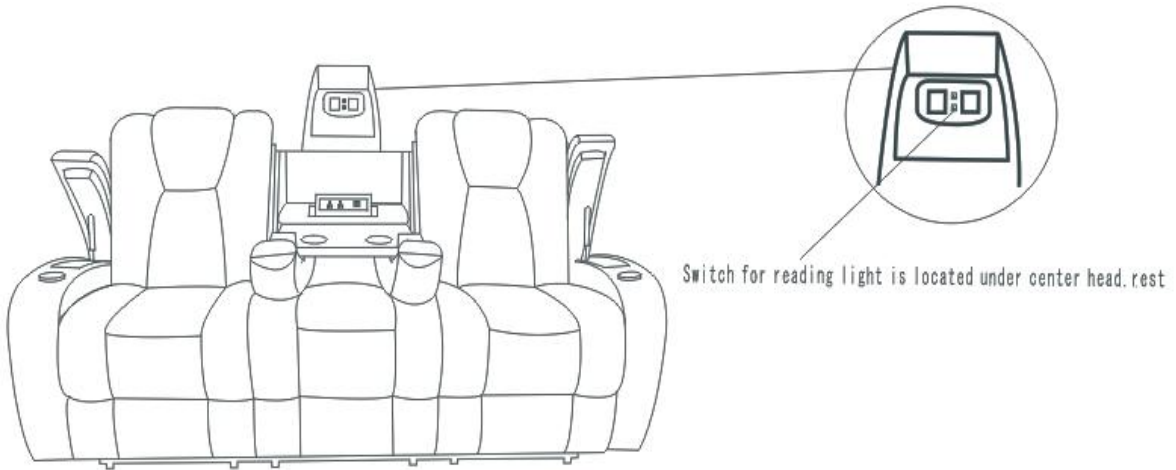

SHOW2

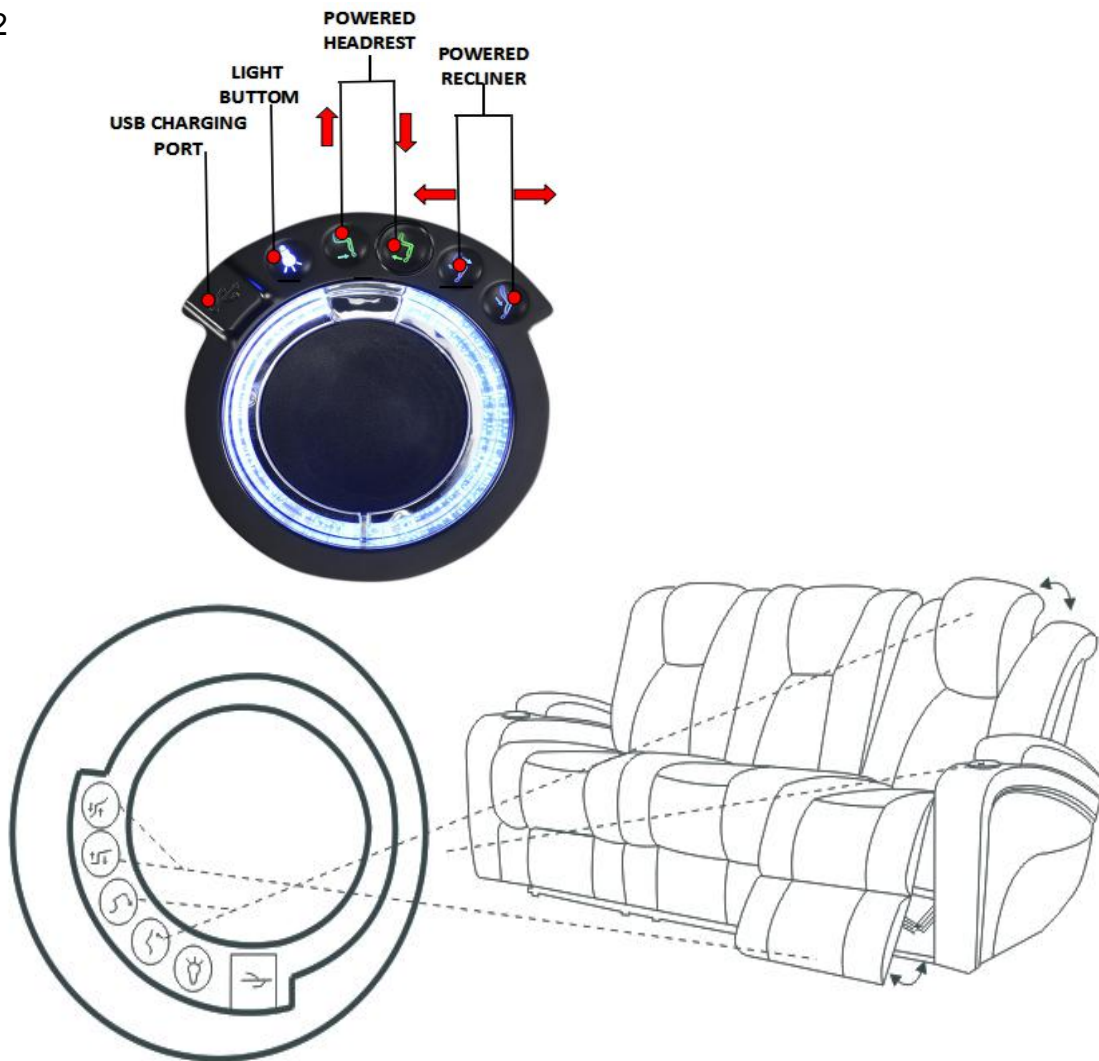

ITEM: 601741P



Note : Dimension tolerance $\pm 5\%$