

ASSEMBLY INSTRUCTIONS
COASTER FINE FURNITURE



Fine Furniture for every stage of life

183516
BAR TABLE

ITEM:183516



ASSEMBLY INSTRUCTIONS

ASSEMBLY TIPS:

1. Remove hardware from box and sort by size.
2. Please check to see that all hardware and parts are present prior to start of assembly.
3. Please follow attached instructions in the same sequence as numbered to assure fast & easy assembly.



WARNING!

1. Don't attempt to repair or modify parts that are broken or defective. Please contact the store immediately.
2. This product is for home use only and not intended for commercial establishments.

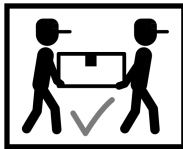

ASSEMBLY TIME 35 MINUTES

PARTS IDENTIFICATION

A TOP

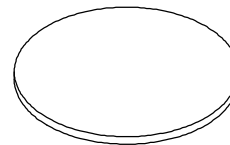

1PC

B CENTER LEG FRAME



1PC

C SIDE LEG FRAME



2PCS

D LEG FRAME SUPPORT

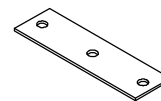

1PC

Z

HARDWARE IDENTIFICATION

1 BOLT
(1/4" x 12mm SR)



3PCS

2 LONG BOLT
(1/4" x 25mm SR)



6PCS

3 CAP
(20 x 40mm BLK)



4PCS

4 LEVELER
(1/4" x 15mm BLK)



4PCS

5 ALLEN WRENCH
(4mm)



1PC

ITEM:183516

ASSEMBLY INSTRUCTIONS



STEP 1 Do not tighten until each step is completed or instructed.

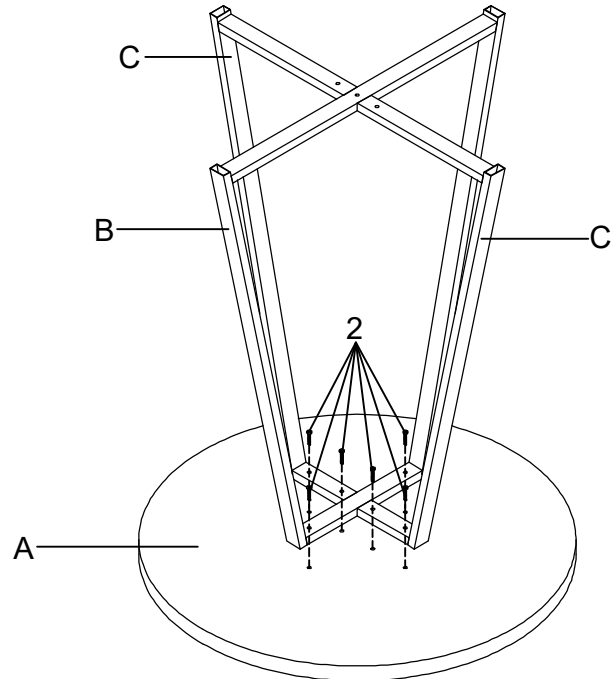

STEP 2

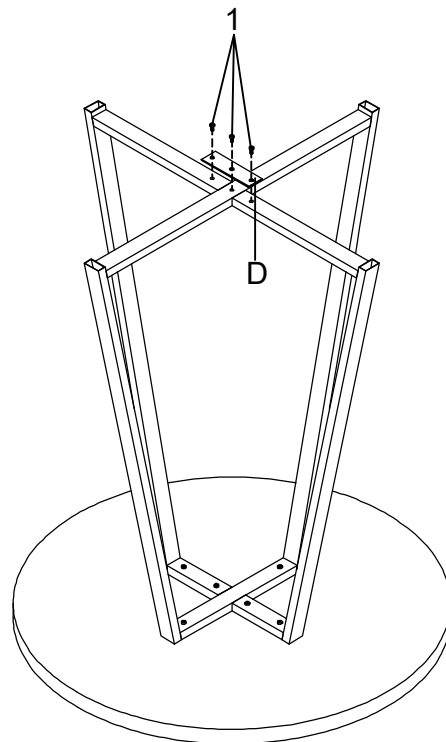

ITEM:183516

ASSEMBLY INSTRUCTIONS

STEP 3

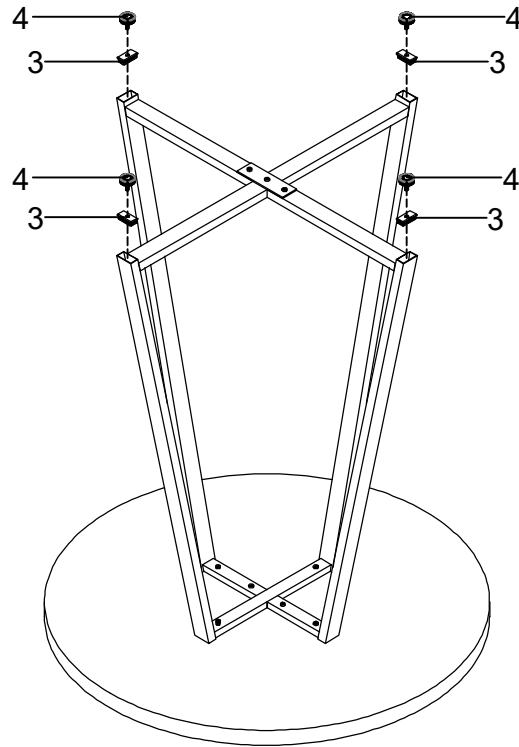

STEP 4 COMPLETE

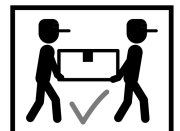
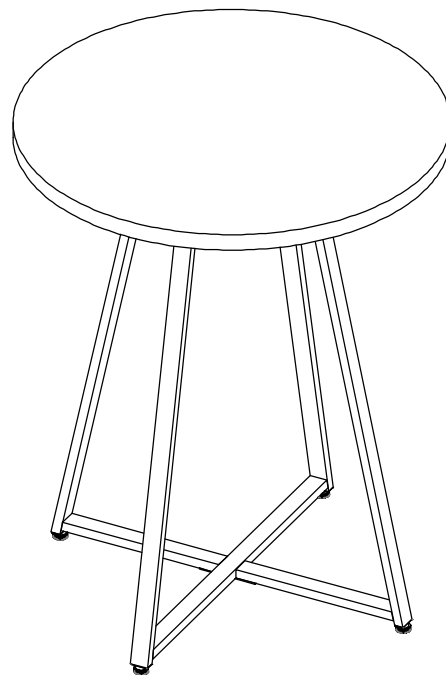

ITEM:183516 ASSEMBLY INSTRUCTIONS



Product Size : 895 DIA X 1086 H (MM)
Product Size : 35.25" DIA X 42.75"

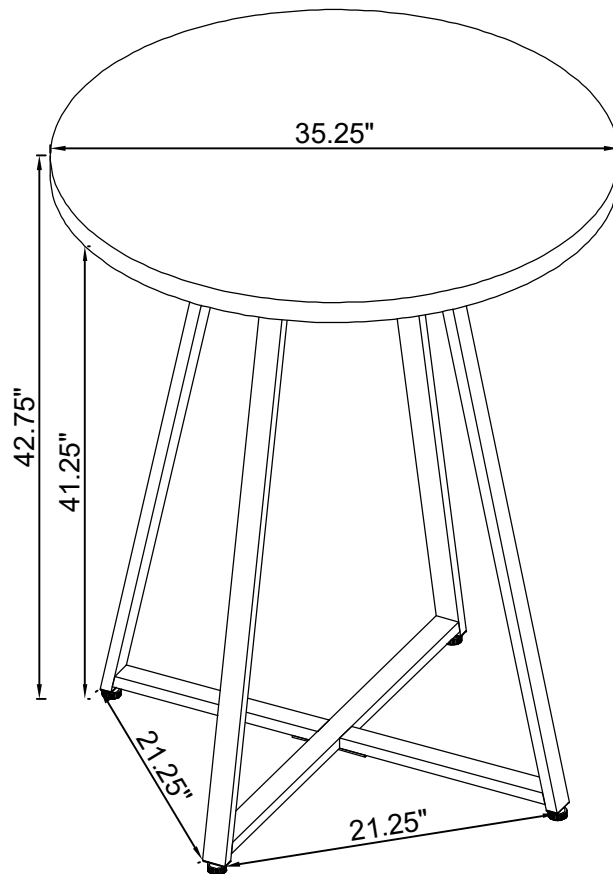

Note : Dimension tolerance $\pm 5\%$