

ASSEMBLY INSTRUCTIONS
COASTER FINE FURNITURE

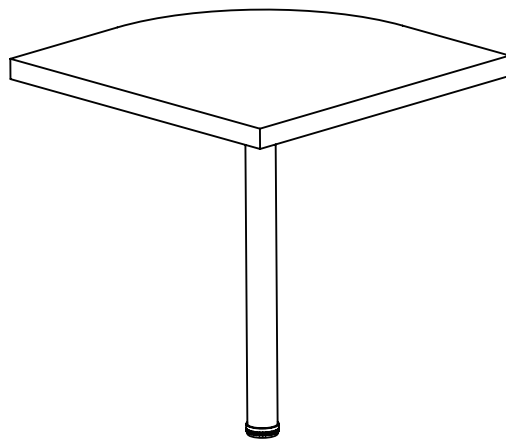

Fine Furniture for every stage of life

800893
CORNER TABLE

ITEM:800893

ASSEMBLY INSTRUCTIONS

ASSEMBLY TIPS:

1. Remove hardware from box and sort by size.
2. Please check to see that all hardware and parts are present prior to start of assembly.
3. Please follow attached instructions in the same sequence as numbered to assure fast & easy assembly.



WARNING!

1. Don't attempt to repair or modify parts that are broken or defective. Please contact the store immediately.
2. This product is for home use only and not intended for commercial establishments.

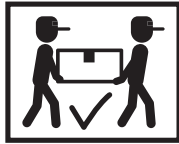

ASSEMBLY TIME

15 MINUTES

PARTS IDENTIFICATION

A

TOP PANEL

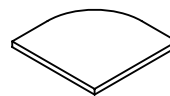

1 PC

HARDWARE IDENTIFICATION

Z

NO

DESCRIPTION

FIGURE

Q'TY

1

LEG PLATE
BLK



1 PC

2

METAL PLATE
BLK



4 PCS

3

IRON PIPE
Ø 60x734mm SR

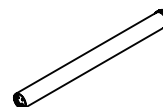

1 PC

4

BOLT
M 8x39mm BLK



1 PC

5

SCREW
Ø 4x16mm RBW



20 PCS

Z1,Z2,Z3 not included in blister packaging.

NOTE:

Phillips head screw driver is required in the assembly process; however, manufacturer does not provide this item.

ITEM: **800893**

STEP 1

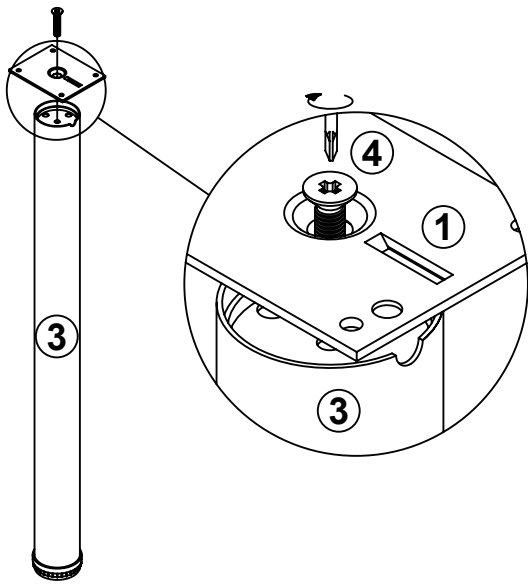

STEP 2

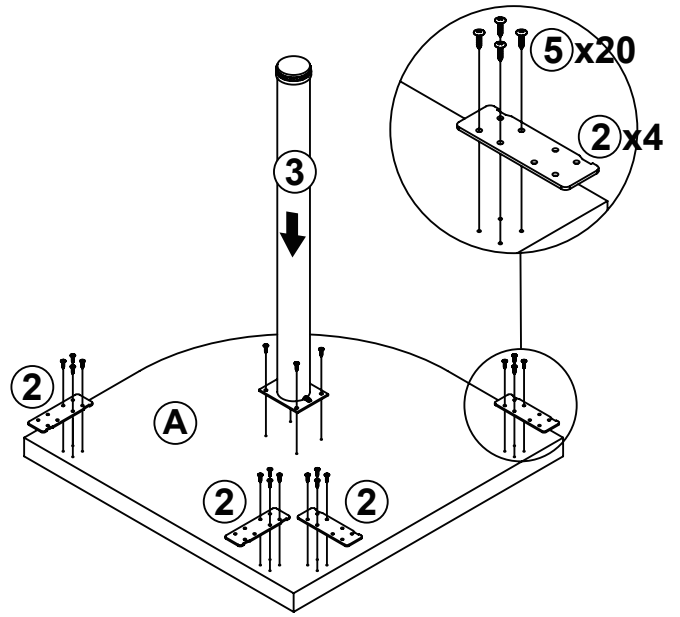

STEP 3

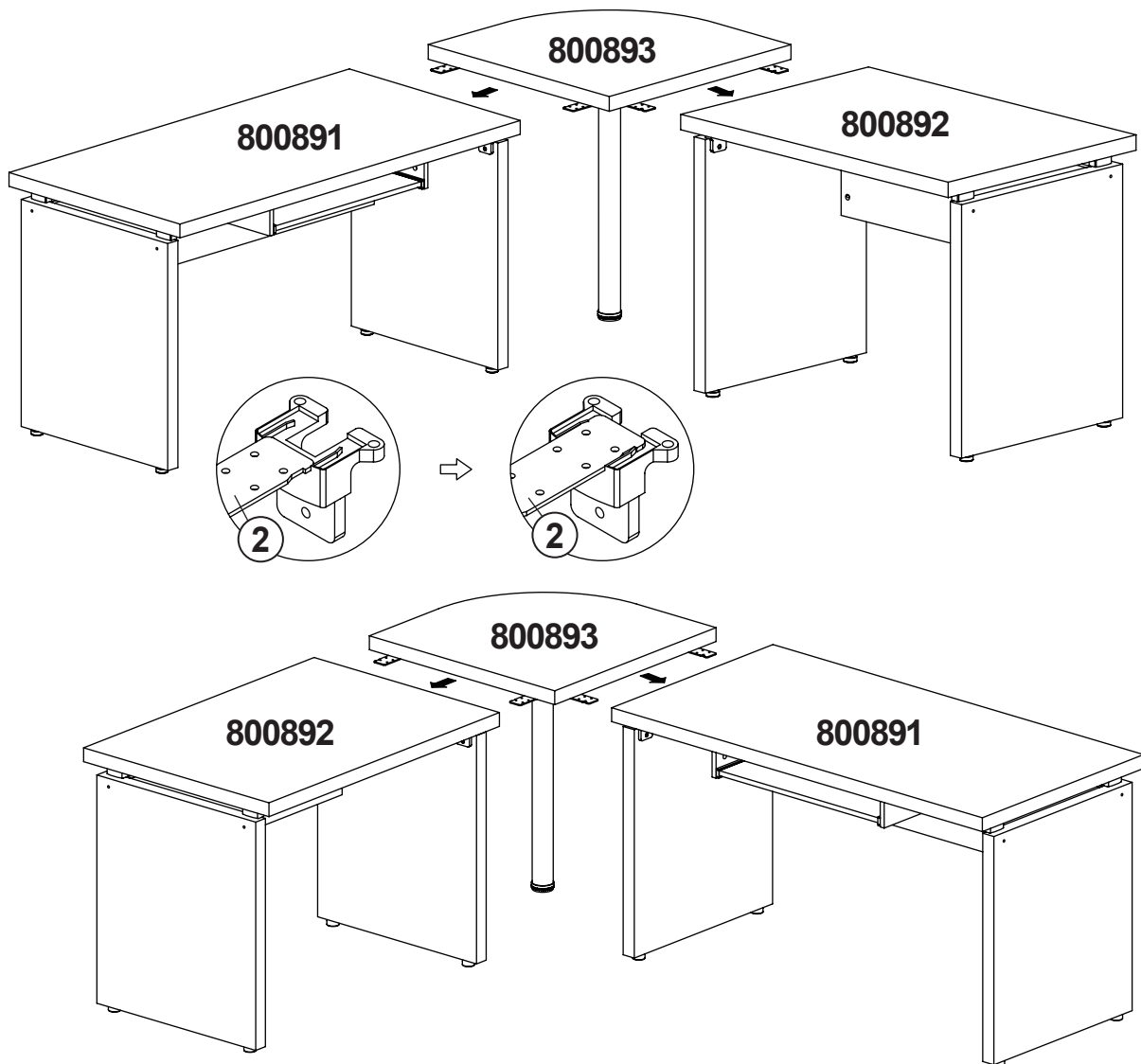

ITEM: 800893

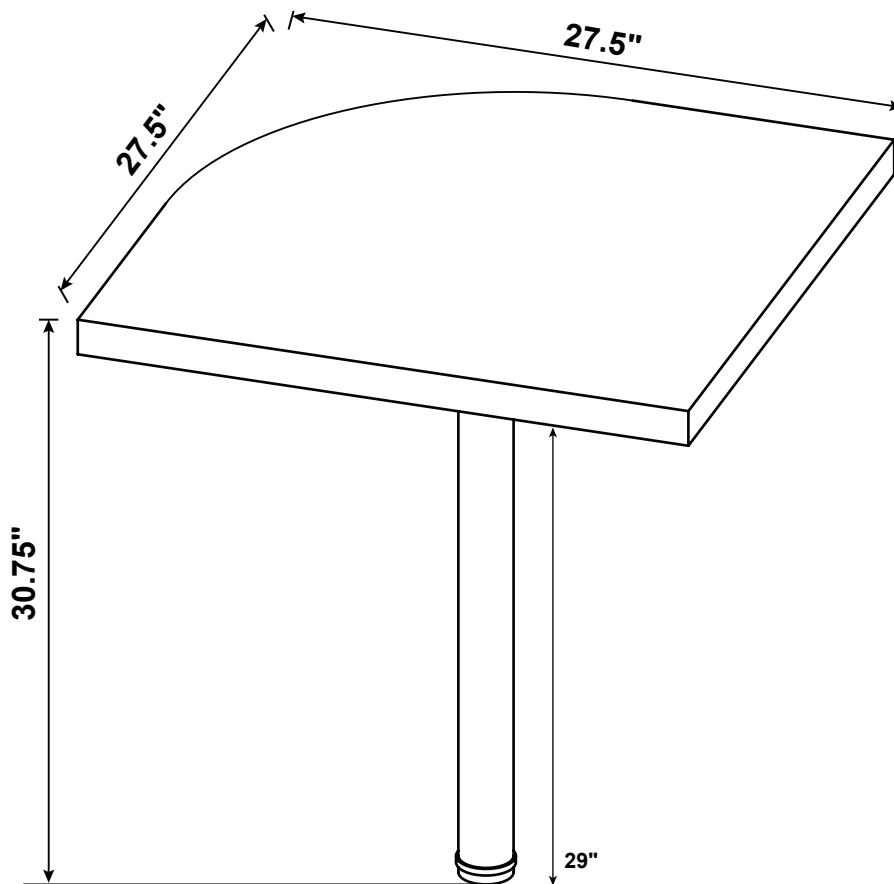

Note : Dimension tolerance $\pm 5\%$