

ASSEMBLY INSTRUCTIONS
COASTER FINE FURNITURE

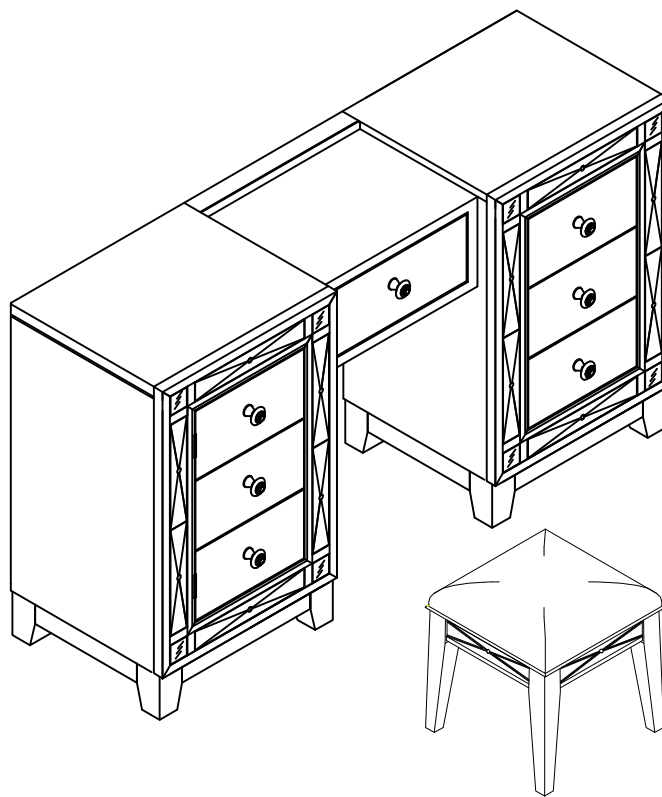

Fine Furniture for every stage of life

204927
Vanity Desk & Stool

REVISION 0 : 06/15/2016
REVISION 1 : 08/05/2019
REVISION 2 : 29/11/2019
REVISION 3 : 09/17/2020

ITEM:204927



ASSEMBLY INSTRUCTIONS

ASSEMBLY TIPS:

- 1.Remove hardware from box and sort by size
- 2.Please check to see that all hardware and parts are present prior to start of assembly.
- 3.Please follow attached instruction in the same sequence as numbered to assure fast & easy assembly.



WARNING!

- 1.Don't attempt to repair or modify parts that are broken or defective. Please contact the store immediately.
- 2.This product is for home use only and not intended for commercial establishments.

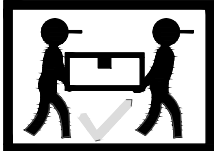

ASSEMBLY TIME

20 MINUTES

PARTS IDENTIFICATION

AN DESK

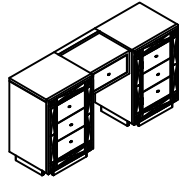

1PC

BN DESK LEG



8PCS

CN STOOL TOP

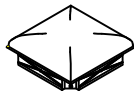

1PC

DN STOOL LEG



4PCS

HARDWARE IDENTIFICATION

1 BOLT
(1/4" x 50mm- RBW)



24PCS

2 LOCK WASHER
(1/4" - RBW)



24PCS

3 FLAT WASHER
(1/4" - RBW)



24PCS

4 ALLEN WRENCH
(4MM - RBW)



1PC

NOTE:

Phillips head screw driver is required in the assembly process; however, manufacturer does not provide this item .

ITEM: 204927
ASSEMBLY INSTRUCTIONS
STEP 1

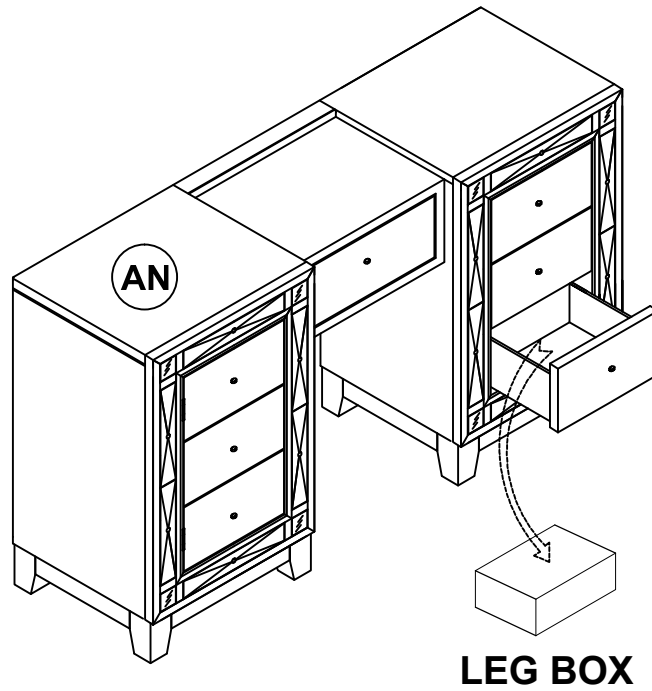

STEP 2

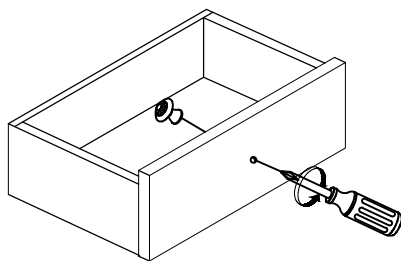

STEP 3

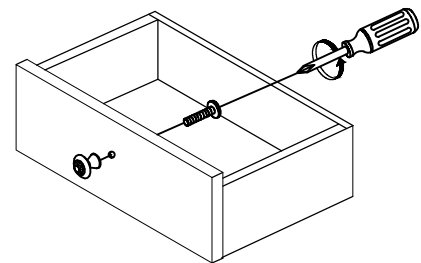

ITEM: 204927

ASSEMBLY INSTRUCTIONS

STEP 4

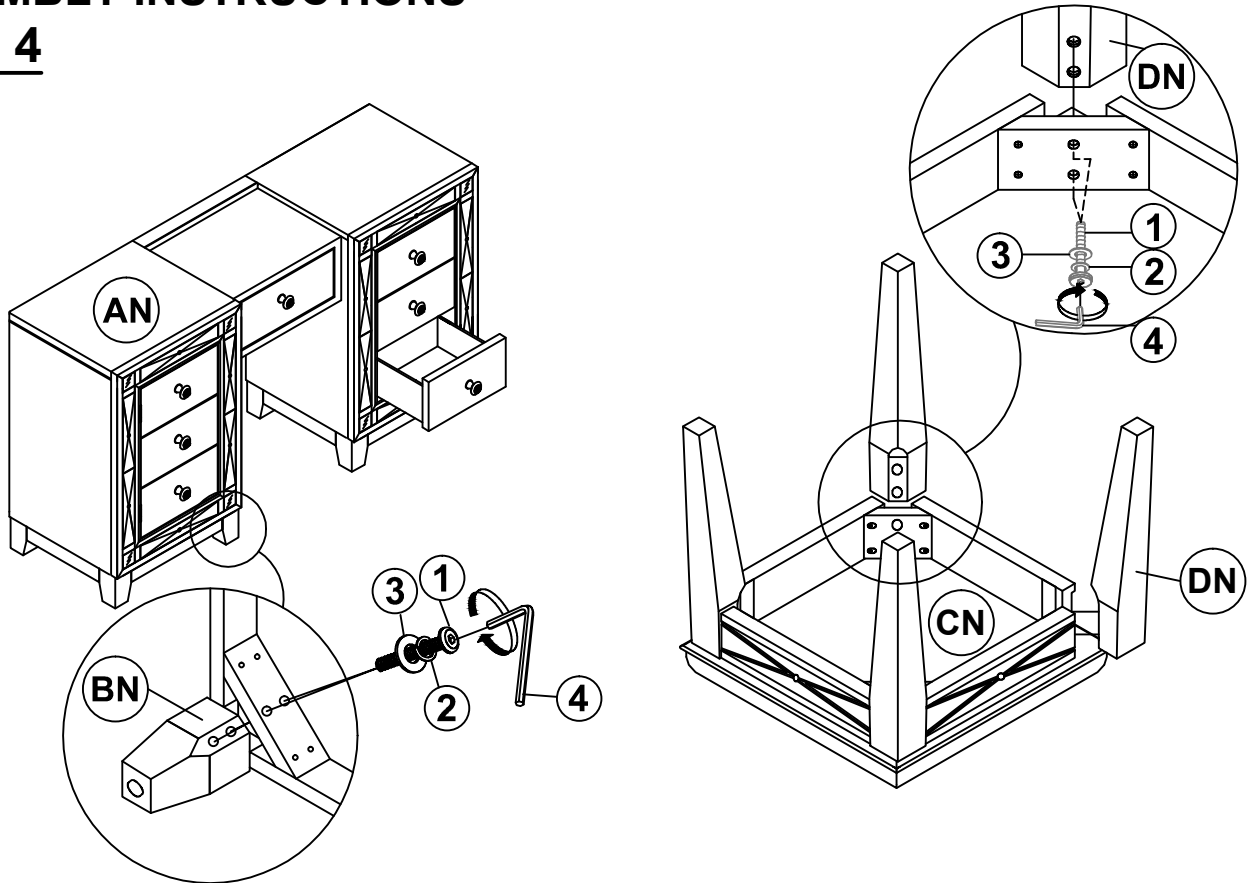

STEP 5 COMPLETE

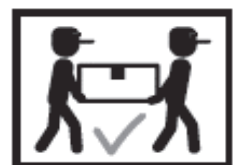
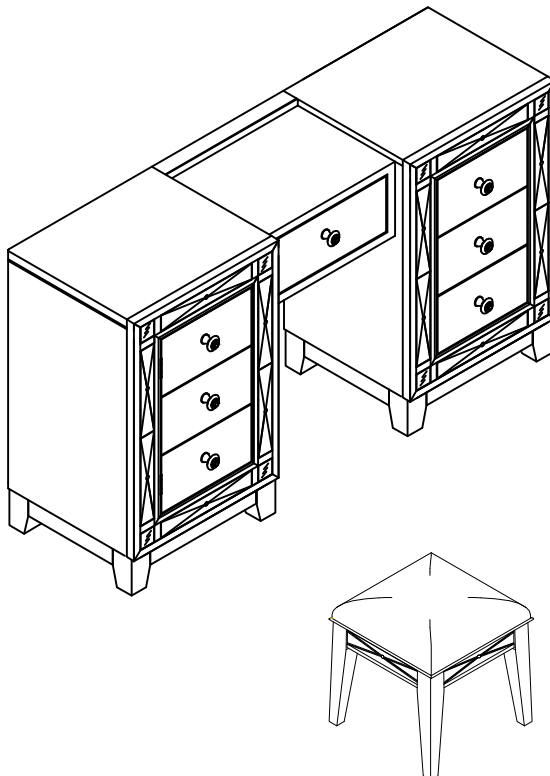

ITEM:204927



Inner Size of Drawer A : 9.25"W X 13.50"D X 3.75"H X 0.50"T
Inner Size of Drawer B : 17.25"W X 11.50"D X 2.75"H X 0.50"T

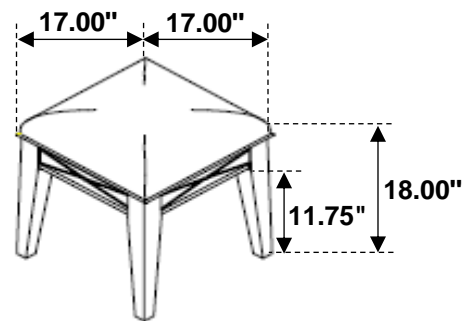
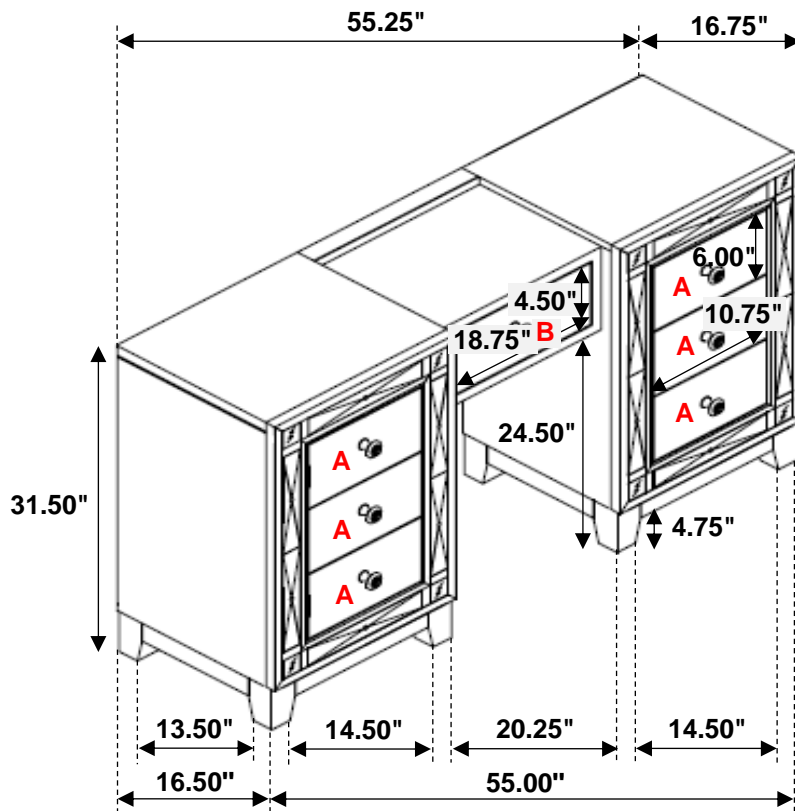

Note: Dimension tolerance $\pm 5\%$

ASSEMBLY INSTRUCTIONS
COASTER FINE FURNITURE

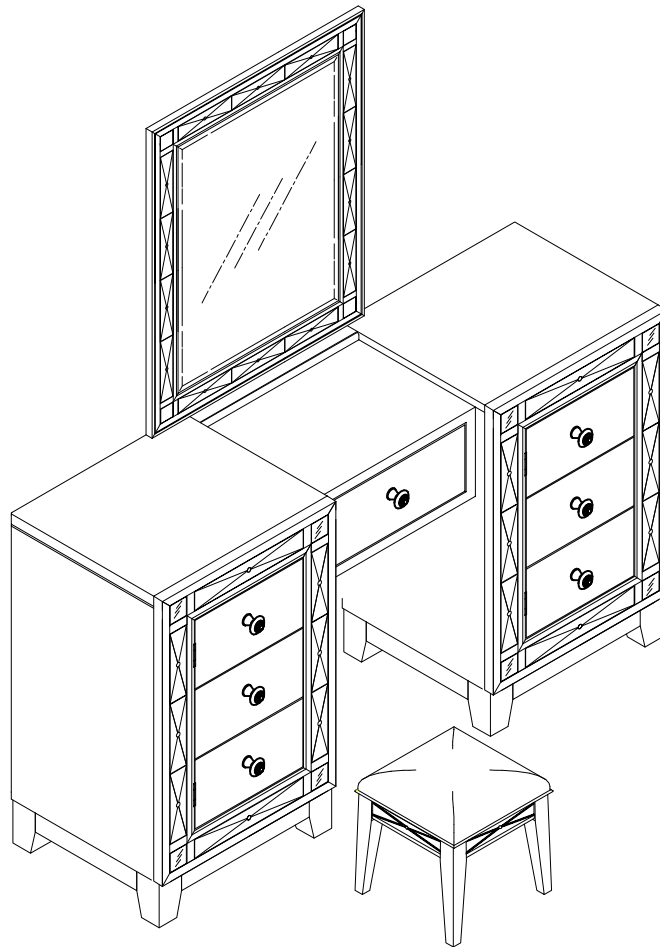

Fine Furniture for every stage of life

204928
Vanity Desk Mirror

ITEM:204928



ASSEMBLY INSTRUCTIONS

ASSEMBLY TIPS:

- 1.Remove hardware from box and sort by size
- 2.Please check to see that all hardware and parts are present prior to start of assembly.
- 3.Please follow attached instruction in the same sequence as numbered to assure fast & easy assembly.



WARNING!

- 1.Don't attempt to repair or modify parts that are broken or defective. Please contact the store immediately.
- 2.This product is for home use only and not intended for commercial establishments.



ASSEMBLY TIME

10 MINUTES

PARTS IDENTIFICATION

AN VANITY MIRROR



1PC

BN DESK & STOOL
FROM BOX
ITEM# 204927

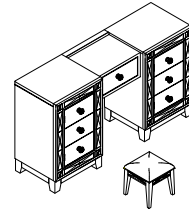

1PC

CN MIRROR SUPPORT
(PACKED WITH DESK)



2PCS

HARDWARE IDENTIFICATION

1 BOLT
(1/4" x 38mm - RBW)

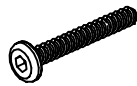

6PCS

2 LOCK WASHER
(1/4" - RBW)



6PCS

3 FLAT WASHER
(1/4" - RBW)



6PCS

4 ALLEN WRENCH
(4MM - RBW)



1PC

ITEM: **204928**

ASSEMBLY INSTRUCTIONS

STEP 1

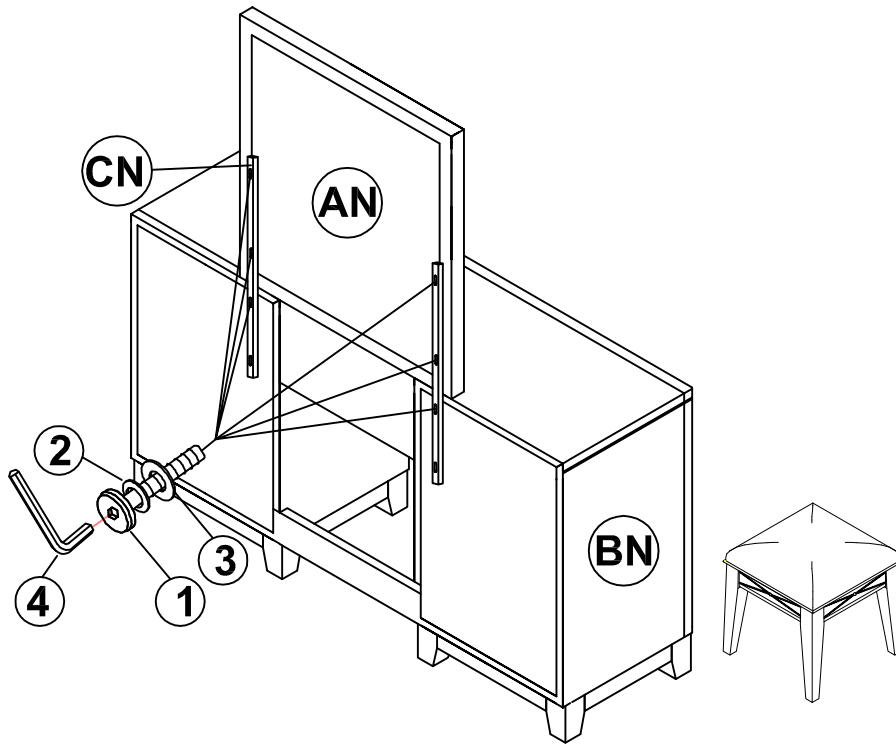

STEP 2
COMPLETE

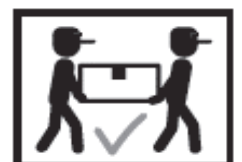
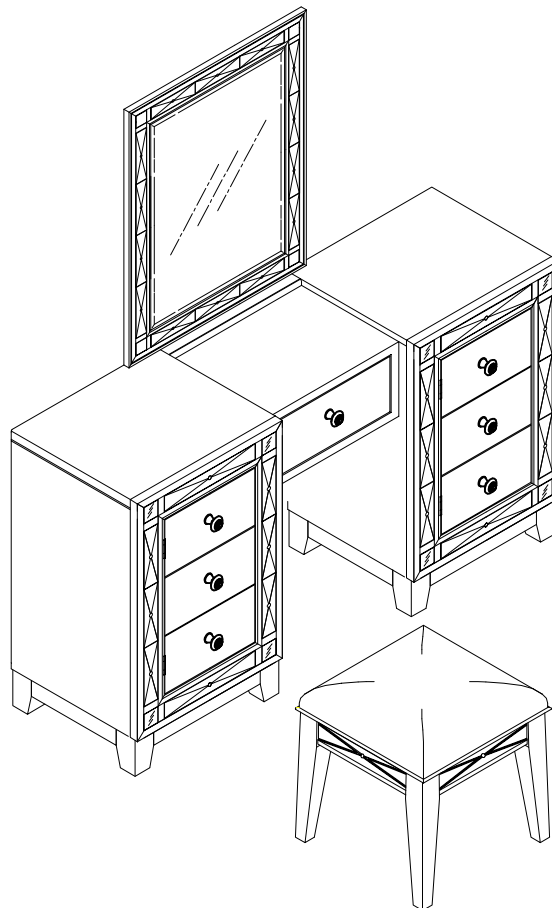

ITEM:204928

COASTER
FINE FURNITURE

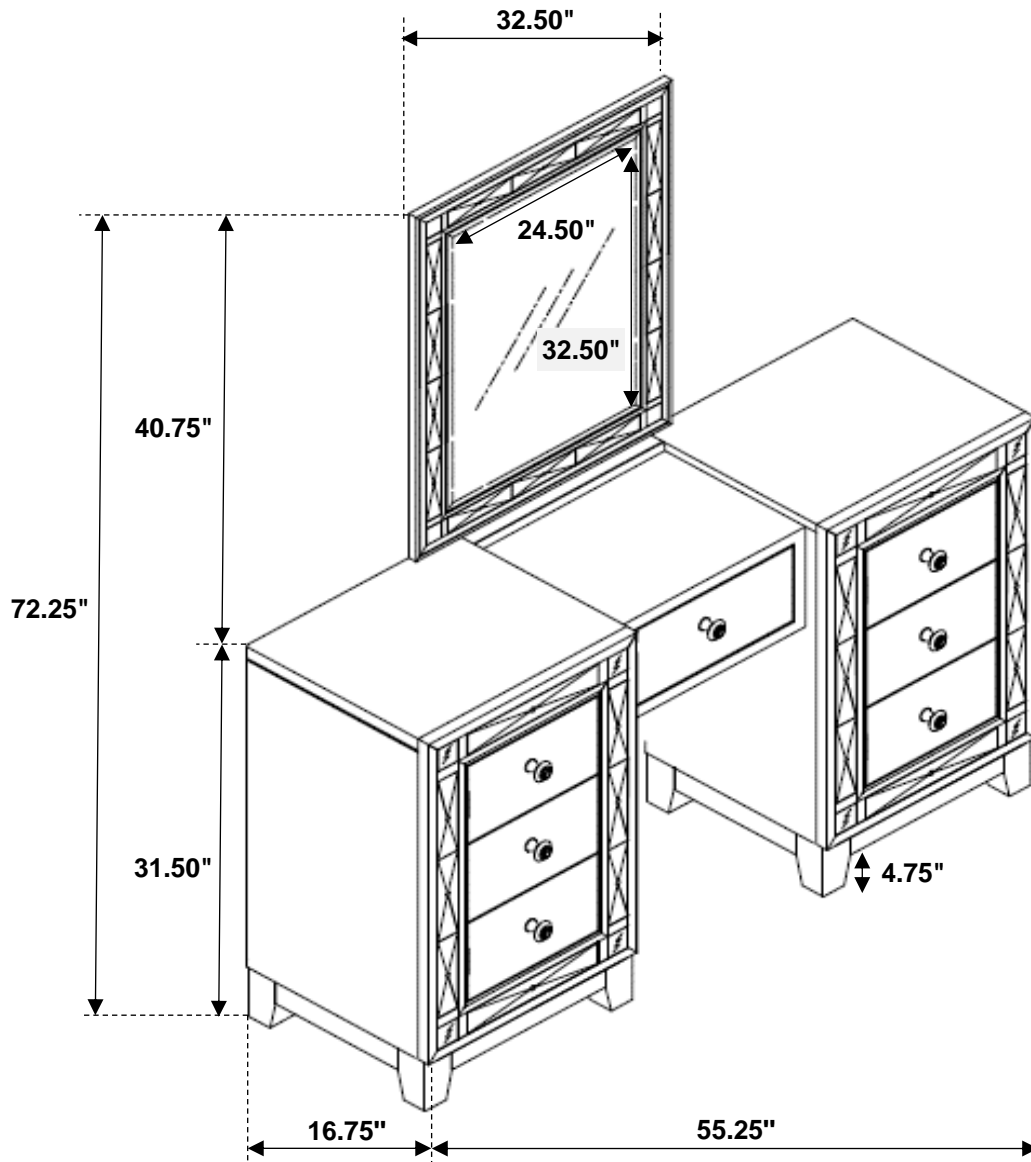

Note: Dimension tolerance $\pm 5\%$