

ASSEMBLY INSTRUCTIONS
COASTER FINE FURNITURE

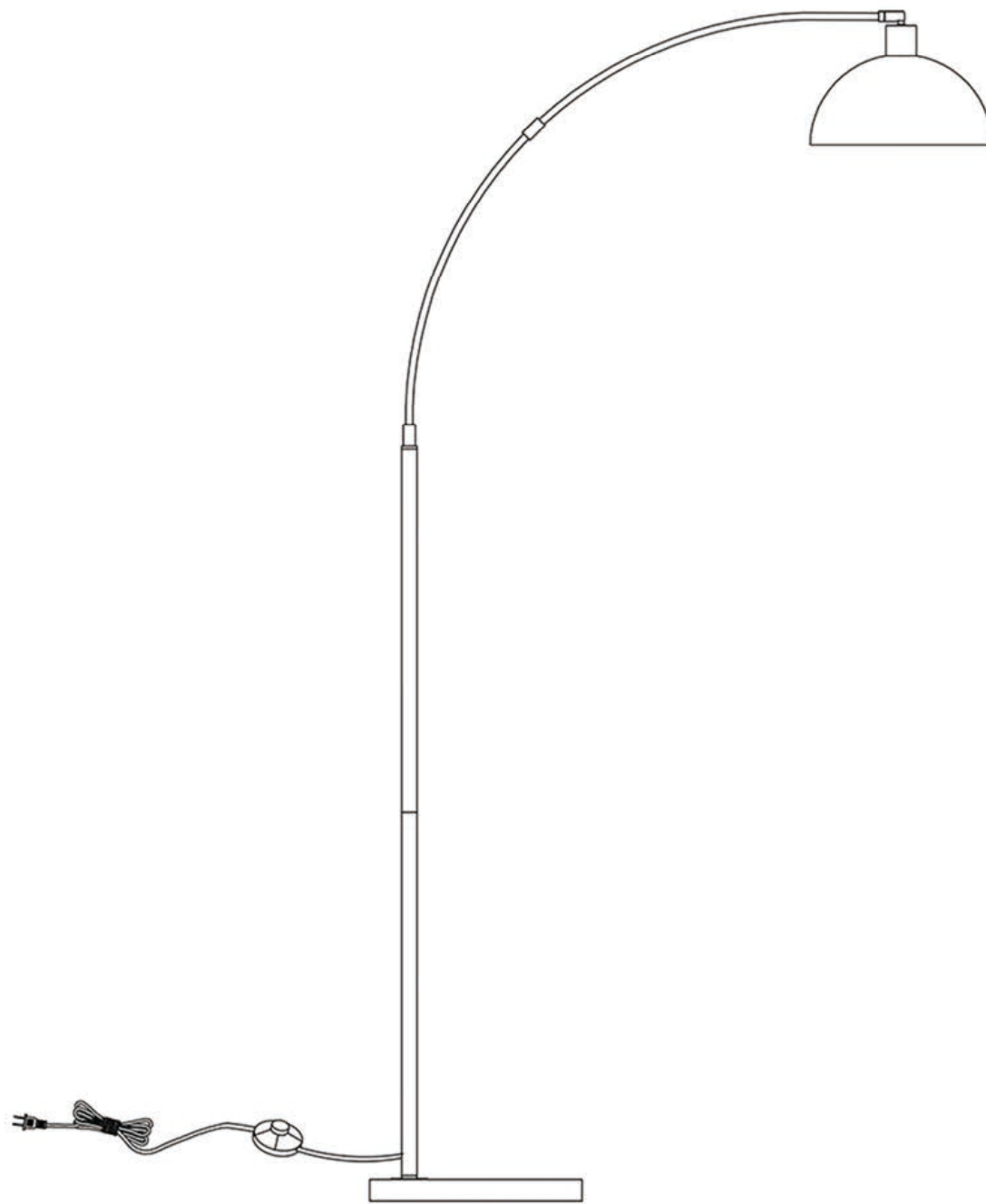

Fine Furniture for every stage of life





REVISION 0: 5/29/2024

920059
FLOOR LAMP



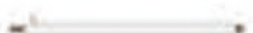

ITEM: 920059



PARTS IDENTIFICATION

A ARM 1		1PC
B ARM 2		1PC
C TUBE 1		1PC
D TUBE 2		1PC
E BASE		1PC
F SHADE		1PC

HARDWARE IDENTIFICATION

1 WRENCH		1PC	3 BIG WASHER		5 NUT	
2 ALLEN KEY		1PC	4 SMALL WASHER			

As a safety feature, and to reduce the risk of electric shock, this portable lamp includes a polarized plug (one blade is wider than the other).

The plug will fit into a polarized outlet in a single direction only.

If the plug does not fit fully in the outlet, reverse the plug and try again.

If it still does not fit, contact a qualified electrician. DO NOT use with an extension cord unless, can be fully inserted. DO NOT alter the plug

FLOOR LAMP:MAX 60 WATT TYPE "A" BULB OR MAX 13 WATT SBCFL BULB

PARTS IDENTIFICATION

STEP-1

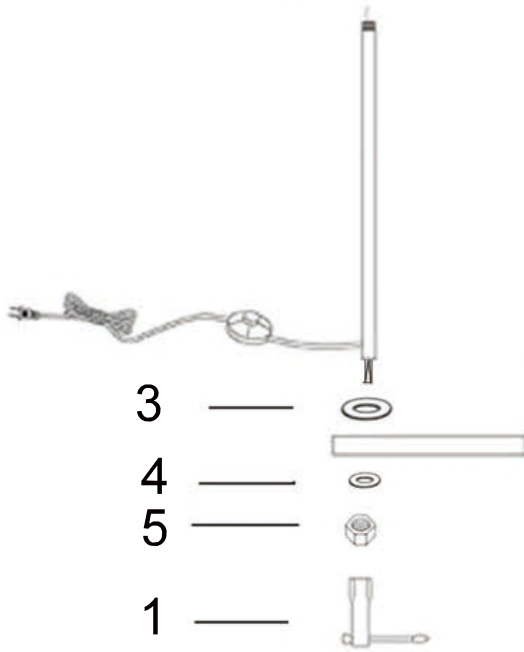

STEP-2

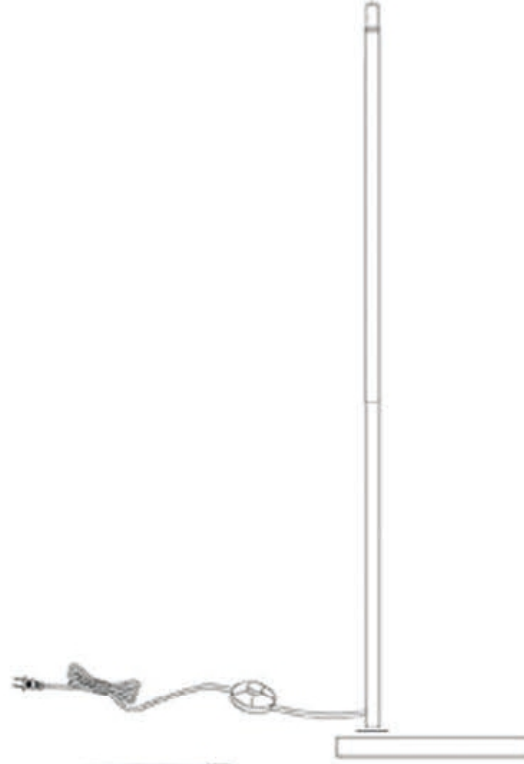

STEP-3

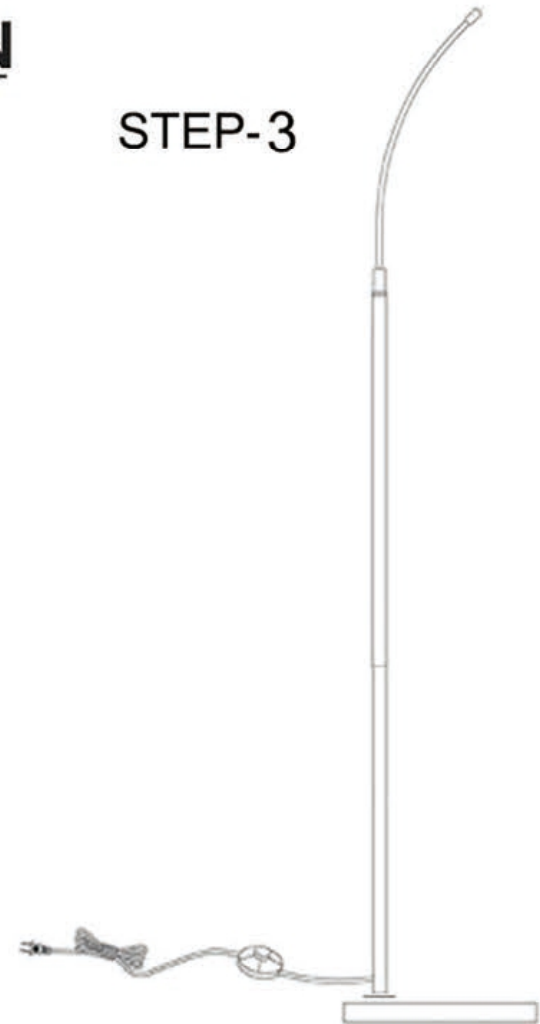

STEP-4

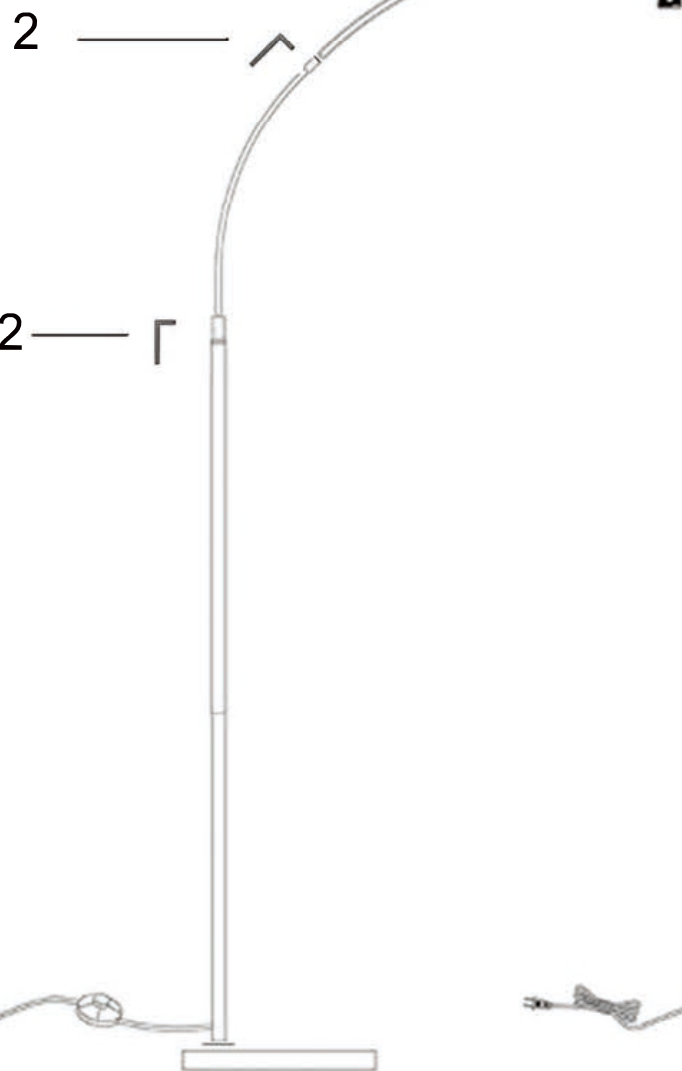

STEP-5

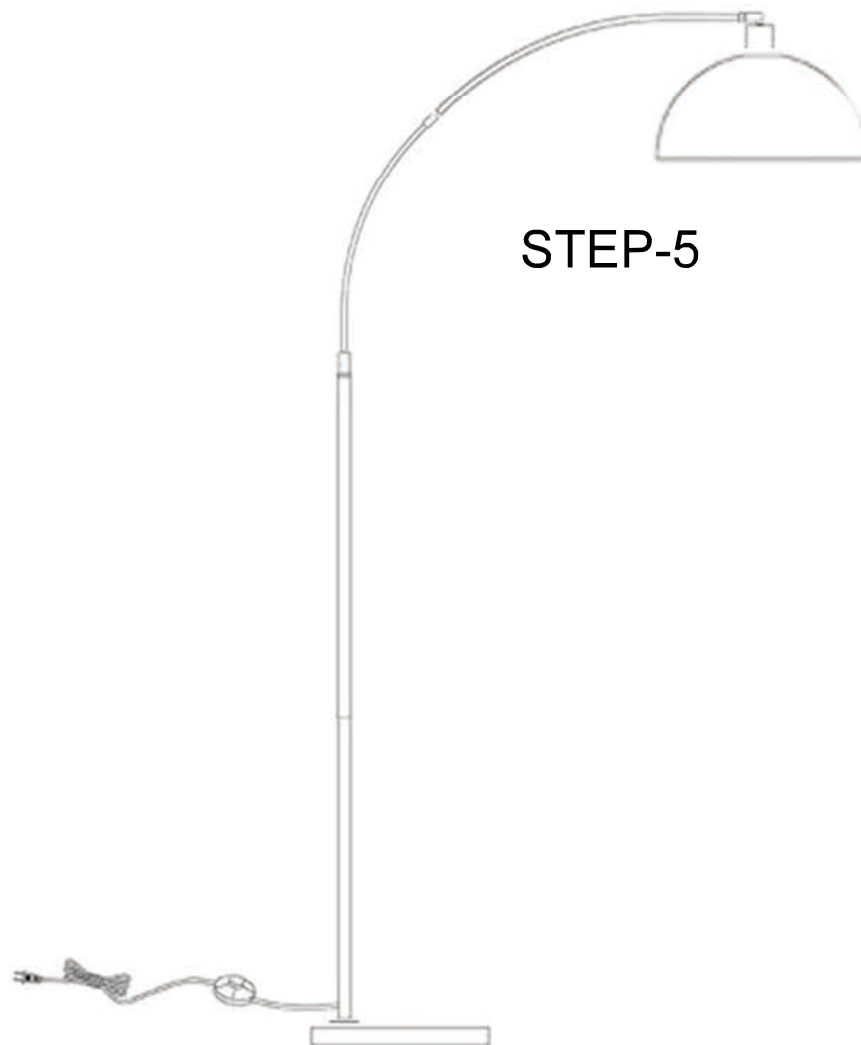

As a safety feature, and to reduce the risk of electric shock, this portable lamp includes a polarized plug (one blade is wider than the other). The plug will fit into a polarized outlet in a single direction only. If the plug does not fit fully in the outlet, reverse the plug and try again. If it still does not fit, contact a qualified electrician. DO NOT use with an extension cord unless, can be fully inserted. DO NOT alter the plug.

ITEM: 920059

PRODUCT/PART DIMENSIONS

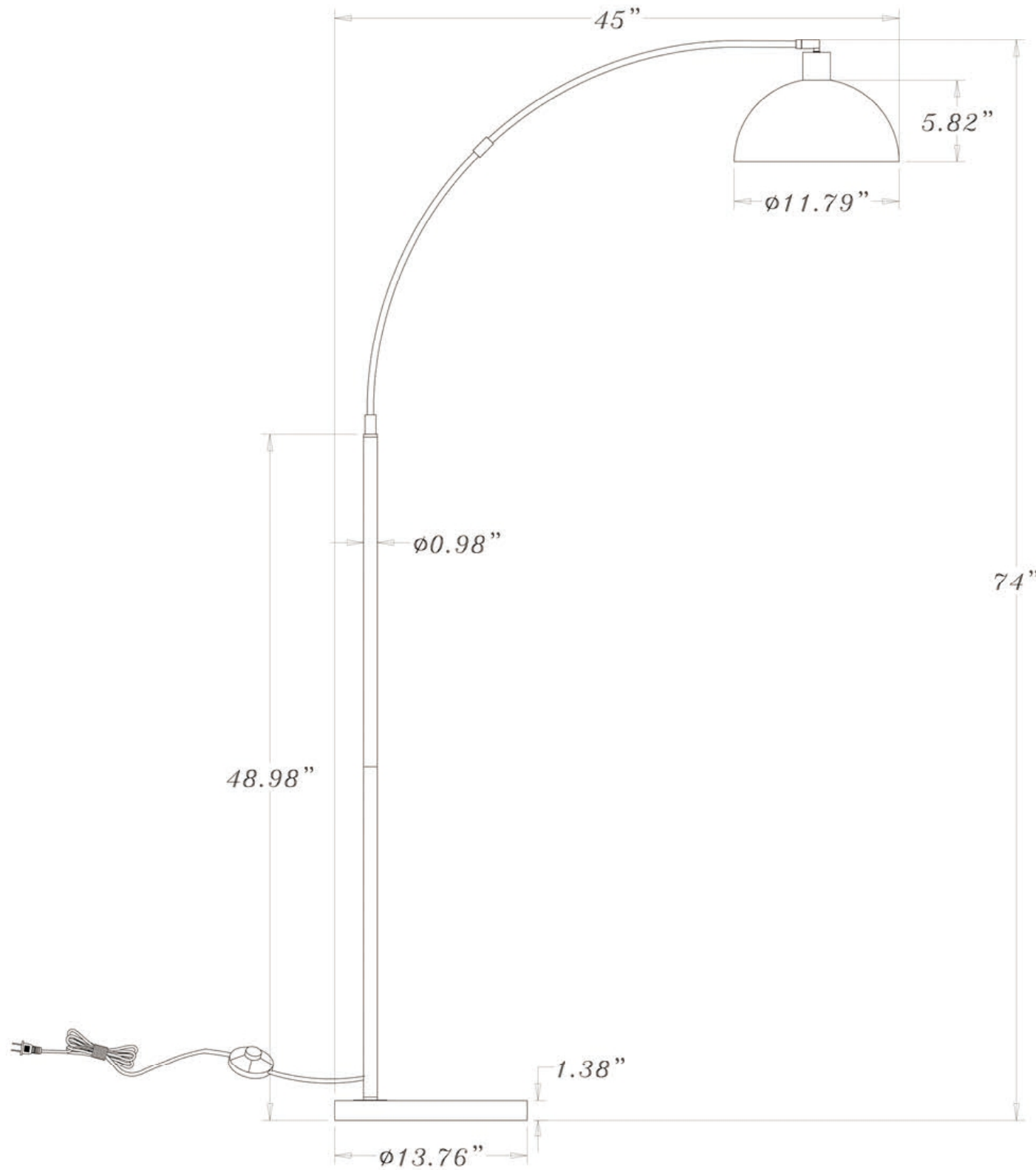

As a safety feature, and to reduce the risk of electric shock, this portable lamp includes a polarized plug (one blade is wider than the other).

The plug will fit into a polarized outlet in a single direction only.

If the plug does not fit fully in the outlet, reverse the plug and try again.

If it still does not fit, contact a qualified electrician. DO NOT use with an extension cord unless, can be fully inserted. DO NOT alter the plug

FLOOR LAMP:MAX 60 WATT TYPE "A" BULB OR MAX 13 WATT SBCFL BULB