

ASSEMBLY INSTRUCTIONS
COASTER FINE FURNITURE

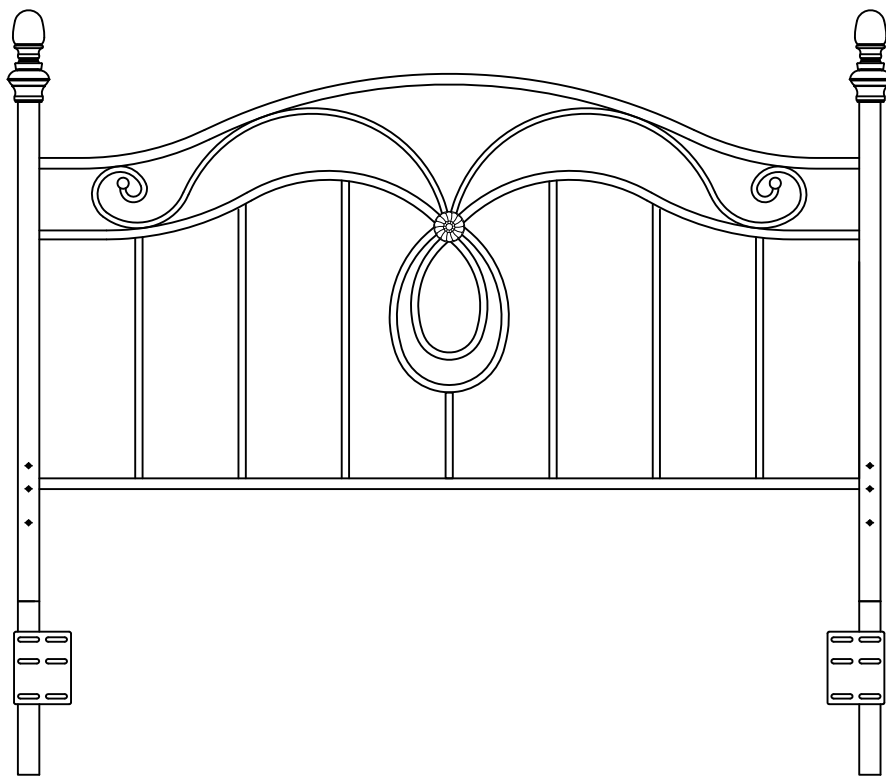

Fine Furniture for every stage of life

300197Q

Queen / Full Headboard

ITEM:300197Q



ASSEMBLY INSTRUCTIONS

ASSEMBLY TIPS:

1. Remove hardware from box and sort by size.
2. Please check to see that all hardware and parts are present prior to start of assembly.
3. Please follow attached instructions in the same sequence as numbered to assure fast & easy assembly.



WARNING !

1. Don't attempt to repair or modify parts that are broken or defective. Please contact the store immediately.
2. This product is for home use only and not intended for commercial establishment.



ASSEMBLY TIME

15 MINUTE

PARTS IDENTIFICATION

A HEADBOARD		1PC	C FINIAL		2PCS
B EXTENSION LEG		2PCS	D ADJUSTING PLATE		2PCS

HARDWARE IDENTIFICATION

1	BOLT (1/4"x2-1/4" - BLK)		4PCS	5	NUT (φ1/4" - BLK)		8PCS
2	BOLT (1/4"x7/8" - BLK)		4PCS	6	ALLEN KEY (4x22X60mm - BLK)		1PC
3	WASHER (φ16mm - BLK)		12PCS	7	WRENCH (11.3x12.5X55mm - WHT)		1PC
4	PLASTIC WASHER (φ25mm - BLK)		8PCS	8	PLASTIC END CAP (φ1-1/2" - BLK)		2PCS

NOTE:

Phillips head screw driver is required in the assembly process; however, manufacturer does not provide this item.

ITEM: 300197Q



ASSEMBLY INSTRUCTIONS

ASSEMBLY

Do not fully tighten all bolts until assembly is complete.
This will help all parts to assemble properly.

STEP 1:

60" ASSEMBLY INSTRUCTIONS

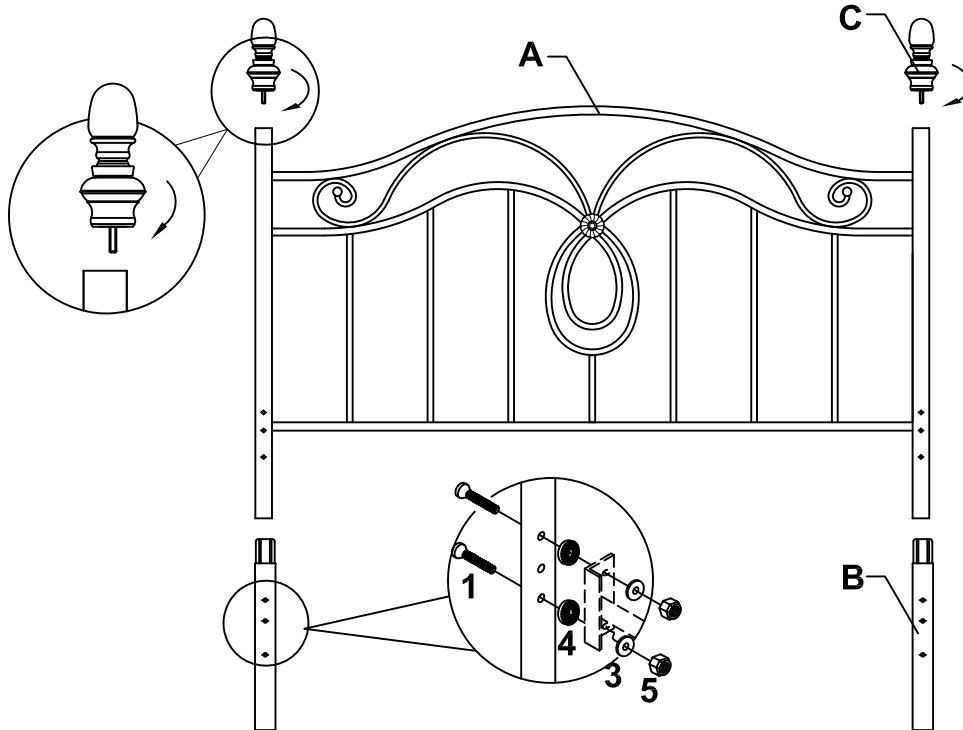

STEP 2:

54" ASSEMBLY INSTRUCTIONS

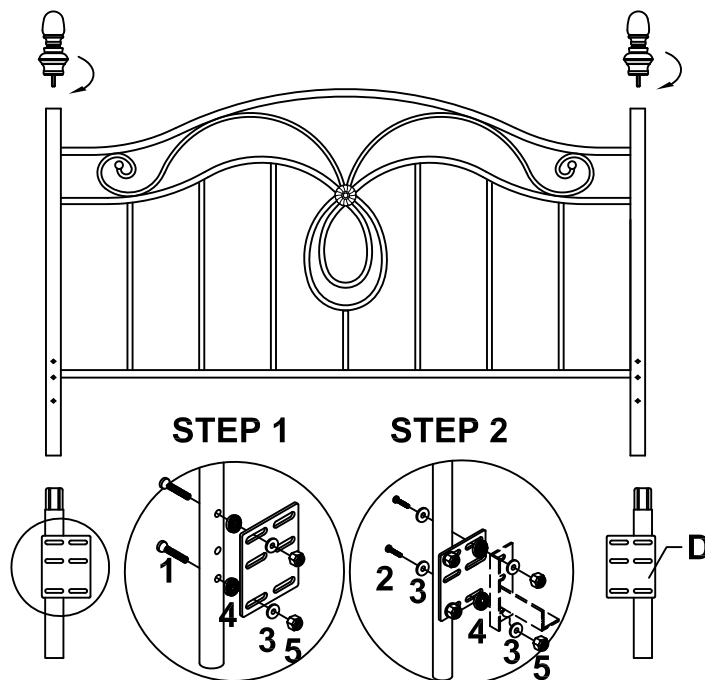

ITEM: **300197Q**

ASSEMBLY INSTRUCTIONS

STEP 3:

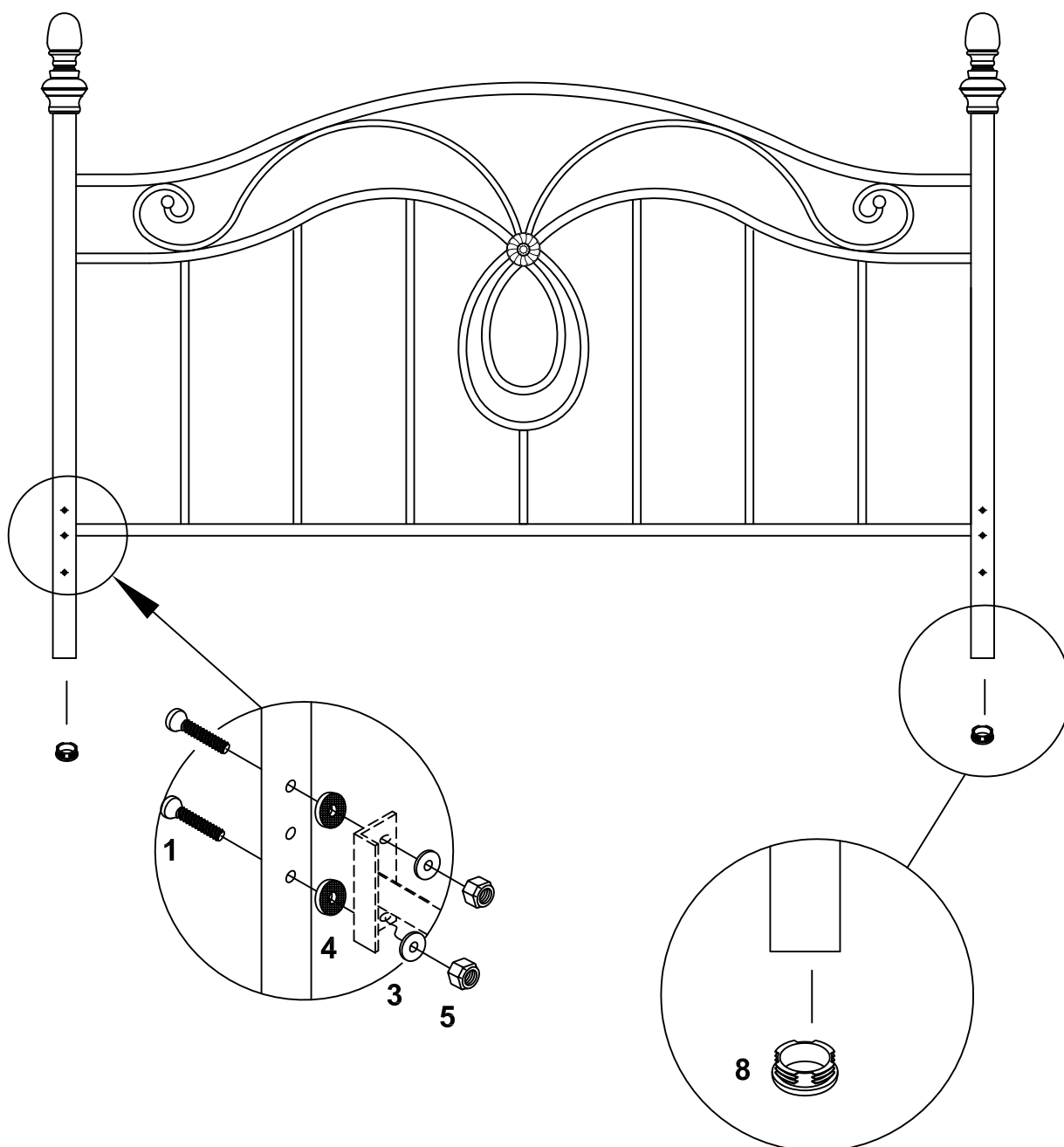

ITEM:300197Q

COASTER
FINE FURNITURE

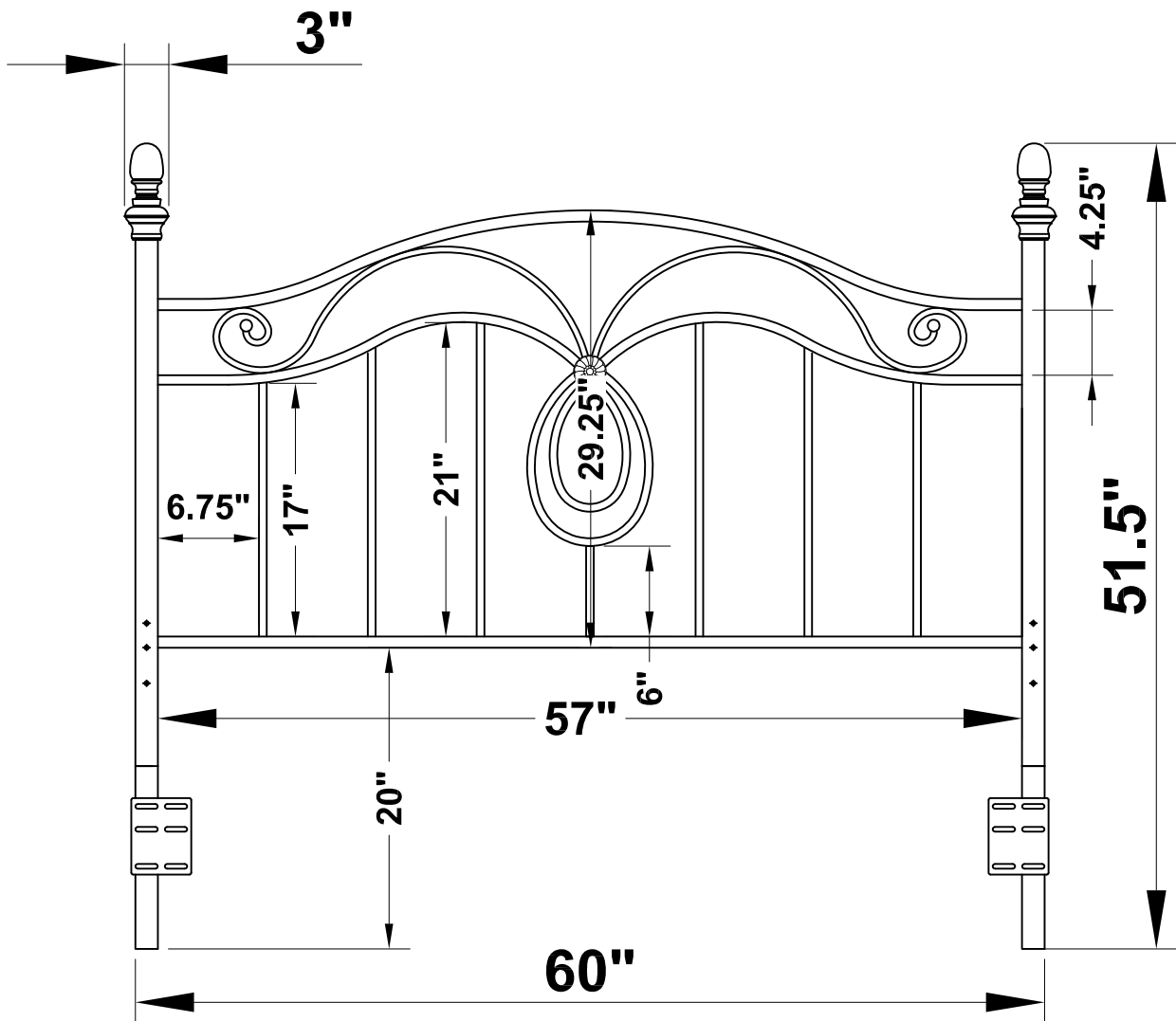

Note : Dimension tolerance $\pm 5\%$