



ASSEMBLY INSTRUCTIONS

COASTER FINE FURNITURE



Fine Furniture for every stage of life

182438(B1&B2)

Counter Height Dining Table

ITEM: 182438(B1&B2)



ASSEMBLY INSTRUCTIONS

ASSEMBLY TIPS:

1. Remove hardware from box and sort by size.
2. Please check to see that all hardware and parts are present prior to start of assembly.
3. Please follow attached instructions in the same sequence as numbered to assure fast & easy assembly.



WARNING!

1. Don't attempt to repair or modify parts that are broken or defective. Please contact the store immediately.
2. This product is for home use only and not intended for commercial establishments.



ASSEMBLY TIME

15 MINUTES

PARTS IDENTIFICATION

B1 (BOX1)

A TOP

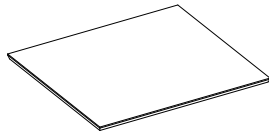

1PC

B2 (BOX2)

B LEG FRAME

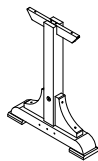

2PCS

C TRESTLE BAR



1PC

D STRETCHER

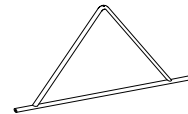

1PC

HARDWARE IDENTIFICATION

Z-B2 (BOX 2) - HARDWARE PACK IS LOCATED IN 182438 (B2)

- | | | | | | | | |
|---|---------------------------------------|--|------|---|---|--|------|
| 1 | BOLT 1
(Ø 1/4 x 30mm- BLK) | | 1PC | 4 | ALLEN WRENCH
(M4- 64mm - BLK) | | 1PC |
| 2 | BOLT 2
(Ø 1/4 x 60mm- BLK) | | 6PCS | 5 | WOOD DOWEL
(Ø 8 x 40mm) | | 4PCS |
| 3 | BOLT 3
(Ø 1/4 x 100mm- BLK) | | 2PCS | 6 | WOOD CAP
(Ø 22 x 35mm) | | 2PCS |

ITEM: 182438(B1&B2)

ASSEMBLY INSTRUCTIONS

STEP 1

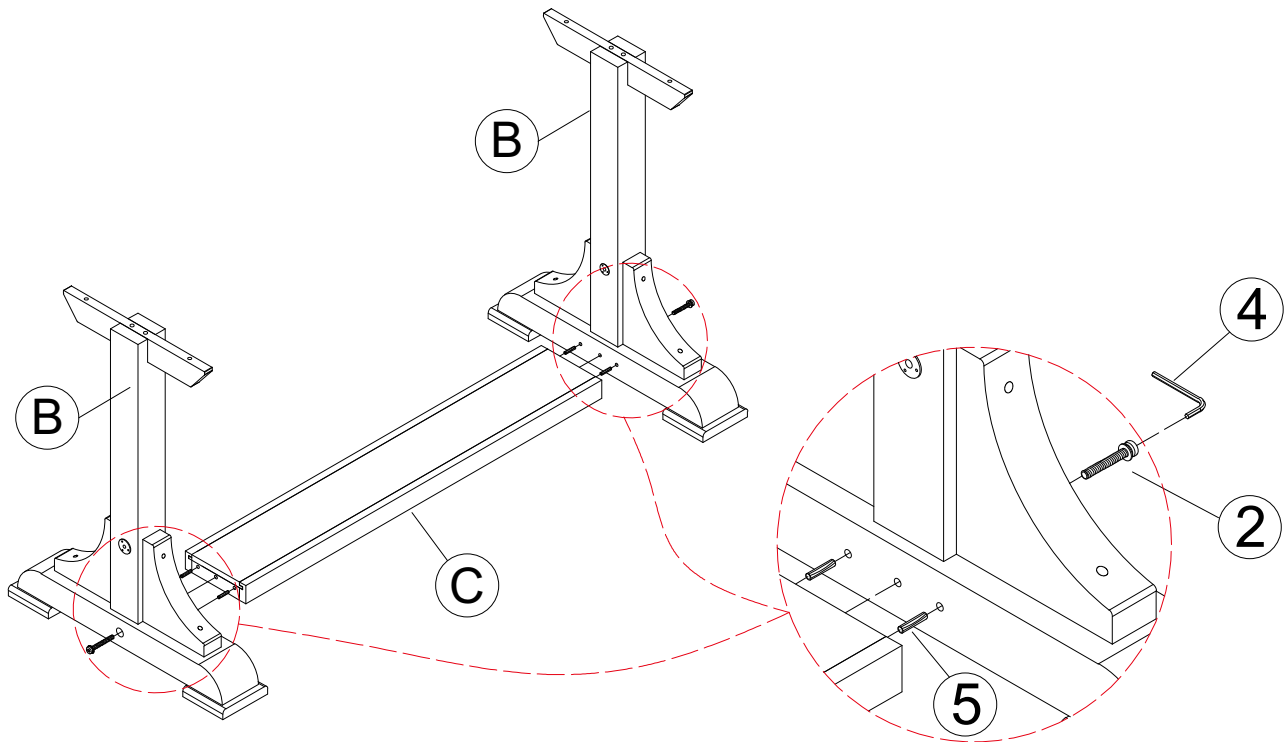

STEP 2

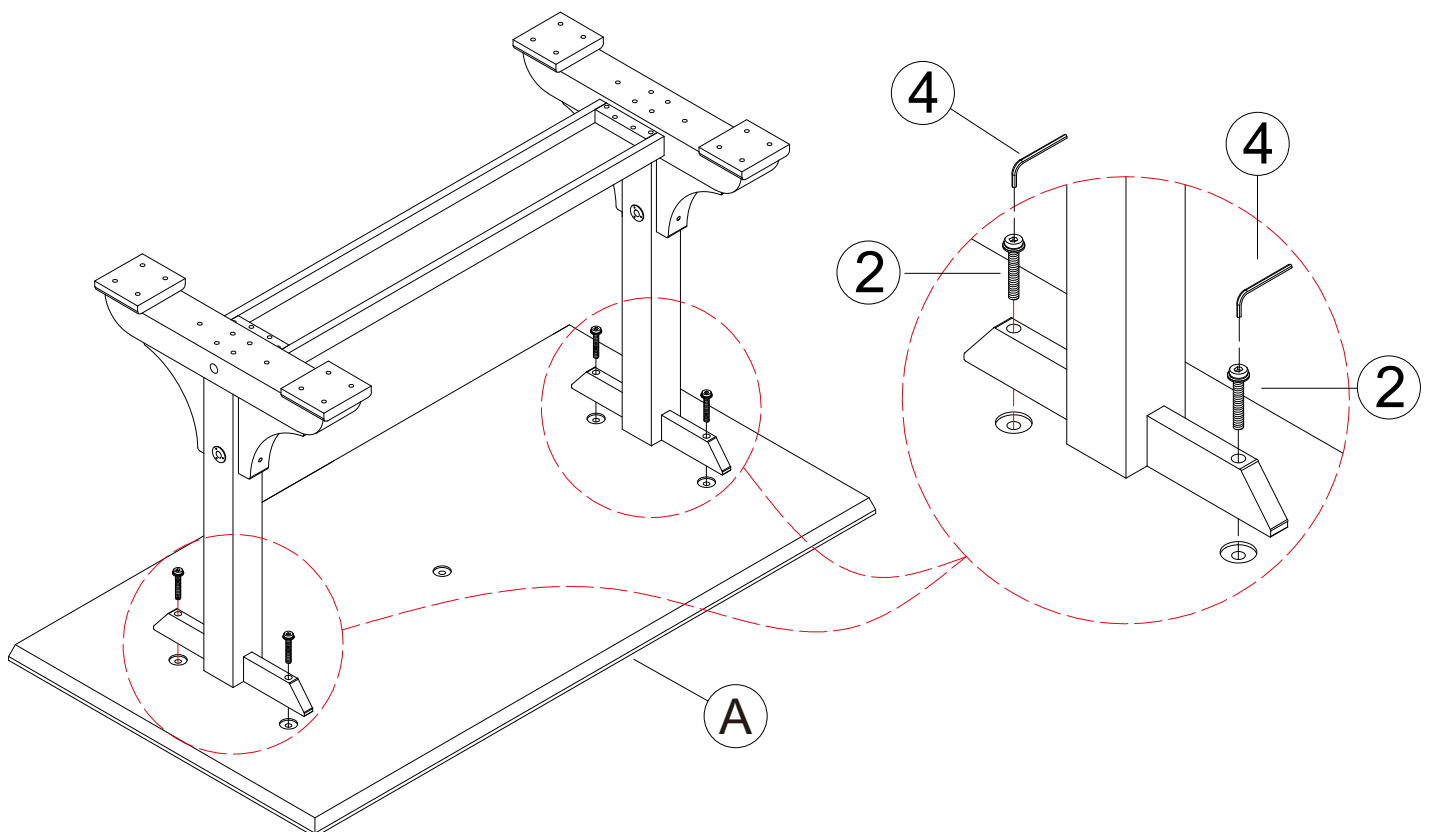

ITEM: **182438(B1&B2)**

ASSEMBLY INSTRUCTIONS



STEP 3

3.2

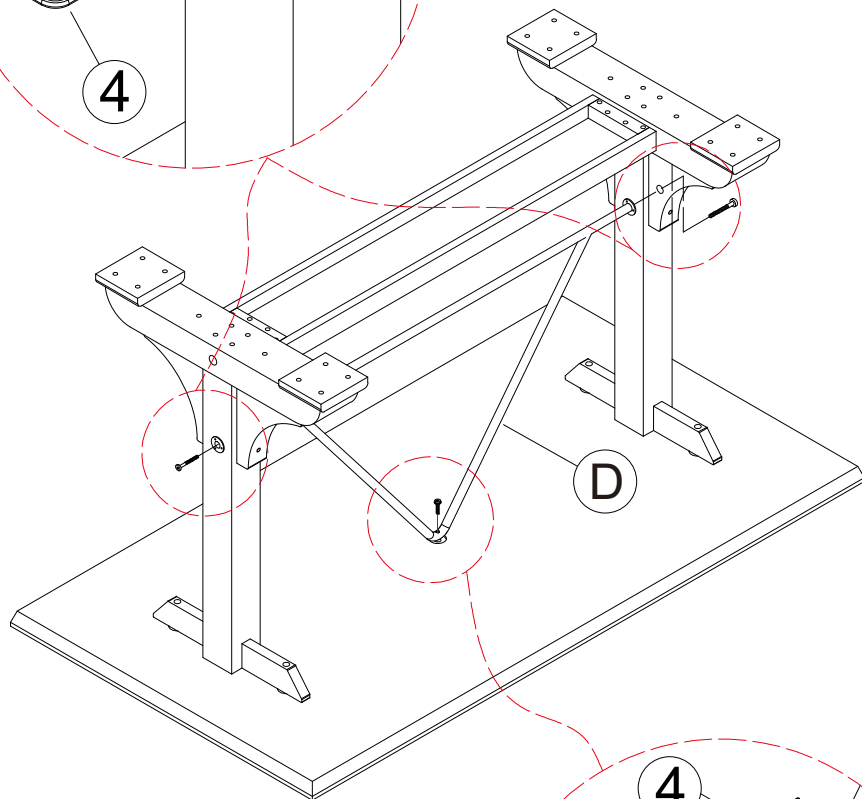
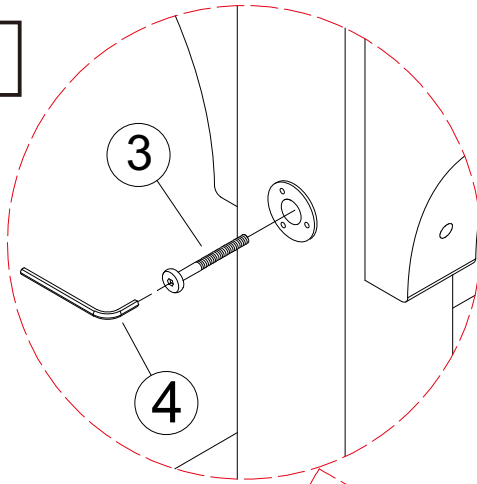

3.1

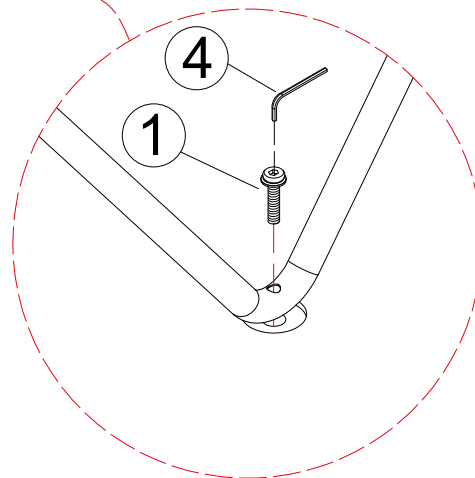

ITEM: **182438(B1&B2)**

ASSEMBLY INSTRUCTIONS



STEP 4

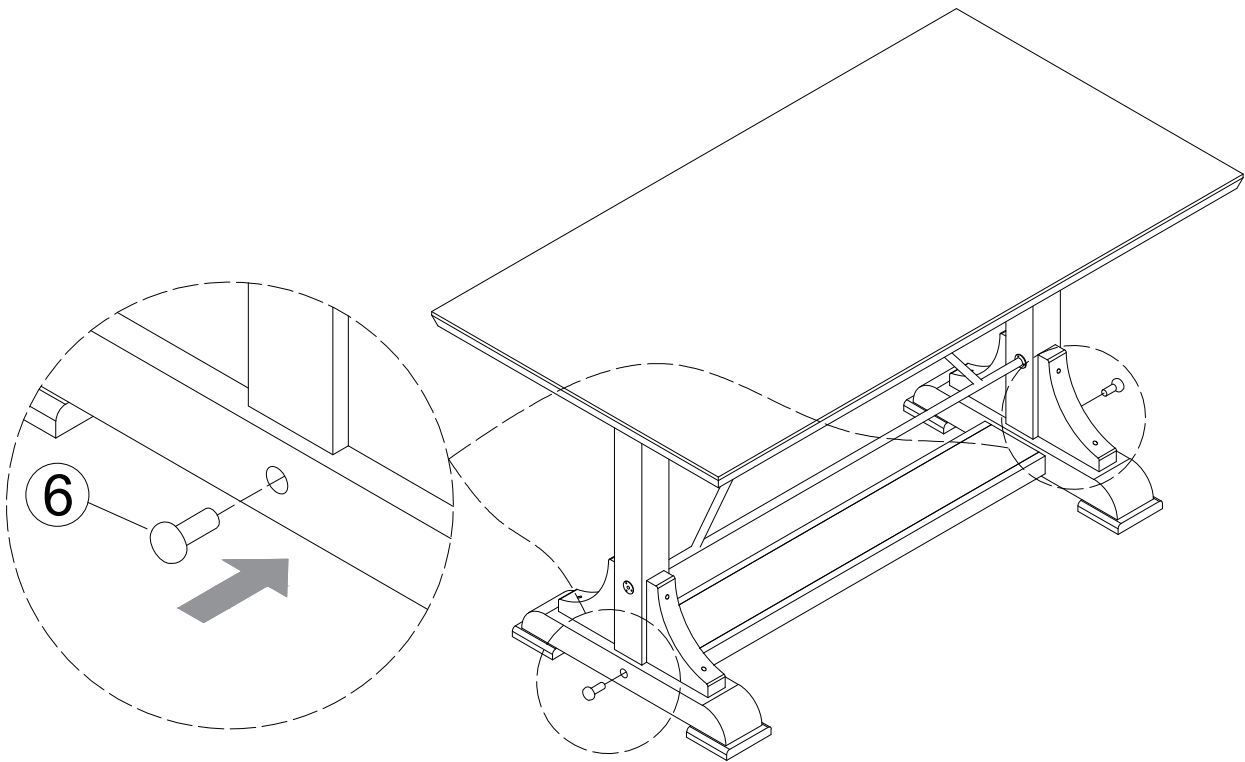

STEP 5 COMPLETE

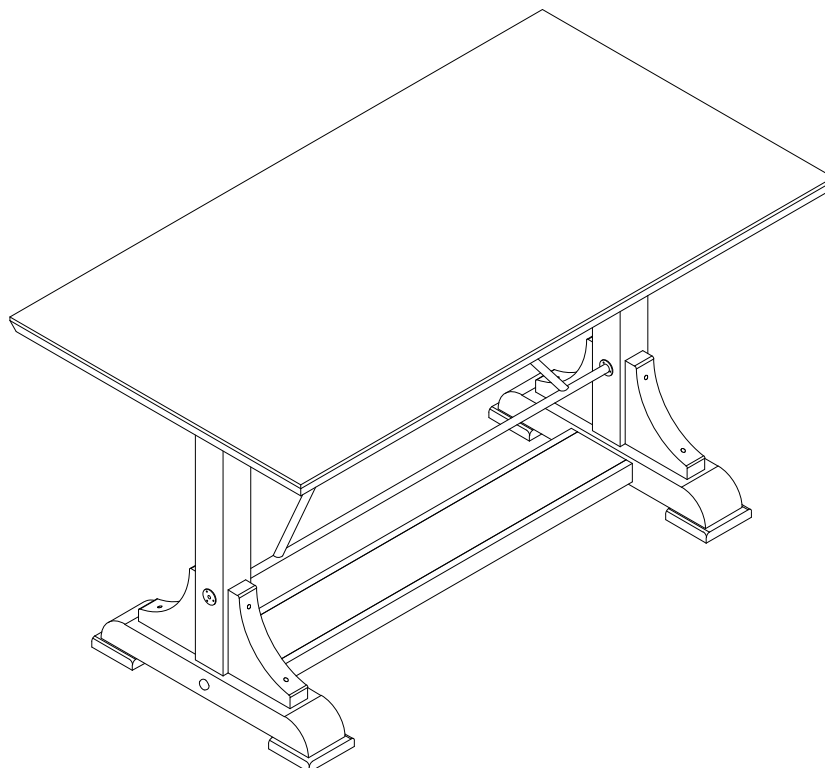

ITEM: **182438(B1&B2)**

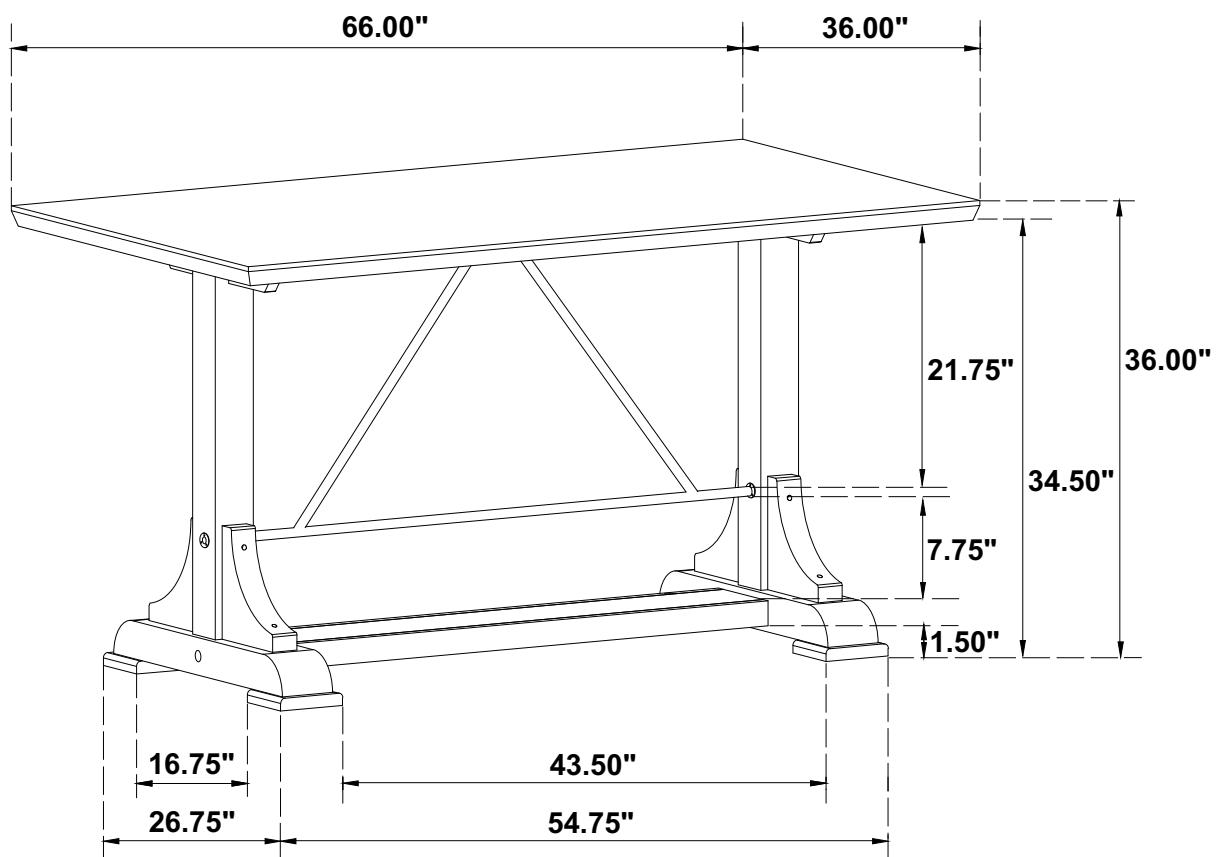

Note : Dimension tolerance $\pm 5\%$