

*ASSEMBLY INSTRUCTIONS
COASTER FINE FURNITURE*



Fine Furniture for every stage of life

315906
BED C-TABLE

ITEM:315906

ASSEMBLY INSTRUCTIONS

ASSEMBLY TIPS:

1. Remove hardware from box and sort by size.
2. Please check to see that all hardware and parts are present prior to start of assembly.
3. Please follow attached instructions in the same sequence as numbered to assure fast & easy assembly.



WARNING!

1. Don't attempt to repair or modify parts that are broken or defective. Please contact the store immediately.
2. This product is for home use only and not intended for commercial establishments.

ASSEMBLY TIME

30 MINUTES

PARTS IDENTIFICATION

A TOP

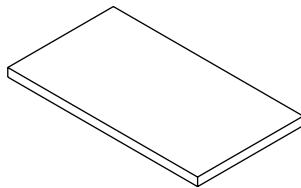

1 PC

B BASE FRAME

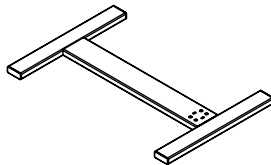

1 PC

C LIFTING POLE

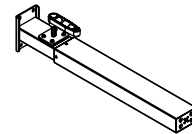

1 PC

D TOP FRAME

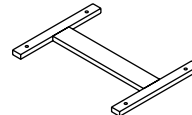

1 PC

HARDWARE IDENTIFICATION

Z							
NO	DESCRIPTION	FIGURE	Q'TY	NO	DESCRIPTION	FIGURE	Q'TY
1	BOLT M6x33mm BLK		4 PCS	5	ALLEN WRENCH 4mm SR		1 PC
2	BOLT M6x15mm BLK		4 PCS	6	ALLEN WRENCH 5mm SR		1 PC
3	BOLT M8x43mm BLK		4 PCS	7	CASTER WITH LOCK		2 PCS
4	FLOOR PROTECTOR 30x15mm		4 PCS	8	CASTER		2 PCS

Z7,Z8 not included in blister packaging.

NOTE:

Phillips head screw driver is required in the assembly process; however, manufacturer does not provide this item.

ITEM: **315906**

STEP 1

COASTER
FINE FURNITURE

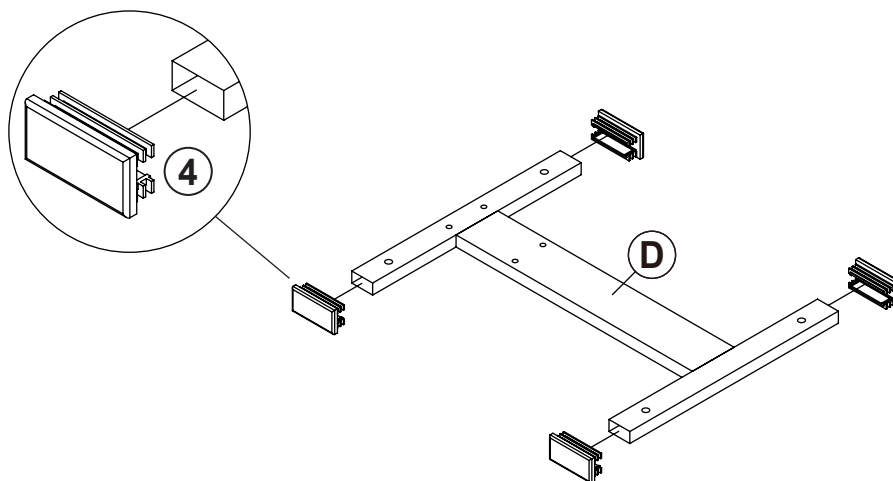
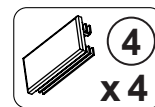

STEP 2

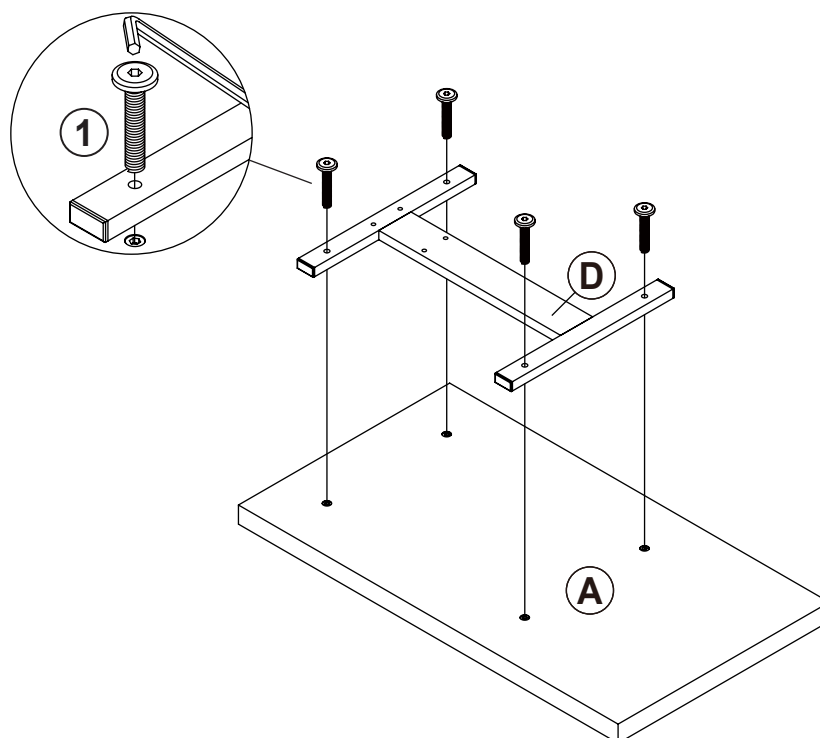
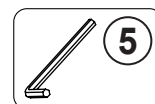
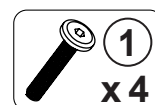

ITEM: **315906**

STEP 3

COASTER
FINE FURNITURE

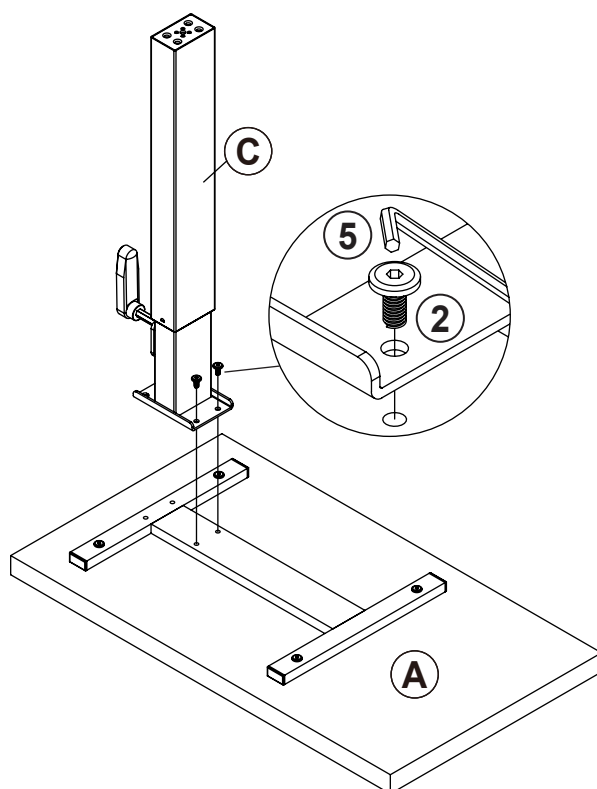
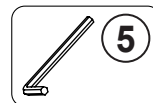
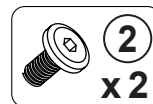

STEP 4

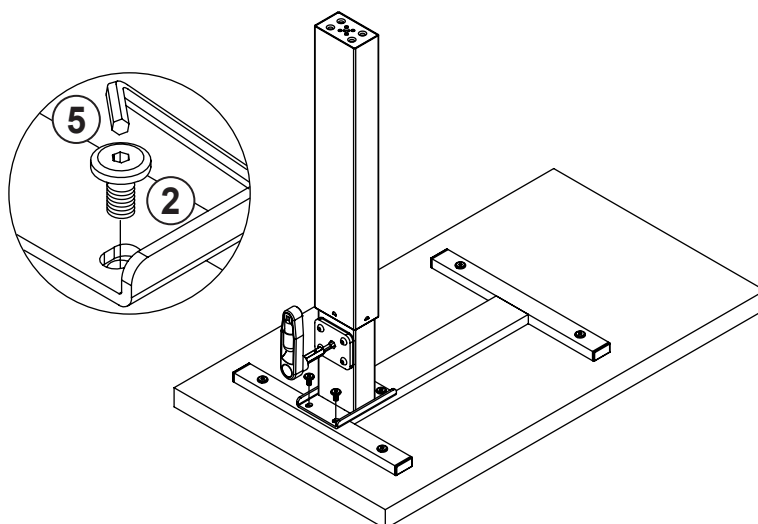
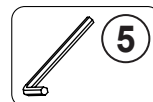
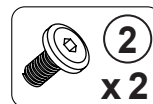

ITEM: **315906**

STEP 5

COASTER
FINE FURNITURE

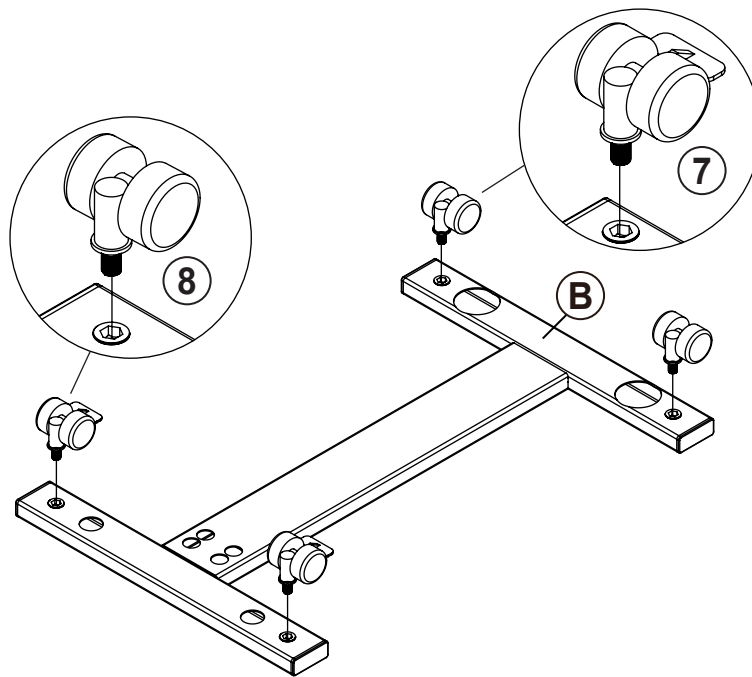
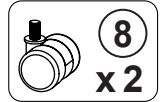
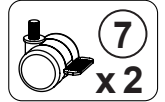

STEP 6

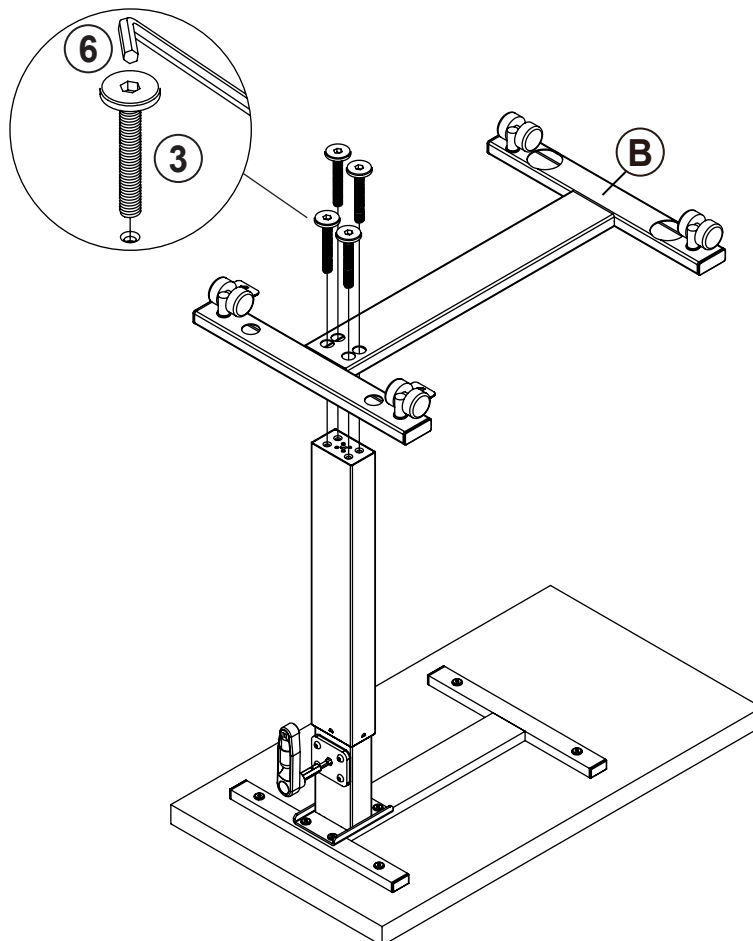
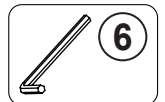
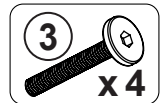

ITEM: **315906**

STEP 7

COMPLETE

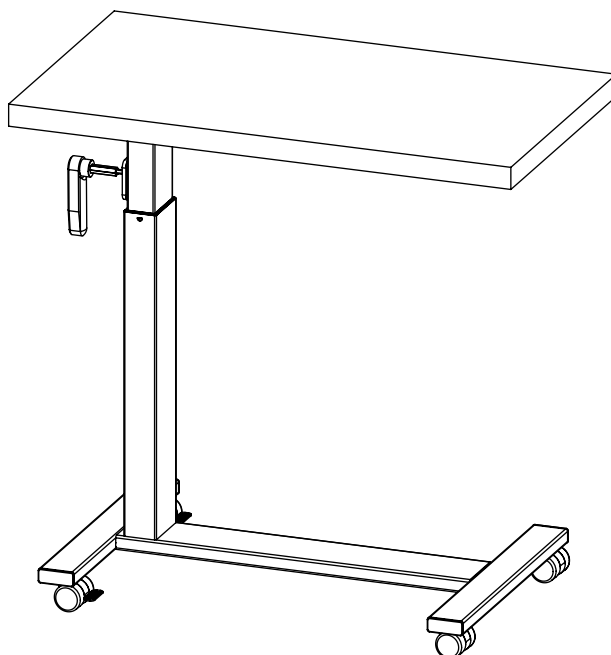

STEP 8

HANDLE USE MANUAL

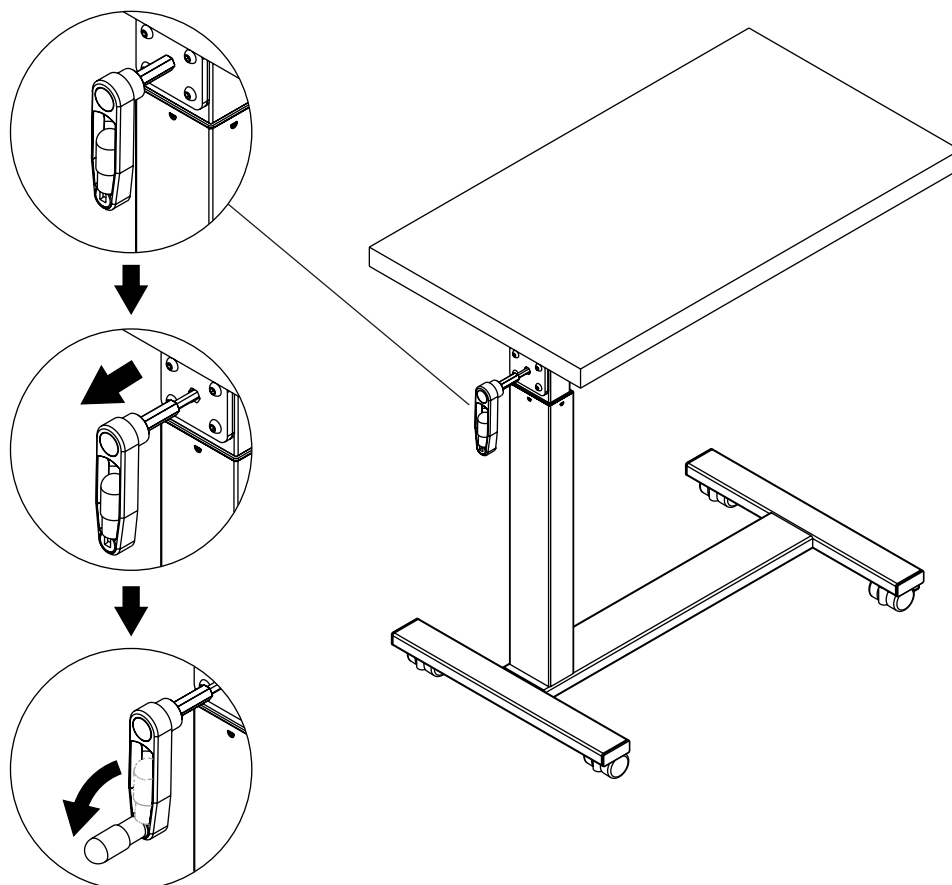

ITEM: **315906**

STEP 9

HANDLE USE MANUAL

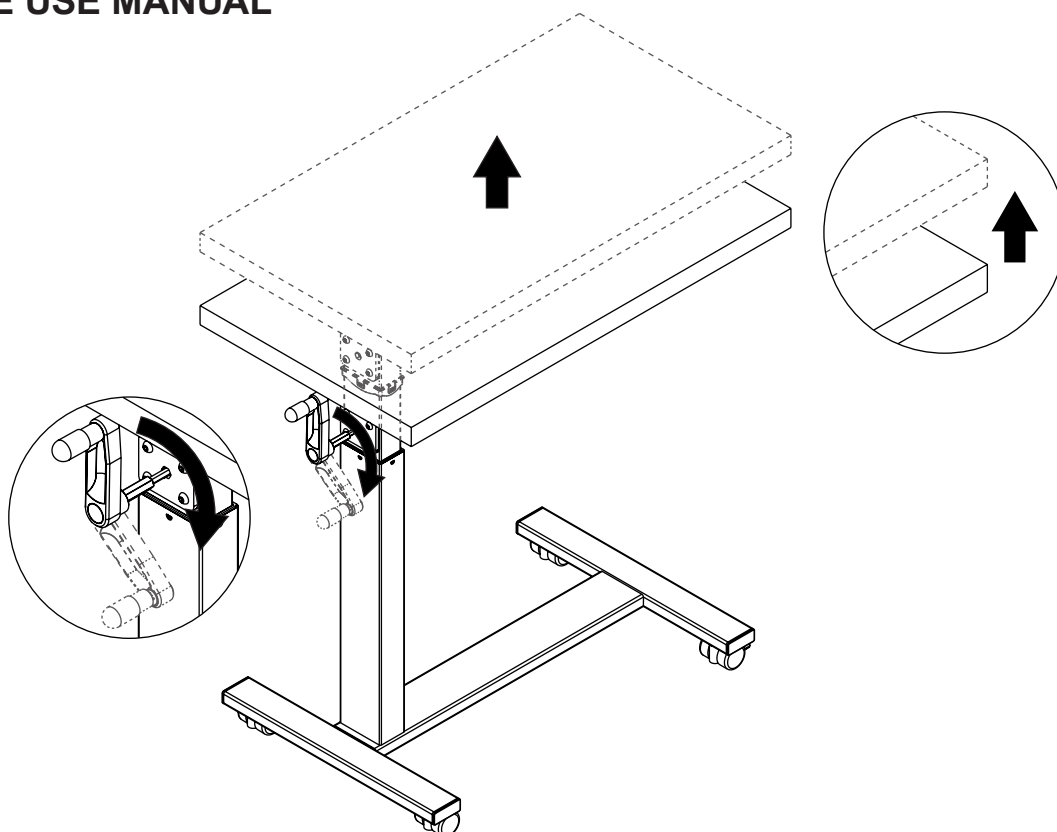

STEP 10

HANDLE USE MANUAL

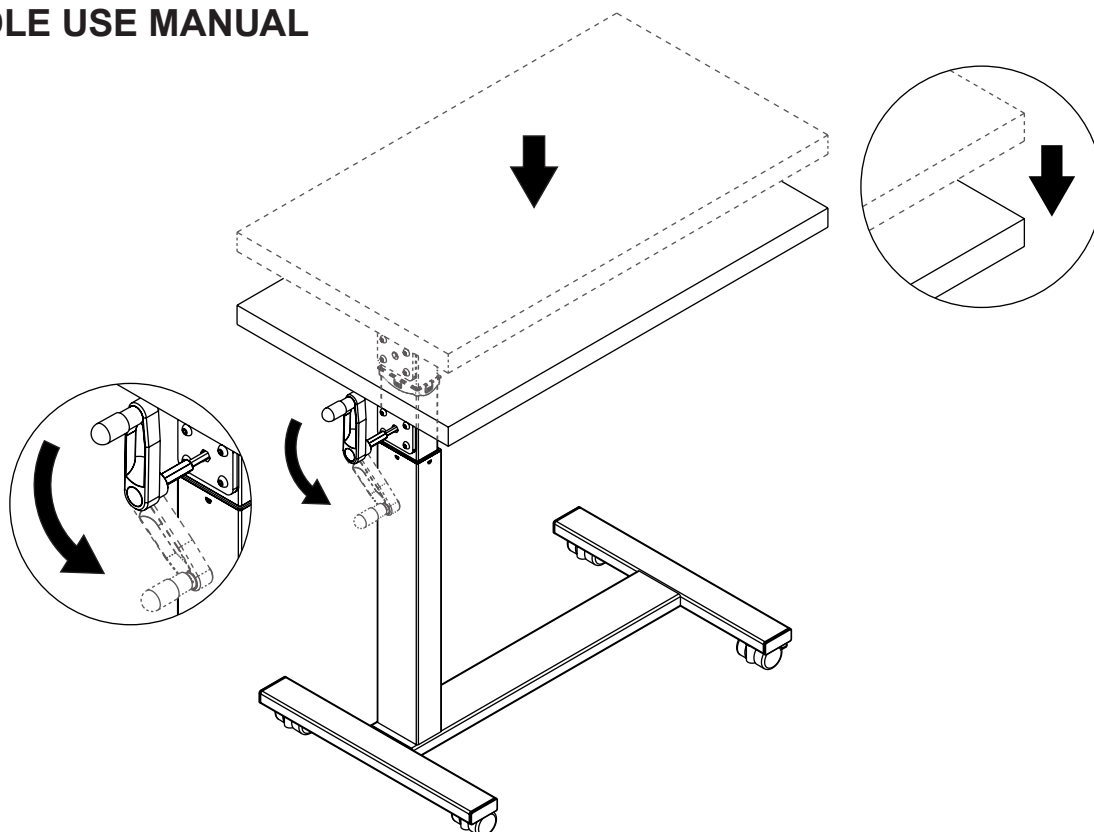

ITEM: **315906**

STEP 11

HANDLE USE MANUAL

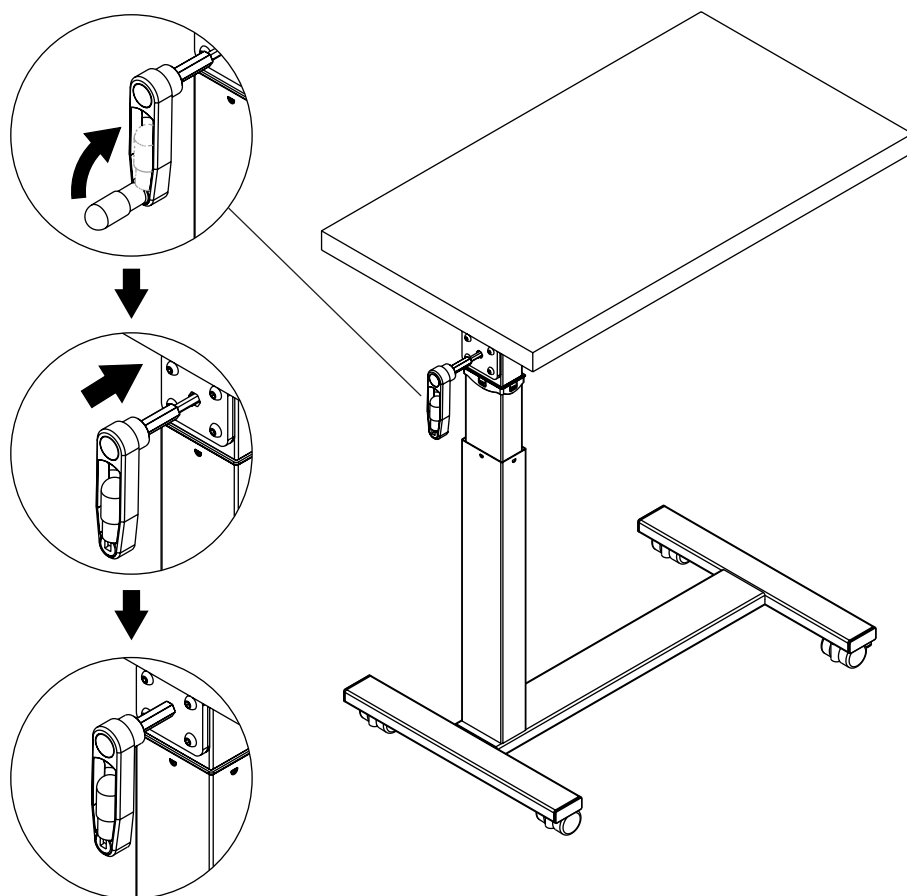

ITEM: 315906

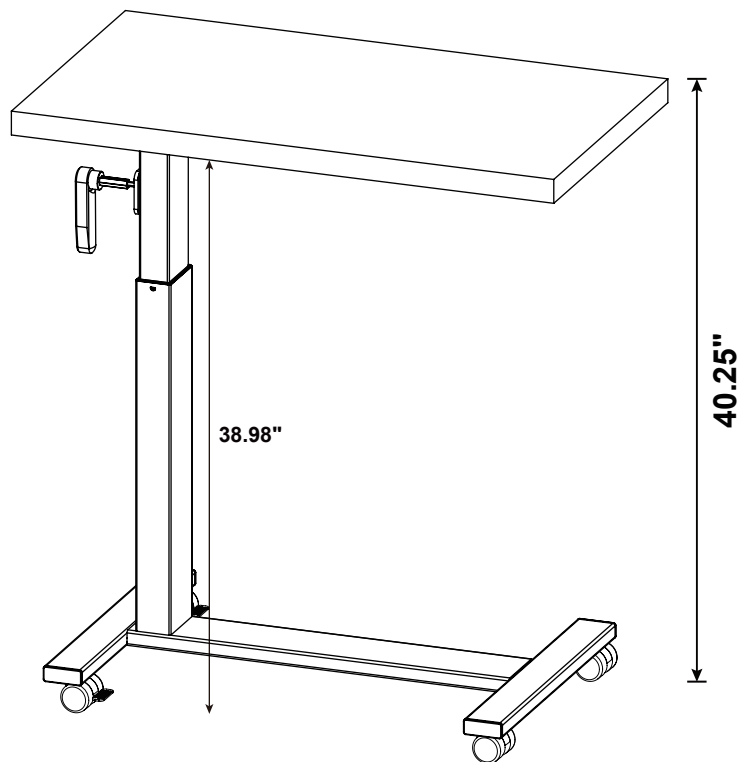
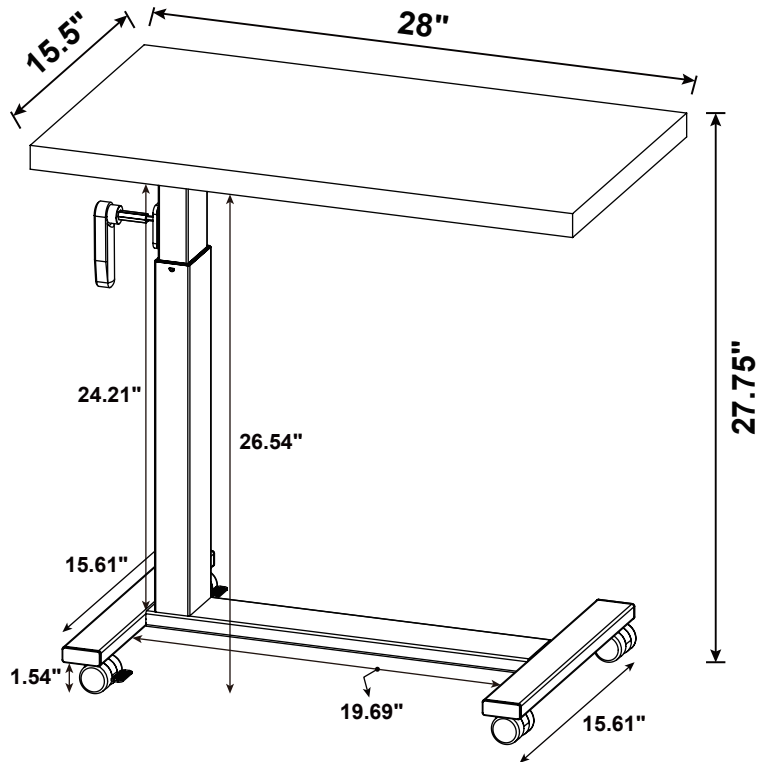

Note : Dimension tolerance $\pm 5\%$