



ASSEMBLY INSTRUCTIONS
COASTER FINE FURNITURE



Fine Furniture for every stage of life

800797(B1&B2)
Writing Desk

ITEM: 800797(B1&B2)

ASSEMBLY INSTRUCTIONS



ASSEMBLY TIPS:

1. Remove hardware from box and sort by size.
2. Please check to see that all hardware and parts are present prior to start of assembly.
3. Please follow attached instructions in the same sequence as numbered to assure fast & easy assembly.



WARNING!

1. Don't attempt to repair or modify parts that are broken or defective. Please contact the store immediately.
2. This product is for home use only and not intended for commercial establishments.



ASSEMBLY TIME

15 MINUTES

PARTS IDENTIFICATION

B1(BOX 1)

A TOP PANEL

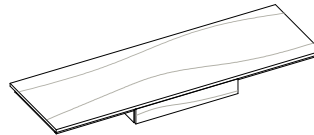

1PC

C BACK PANEL

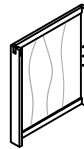

1PC

D BOTTOM PANEL

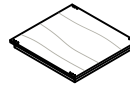

1PC

E RIGHT SIDE APRON



1PC

F LEFT SIDE APRON



1PC

G RIGHT LEG

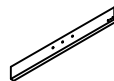

1PC

H LEFT LEG



1PC

I FRONT APRON



1PC

J SHELF PANEL

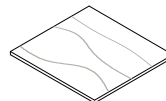

1PC

B2(BOX 2)

B LEFT CABINET



1PC

ITEM: 800797(B1&B2)

ASSEMBLY INSTRUCTIONS



ASSEMBLY TIPS:

1. Remove hardware from box and sort by size.
2. Please check to see that all hardware and parts are present prior to start of assembly.
3. Please follow attached instructions in the same sequence as numbered to assure fast & easy assembly.



WARNING!

1. Don't attempt to repair or modify parts that are broken or defective. Please contact the store immediately.
2. This product is for home use only and not intended for commercial establishments.

HARDWARE IDENTIFICATION

Z- B1(BOX 1) - HARWARE PACK IS LOCATED IN 800797(B1)

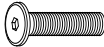
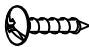
1	LONG BOLT (Ø1/4" x 1 1/2" - BLK)		4PCS
2	SHORT BOLT (Ø1/4" x 1 3/16" - BLK)		8PCS
3	LOCK WASHER (Ø1/4" x 16mm - BLK)		12PCS
4	FLAT WASHER (Ø1/4" - BLK)		12PCS
5	WOOD DOWEL (Ø5/16" x 1 1/4")		20PCS
6	CAM NUT (Ø15 x 12mm - SR)		6PCS
7	CAM BOLT (Ø6 x 32mm - SR)		6PCS
8	SHELF SUPPORT (1 x 19mm - BLK)		4PCS
9	FLAT HEAD SCREW (5/8" x 15mm - BLK)		4PCS
10	ALLEN WRENCH (4 x 59mm - BLK)		1PC

NOTE:

Phillips head screw driver is required in the assembly process; however, manufacturer does not provide this item.

ITEM: **800797(B1&B2)**
ASSEMBLY INSTRUCTIONS

STEP 1

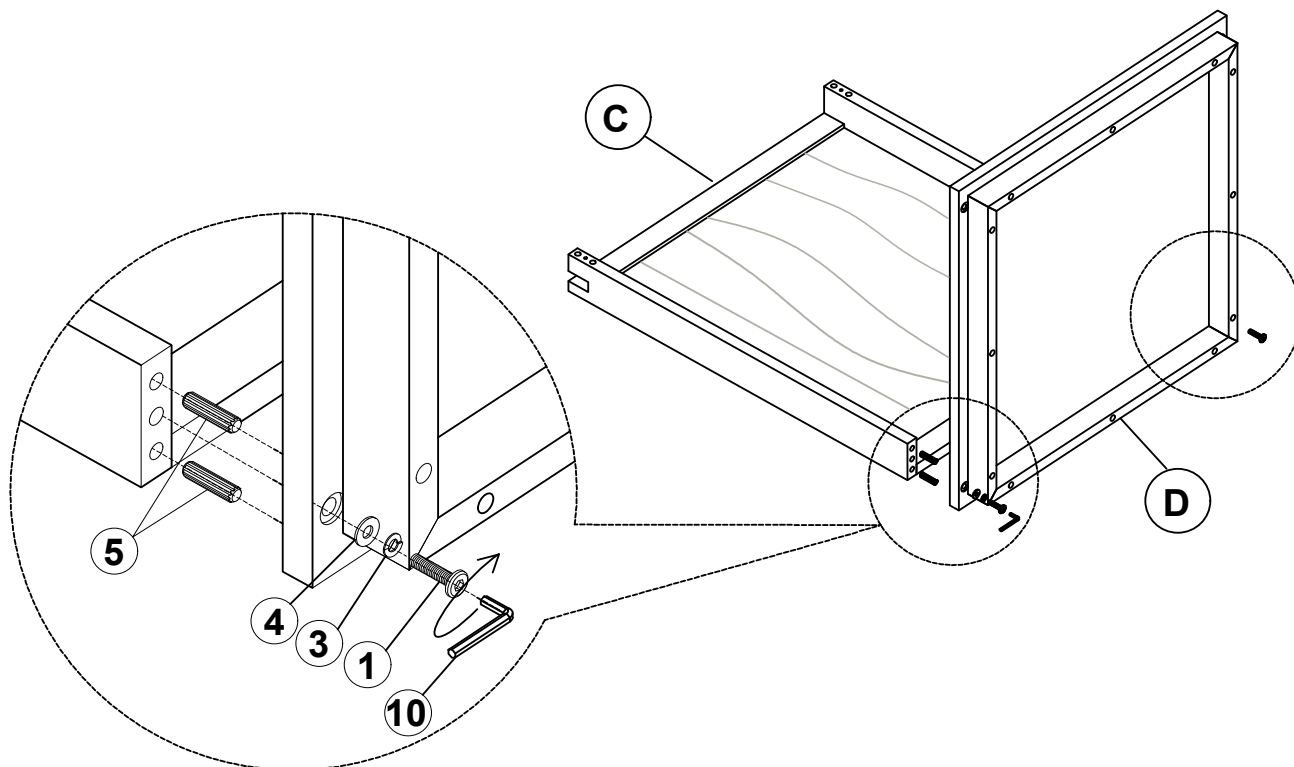

STEP 2

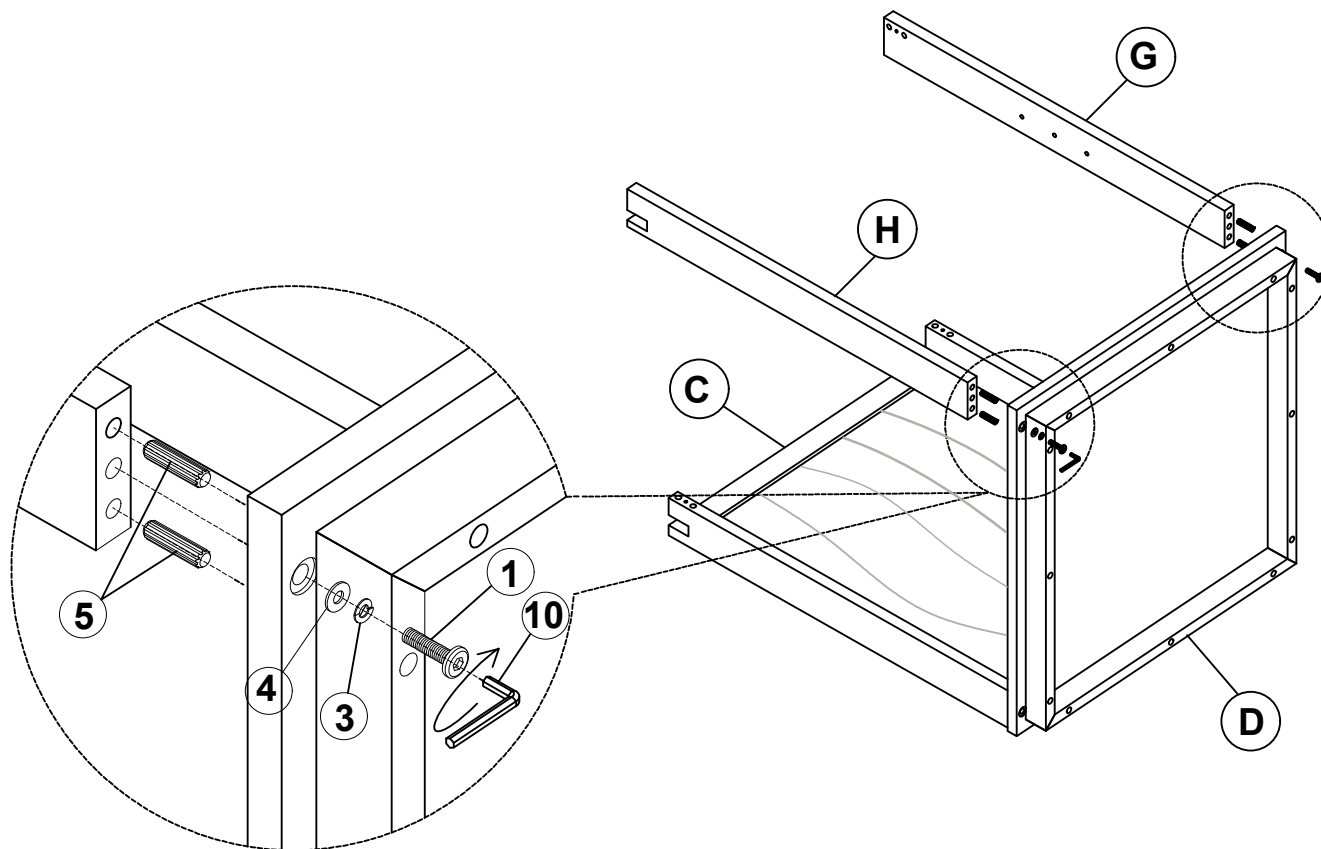

ITEM: 800797(B1&B2)

ASSEMBLY INSTRUCTIONS

STEP 3

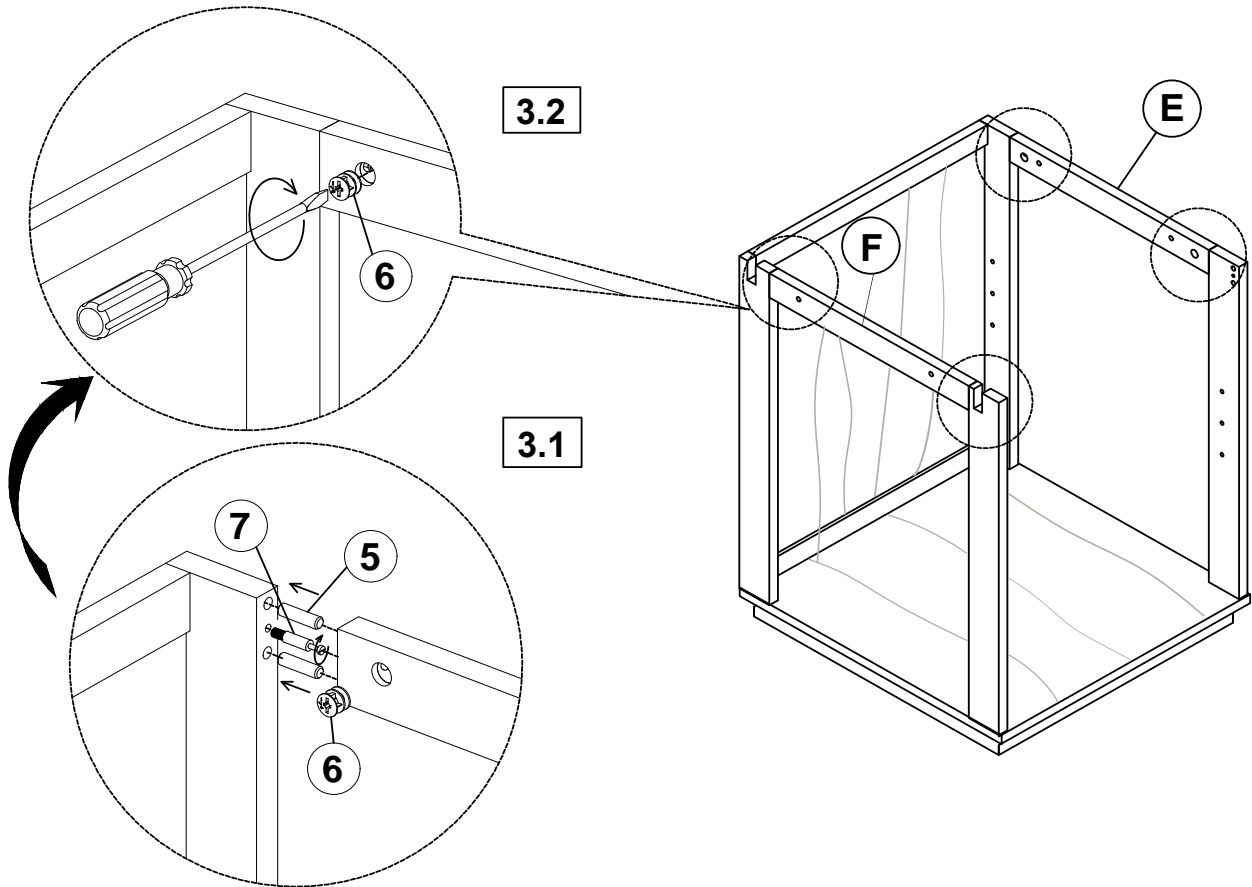

STEP 4

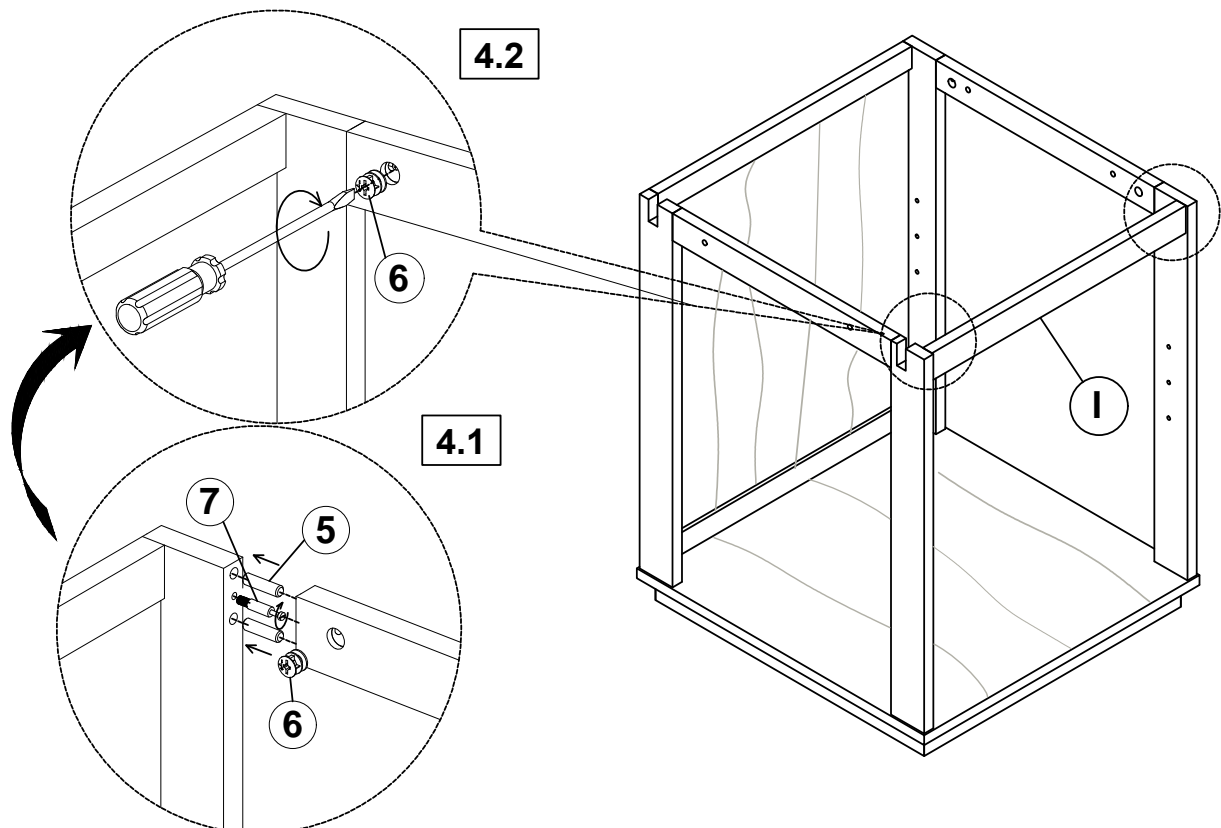

ITEM: **800797(B1&B2)**
ASSEMBLY INSTRUCTIONS

STEP 5

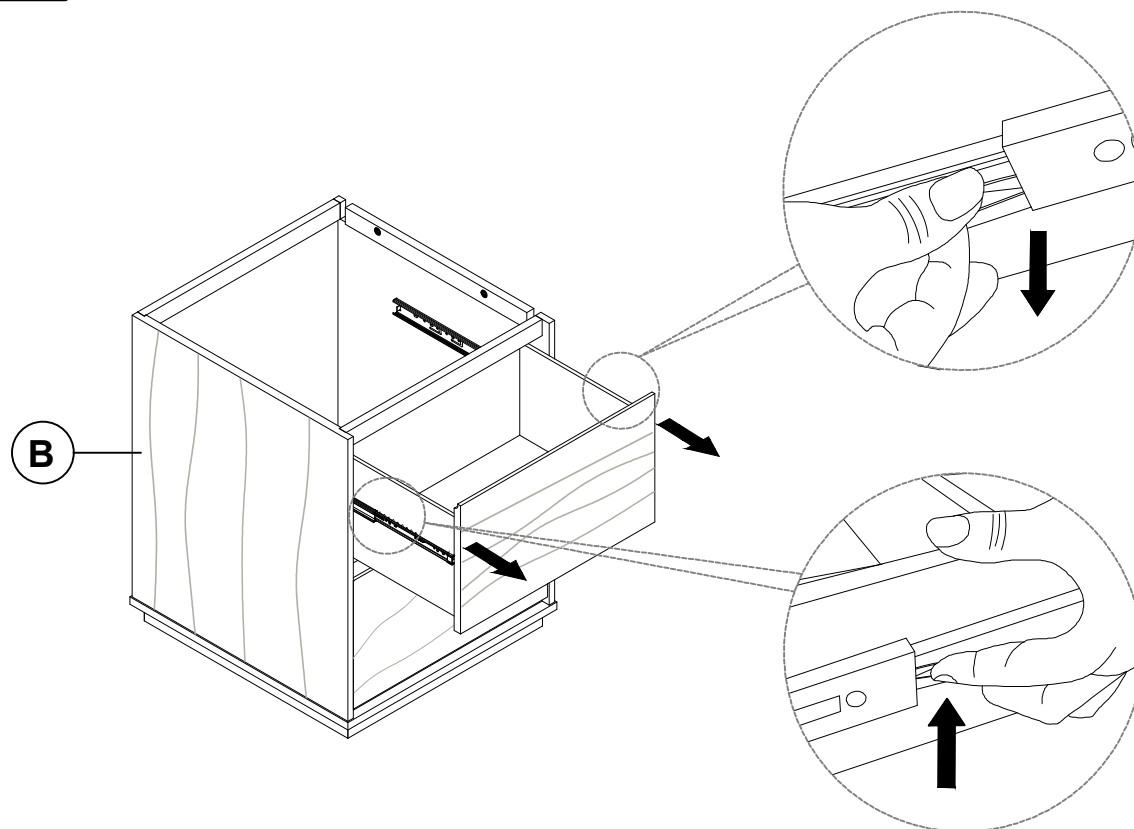

STEP 6

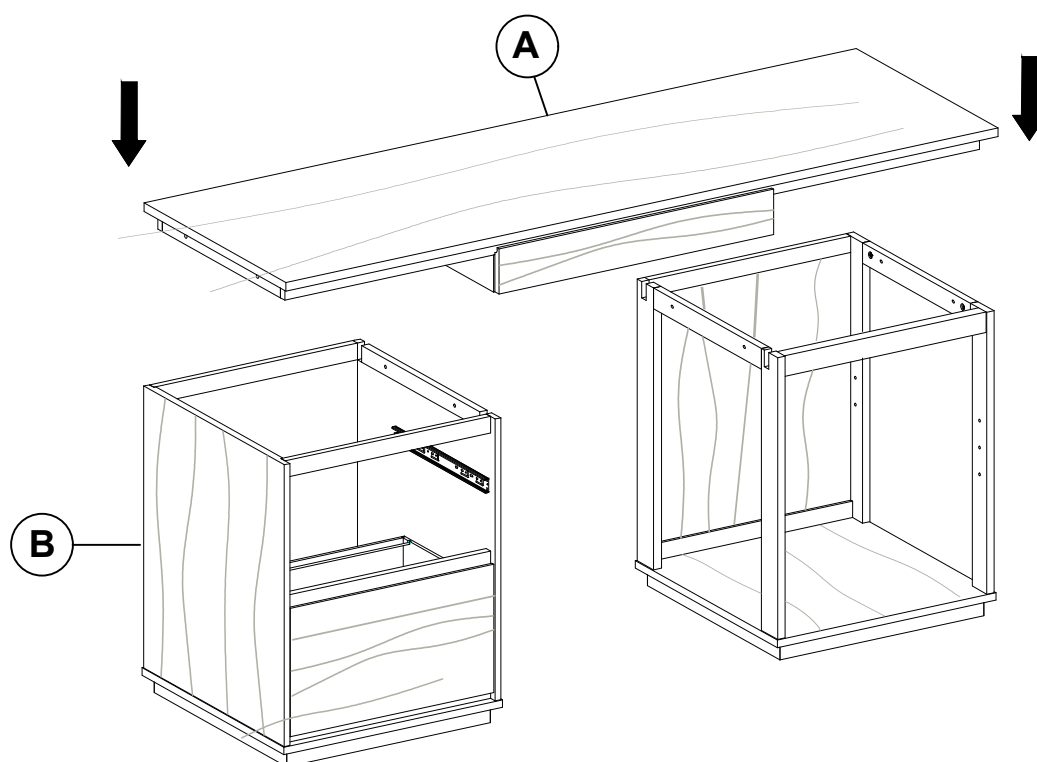

ITEM: **800797(B1&B2)**
ASSEMBLY INSTRUCTIONS

STEP 7

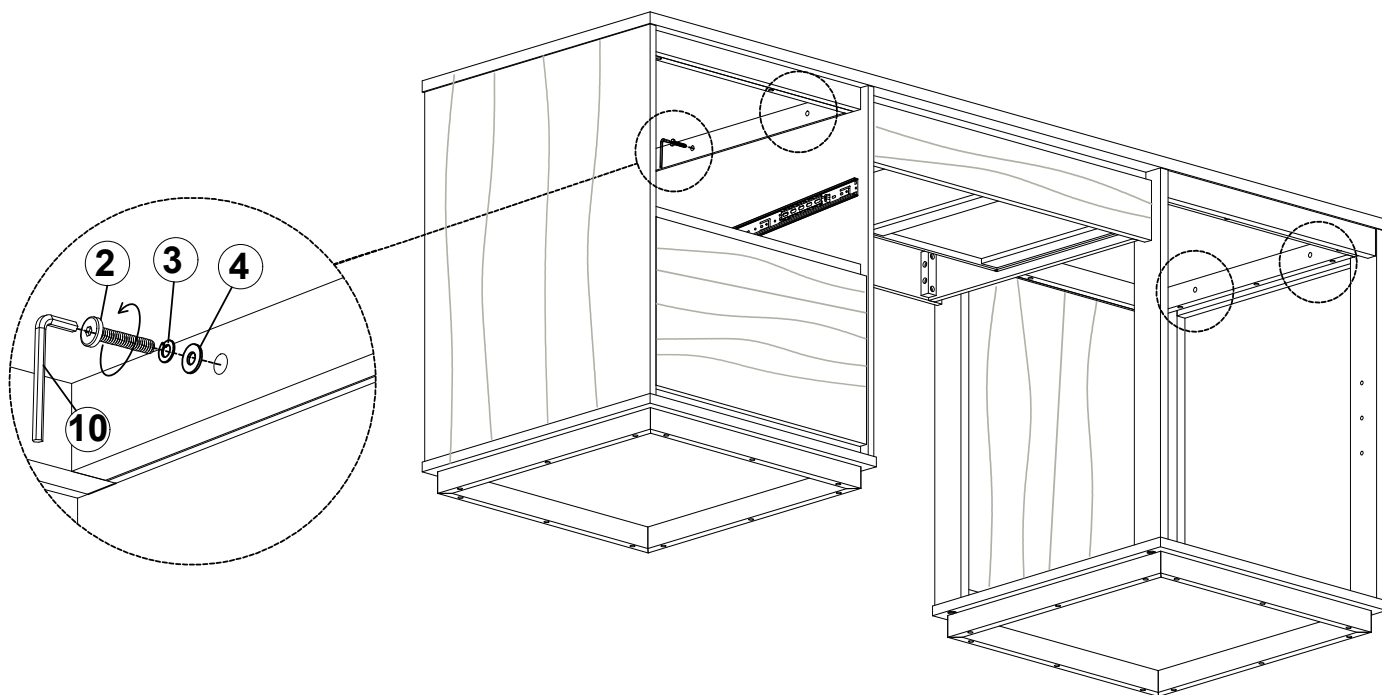

VIEW FROM THE LEFT

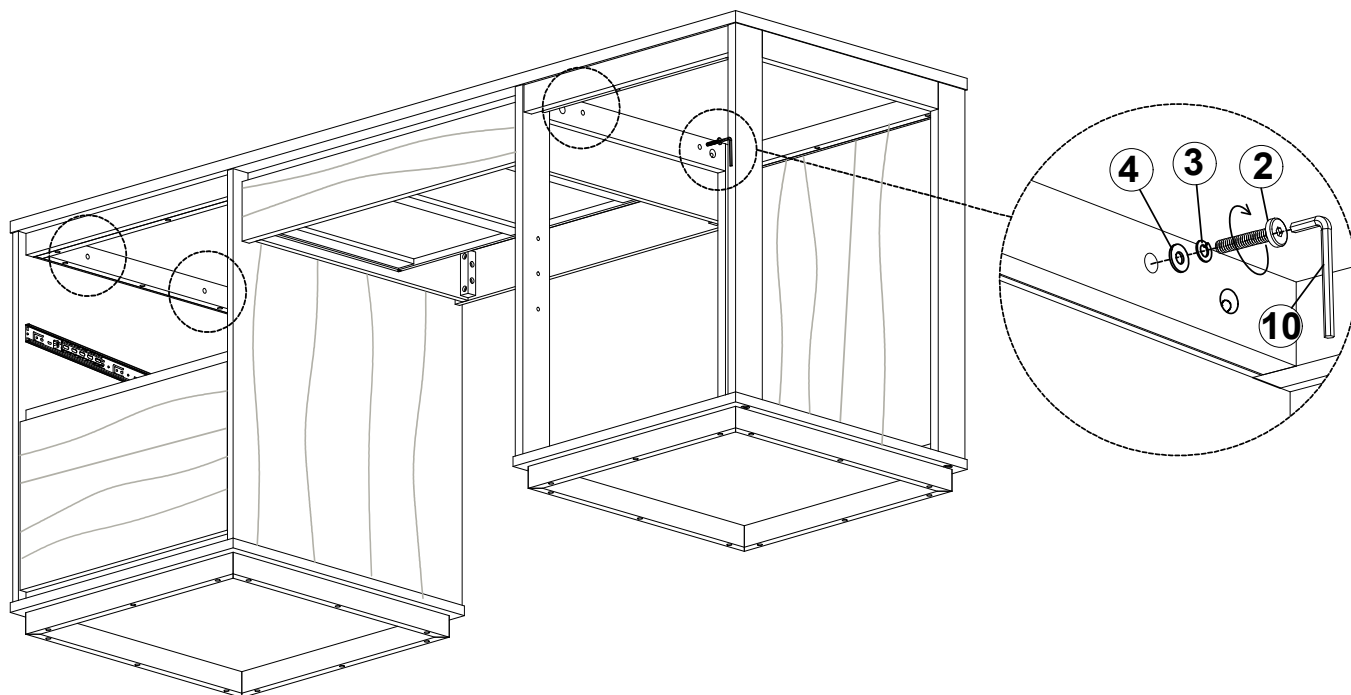

VIEW FROM THE RIGHT

ITEM: **800797(B1&B2)**

ASSEMBLY INSTRUCTIONS

STEP 8

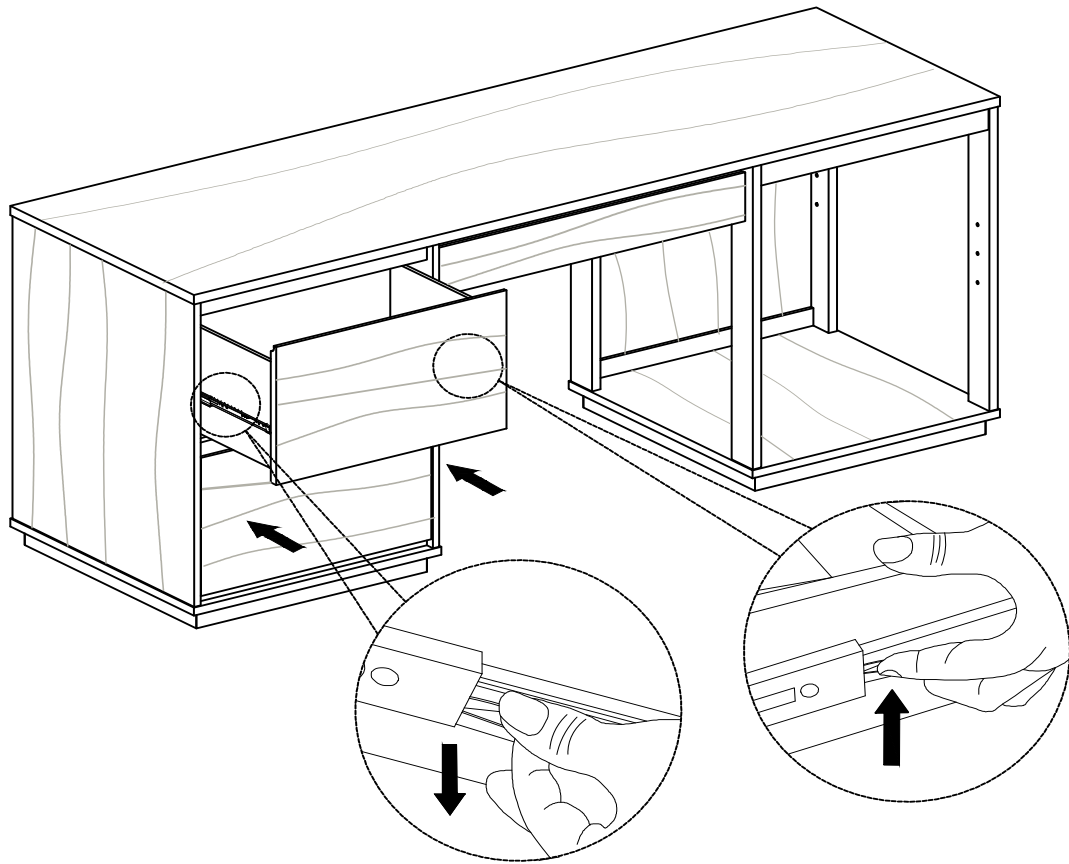

STEP 9

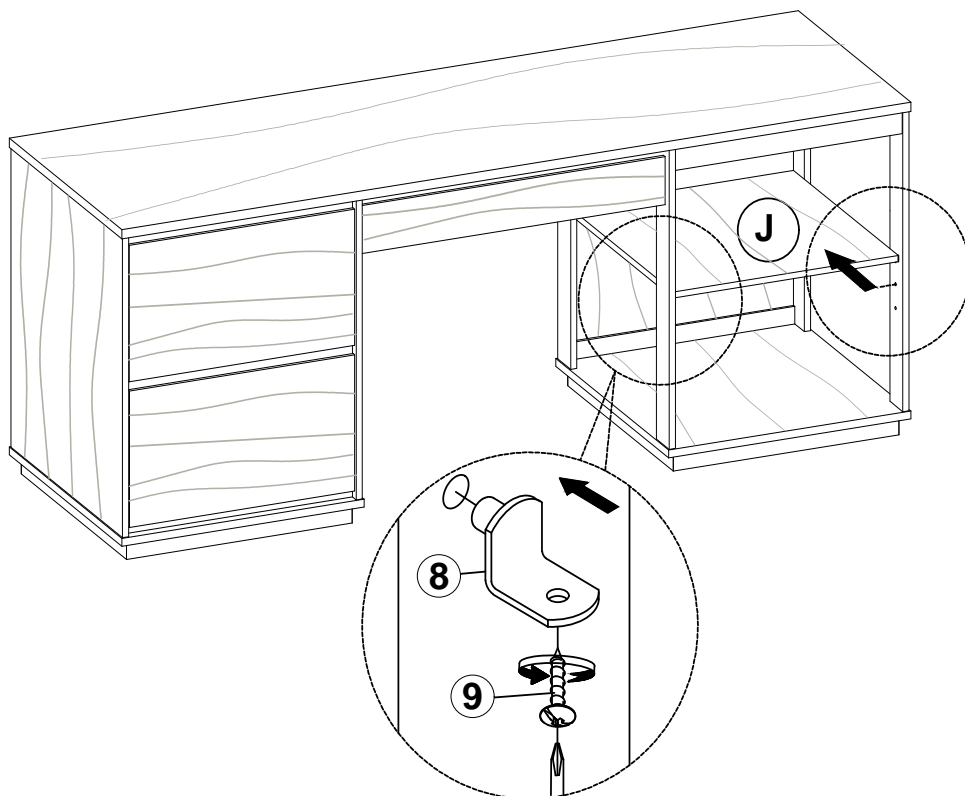

ITEM: **800797(B1&B2)**

ASSEMBLY INSTRUCTIONS

STEP 10

COMPLETE

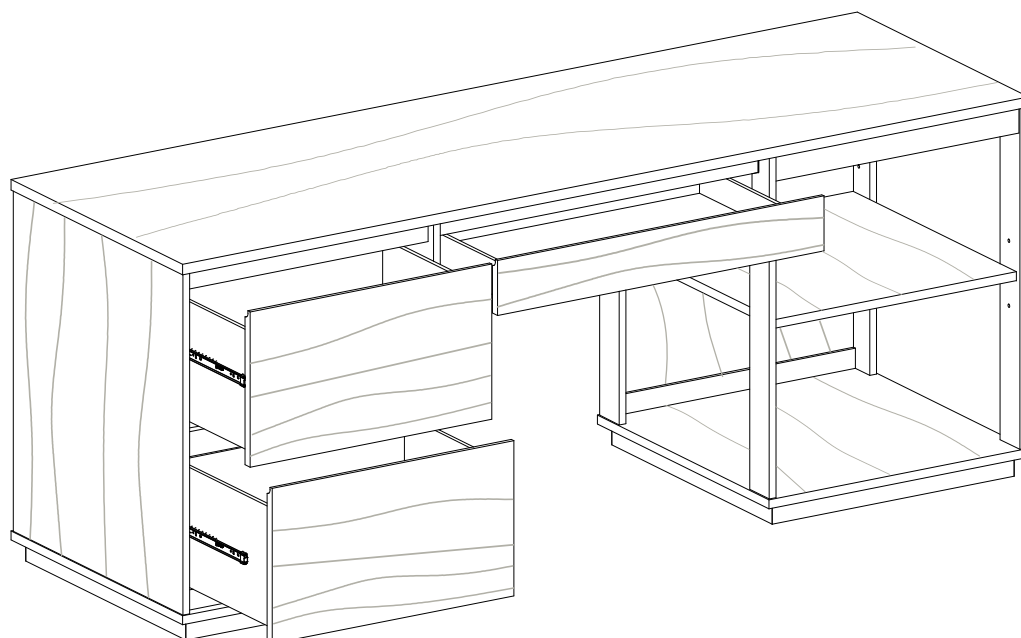
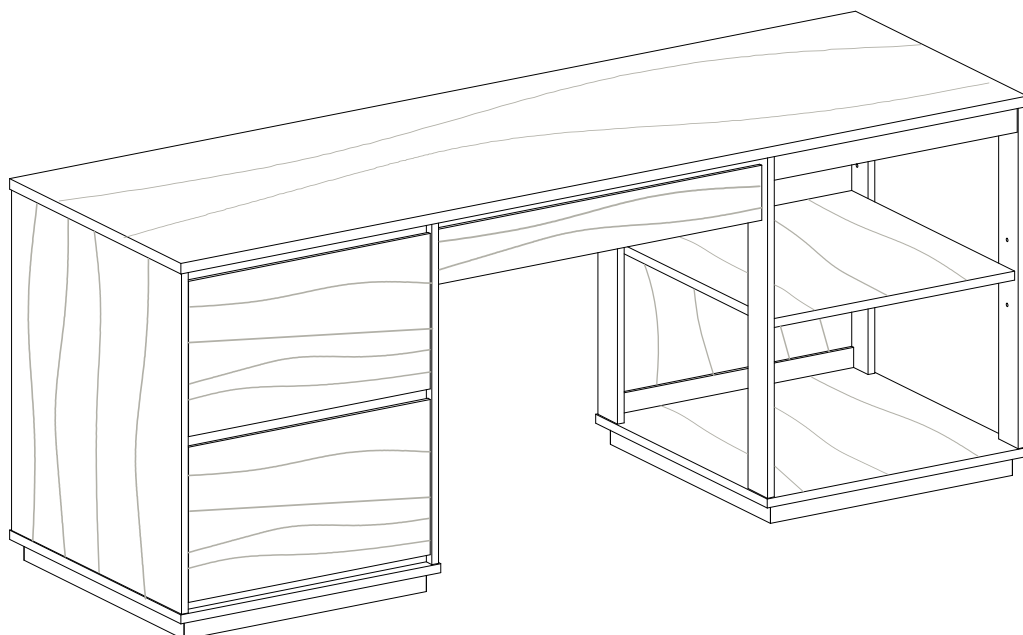

OPTIONAL ADJUSTABLE SHELF

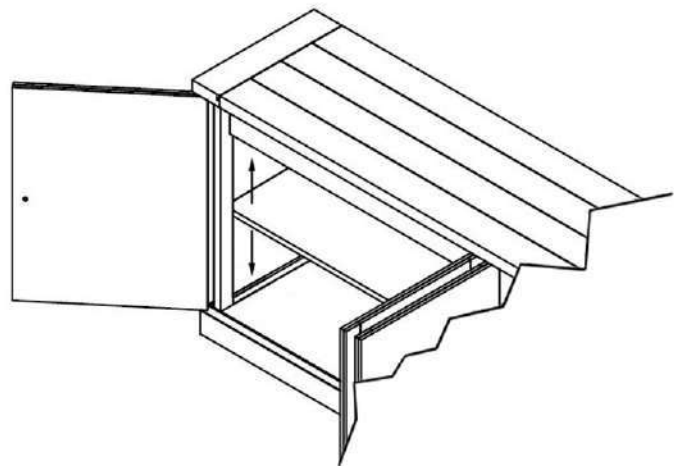
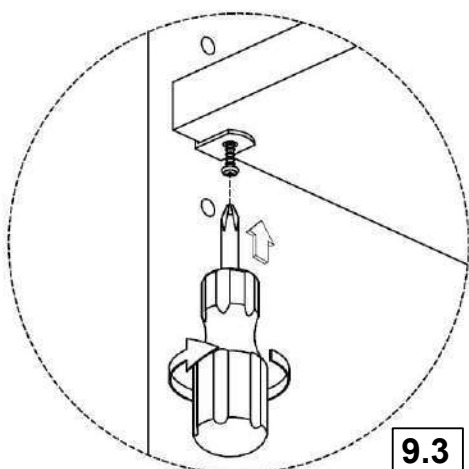
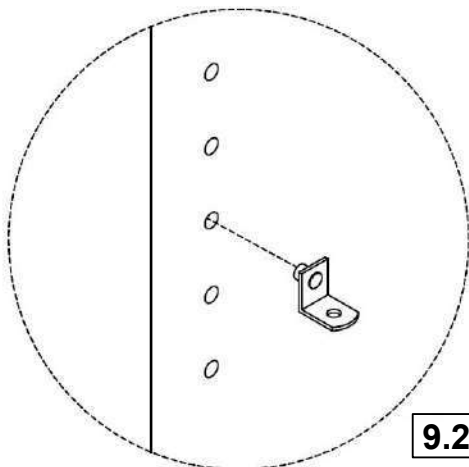
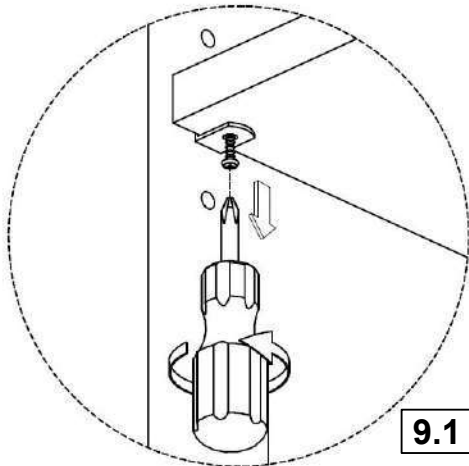

NOTE:

Phillips head screw driver is required in the assembly process; however, manufacturer does not provide this item.

